

29 APR 1963

# SCANTLING SECTIONS

FOR

500 TON POWERED TANKER CARGO ABOVE 150° FLASH

DIMENSIONS: O.A. 163'-3" • BP 149'-8" • BEAM. 32'-6" • DEPTH. 10'-6"

— CLASS. 100.A.I. AT LLOYDS FOR "RIVER THAMES SERVICE" —

"ELECTRICALLY WELDED"

DETAILS OF EQUIPMENT TO BE SUBMITTED

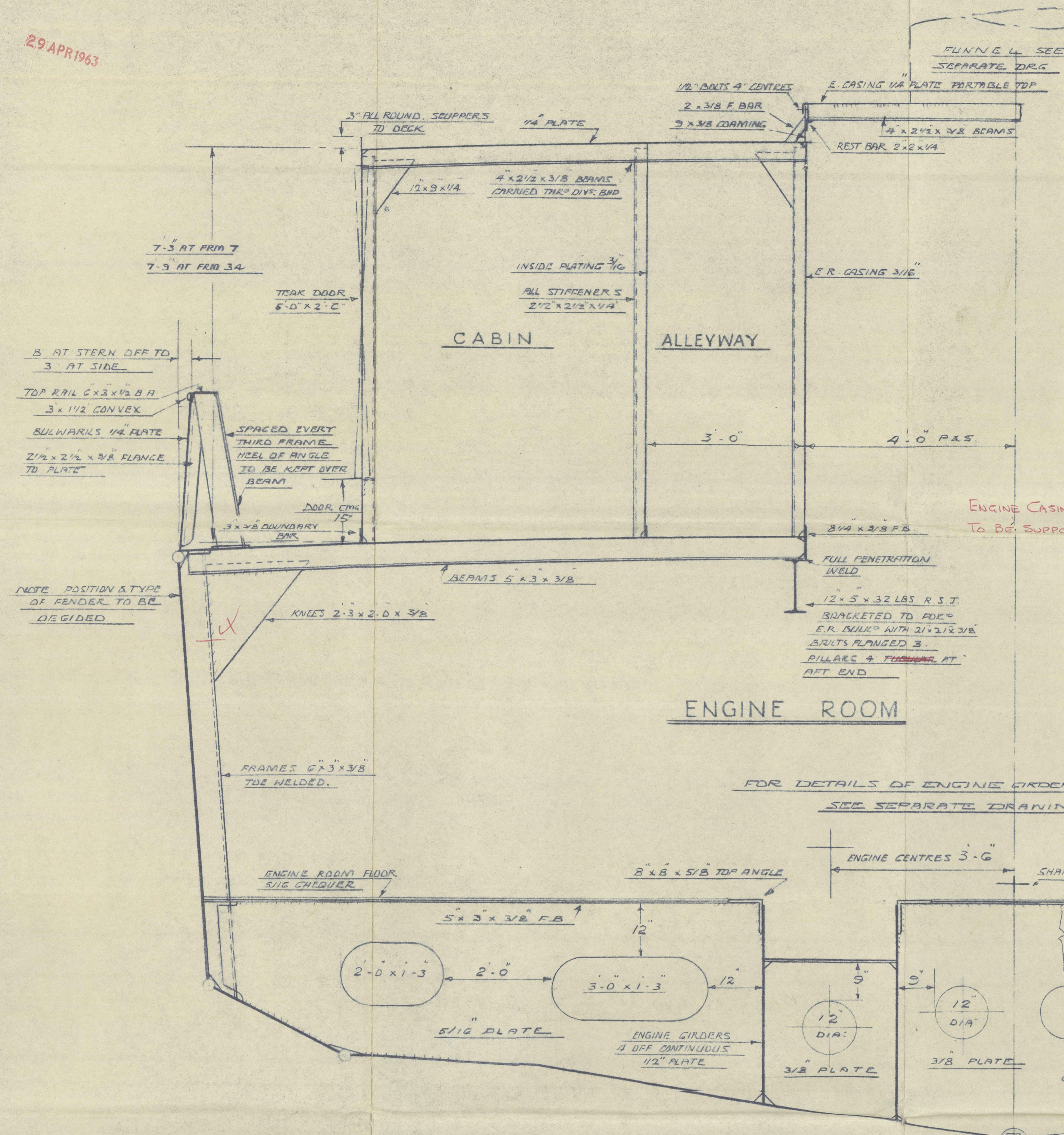

SECTION AT FRAME 24 LOOKING AFT

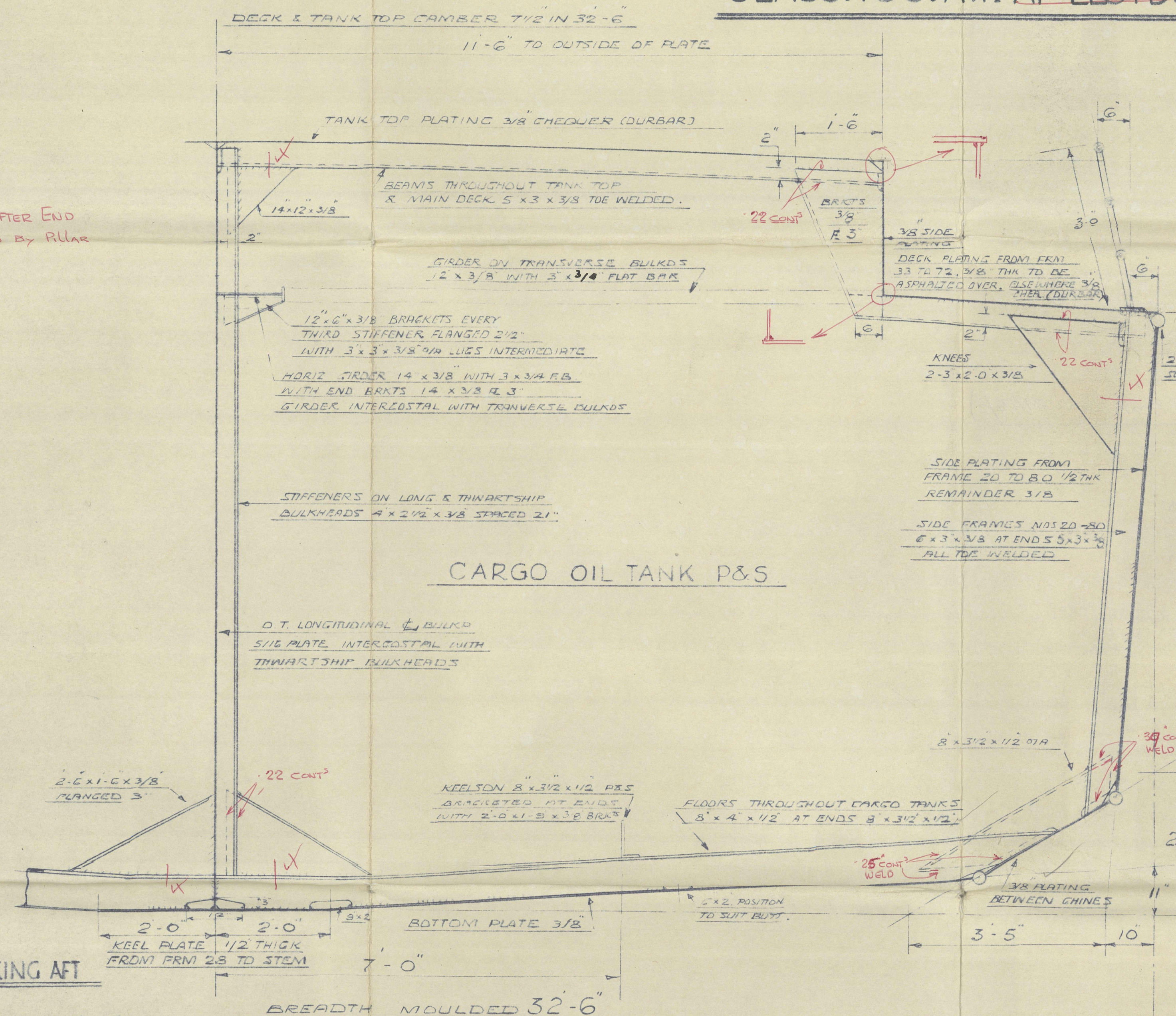

MIDSHIP SECTION LOOKING FORWARD

SCALE 3/4" = 1' FT

FRAME SPACING THROUGHOUT 21" • CAMBERS 7 1/2" IN 32'-6"

TEST HEAD 2'-0" ABOVE TRUNK TOP

SECTION AT FRAME 80. LOOKING FORWARD.

FAIRMILE  
MARINE CONSULTANTS LTD  
CORNHAM SURREY ENGLAND  
SCANTLING SECTIONS

SCALE 3/4" = 1' FT  
DRAWN J BLACKWOOD  
DATE 2-4-63

BUILDERS • CHARRINGTON GARDNER LOCKET • LONDON LTD • PRIORY WORKS • DARTFORD • KENT.

012786-012791-0126

© 2021  
Lloyd's Register  
Foundation

CHARRINGTON GARDNER LOCKET LTD.

<sup>u</sup>  
CHARCREST 

SCANTLING SECTIONS (DRG. N<sup>o</sup> FM/174/2)

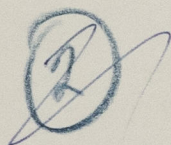

This plan has been verified with the approved plans, and includes any modifications and/or additions to the original approved arrangements made during construction which have been approved locally as being in accordance with or equivalent to Rules Requirements.

Signature .....  
Surveyor to Lloyd's  
Register

RECORDS DEPT.  
LONDON.

Date .....  
Date .....

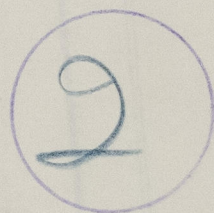



© 2021

Lloyd's Register  
Foundation

012786-012791-0126