

T.S.M.V. "GEBOSO"

GENERAL ARRANGEMENT.

SCALE :- 1/4" = 1 FOOT.

OFFICIAL NO.

PRINCIPAL DIMENSIONS :- LENGTH 102'-8" B.DTH MLD 26'-0" DEPTH MLD 6'-0"
 REGISTERED DIMENSIONS :- LENGTH 105'-0" B.DTH 26'-05" DEPTH 5'-7"
 GROSS TONNAGE 210.32 TONS
 NETT. TONNAGE 69.92 TONS
 SUEZ CANAL GROSS TONNAGE 220.11 TONS
 SUEZ CANAL NETT TONNAGE 137.29 TONS

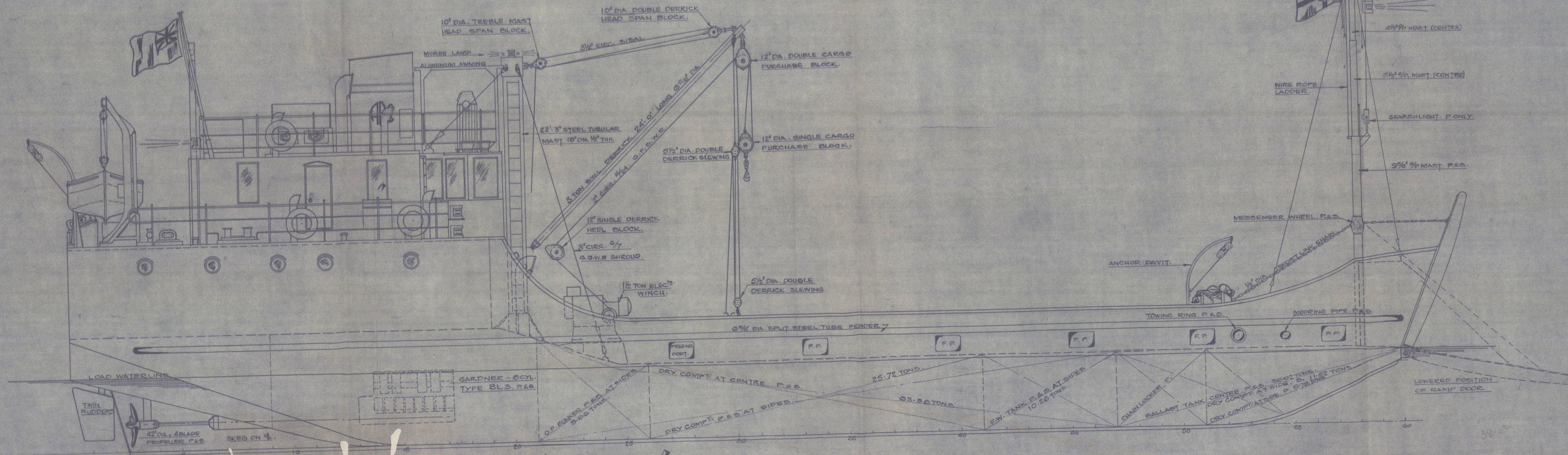

PROFILE.

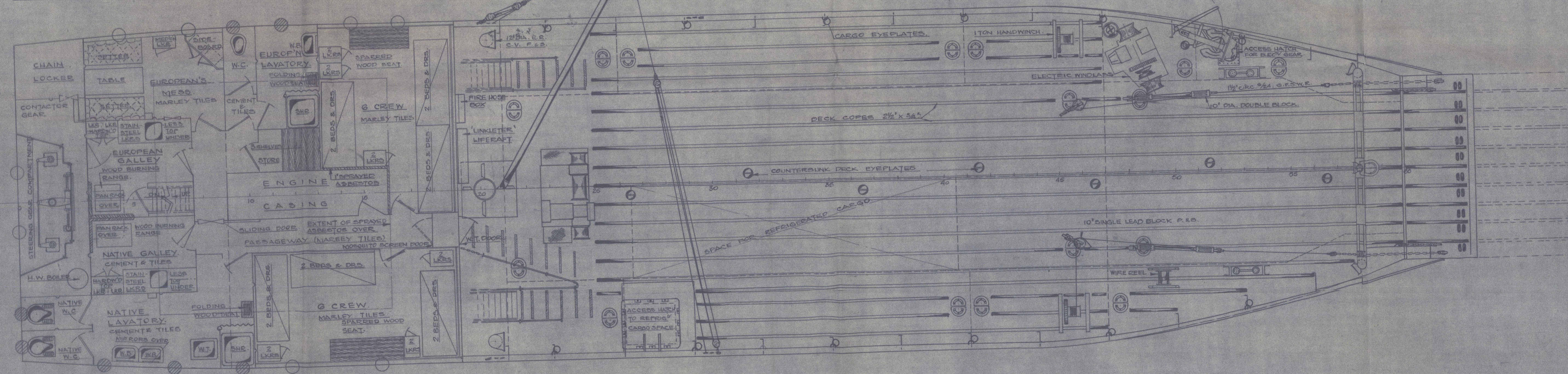

MAIN DECK

TWEEN DECK HEIGHT 7'-0"
 SIDELIGHTS 12" DIA.

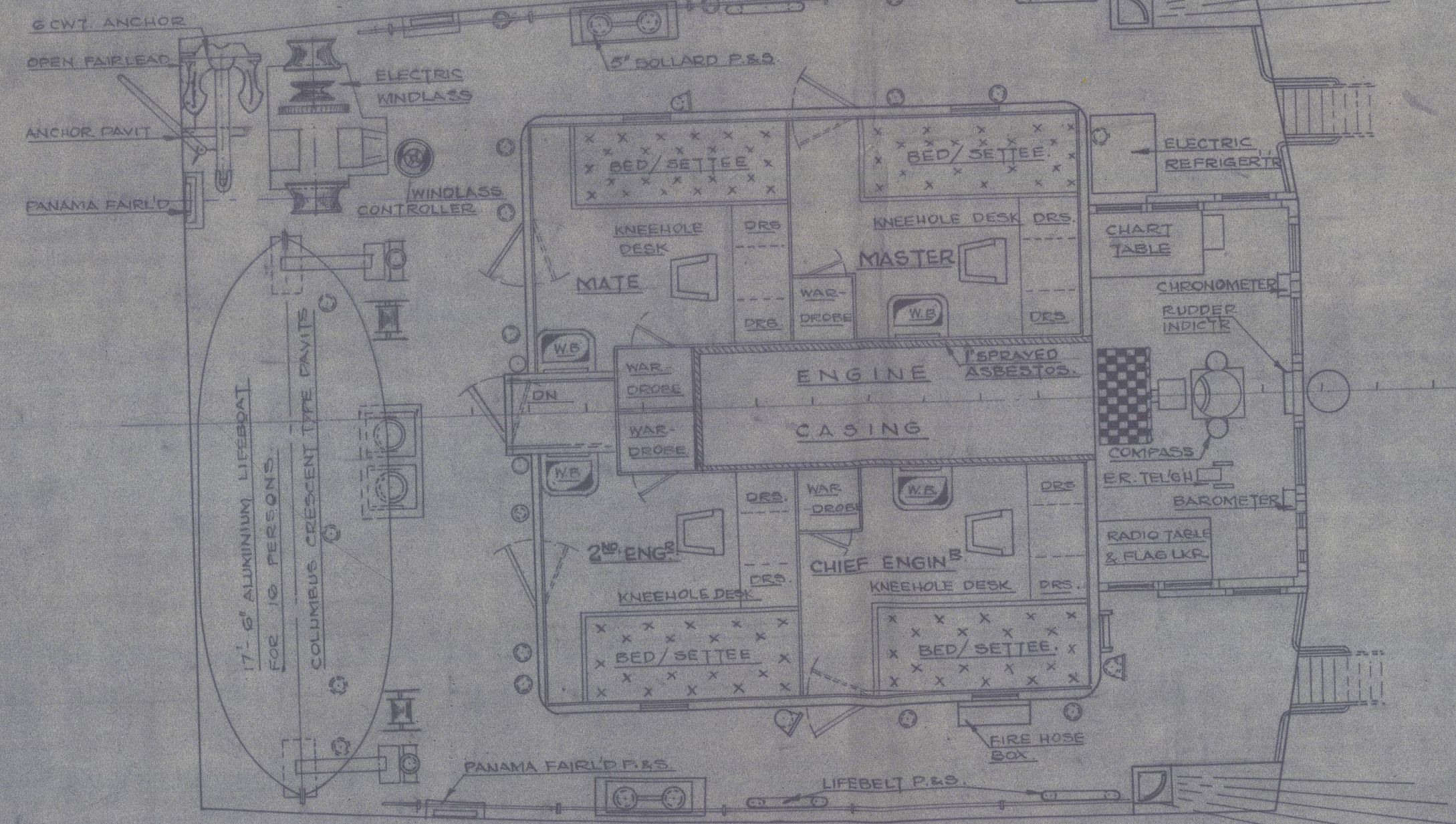

POOP DECK.

TWEEN DECK HEIGHT 7'-0"
 WINDOWS RAINWATER TYPE
 1/4" SPRAYED UNIPET ASPHALT UNDER DECK

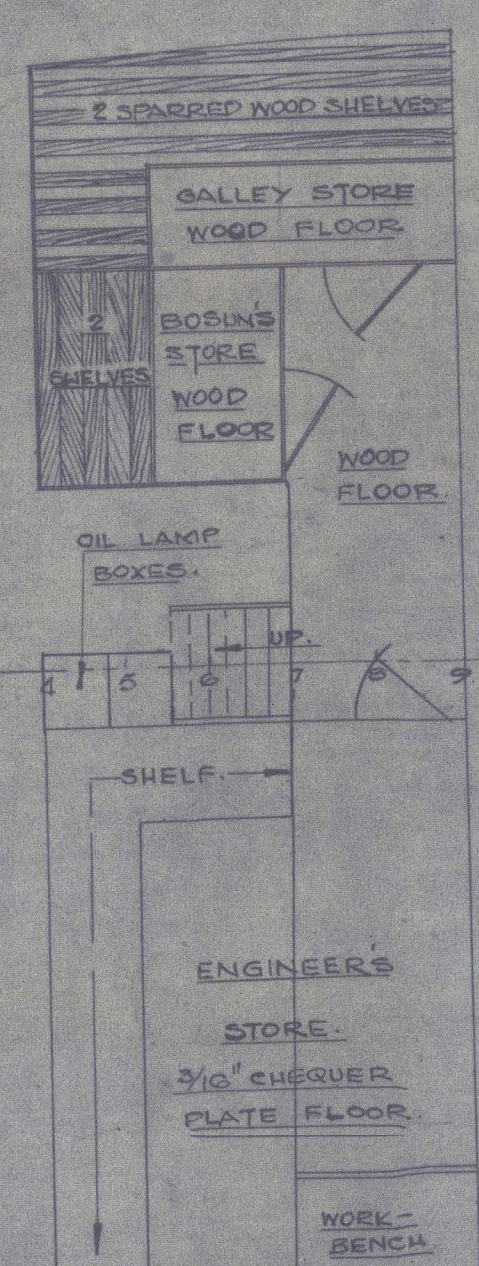

STORES
 BELOW MAIN DECK.

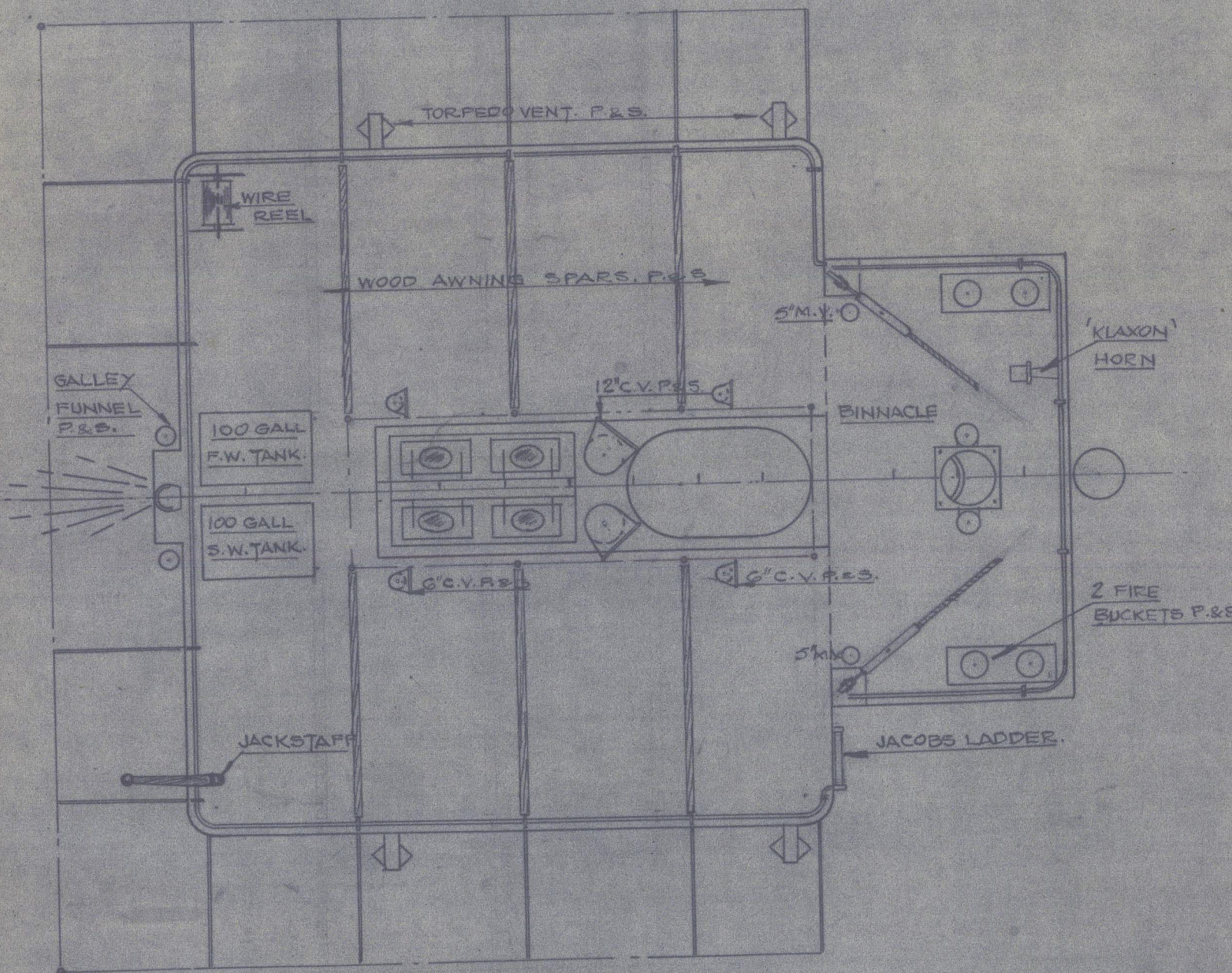

WHEELHOUSE TOP.

BUILT BY :- CLELANDS (SUCCESSORS) LTD.
 WALLSEND - ON - TYNE.

N^{os} 206 - 207 - 209

GENERAL ARRANGEMENT
AS FITTED

CLELANDS (SUCCESSORS) LTD.

'GIMADA'

Newcastle upon Tyne

Report No. II2732

YARD no. 206

RECORDS DEPT.
LONDON.

2

'GEBOSO'

Newcastle upon Tyne

Report No. II2733

YARD no. 207

RETAIN



© 2021

Lloyd's Register
Foundation

012553-012563-0101