

PARTICULARS OF PROTECTION TO OPENINGS, ETC.

| HATCHWAYS ON FREEBOARD AND SUPERSTRUCTURE DECKS | | | | | | | | | | | | | |
|---|-----|-----------------------|----------------|------------------------------------|------------------------------------|--|---|---------------------------|------------------------------|---------------------------|--------------------------|---|--------|
| Description of Hatchway | ... | ... | No 1. | No 2 | No 3. | No 4. | Cross Bkr H. on Br. Dk | Cross Bkr H. on Up. Dk | Coal Shoot H. on Comp Top | Bkr side Hs on Br. dk. | Bkr side Hs on Up. Dk | Eo Cape Hs on Tramp Top on U. Dk. | |
| Dimensions of Hatchway | ... | ... | 35-3' x 27'-0" | 37-4 1/2' x 27' | 36-9' x 27' | 34-1 1/2' x 27' | 5-10 1/2' x 17' | 6-10 1/2' x 17'-6" | 4-6' x 11-9" | 7-0' x 2-5 1/2' | 2-0' x 2-3' | 24' x 4'-10" | |
| COAMINGS | { | Height above Deck | ... | 3'-6" | 3'-6" | 3'-6" | 3'-6" | 9 x 3 1/2' x 50 | 9.3 1/2' .50 L | 9.3 1/2' x 50 L | 2-6 | 9 x 3 1/2' x 50 | 2-6 |
| | | Thicknes... { Sides | ... | .44 | .44 | .44 | .44 | BA. ON 3" TRUNK | | | .44 | | .44 |
| | | Thicknes... { Ends | ... | .44 | .44 | .44 | .44 | | | | .44 | | .44 |
| | | Stiffeners | ... | 7 x 3 1/2' x 50 | 7.3 1/2' .50 | 7.3 1/2' .50 | 7.3 1/2' .50 | | | | | | |
| Brackets, Stays | ... | 3 @ 24 dia | 3 @ 24 d | 3 @ 24 d | 3 @ 24 d | | | | | ✓ | | | |
| HATCH BEAMS | { | Number | ... | 5. | 5 | 5. | 5 | | | | | | |
| | | Spacing | ... | 5-10 1/2" | 6-3" | 6-1 1/2" | 5-8" | | | | | | |
| | | Scantling and Sketch | ... | 4 Bars 6.3 1/2' .47' 24 x 40 | 4 Bars 6.3 1/2' .47' 25 x 40 | 4 Bars 6.3 1/2' .47' 24 3/4 x 40 | 4 Bars 6.3 1/2' .47' 23 1/2' x 39 | | | | | | |
| | | Bearing Surface | ... | 3 1/2" | 3 1/2" | 3 1/2" | 3 | | | | | | |
| FORE AND AFTERS | { | Number | ... | | | | | | | | | | |
| | | Spacing | ... | | | | | | | | | | |
| | | Unsupported Lengths | ... | | | | | | | | | | |
| | | Scantling* and Sketch | ... | | | | | | | | | | |
| Bearing Surface | ... | | | | | | | | | | | | |
| HATCH COVERS | { | Material | ... | W.P. ✓ | WP ✓ | WP ✓ | WP ✓ | W.P. ✓ | W.P. ✓ | W.P. ✓ | W.P. ✓ | Permanently attached hinged steel covers Secured with ✓ | W.P. ✓ |
| | | Thickness... | ... | 3 ✓ | 3 1/4 ✓ | 3. ✓ | 3 ✓ | 2 1/2 ✓ | 2 1/2 ✓ | 2 1/2 ✓ | 2 1/2 ✓ | | 2 1/2 |
| | | How fitted | ... | To a ✓ | To a ✓ | To a ✓ | To a ✓ | To a ✓ | To a ✓ | To a ✓ | athw'd ✓ | | Solid |
| | | Bearing Surface | ... | 3 ✓ | 3 ✓ | 3 ✓ | 3 ✓ | 3. ✓ | 3 ✓ | 3. ✓ | 3. ✓ | | 3. |
| Spacing of Cleats | ... | ... | 24" | 26" | 24" | 26" | 30" | 20. | 19 | 20. | Toggles | 22 | |
| Number of Tarpaulins | ... | ... | 2 | 2 | 2 | 2 | 2 | 2 | 2. | 2 | 12" apart. | 2 | |
| *Are wood fore and afters steel shod at all bearing surfaces? ✓ | | | | | | | | | | | | | |
| Are battens and wedges efficient and in good condition? yes ✓ | | | | | | | | | | | | | |
| Are tarpaulins in good condition and in accordance with rule requirements? yes ✓ | | | | | | | | | | | | | |
| Are lashings provided in accordance with rule requirements? lashing bars fitted ✓ | | | | | | | | | | | | | |

Particulars of fiddley, funnel and ventilator coamings :—

Fidley gratings are fixed with hinged steel covers ✓
 Engine Room Skylight is of steel. 6 flaps with 24 inch eyes each (1 broken)
 Gallery skylight of wood in good condition ✓
 Ventilators on Fidley top & stove funnels are in good order ✓

Particulars of Flush Bunker Scuttles:—

None ✓

Particulars of Companionways :—

One on Poop & Crew Quarters of Strong Construction
5-10 high 4-3 x 1-11. Door (in helms) 4-3 x 2-4 x 1/2 Solid teak
16" to sill above wood deck
1 Side light. no dead light. ✓

Particulars of Ventilators in exposed positions on freeboard and superstructure decks :—

Particulars of Ventilators in exposed positions on freeboard and superstructure decks:—

| | |
|---|---|
| On fore well deck one 18" dia 36 x 4 coaming led to fore hold | one 6" Vent on fore head 36 x 4 coaming to peak str |
| " " " " 48 x 4 " " " " | On Poop one 6" vent to crew galley (macassar) |
| " " " " " " " " | " " " 8" stove pipe " " do |
| " fore trunk one vent 18" dia x 36 x 4. " " " " | On Bridge 2 vents to E.R. 9" dia x 30 x 4 |
| " after well deck one 18" " x 36 x 4 " " aft hold | " " " 4 " to Bunkers 9" dia x 30 x 4 |
| " " " " " 48 x 4 " " " " | |
| " after trunk one 18" dia x 36 x 4 " " " " | |
| " well deck on 6" dia x 36 x 4 to tunnel | |

1st Successfully supported

Plugs & covers ~~started~~ ~~on~~ on Board. Vents to break

Particulars of Air Pipes in exposed positions on freeboard, raised quarter, or superstructure decks:—

Particulars of Air Pipes in exposed positions on freeboard, raised quarter, or superstructure decks:—

| | | | | | | |
|-----------------------|------|---------|---------------|------------------|----------------------|--|
| On Fore deck one | 2½" | W.1. | 27" to aft. | 30" to head | led to fore peak ✓ | on Peak to aft peak Two 4½" W.1. 6" to aft 11" |
| " " " Two | 4" | W.1. | 6" - - - | 12" - - - | " to " " ✓ | |
| On fore well - | 3" | W.1. | 30" - - - | 36" ✓ - - - | } 2s 2nd COB Tanks ✓ | |
| " " " " | 3" | W.1. | 20" - - - | 34" ✓ - - - | | |
| " Br. deck four | 3" | W.1. | 25" - - - | 29" - - - | } midship do do ✓ | |
| On aft well deck Two. | W.1. | 3" dia. | 3'-8" to aft. | } to aft. Tank ✓ | } to aft hold Tanks | |
| " " " " | " | W.1. | 3" - - - | | | 2'-10" - - - |
| " " " " | " | W.1. | 3" - - - | 2'-6" ✓ - - - | | } 36" to head. ? |
| " " " " | " | W.1. | 4" - - - | 2'-10" - - - | | |

Particulars of Gangway Cargo and Coaling Ports:—

x 36" diam. hole drilled in water board

wood
20" / plugs - covers fitted
to air pipes

Particulars of Gangway Cargo and Coaling Ports:—

None

all Hatfield
der Fele
-6 x 2 -6
x 6/20. L
W.P.
overs
"B. Surface
ats 16"
overs ✓

Particulars of Side Scuttles:

In ports all side scuttles have strong permanently attached deadlights ✓
 1 Scuttle in ports companion. no deadlights ✓ ~~3 Broken glass~~
 Side lights in Saloon House fixed with deadlights except in Bath rooms
 No Deadlights fixed to side lights in officers & Engineer sidehouse or
 Bridge deck ✓

Particulars of Guard Rails :—

Forecastle 2 rods 18" x 36" high 5 timbers 4'-8" apart ✓
 Port " " " " " 4'-4" " ✓
 Across end Bridge (aft) 18" x 36" high " 4'-6" " ✓

Particulars of Gangways, Lifelines, etc. :—

~~non fixed no provision made~~

A gangway and line fitted in each well for the use of the crew across the top of the hatchway.

State position of each freeing port
(F. and A. position and height ab

| | Length of Bulwark | Height of Bulwark | Size of Freeing Ports | Number each side | Area each side | Rule area each side |
|---------------------|-------------------|-------------------|--|------------------|----------------|---------------------|
| After Well | 100 - 6 ✓ | 3 - 5½ ✓ | 1 st 13-8 2 nd 12-0 } × 7 | 3. | 21.8 ✓ | 20.1 ✓ |
| Forward Well | 97 - 2 ✓ | 3 - 7. ✓ | 2 F. 11-10 1. A. 15-3 } × 7 | 3. | 22.6 ✓ | 19.4 ✓ |

State position of each freeing port.

State whether the freeing ports are fitted with sh

} After Well:— From Br end. bhd. 9-4: 80 g. ft. to Ford ends. } all "above etc ✓
 } Forward Well:— From Ford 14', 45', 72' to Ford ends. }
 ters, bars, or rails, and give particulars of such:—
 Bridge Bx Banks 67-0 x 2-10. no wash ports. open both ends ✓

| | | |
|--|-----|-----|
| Trunk, Forward | ... | ... |
| Exposed Machinery Casings on Free- | ... | ... |
| board or Raised Quarter Decks | ... | ... |
| Exposed Machinery Casings on Super- | ... | ... |
| structure Decks | ... | ... |
| Machinery Casings within Superstructures | ... | ... |
| not fitted with Class I Closing | ... | ... |
| Appliances | ... | ... |

| | Coaming | Plating | Stiffeners | Spacing | End Attachments of Stiffeners | Size of Openings | Height of Sills | Height of Casings |
|--|---------|---------|-------------------------------|-------------|-------------------------------|--|-----------------|-------------------|
| Poop Bulkhead | 30 ✓ | 30 ✓ | 4 1/2 - 3. 30 ✓ | 26 to 39. ✓ | lugged T & B. ✓ | none except h self contains Wts. 2-0 x 4-7 ✓ | 1-6. ✓ | 7-0 ✓ |
| Raised Quarter Deck Bulkhead ... | | | | | | | | |
| Bridge, After Bulkhead | 20 ✓ | 30. ✓ | 3-3. 26. 0A 5 3/4 Hanger ✓ | 2-9 1/2 ✓ | none ✓ | Two 4-0 x 3-0 ✓ | 1-6 ✓ | 7-0 ✓ |
| Bridge, Forward Bulkhead | 36 ✓ | 36. ✓ | 7 1/2 x 3 x 1/20 L ✓ | 2-5. ✓ | lugs T & B ✓ | Two 4-0 x 2-6 ✓ | 1-8 ✓ | 7-0 ✓ |
| Forecastle Bulkhead | 20 ✓ | 20 ✓ | Long P Bhs ✓ | 2-3. ✓ | Bhs bars ✓ | Two 4-3 x 3-0 ✓ | 1-6 ✓ | 7-0 ✓ |
| Trunk, Aft | | | | | | | | |
| Trunk, Forward | | | | | | | | |
| Exposed Machinery Casings on Free- board or Raised Quarter Decks ... | | | | | | | | |
| Exposed Machinery Casings on Super- structure Decks | 30 ✓ | 30 ✓ | 2 1/2 - 3. 1/20 A ✓ | 3-0 ✓ | none ✓ | 4-6 x 22. 5 ^{PL} ✓ | 18. ✓ | 7-3 ✓ |
| Machinery Casings within Superstruc- tures not fitted with Class I Closing Appliances | | | | | | | | |
| Deckhouses on Flush Deck Ships ... | | | | | | | | |

| | | | |
|---|-----|-----|-----|
| Poop Bulkhead | ... | ... | ... |
| Raised Quarter Deck Bulkhead | ... | ... | ... |
| Bridge, After Bulkhead | ... | ... | ... |
| Bridge, Forward Bulkhead | ... | ... | ... |
| Forecastle Bulkhead | ... | ... | ... |
| Exposed Machinery Casings on Free-board or Raised Quarter Decks | ... | ... | ... |
| Exposed Machinery Casings on Superstructure Decks | ... | ... | ... |
| Machinery Casings within Superstructures not fitted with Class I Closing Appliances | ... | ... | ... |
| Deckhouses on Flush Deck Ships | ... | ... | ... |

No opening in Prop. front proper. ✓ Hinged door to W.C's

2 Bolted steel plates with hook bolts @ 9" center ✓
2 Bolted steel plate with top bolts through plating 4" apart ✓
Tonnage opening P&S. 3" weather boards in Ratchet chamber full height ✓
✓
Ordinary steel hinged fully casing doors operated with Sides ✓

Greathope

Superstructure bulkheads, trunks, deckhouses, casings, cargo and coaling hatchways, extent and thickness of sheathing on the freeboard deck, gangway, cargo and coaling ports, and any other openings, etc., which would affect the seaworthiness of the ship are to be shown on the following sketches:—

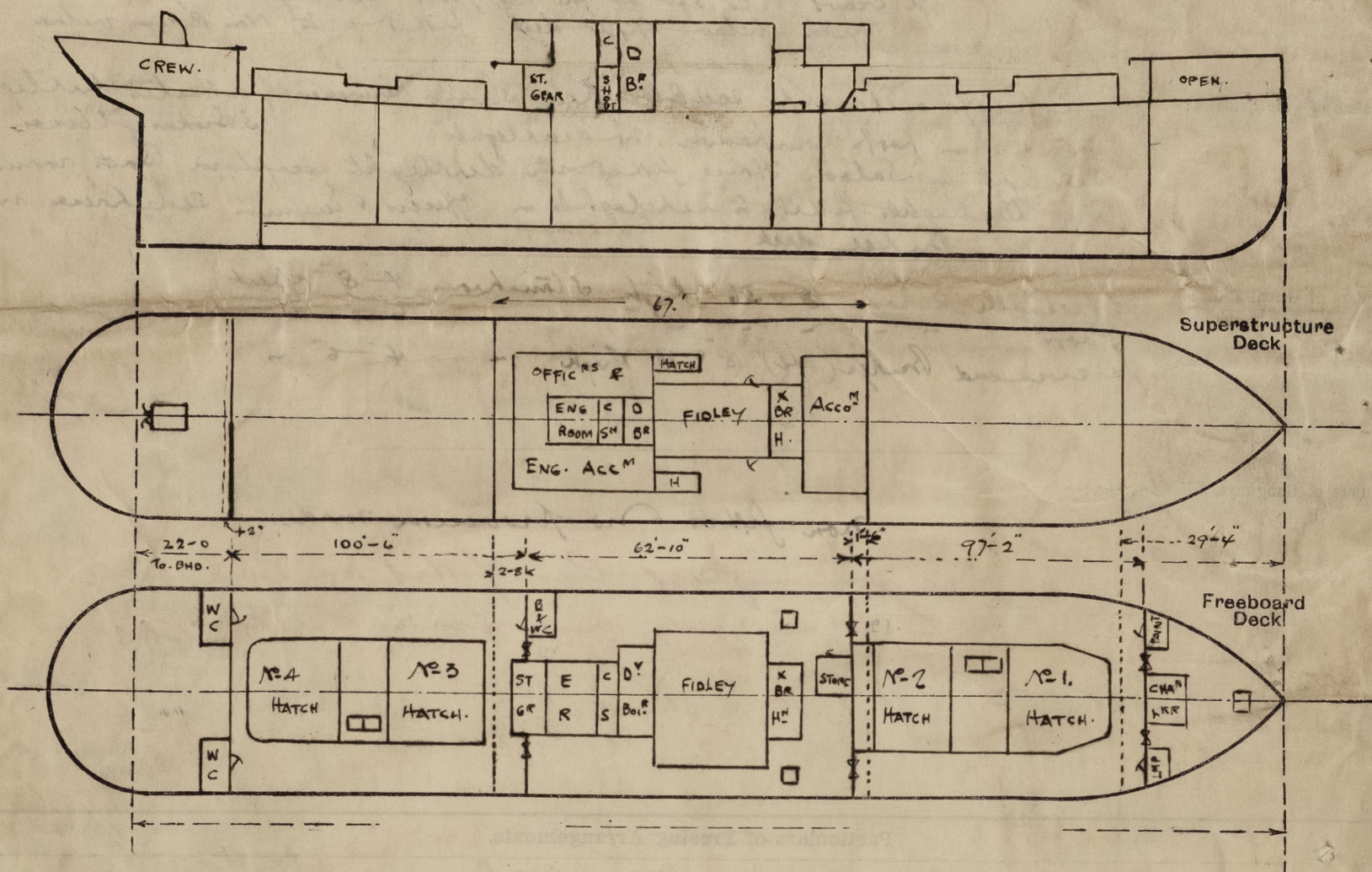

State any special features in the construction of the ship.

no information available for displacements or tons per inch

Out

| Height of Cargo | Height of Deck | Size of Opening | Red Alignment of Bulkheads | Spacing | Height | Width | Area |
|--------------------|-------------------|-----------------|-------------------------------|-----------|-----------|-----------|-----------|
| 0-7 | 1-2 | 10' x 10' | 10' x 10' | 10' x 10' | 10' x 10' | 10' x 10' | 10' x 10' |
| 0-7 | 1-2 | 10' x 10' | 10' x 10' | 10' x 10' | 10' x 10' | 10' x 10' | 10' x 10' |
| 0-7 | 1-2 | 10' x 10' | 10' x 10' | 10' x 10' | 10' x 10' | 10' x 10' | 10' x 10' |
| 0-7 | 1-2 | 10' x 10' | 10' x 10' | 10' x 10' | 10' x 10' | 10' x 10' | 10' x 10' |

Builder's name and yard number

Burntisland S. B. Co. Ltd. S/S No 137.

Names of sister ships

Owners

Newbiggin S/S. Co. Ltd.

Fee £

10. 4. 0

Received by me

APPLIED FOR 19 APR 1932



© 2021

Lloyd's Register
Foundation