

Bovenaanzicht Dubbele bodem

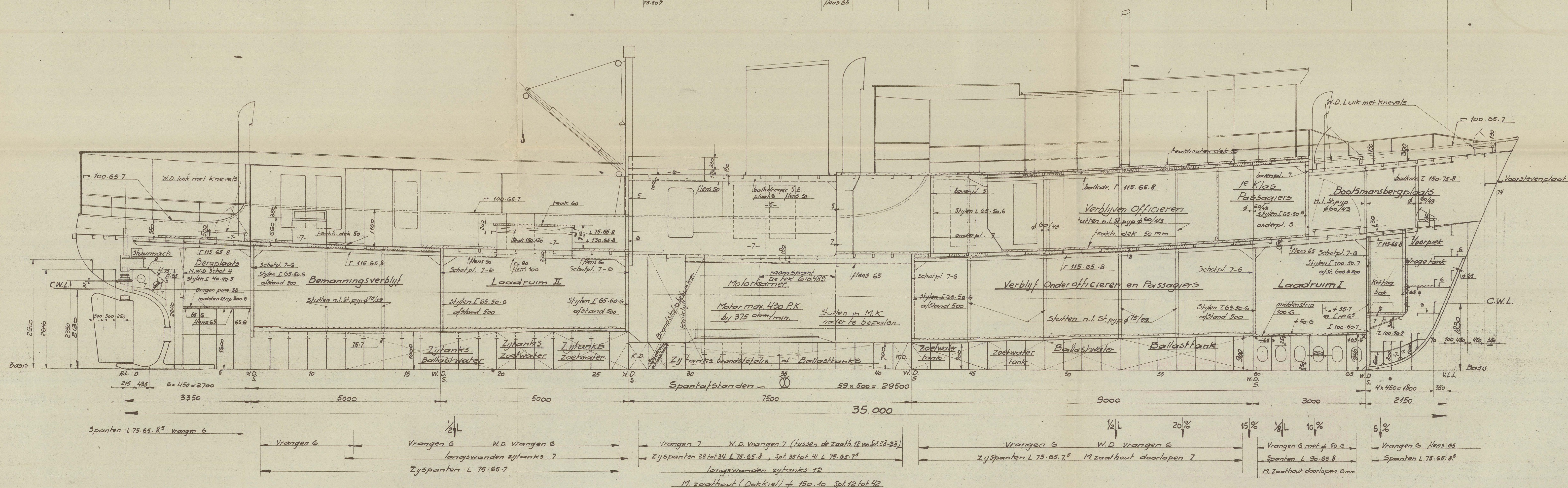
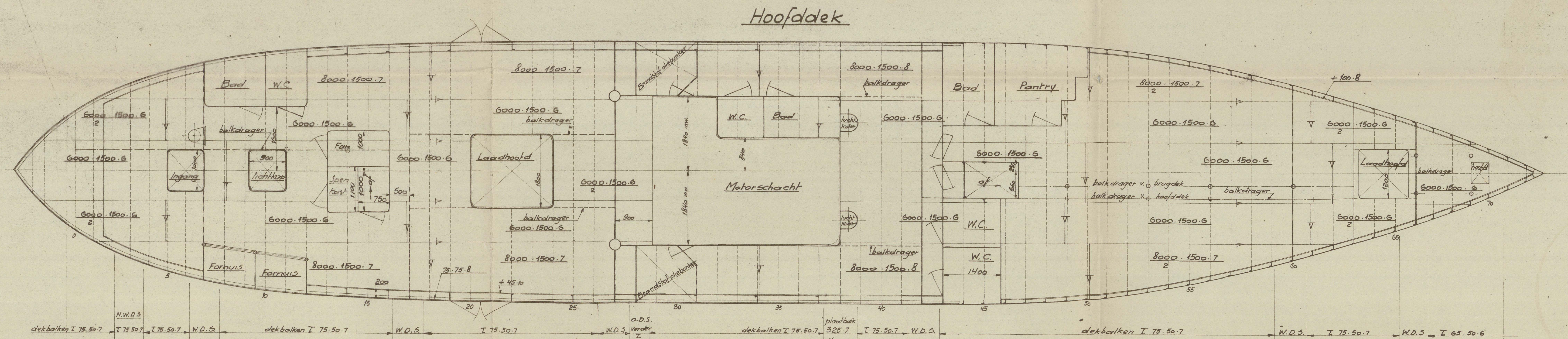
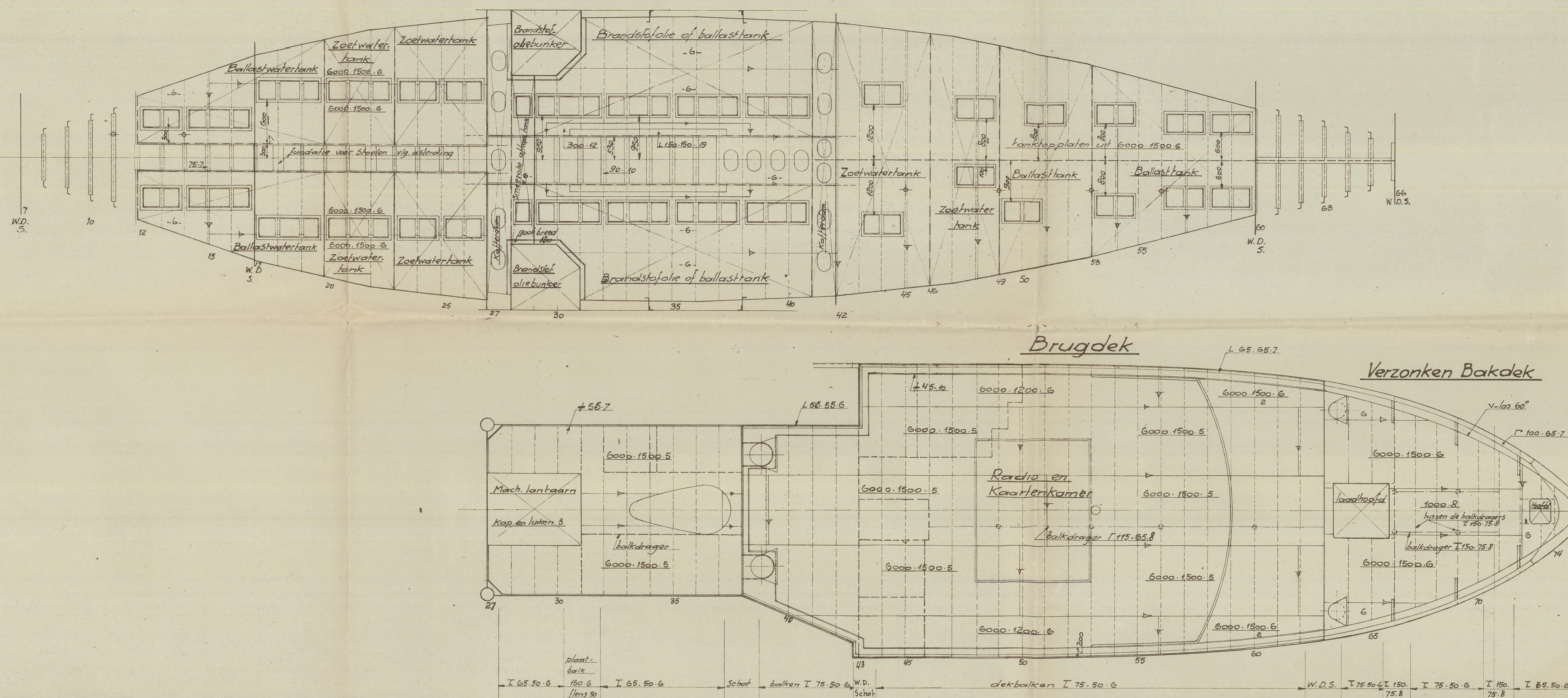

N.B. De afmetingen der Spanten zijn de minimum maten volgens Lloyds

For service in the Indonesian Archipelago

Hoofdafmetingen

Breedte op buitenk. Spt. 6.50 " = 21.33'

Holte tot Brugdek 5.05" = 16,56'

Gemidd. diepg. maximaal (^{boven} _{daals}) 1.98 M = 6.54'

Schaal 1:50

Equipment Number

$$\begin{aligned} E &= L(B+D) + 0.75 \cdot l \cdot h (\text{Brug en Bak}) + 0.50 \cdot l \cdot h (\text{Motorschacht}) = \\ &= 114.83 (21.33 + 9.66) + 0.75 \times \frac{13 \times 2.1}{0.305} + 0.5 \times \frac{8.5 \times 2.1}{0.305} = \\ &= 114.83 (30.99) + \frac{20.4 \times 8.9}{0.305} = 3559 + \frac{29.3}{0.305} = 3559 + 324 = 3883 \text{ ft.}^2 \end{aligned}$$

Volgens bestek

2 Stokloze patentankers elk 270 kg

1 Stroomanker van 90kg excl. Stok

2 x 125 M damanketketting 21mm
1 2" Flexible Steel-h... (1 10) 1 82.5 M

7-C Flexibele Staaldraad (6x12) lang 82,5 M

Volgens Lloyd's 75 vadem G" hennep of 2 1/4" staaldraad

[illegible]

012431-012438-0362

Construction plans.

'BARAU'



RECORDS DEPT.
LONDON

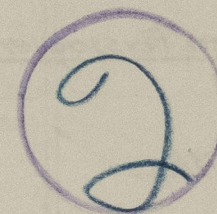

BELONGS TO GRONINGEN Rpt No. 072 a.
VESSEL'S NAME. "Barau"?

GRONINGEN:	12/10-33
SHIP:	"Barau"
YARD:	Bredene Schipwerf
YARD NUMBER:	401.
NUMBER C. 11 REPORT:	050.
NUMBER FIRST ENTRY & DATE:	072
SISTER VESSEL:	"Becken" etc. (A'dam photo)
DEVIATIONS FROM APPROVED PLANS?	none

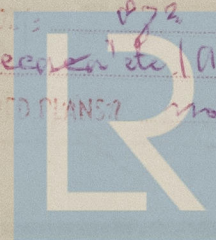

© 2021

Lloyd's Register
Foundation

012431-012438-0362