

S.T. MEITAI-MARU

CAPACITY PLAN & DEADWEIGHT SCALE

SCALE 1/200

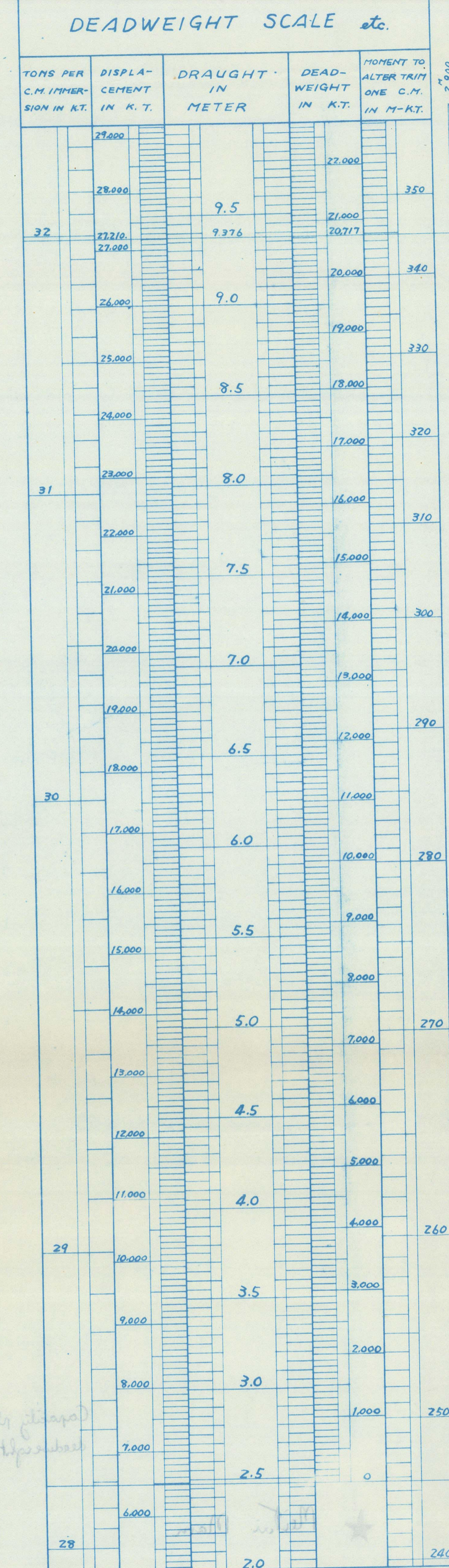

TOP OF WATER LINE STRONGER

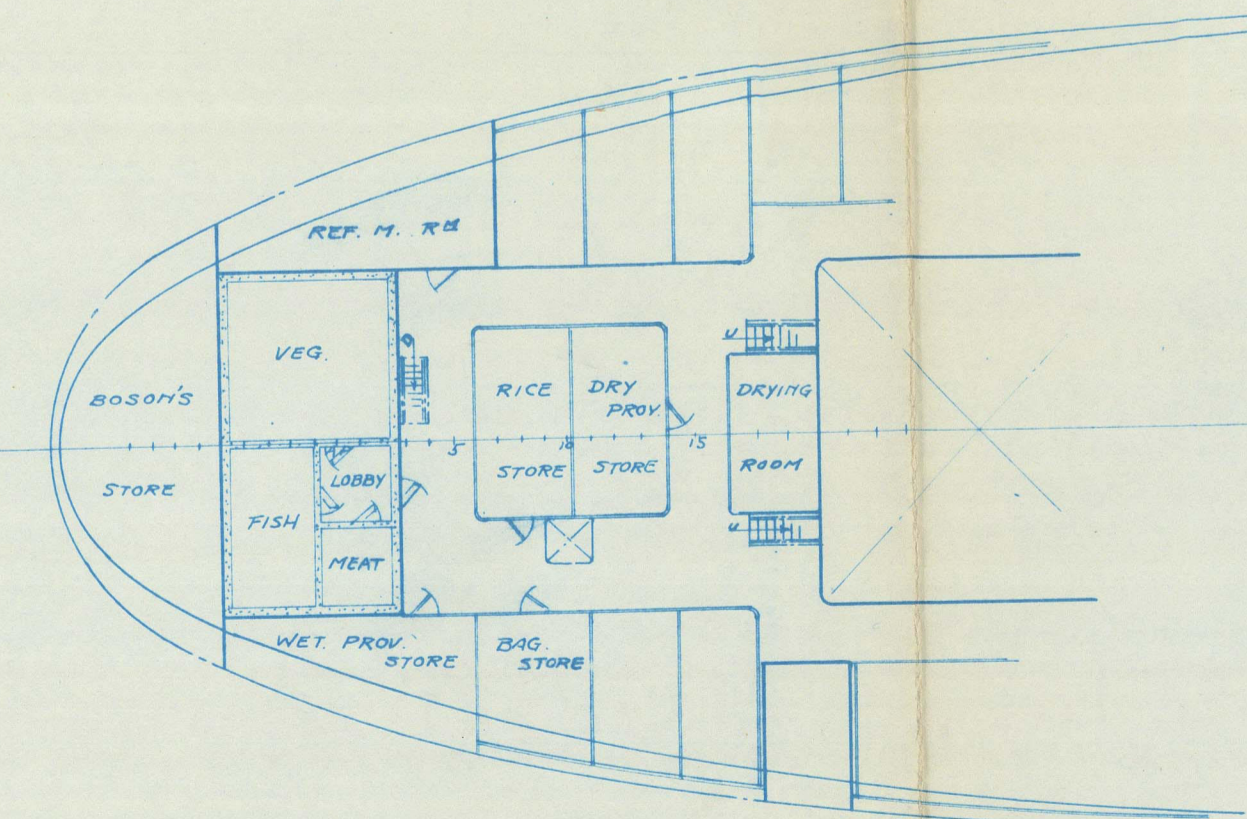
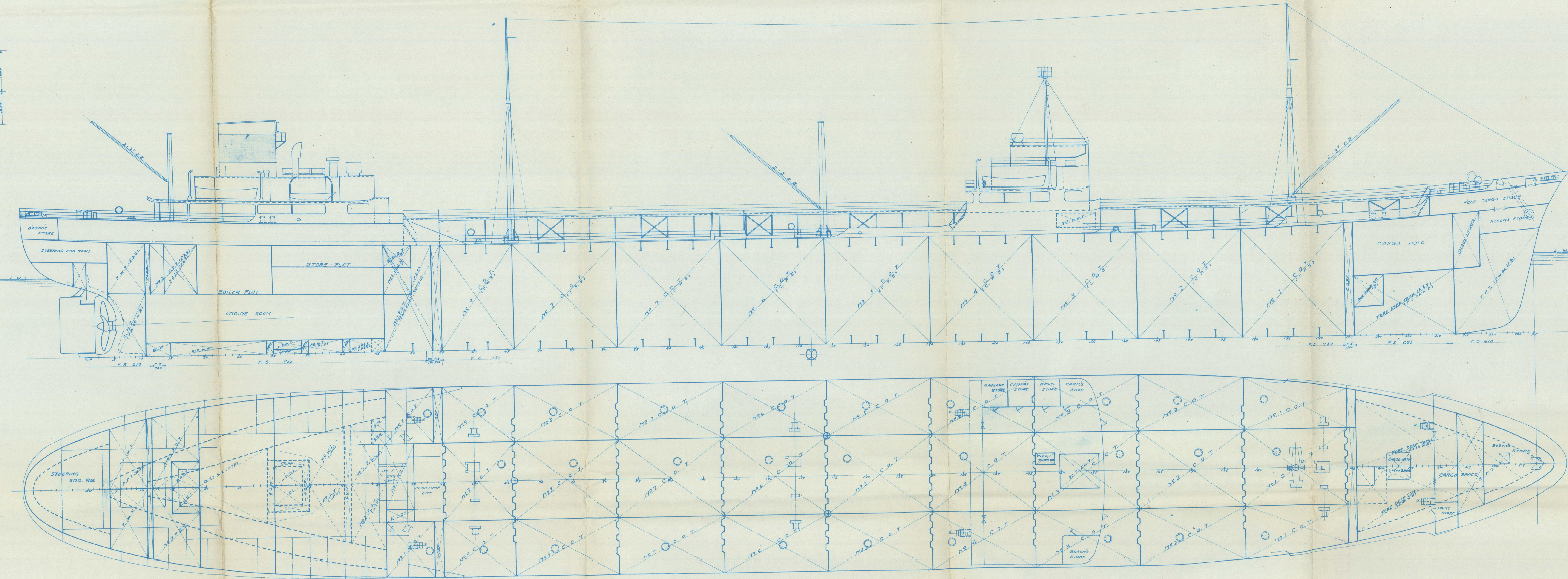
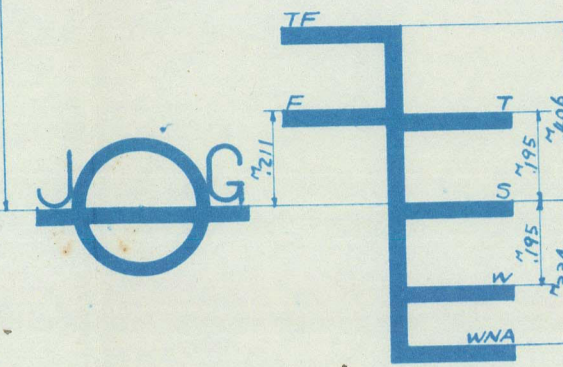
LIGHT 2475
1493.00

PRINCIPAL DIMENSIONS

LENGTH OVER ALL	178'00"
BETWEEN PERPENDICULARS	167'00"
BREADTH MOULDED	22'00"
DEPTH	12'00"
LOADED DRAUGHT	9'37"
DISPLACEMENT TO SUMMER C.W.L.	27,210.00
LIGHT DISPLACEMENT	6,493.00
DEAD WEIGHT	20,717.00

TONNAGE			
REGISTERED	11,891.28	GROSS	12,782.28
NET	9,552.53		
MEASUREMENT	11,891.28	GROSS	12,782.28
NET	9,552.53		

CAPACITY OF PROVISION STORE			
NAME OF STORE	LOCATION	FRONT	CUBIC METERS
RICE STORE	C	10' x 10'	29.71
DRY PROV. STORE	C	10' x 10'	29.71
WET PROV. STORE	C	10' x 10'	29.71
TOTAL			89.13

CAPACITY OF REFRIGERATING CHAMBER			
NAME OF STORE	LOCATION	FRONT	CUBIC METERS
VEGETABLE	A	5' x 10'	36.37
FISH	S	5' x 10'	36.37
MEAT	S	5' x 10'	36.37
LOBBY	S	5' x 10'	36.37
TOTAL			145.51

CAPACITY OF CARGO SPACE (GRAIN)			
NAME OF CARGO SPACE	FRONT	DECK	CUBIC METERS
FORE CARGO SPACE	247.34	77.29	15.36
CARGO HOLD	194.213	97.44	10.48
TOTAL			260.78

CAPACITY OF CARGO SPACE (BALD)			
NAME OF CARGO SPACE	FRONT	DECK	CUBIC METERS
FORE CARGO SPACE	247.34	77.29	15.36
CARGO HOLD	194.213	97.44	10.48
TOTAL			260.78

MACHINERY			
MAIN ENGINE			
ONE SET OF S.T. BERNARDI REDUCTION GEARED IMPULSE TURBINE MANUFACTURED BY KAWASAKI DOCK YARD			
MAX. CONTINUOUS POWER 2,000 H.P. @ 1,500 R.P.M.			
MAIN BOILERS			
TWO SETS OF B.O.B. TYPE DRUM, BUILT TUBE FORCED DRAUGHT OIL BURNING BOILER, MANUFACTURED BY KAWASAKI DOCK YARD			
MAIN GENERATORS			
TWO SETS OF 250 K.W. D.C. TURBO GENERATOR			
PROPELLER			
SINGLE SCREW, FOUR BLADE, SUBMERGED TYPE, DIA. 12'0"			
CARGO PUMPS			
THREE HORIZONTAL CENTRIFUGAL CARGO PUMPS			
TWO SETS OF 1,200 G.P.M. HAND PUMP, TWO SETS OF 1,200 G.P.M. HAND PUMP, TWO SETS OF 1,200 G.P.M. HAND PUMP			
STEERING GEAR			
ONE SET OF KAWASAKI HULL-SWIM TYPE TWO SHAFTS, FOUR CYLINDERS, ELECTRO-HYDRAULIC STEERING GEAR WITH TWO 20 H.P. POWER PUMPS			
FUEL LINE			
MAIN SUCTION PIPES			
SUCTION BRANCHES			
MAIN DELIVERY PIPES			
DELIVERY BRANCHES			
DIRECT FILLING PIPES			
SHORE CONNECTIONS, CARGO OIL			
FOUR LOADING STATIONS			
STEERING			
FUEL OIL FILLING PIPES			
OIL HOSES TO BE USED			

CAPACITY OF FUEL OIL TANKS			
NAME OF TANKS	LOCATION	FRONT	CUBIC METERS
NO. 1 F.O.T.	C	10' x 10'	29.71
NO. 2 F.O.T.	C	10' x 10'	29.71
NO. 3 F.O.T.	C	10' x 10'	29.71
NO. 4 F.O.T.	C	10' x 10'	29.71
NO. 5 F.O.T.	C	10' x 10'	29.71
NO. 6 F.O.T.	C	10' x 10'	29.71
NO. 7 F.O.T.	C	10' x 10'	29.71
NO. 8 F.O.T.	C	10' x 10'	29.71
NO. 9 F.O.T.	C	10' x 10'	29.71
NO. 10 F.O.T.	C	10' x 10'	29.71
TOTAL			297.10

CAPACITY OF LUBRICATING OIL TANKS			
NAME OF TANKS	LOCATION	FRONT	CUBIC METERS
NO. 1 L.O.T.	C	10' x 10'	29.71
NO. 2 L.O.T.	C	10' x 10'	29.71
NO. 3 L.O.T.	C	10' x 10'	29.71
NO. 4 L.O.T.	C	10' x 10'	29.71
NO. 5 L.O.T.	C	10' x 10'	29.71
NO. 6 L.O.T.	C	10' x 10'	29.71
NO. 7 L.O.T.	C	10' x 10'	29.71
NO. 8 L.O.T.	C	10' x 10'	29.71
NO. 9 L.O.T.	C	10' x 10'	29.71
NO. 10 L.O.T.	C	10' x 10'	29.71
TOTAL			297.10

CAPACITY OF COFFERDAM			
NAME OF TANKS	LOCATION	FRONT	CUBIC METERS
NO. 1 C.D.	C	10' x 10'	29.71
NO. 2 C.D.	C	10' x 10'	29.71
NO. 3 C.D.	C	10' x 10'	29.71
NO. 4 C.D.	C	10' x 10'	29.71
NO. 5 C.D.	C	10' x 10'	29.71
NO. 6 C.D.	C	10' x 10'	29.71
NO. 7 C.D.	C	10' x 10'	29.71
NO. 8 C.D.	C	10' x 10'	29.71
NO. 9 C.D.	C	10' x 10'	29.71
NO. 10 C.D.	C	10' x 10'	29.71
TOTAL			297.10

CAPACITY OF FRESH WATER TANKS			
NAME OF TANKS	LOCATION	FRONT	CUBIC METERS
NO. 1 F.W.T.	C	10' x 10'	29.71
NO. 2 F.W.T.	C	10' x 10'	29.71
NO. 3 F.W.T.	C	10' x 10'	29.71
NO. 4 F.W.T.	C	10' x 10'	29.71
NO. 5 F.W.T.	C	10' x 10'	29.71
NO. 6 F.W.T.	C	10' x 10'	29.71
NO. 7 F.W.T.	C	10' x 10'	29.71
NO. 8 F.W.T.	C	10' x 10'	29.71
NO. 9 F.W.T.	C	10' x 10'	29.71
NO. 10 F.W.T.	C	10' x 10'	29.71
TOTAL			297.10

CAPACITY OF FEED WATER TANKS			
NAME OF TANKS	LOCATION	FRONT	CUBIC METERS
NO. 1 F.W.T.	C	10' x 10'	29.71
NO. 2 F.W.T.	C	10' x 10'	29.71
NO. 3 F.W.T.	C	10' x 10'	29.71
NO. 4 F.W.T.	C	10' x 10'	29.71
NO. 5 F.W.T.	C	10' x 10'	29.71
NO. 6 F.W.T.	C	10' x 10'	29.71
NO. 7 F.W.T.	C	10' x 10'	29.71
NO. 8 F.W.T.	C	10' x 10'	29.71
NO. 9 F.W.T.	C	10' x 10'	29.71
NO. 10 F.W.T.	C	10' x 10'	29.71
TOTAL			297.10

CAPACITY OF BALLAST WATER TANKS			
NAME OF TANKS	LOCATION	FRONT	CUBIC METERS
NO. 1 B.W.T.	C	10' x 10'	29.71
NO. 2 B.W.T.	C	10' x 10'	29.71
NO. 3 B.W.T.	C	10' x 10'	29.71
NO. 4 B.W.T.	C	10' x 10'	29.71
NO. 5 B.W.T.	C	10' x 10'	29.71
NO. 6 B.W.T.	C	10' x 10'	29.71
NO. 7 B.W.T.	C	10' x 10'	29.71
NO. 8 B.W.T.	C	10' x 10'	29.71
NO. 9 B.W.T.	C	10' x 10'	29.71
NO. 10 B.W.T.	C	10' x 10'	29.71
TOTAL			297.10

CAPACITY OF CARGO, OIL TANKS			
NAME OF TANKS	LOCATION	FRONT	CUBIC METERS
NO. 1 C.O.T.	C	10' x 10'	29.71
NO. 2 C.O.T.	C	10' x 10'	29.71
NO. 3 C.O.T.	C	10' x 10'	29.71
NO. 4 C.O.T.	C	10' x 10'	29.71
NO. 5 C.O.T.	C	10' x 10'	29.71
NO. 6 C.O.T.	C	10' x 10'	29.71
NO. 7 C.O.T.	C	10' x 10'	29.71
NO. 8 C.O.T.	C	10' x 10'	29.71
NO. 9 C.O.T.	C	10' x 10'	29.71
NO. 10 C.O.T.	C	10' x 10'	29.71
TOTAL			297.10

KAWASAKI DOCK YARD CO. LTD. KOBE JAPAN
SHIPDESIGNING DEPARTMENT

FINISHED PLAN

MEITAI MARU
TITLECAPACITY PLAN
&
DEADWEIGHT SCALE

SCALE 1/200

KAWASAKI DOCK YARD CO. LTD.
KOBE JAPAN
SHIPDESIGNING DEPARTMENTCHIEF OF DEPARTMENT
CHIEF OF SECTION
CHECKED BY
DRAWN BY
DATE: AUG. 17th 1953

DRAWING NO. A-5

02372-02385-0310

Lloyd's Register
Foundation

Capacity plan +
deadweight scale.

★ Meitai Marn.

RECORDS DEPT.
LONDON

20



© 2021

Lloyd's Register
Foundation

012377 - 012385 - 0310

TO LLOYD'S REGISTER OF SHIPPING



AS FITTED

