

# **No. 1418.** **PLAN OF STEEL DECKS.**

DIMENSIONS:- 460'-0" BP x 59'-0" MLD x 34'-10" MLD

SCALE:- 1/8" = 1 FOOT

No 1373-1383 TO CLASS LLOYD'S A.I. &  
"CARRYING PETROLEUM IN BULK"  
No 1350-1-1392 TO CLASS NVAL "BULK OIL CARRIER"

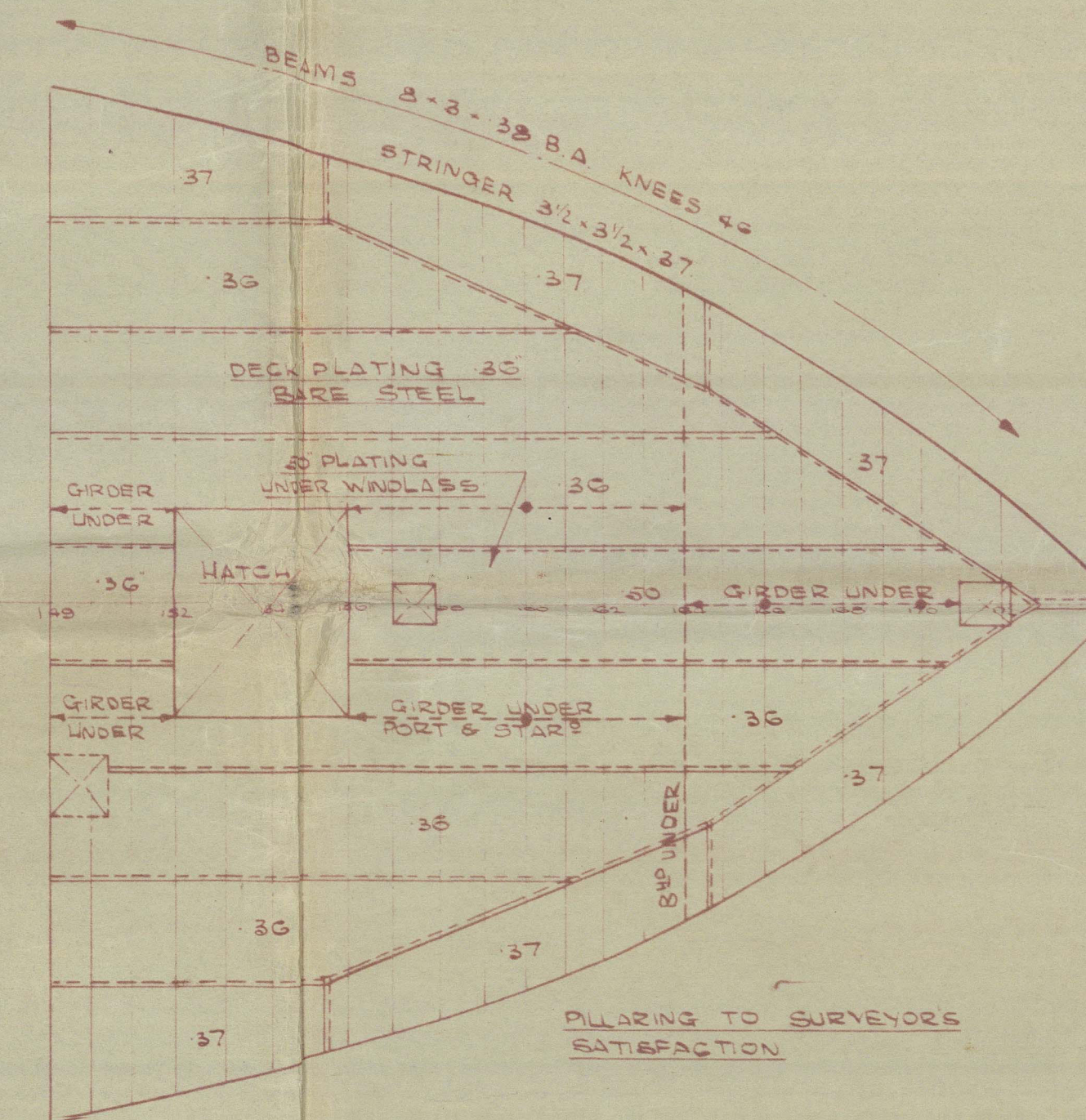
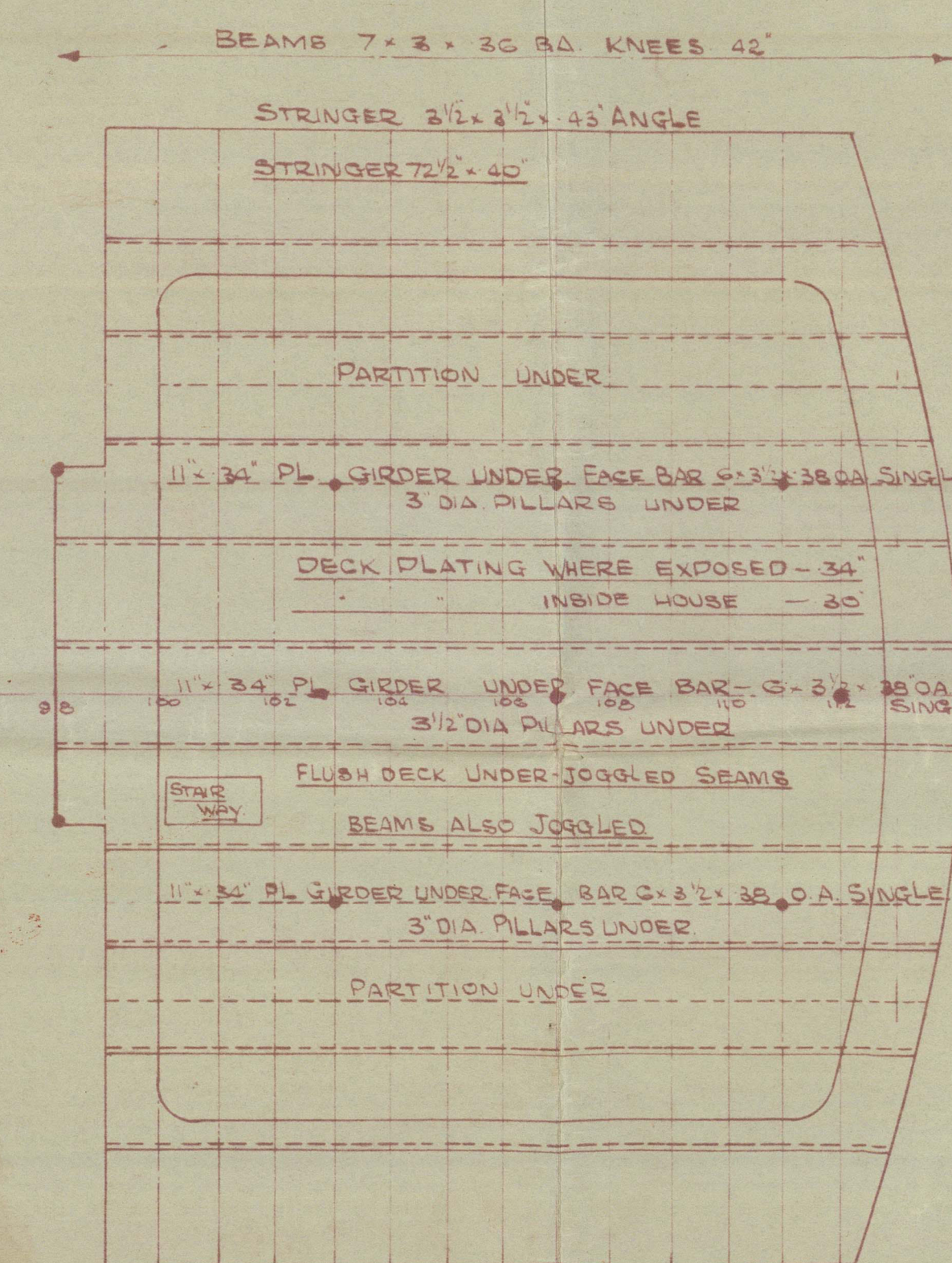

POOP DECK



UPPER DECK

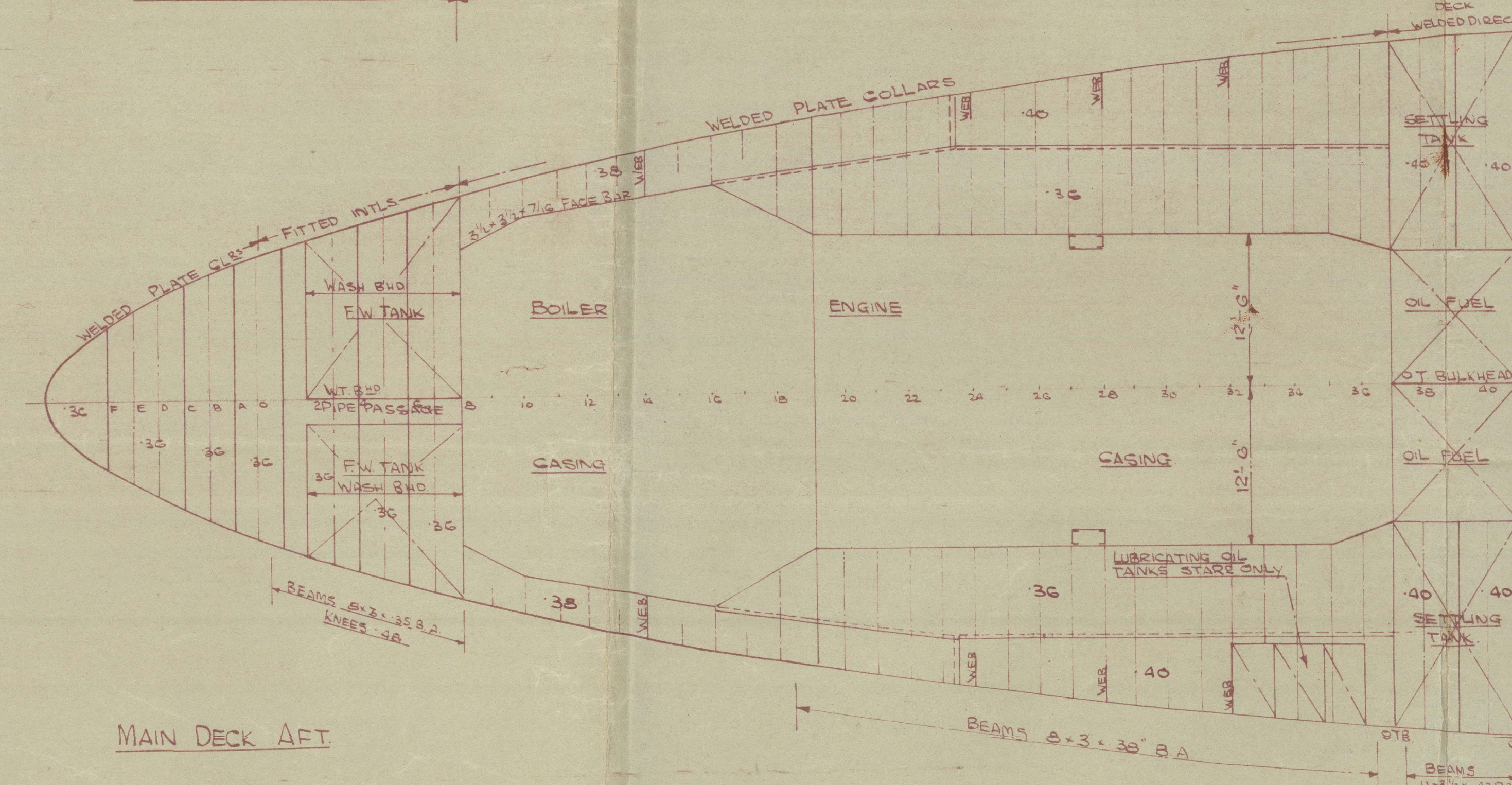

MAIN DECK AFT

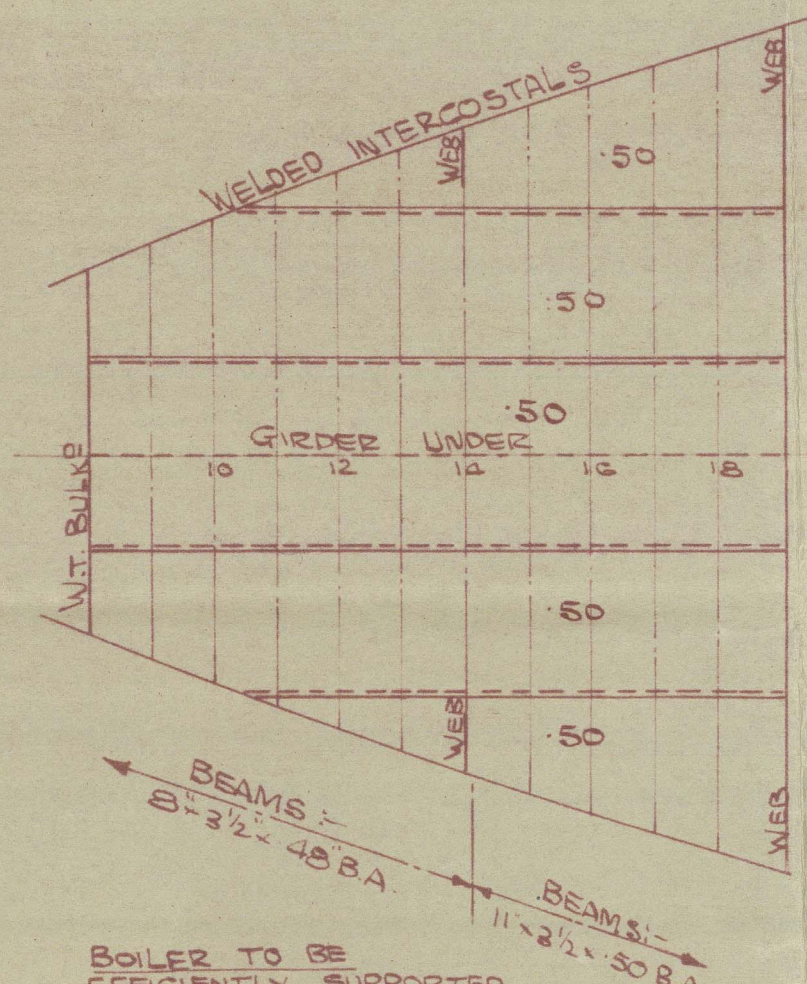

BOILER FLAT

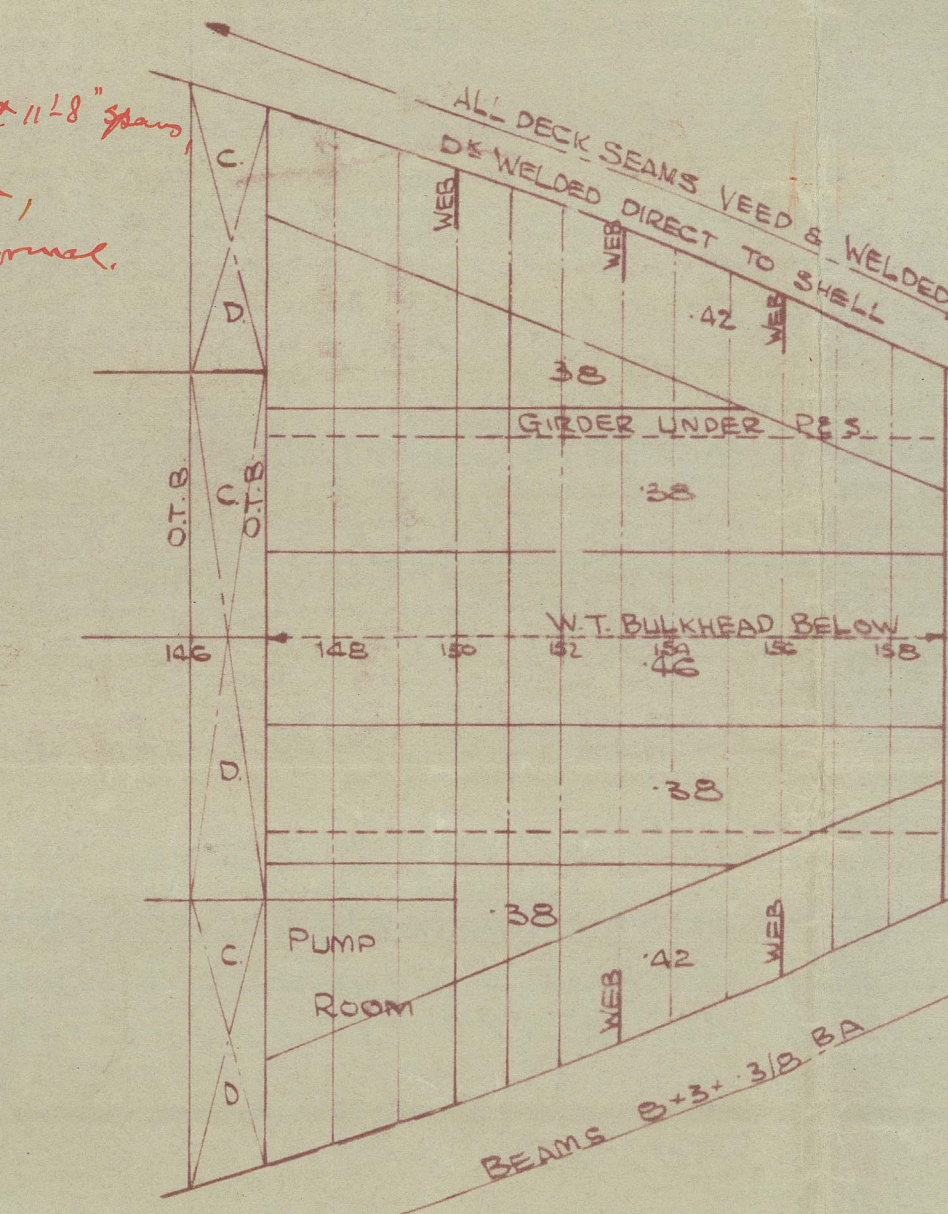

TOP OF DEEP TANK

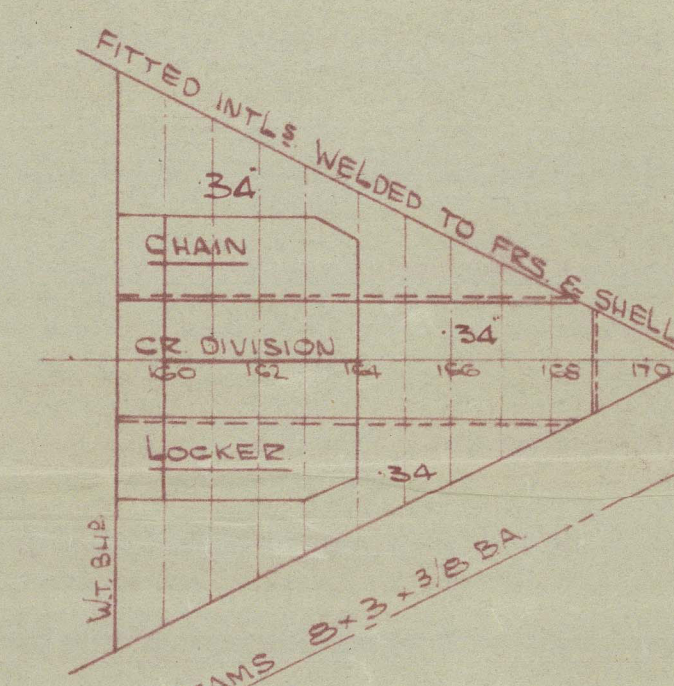

W.T. FLAT

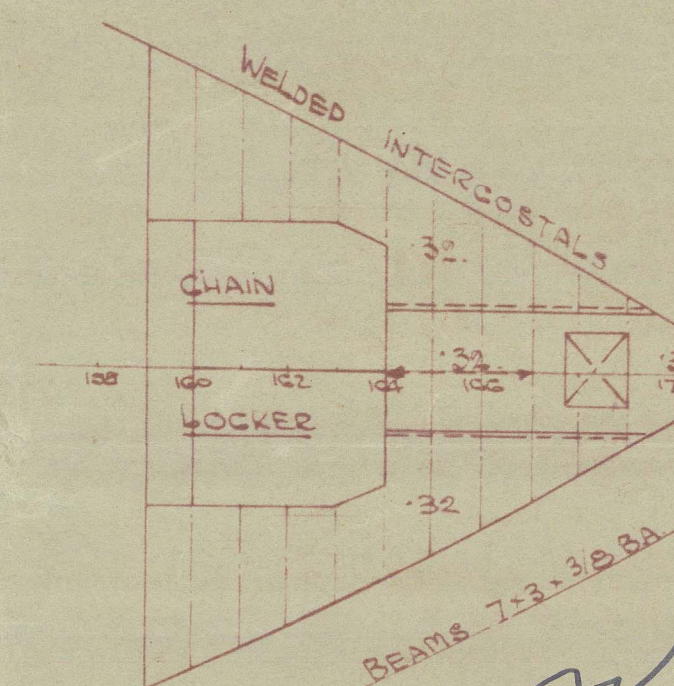

MAIN DECK FORE

2 1/2 x 3/4" BAR FITTED ON THESE LONGITUDINALS FOR EXTENT SHOWN  
CONVERTED TO TRANSVERSE, 2 1/2" x 3/4" BAR CO-2" TO BULKHEAD  
REMAINDER OF BRACKETS TO BE NORMAL  
2nd brackets of all said longitudinal to be 47" (flanges) from transverse bulkhead, 21" x 7/8" at 11' 4" from  
alternatively 4 x 5/8" x 31" web bar fitted to longitudinal marked x. For structural shown,  
connected to transverse, 2" x 40" in bulkhead (10-7 1/2") to bed. Remains of brackets normal.

"As fitted"  
12/11/50  
J. Downer



012370-012376-0154





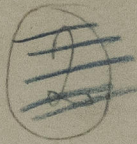

HARLAND & WOLFF LTD.  
BELFAST

No. 1418  
TITLE. *Steel Decks*

DATE APPROVED. *10/12/48*

*"As fitted" 12/12/50*

*Belt Rpt. no. 15109*

*- hagenfield* ★

*Belfast Steel. Report No. F. 133*

RECORDS DEPT..  
LONDON

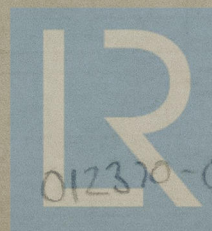
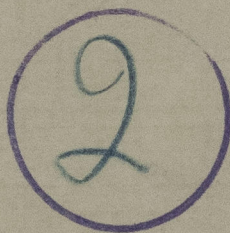

© 2021

Lloyd's Register  
Foundation

012370-012376-0194