

## GENERAL ARRANGEMENT

DIMNS: 100'-0" B.P. x 19'-8" MLD. x 8'-0" MLD.

SCALE:  $\frac{1}{4}" = 1 \text{ FOOT.}$

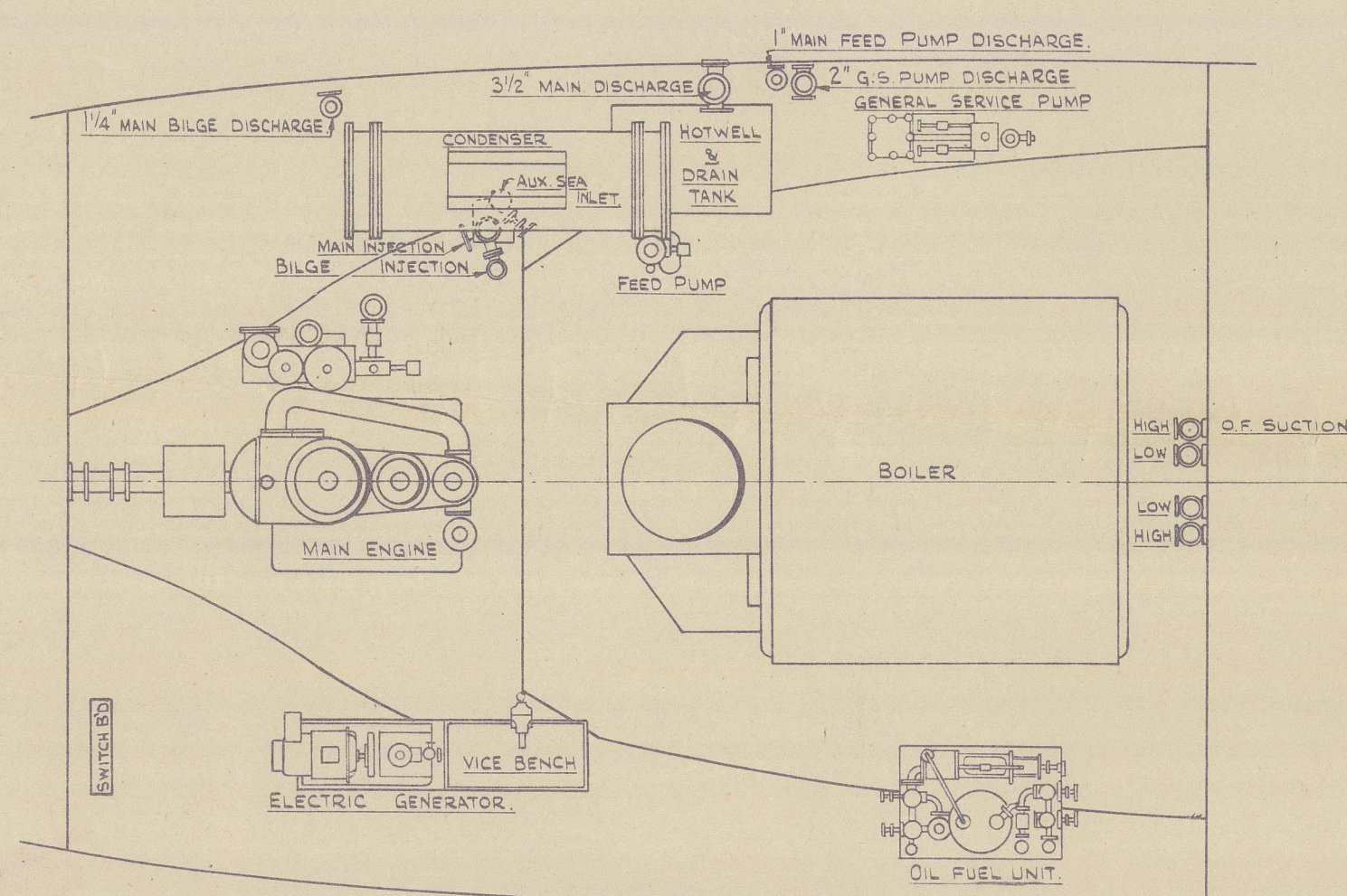

DISPLACEMENT ON 6'-0" LOADED DRAFT. = 239.44 TONS  
LIGHTWEIGHT OF VESSEL MINUS BOILER WATER. = 118.15 TONS  
DEADWEIGHT = 121.29 TONS

<u>DEADWEIGHT CAPACITY.</u>	
BUNKER	18.00 TONS.
FRESH WATER	85 TONS.
LUB OIL	17 TONS.
BOILER WATER	7.00 TONS.
CARGO	95.27 TONS.
	21.29 TONS.

CARGO STOWAGE WHEN 98% FULL

FORD TANK	=	36.04	TONS AT 50 CUBIC FEET.
MIDDLE TANK	=	41.19	TONS " " " "
AFTER TANK	=	41.19	TONS " " " "
TOTAL STOWAGE	=	118.42	TONS " " " "

DISPLACEMENT ON 7'-0" WATER LINE. = 287.26 TONS.  
 LIGHTWEIGHT OF VESSEL MINUS BOILER WATER = 118.15 TONS.  
 DEADWEIGHT = 169.11 TONS.

TONS PER INCH ON 6'-0" WATER LINE. = 4.04 TONS  
" " " " 7'-0" " " = 4.15 TONS

LIGHT DRAUGHT WITHOUT BOILER WATER = 6'-3" AFT. 1'-2" FORD

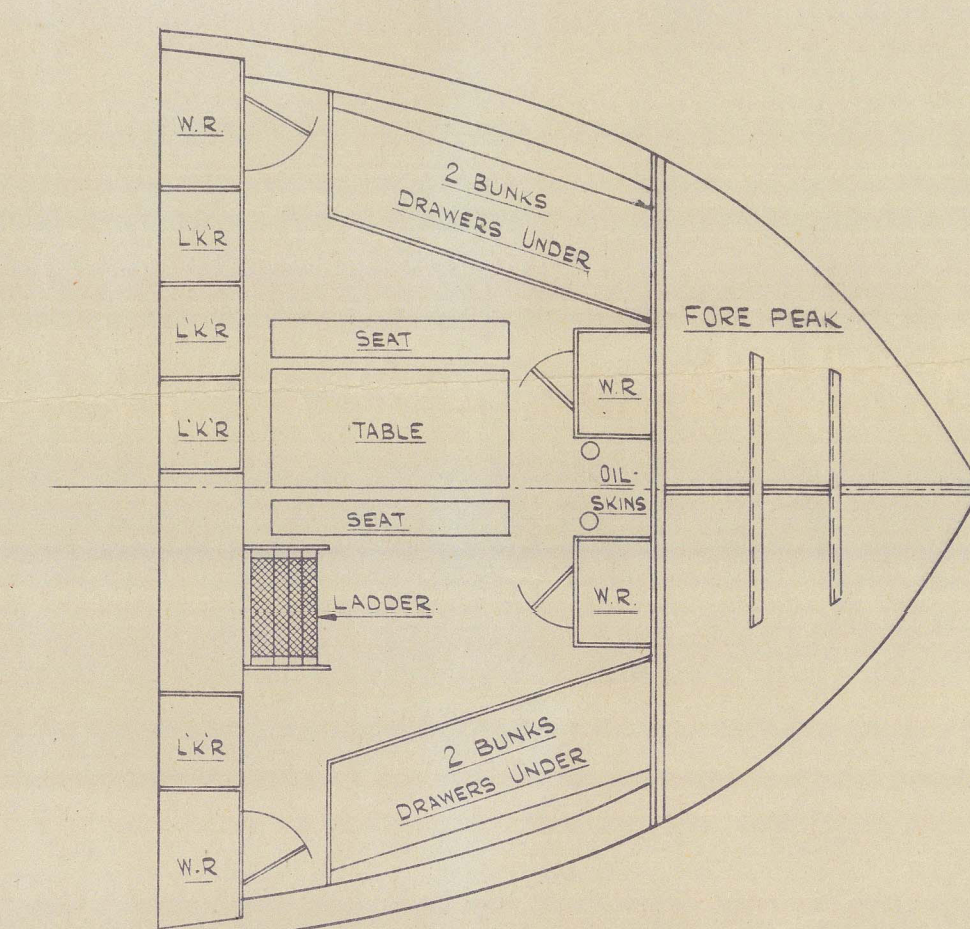
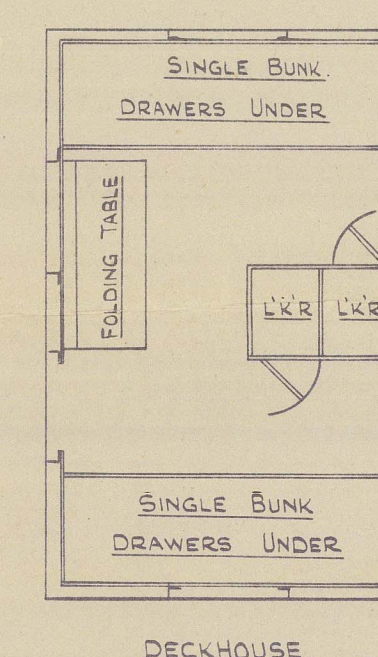

FOC'S'LE DECK :-  
TOPSIDE COVERED WITH 2 1/2" DECKING.

FLOOR OF ACCOMMODATION IN DECKHOUSE & FO'C'SLE  
TO BE COVERED WITH 'CORTICENE'.

FLOOR OF GALLEY, W.C., & WASHPLACE TO BE COVERED  
WITH 1" THICK CEMENT

ANTI-SABOTAGE MEASURES TO BE CARRIED OUT

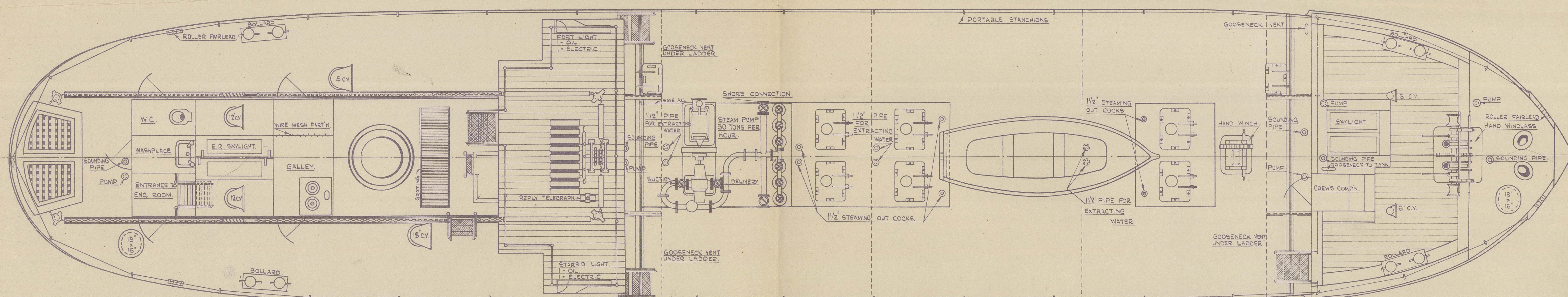
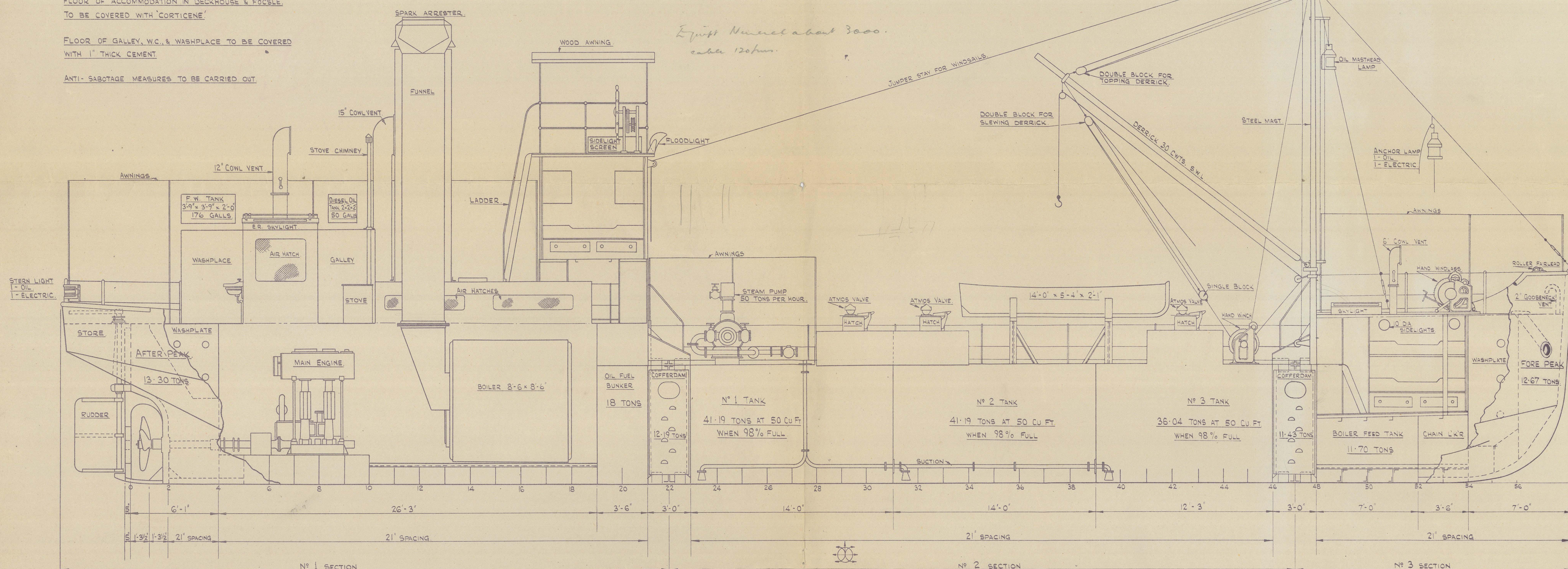



Morby

16.4.83

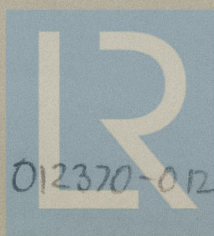

© 2021

Lloyd's Register  
Foundation

012370-012376-0113