

S.S. N^o 1115.
GENERAL ARRANGEMENT.

157'-2" B.P. x 26'-10" EXT. x 12'-0" MLD.

SCALE $\frac{1}{8}$ " = 1 FOOT.

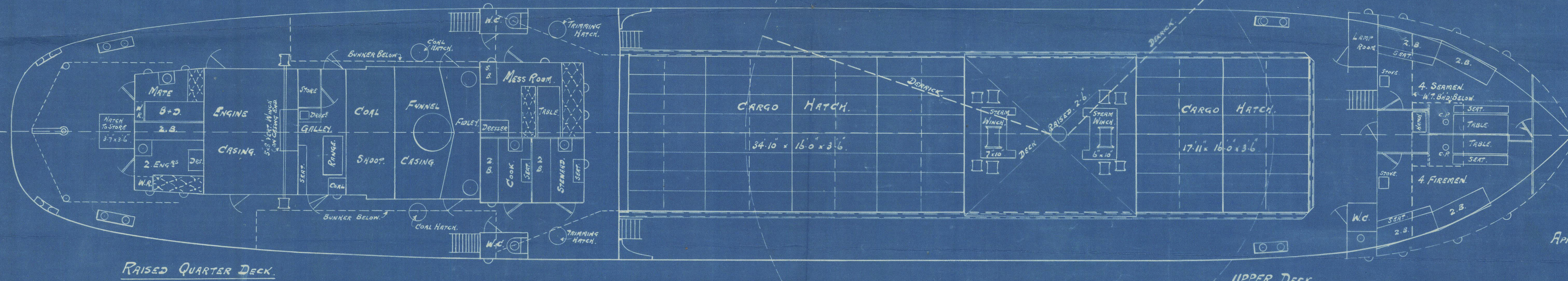
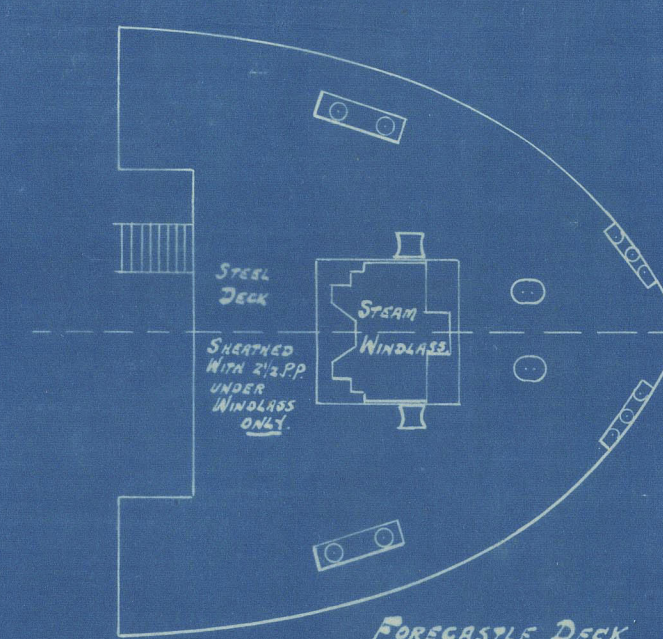
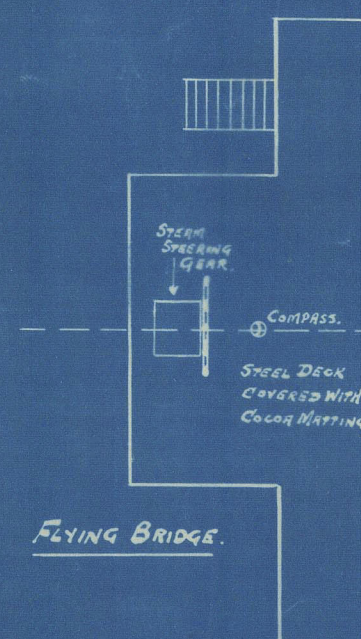
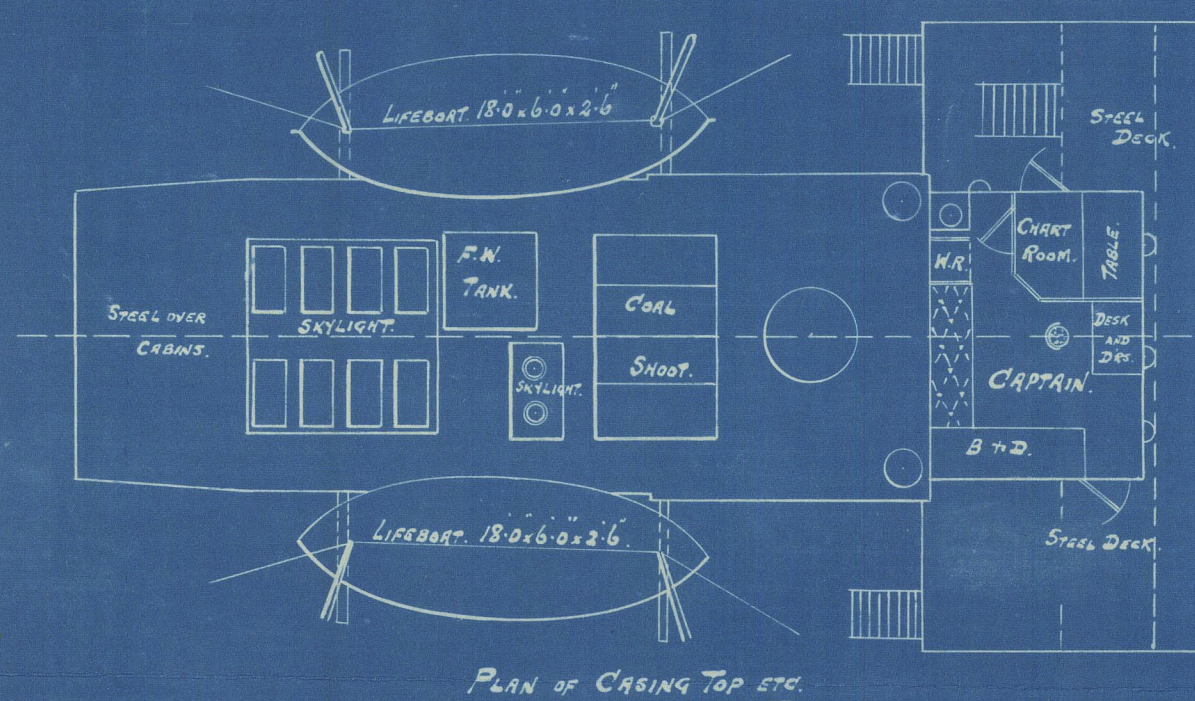
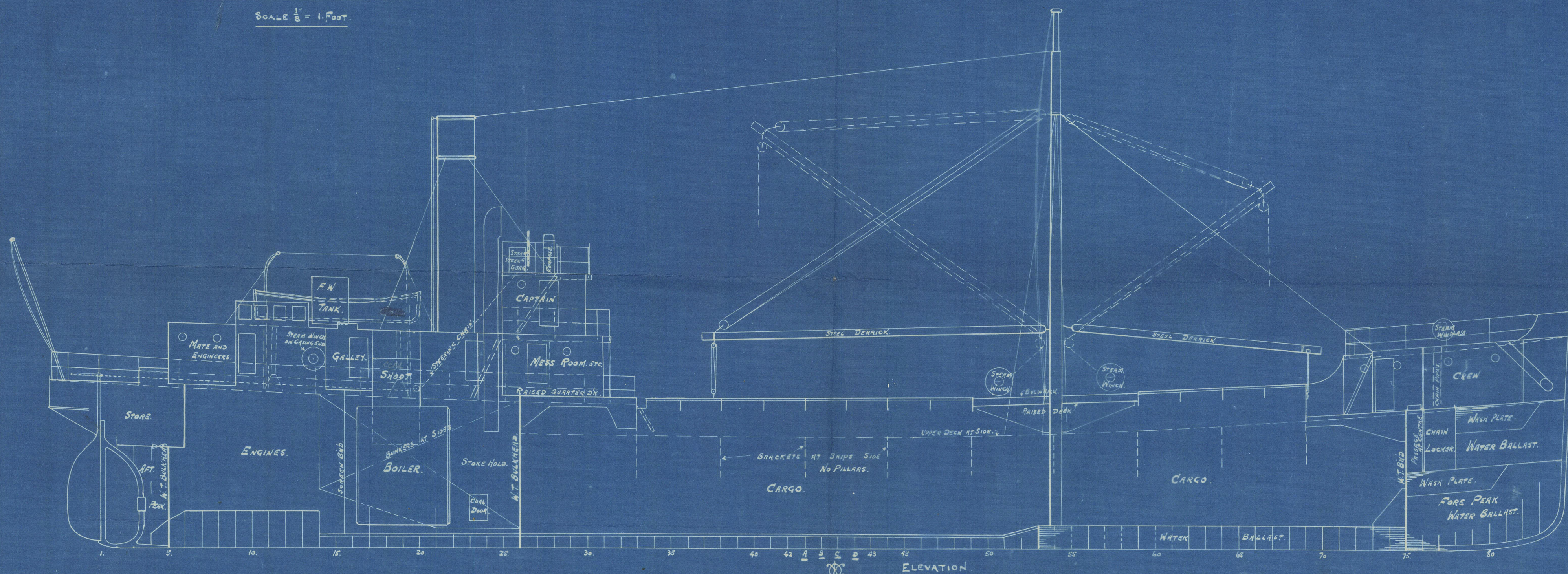

UPPER DECK.

APRIL 18th 1918.
10/1115

SWAN, HUNTER, AND WIGHAM RICHARDSON LTD.

SHIPBUILDERS AND ENGINEERS.

WALLSEND ON TYNE.

N^o 1115.

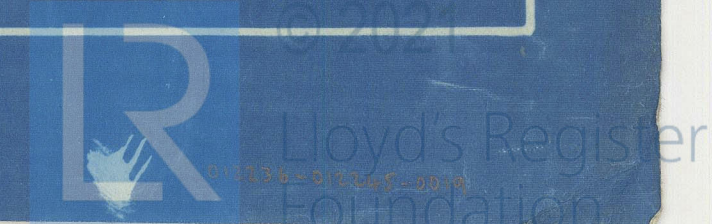

No. 4.

C.S. TYPE

SWAN HUNTER & WIGHAM RICHARDSON LTD.

SS No. 1115

General arrangement

1/2" "Hung
Sing"

S. P. WAR TAMAR

NEWCASTLE ON TYNE.

Report No. 1840.



© 2021

Lloyd's Register
Foundation

012236-012245-0019

Standard ship

1115

" Class.

For the information of the Surveyors at NWC

(Date) 16. 5. 18



© 2021

Lloyd's Register
Foundation

No. 4.

C.S. TYPE

SWAN HUNTER & WIGHAM RICHARDSON LTD.

SS No. 1115

General arrangement 7/11 "Hung Sing"

S. P. WAR TAMAR

NEWCASTLE ON TYNE.

Report No. 11840.

Shaw and Day
1115
Class.
For the information of the Surveyors at NWC
(Date) 16. 5. 18

012236-012245-0019



© 2021

Lloyd's Register
Foundation