

- VISTA ESTERNA -

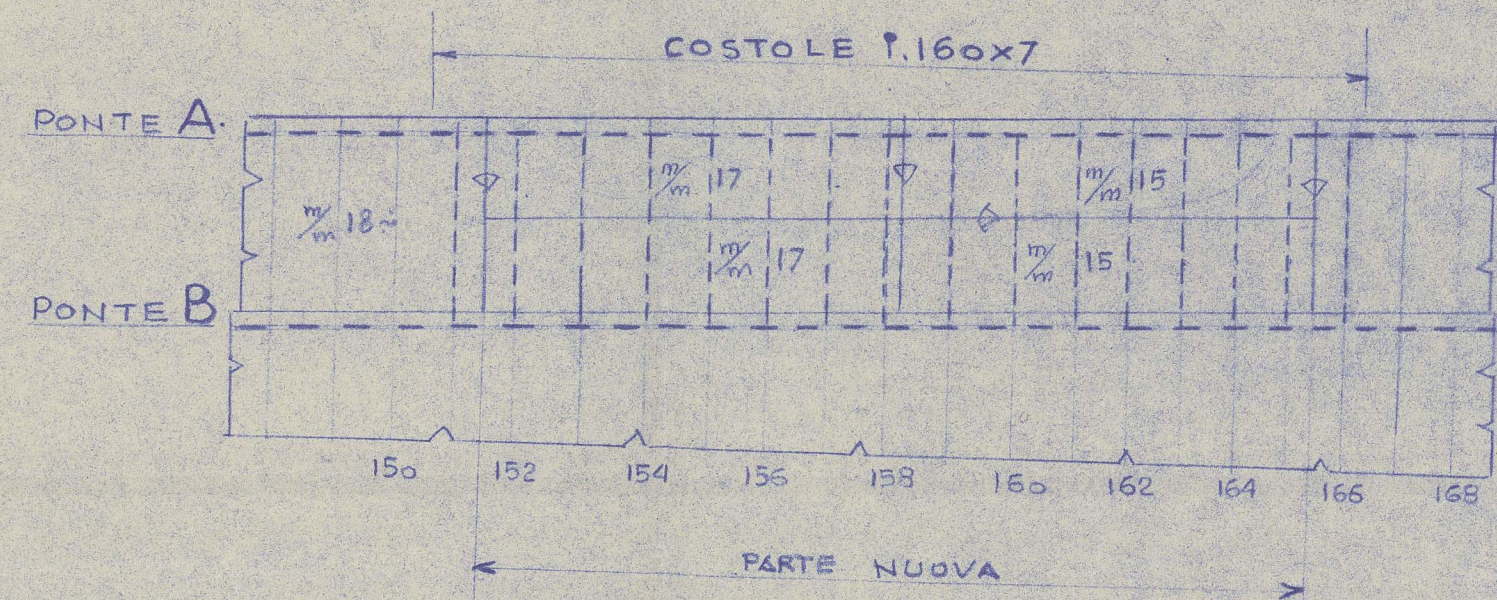

- SEZIONE LONGIT. AA -

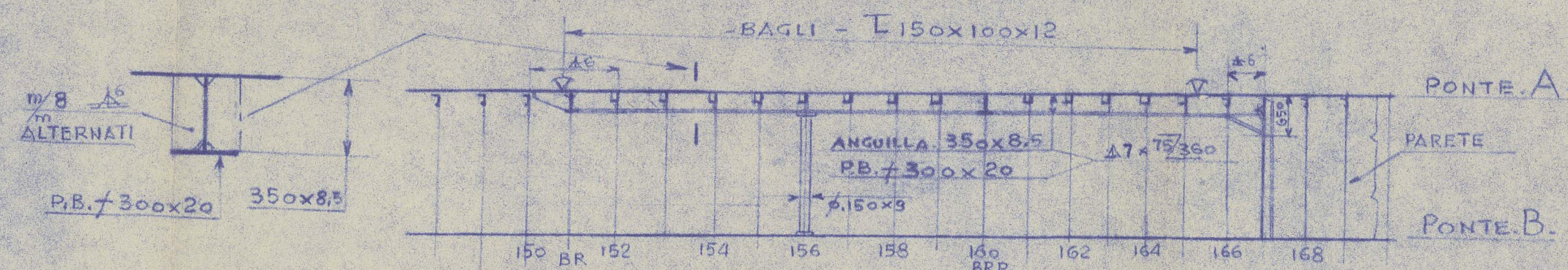

- SEZ. CC -

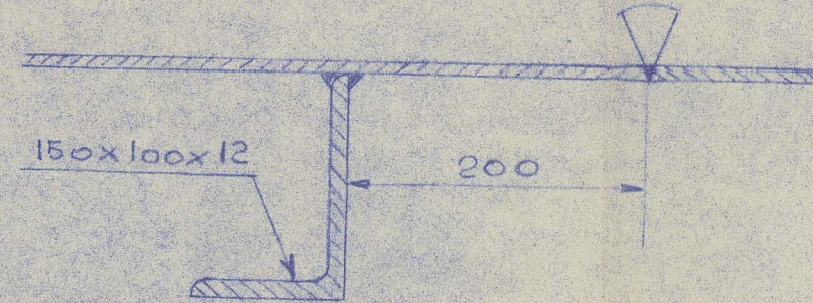

- SEZIONE LONGIT-B-B -

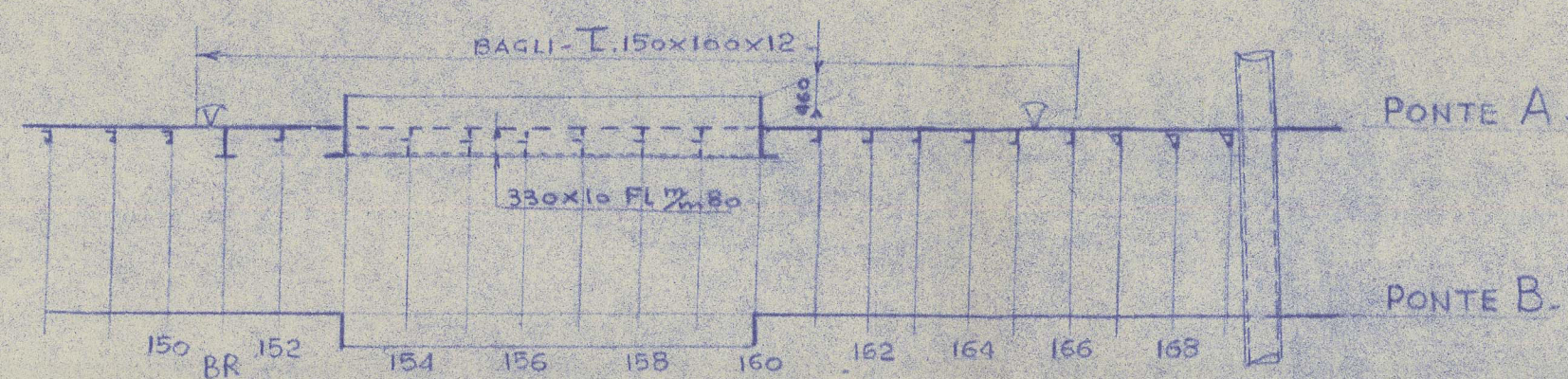

-PONTE - A -

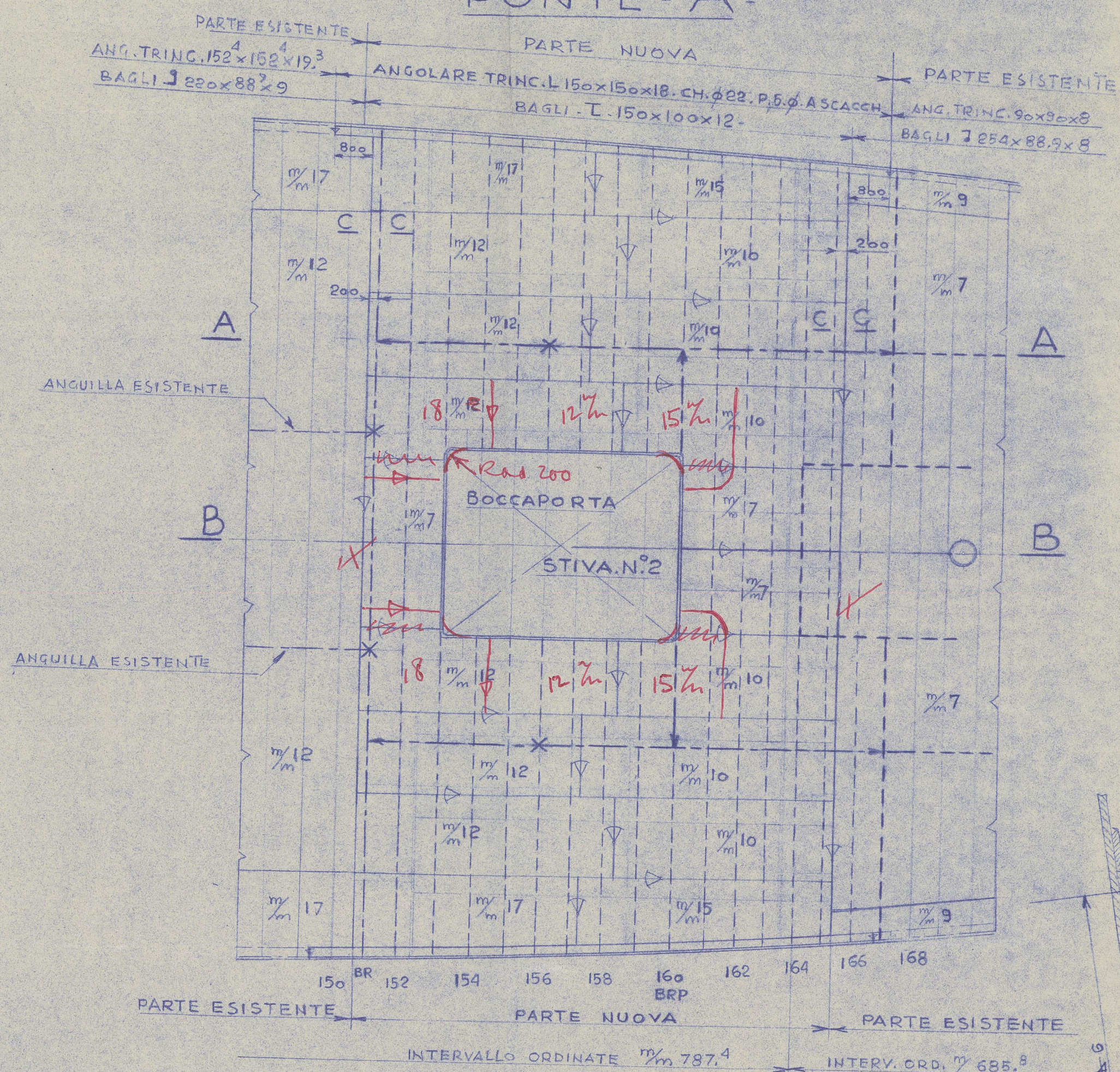

SEZIONE TRASV. ORD. 151 - (BAGLIO RINFORZATO)
GUARDANDO A/

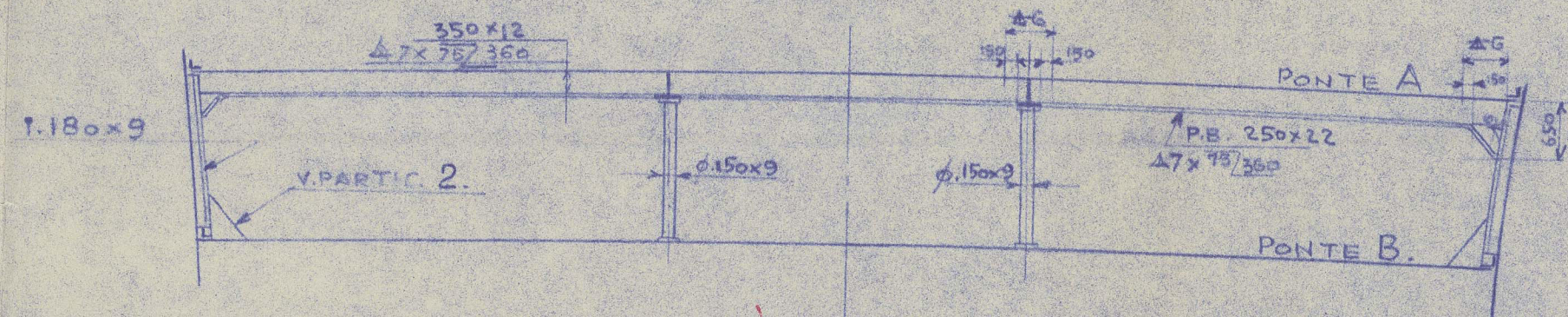

X Details of the connections of new & existing material to be decided at ship to surveyor's satisfaction

SEZIONE TRASV-ORD-160-

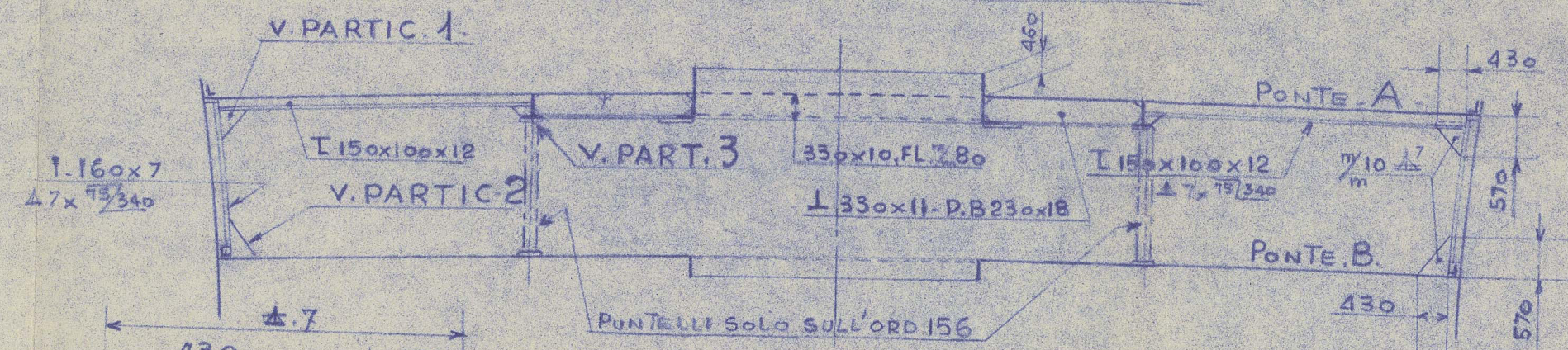

-PARTIC. 2-

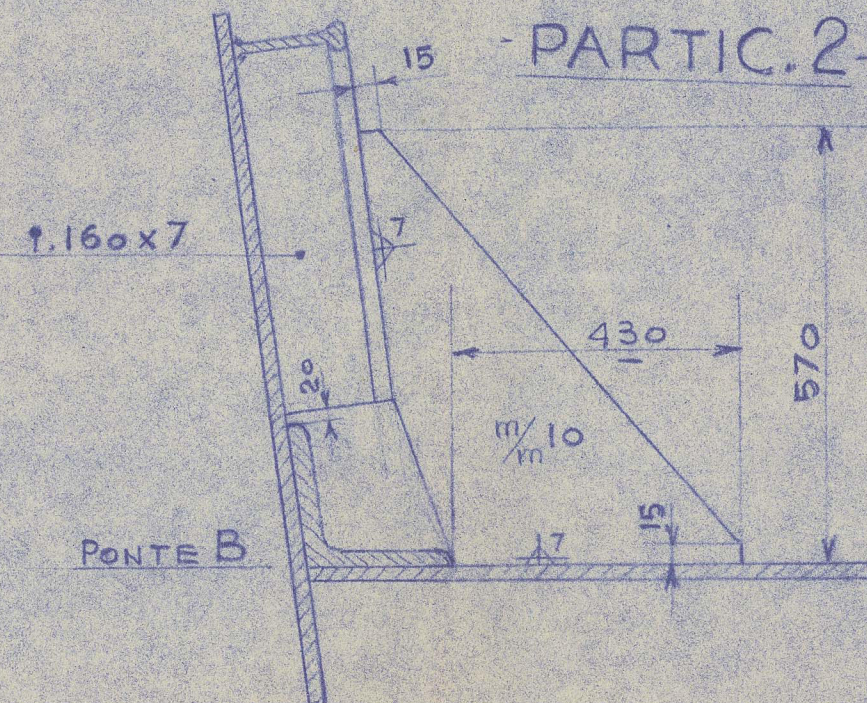

-PARTIC-3-

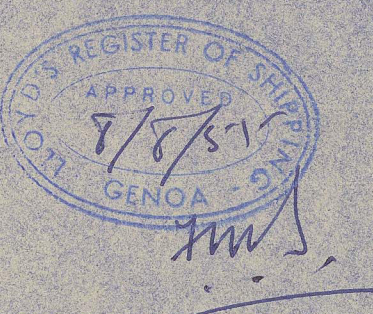
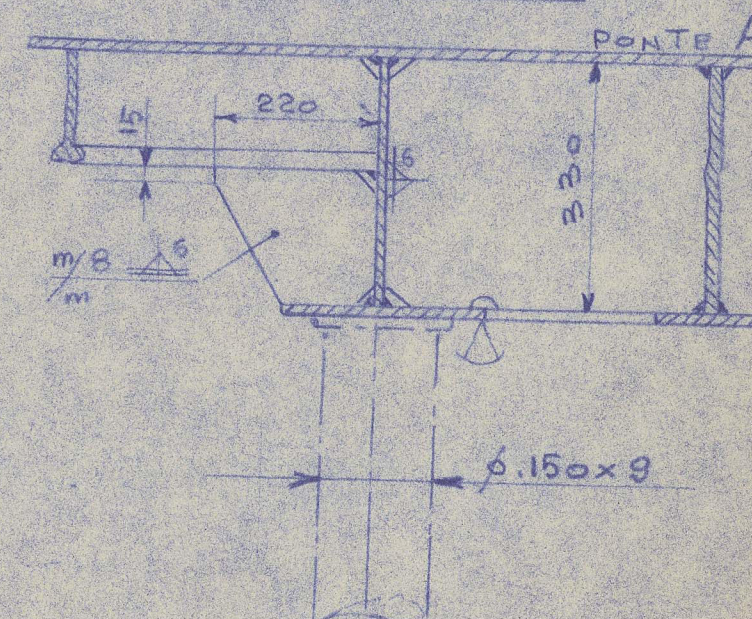

MODIFICHE	INDICE	VI STI	DATA
<p>ANSALDO S.p.A. CANTIERE DI MUGGIANO - LA SPEZIA - 2/11/81</p>			
<p>T/N. IRPINIA</p>			
<p>PROLUNGAMENTO PONTE A</p>			
<p>DALL'ORD. 151 ÷ 165.</p>			
SCALE	1:96	1:10	1:100
DISEGNIATO	CONTR. CC	CONTR. N	L'INGEGN.
DIS. N.	A	COMM	IR-1004
		L.T. 10320	
		m. 6.500	