

# YARD №112 - PROFILE & DECKPLANS - SCALE 1:100.

## NUMERALS:

D	= 34.5
L x D = 450 x 34.5	= 15525
L x (B+D) = 450 x (66+34.5)	= 48205
L x D	= 15525

## DIMENSIONS:

LENGTH BETWEEN PERPENDICULARS	450'0" = 137.157 METRES
(85' LENGTH FROM F.P. TO CRUISER STERN AT 2 DECK + 56' 446.73' = 447'10")	
BREADTH MOULDED	66'0" = 20.116 METRES
DEPTH MOULDED TO UPPERDECK	34'6" = 10.516
HEIGHT OF POOP	8'0" = 2.438
HEIGHT OF BRIDGE AND FORECASTLE	7'6" = 2.286

CLASS: BRITISH LLOYD'S REG. 100-A.1 CARRYING PETROLEUM IN BULK. ELECTRIC WELDED.  
LONGITUDINAL SYSTEM OF CONSTRUCTION.

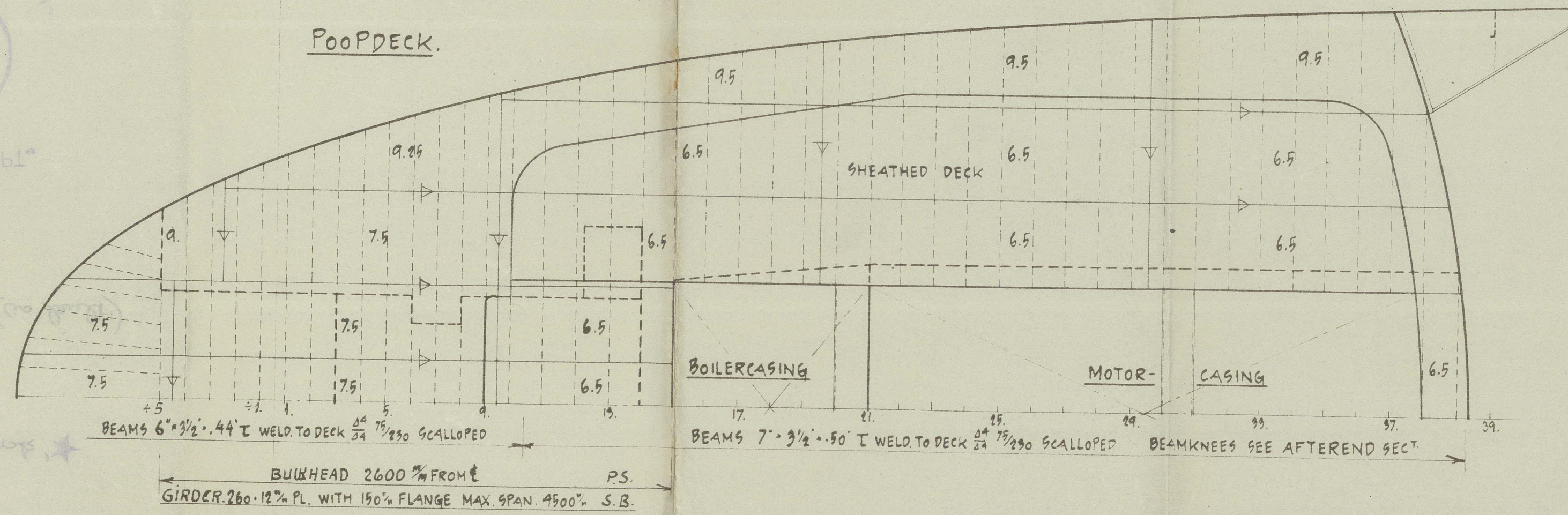


## ALTERNATIVE DECKPLAN FOR VERTICAL CORRUGATED TRANSVERSE BULKHEADS

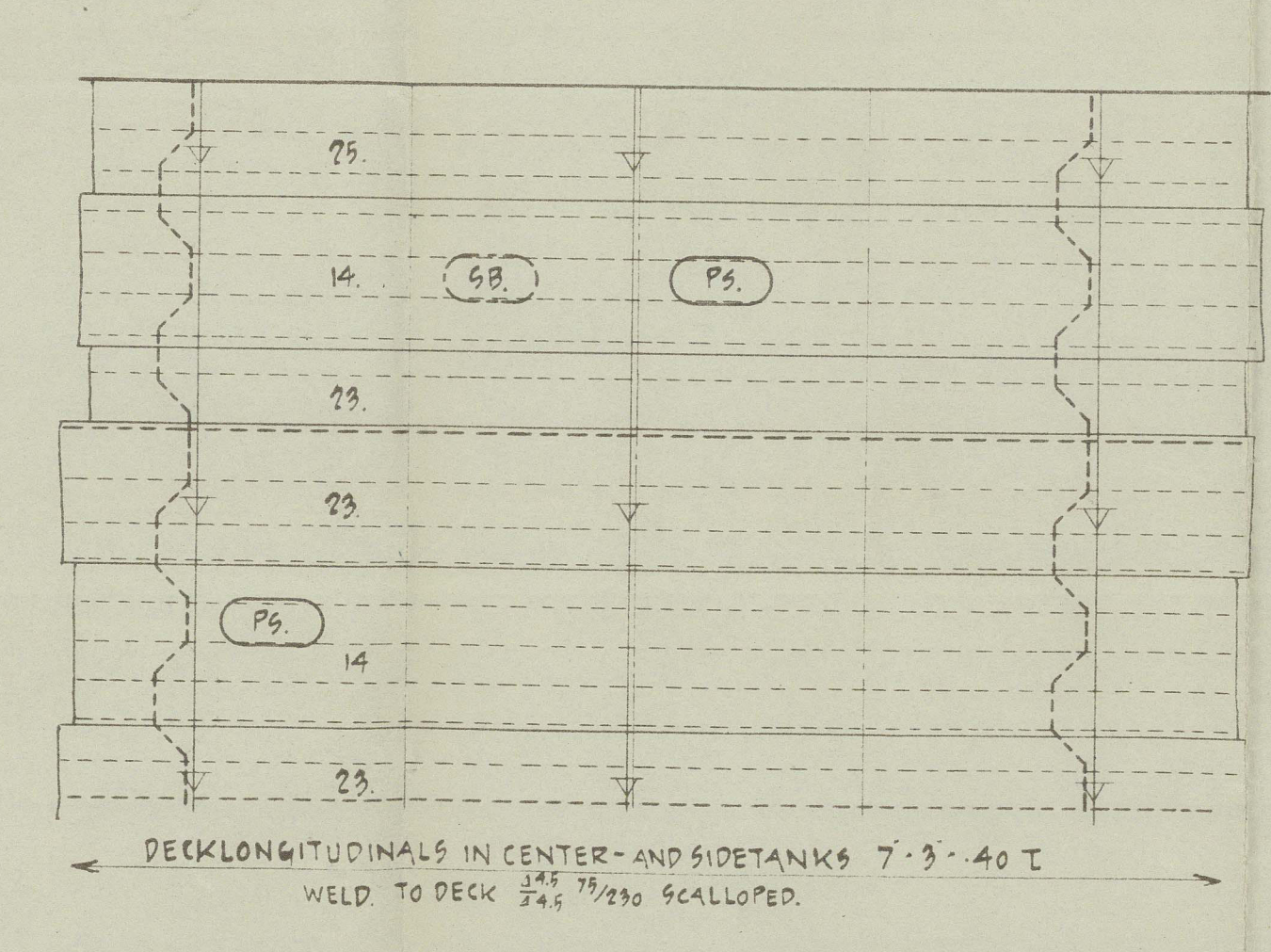

## BRIDGEDECK

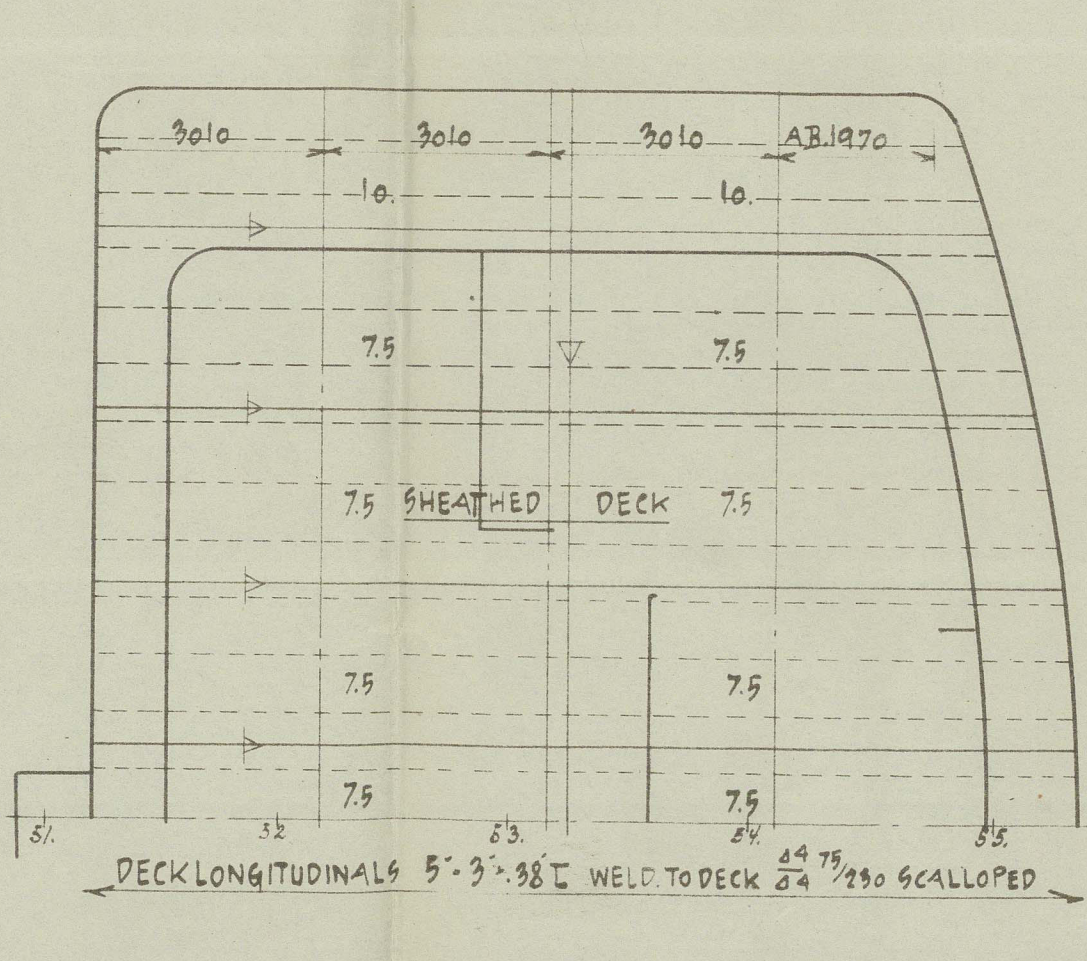

## ALTERNATIVE SECTION AT CENTERLINE FOR VERTICAL CORRUGATED TRANSVERSE BULKHEAD

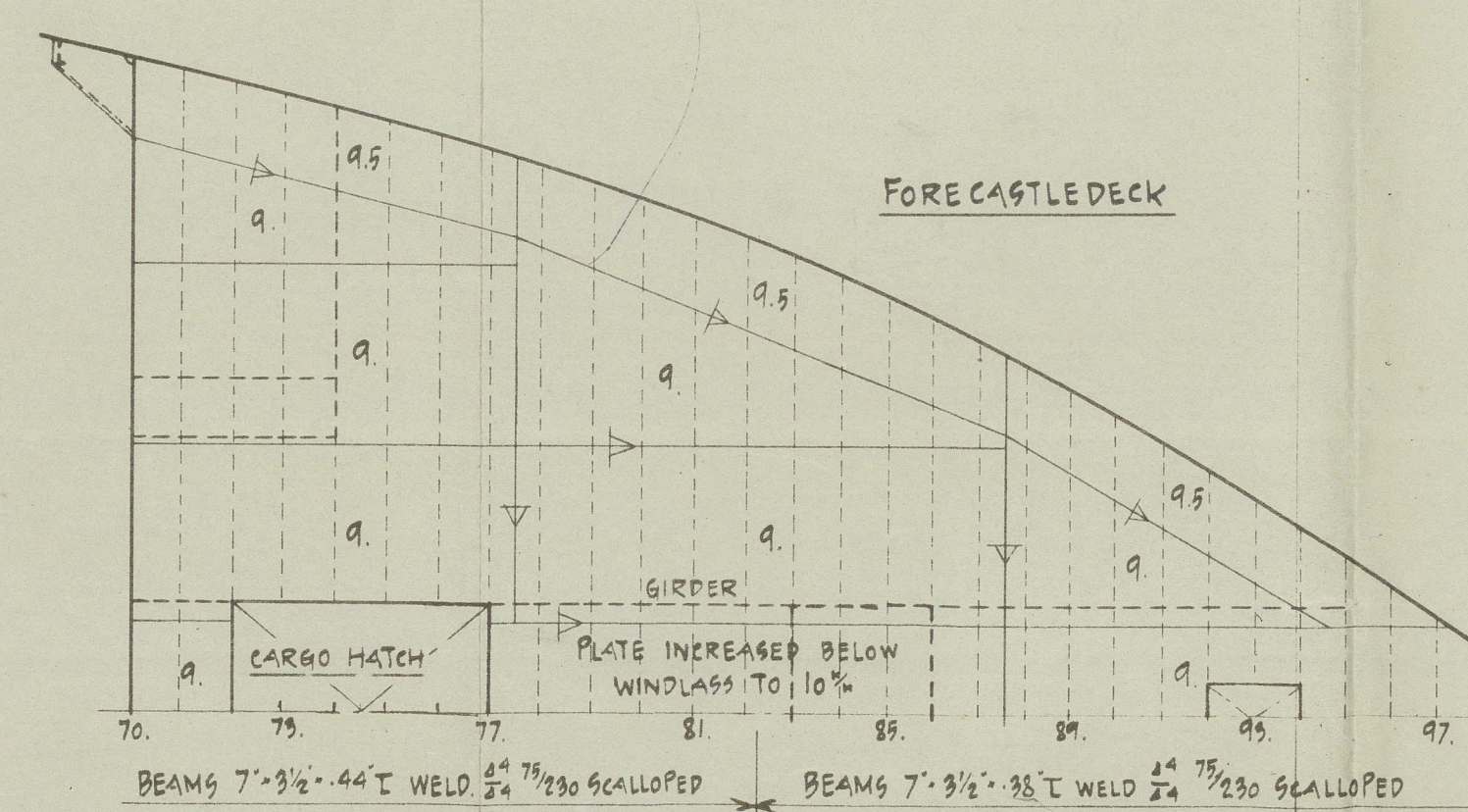
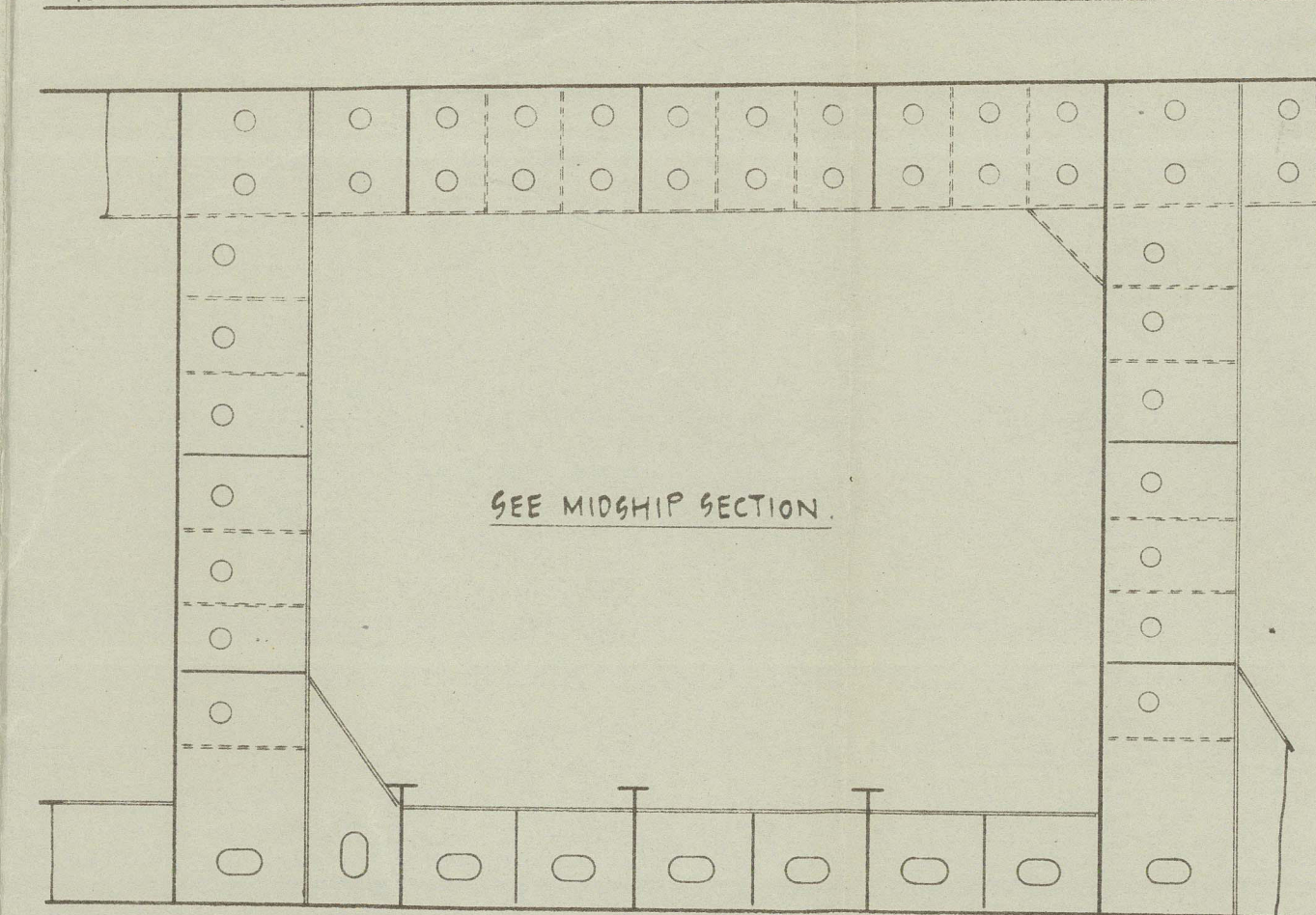

## CONNECTIONS OF DECKS AND STRINGERS TO SHELL PLATING

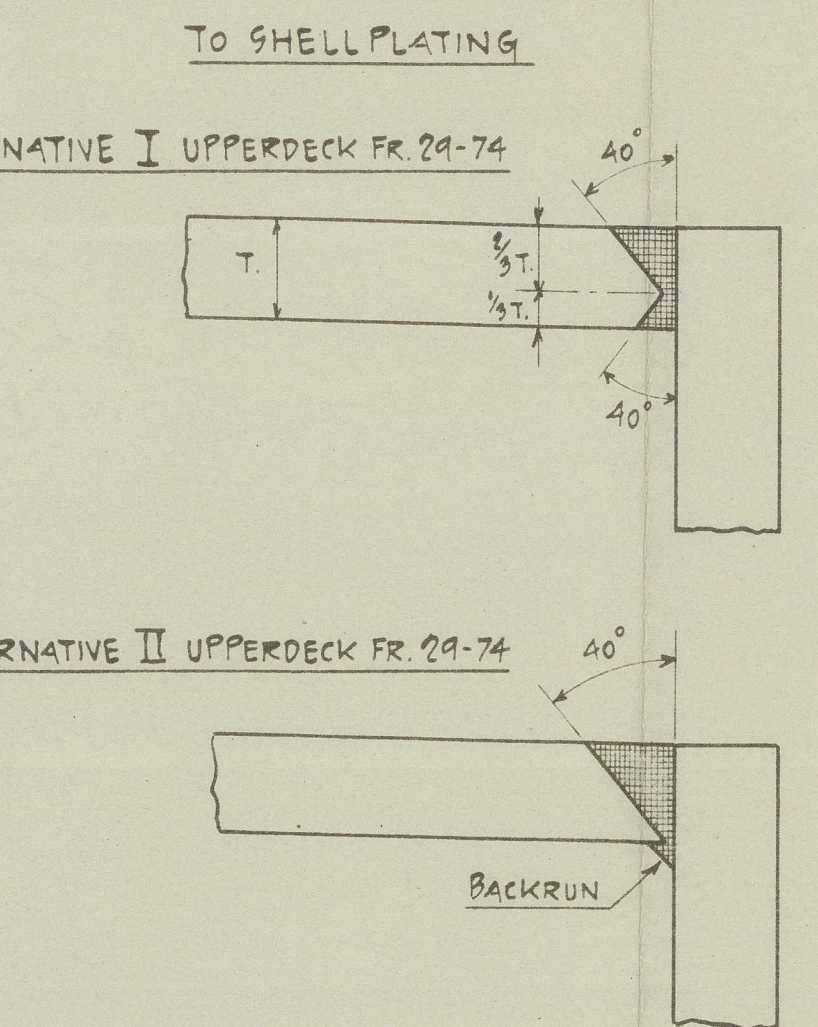

## POOP, BRIDGE, AND FORECASTLE DECK

UPPERDECK AT ENDS, SECONDDECK, BOILER PLATFORM, PEAKDECK AND STRINGERS

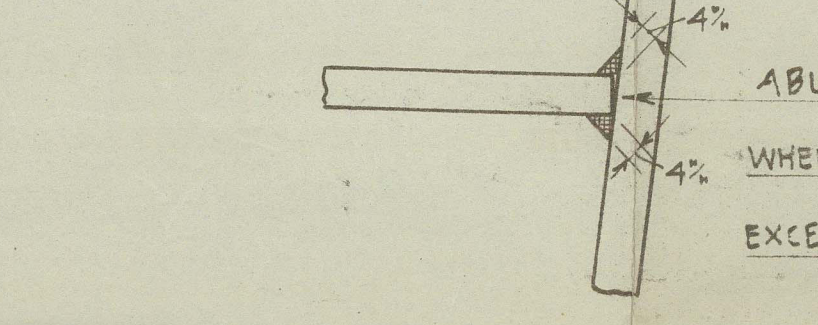

## WELDING OF UPPERDECK PLATING

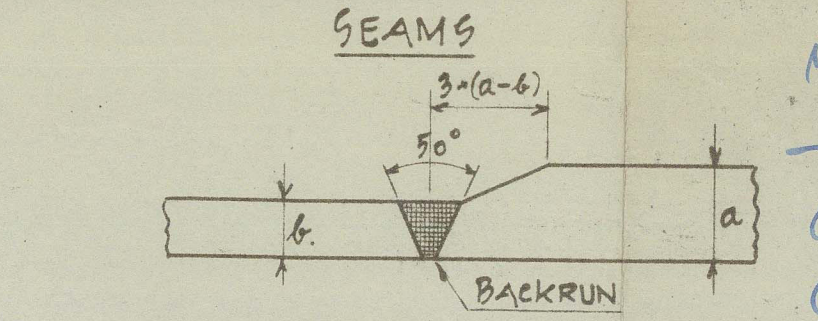

## WELDING OF LONGITUDINAL AND TRANSVERSE BUTTS IN WAY OF BULKHEADS AND WEBS

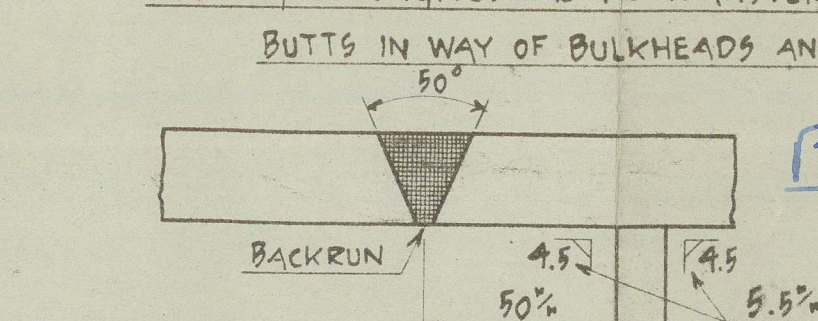

## SEAMS AND BUTTS ELSEWHERE

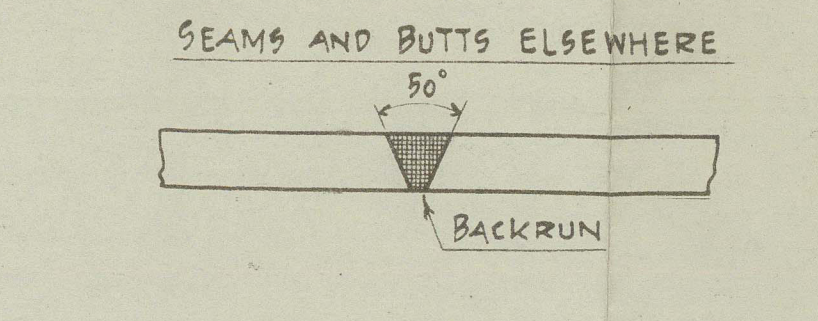

MY "CHARLOTTE MERCK"

Order of no. 112

Profile & deck as built

OBENIS STALLERUP

2/1/57

1:100

0-3-48

PROFILE AND DECKPLANS

CORRECTED BY LLOYD'S APPROVED PLAN 19-A-48 NK  
AND IN ACCORDANCE WITH THE BUILD SHIP 19-12-50

0103601000-1098

Lloyd's Register Foundation



ATRAX

EX 'Charlotte Maersk' ★

Profile & deck (as built)

RECORDS DEPT.  
LONDON

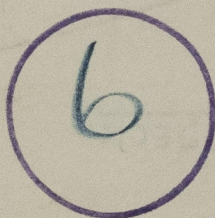

© 2021

Lloyd's Register  
Foundation

012036-012044-0098