

## Lloyd's Register of Shipping.

## SURVEYS FOR FREEBOARD.

N<sup>o</sup> 34273

"UNION FAIR"

(CONDITIONS OF ASSIGNMENT.)

Ship's Name *ex* "EMPIRE HONDURAS"Port of Survey *Sunderland*Official Number *180174*Surveyor's Signature *R.M. Wilson*Nationality and Port of Registry *British, Sunderland*  
*Liberian Monrovia*Date of Survey *While building*

Disposition and dimensions of superstructures, trunks, deckhouses and machinery casings to be inserted in the diagrams and tabular statement: --

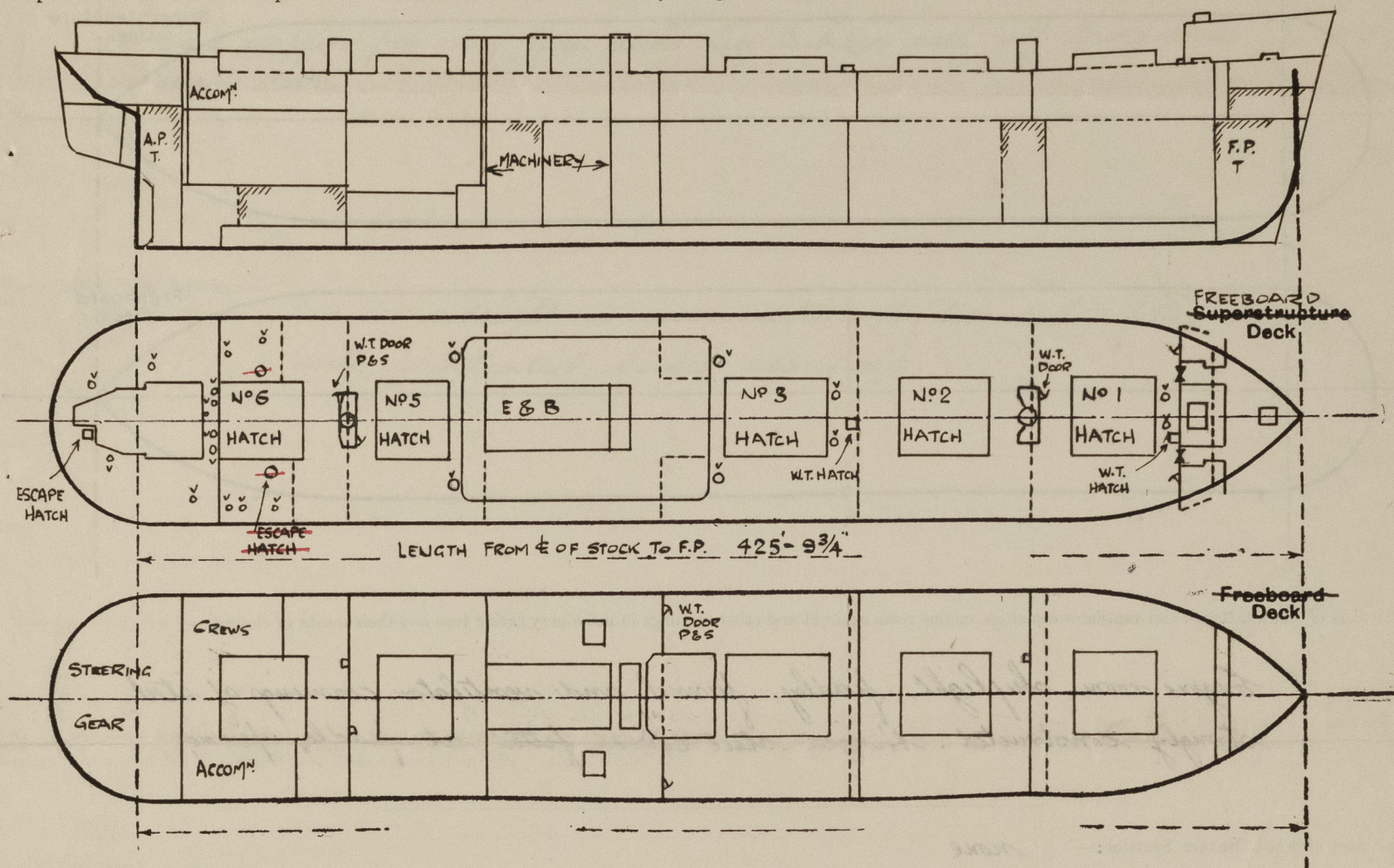

Particulars of Superstructures, Trunks, Casings, Deckhouses.

	Coaming	Plating	Stiffeners	Spacing	End Attachments of Stiffeners	Size of Openings	Height of Sills	Height of Casings
Poop Bulkhead ... ..	✓	40"	5" x 3" x 40' L x 8 3/4" x 40' Flat Welded @ 3'-7 3/4"	✓	✓	✓	✓	3'-0" ✓
Raised Quarter Deck Bulkhead ...	✓							
Bridge, After Bulkhead ... ..	✓							
Bridge, Forward Bulkhead ... ..	✓							
Forecastle Bulkhead ... ..	30"	30"	3 1/2" x 3 3/8" W.T.O.	30"	WELDED TO DECK	20'5"0" x 2'-0" / 20'5"0" x 3'-1"	12"	7'-0" ✓
Trunk, Aft ... ..	✓							
Trunk, Forward ... ..	✓							
Exposed Machinery Casings on Freeboard or Raised Quarter Decks ...	✓							
Exposed Machinery Casings on Superstructure Decks ... ..	✓							
Machinery Casings within Superstructures not fitted with Class I Closing Appliances ... ..	✓							
Deckhouses on Flush Deck Ships ...	✓							

Particulars of Closing Appliances (state if capable of being manipulated from both sides).

Poop Bulkhead ... ..	No openings.
Raised Quarter Deck Bulkhead ...	✓
Bridge, After Bulkhead ... ..	✓
Bridge, Forward Bulkhead ... ..	✓
Forecastle Bulkhead ... ..	Hinged steel doors operated from both sides. 2 1/2" shifting boards in full height channels ✓
Exposed Machinery Casings on Freeboard or Raised Quarter Decks ...	✓
Exposed Machinery Casings on Superstructure Decks ... ..	✓
Machinery Casings within Superstructures not fitted with Class I Closing Appliances ... ..	✓
Deckhouses on Flush Deck Ships ...	✓

Lloyd's Register  
Foundation

011823-011825-0184'12







### PARTICULARS OF PROTECTION TO OPENINGS, ETC.

HATCHWAYS ON FREEBOARD AND SUPERSTRUCTURE DECKS.													
← FREEBOARD DECK →													
Description of Hatchway			№1	№5 283	№5	№6	CASING TOP 2 OFF	FOCLE DECK	UPPER DK. IN FOCLE	UPPER DK. IN FOCLE	W.T. ESCAPE HATCHES ON UPPER DK. 3- OFF 2' 0" x 2' 6" APPROX.	ESCAPE HATCHES FROM ACCOM	
Dimensions of Hatchway			31' 6" x 23'	36' x 23'	36' x 23'	36' x 23'	19' 4" x 9'	6' x 4' 2"	3' 9" x 3'	6' 4" x 4' 3"		2- OFF	
COAMINGS	{	Height above Deck	30"	30"	42"	54"	12"	30"	9"	9"		24" DIA"	
		Thickness	Sides	44	44	44	44	12 x 3 1/2 x 45 L	44	9 x 3 1/2 x 40 L	9 x 3 1/2 x 40 L	9" x 40"	6" COAMING MECHANISMS MAKE
			Ends	44	44	44	44	20	44	20	20		
		Stiffeners	9 x 3 1/2 x 46 L	12 x 3 1/2 x 46 L	9 x 3 1/2 x 46 L	9 x 3 1/2 x 46 L	✓	✓	✓	✓	✓		
Brackets, Stays	3-40 BKTS	3-40 BKTS	3-40 BKTS	3-40 BKTS	✓	✓	✓	✓	✓				
HATCH BEAMS	{	Number	6	7	7	7	1						
		Spacing	equal	equal	equal	equal	equal						
		Scantling and Sketch		5 x 3 x 46	20	20	20	4 x 3 x 44	✓	✓	✓	✓	✓
				18 x 36				16 x 36					
Bearing Surface	5 x 3 x 46	3	3	3	3	4 x 3 x 44	3						
FORE AND AFTERS	{	Number											
		Spacing											
		Unsupported Lengths											
		Scantling and Sketch	NONE	✓	✓	✓	✓	✓	✓	✓	✓	✓	
Bearing Surface													
HATCH COVERS	{	Material	W.W.	W.W.	W.W.	W.W.	W.W.	W.W.	W.W.	W.W.	HINGED STEEL COVER	HINGED STEEL COVER	
		Thickness	3"	3"	3"	3"	3"	3"	3"	3"	3"	BY TOSSELES	
		How fitted	F.B.A.	F.B.A.	F.B.A.	F.B.A.	F.B.A.	THWART	F.B.A.	THWART.			
		Bearing Surface	3	3	3	3	3	3	3	3	3		
Spacing of Cleats			24"	24"	24"	24"	24"	24"	24"	24"			
Number of Tarpaulins			3	3	3	3	2	3	2	2			

\*Are wood fore and afters steel shod at all bearing surfaces? NONE

Are battens and wedges efficient and in good condition? YES

Are tarpaulins in good condition and in accordance with rule requirements? YES

Are lashings provided in accordance with rule requirements? LOCKING BARS.

Particulars of any special features :—

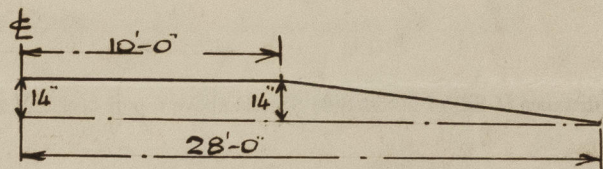
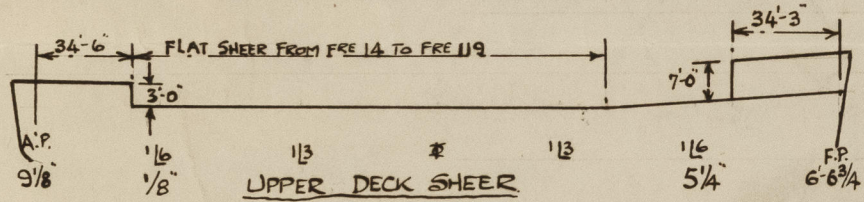

CAMBER Equivalent Camber Area

$$\begin{aligned} (20+18) \times \frac{14}{12} &= 44.33 \text{ sq. ft.} \\ \text{mean height} &= \frac{44.33}{100} = .792 \end{aligned}$$

This vessel has been built to scantlings as per plans approved <sup>mean depth =  $\frac{4.55}{2} = 2.275$</sup>  56 <sup>Eq camber</sup> 29/10/43 in order to obtain a draught in excess of that permitted by  <sup>$.792 \times 1.5 \times 12 = 14.25$</sup>  the Rules for a C.S.S. vessel having a tonnage opening.

Pre-fabricated materials have been incorporated in the vessel.

Endorsement at first survey and at surveys for renewal of Certificate :—

The fittings and appliances are in accordance with the particulars shown on this form (or as now modified) and are in good condition.