

Lloyd's Register of Shipping.
SURVEYS FOR FREEBOARD.
(CONDITIONS OF ASSIGNMENT.)

Ship's Name "WINAMAC" ex Mobilube Port of Survey Marseille
Official Number ✓ Surveyor's Signature [Signature]
Nationality and Port of Registry Panamanian, Panama R.P. Date of Survey 5th December 1955

Disposition and dimensions of superstructures, trunks, deckhouses and machinery casings to be inserted in the diagrams and tabular statement: -

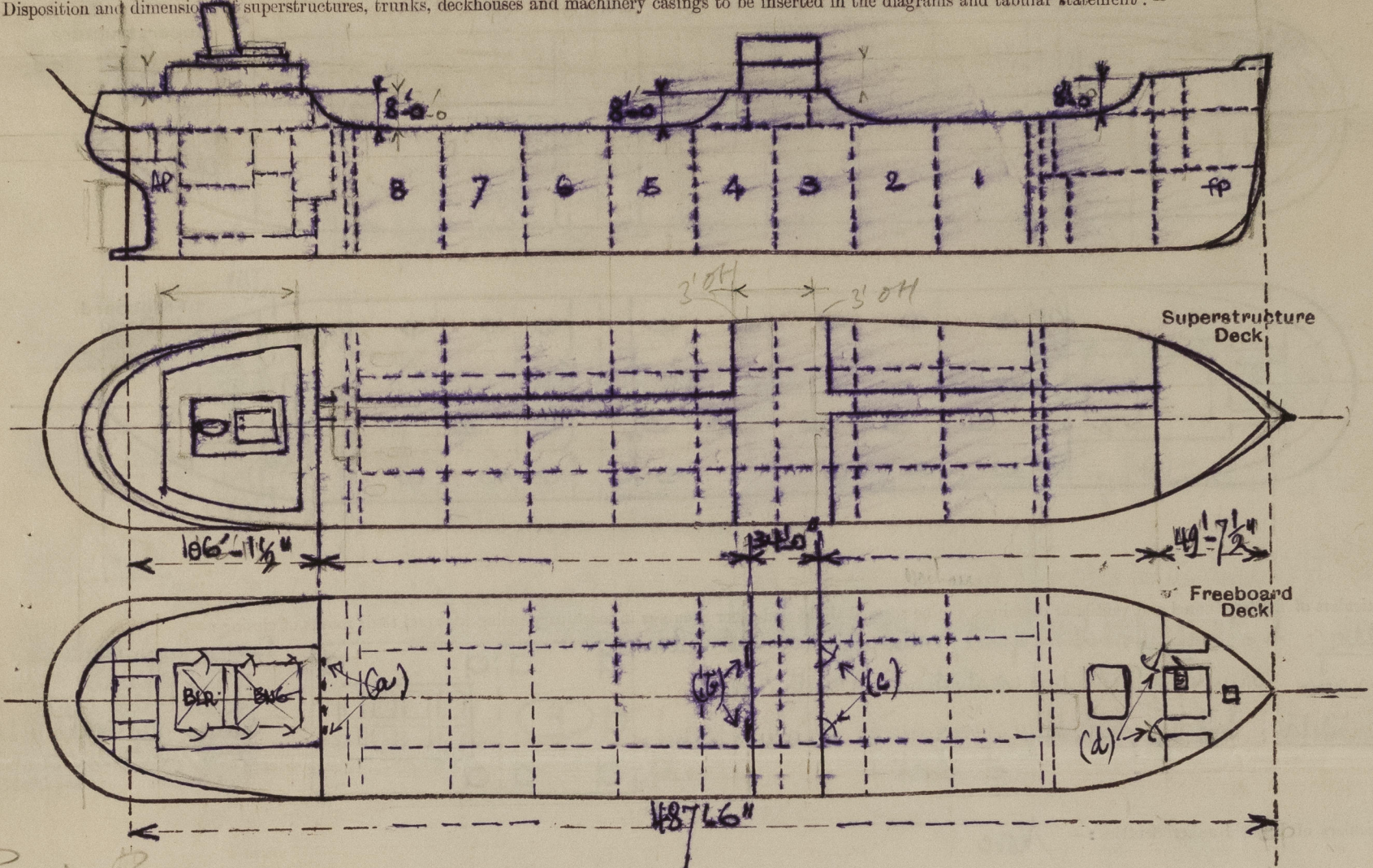

Pump Room

Particulars of Superstructures, Trunks, Casings, Deckhouses.								
	Coaming in.	Plating in.	Stiffeners in.	Spacing in.	End Attachments of Stiffeners	Size of Openings in.	Height of Sills in. ins.	Height of Casings ft.
Poop Bulkhead ...	46	46	8x4x5/8	14	14x14x1/2 at top	12 in diam port light	60	8'-0
Raised Quarter Deck Bulkhead ...	✓	✓	✓	✓	✓	✓	✓	✓
Bridge, After Bulkhead ...	82	82	5x3x3/8	33	14x14x1/2 at top	50x62	18	8'-0
Bridge, Forward Bulkhead ...	46	46	8x4x5/8	33	14x14x1/2 at top	28x60	18	8'-0
Forecastle Bulkhead ...	82	82	4x3x3/8	30	no brackets	28x60	18	8'-0
Trunk, Aft ...	✓	✓	✓	✓	✓	✓	✓	✓
Trunk, Forward ...	✓	✓	✓	✓	✓	✓	✓	✓
Exposed Machinery Casings on Freeboard or Raised Quarter Decks ...	✓	✓	✓	✓	✓	✓	✓	✓
Exposed Machinery Casings on Superstructure Decks ...	✓	✓	✓	✓	✓	✓	✓	✓
Machinery Casings within Superstructures not fitted with Class I Closing Appliances ...	✓	✓	✓	✓	✓	✓	✓	✓
Deckhouses on Flush Deck Ships ...	✓	✓	✓	✓	✓	✓	✓	✓

Particulars of Closing Appliances (state if capable of being manipulated from both sides).

Poop Bulkhead ...	(a)	4 in 2° brass framed port lights, substantially constructed, fitted with hinged W.T. Deadlights
Raised Quarter Deck Bulkhead ...	✓	✓
Bridge, After Bulkhead ...	(b)	3/8th bolted steel plates, port and starboard, efficiently secured by hook bolts.
Bridge, Forward Bulkhead ...	(c)	2 in 40 strong hinged steel W.T. doors capable of being manipulated from both sides.
Forecastle Bulkhead ...	(d)	2 in 40 strong hinged steel W.T. doors capable of being manipulated from both sides.
Exposed Machinery Casings on Freeboard or Raised Quarter Decks ...	✓	✓
Exposed Machinery Casings on Superstructure Decks ...	✓	✓
Machinery Casings within Superstructures not fitted with Class I Closing Appliances ...	✓	✓
Deckhouses on Flush Deck Ships ...	✓	✓

PARTICULARS OF PROTECTION TO OPENINGS, ETC.

The following diagrams should be used to indicate the positions of cargo and coaling hatchways, gangway, cargo and coaling ports, ventilators, companionways, etc., which would affect the seaworthiness of the ship :-

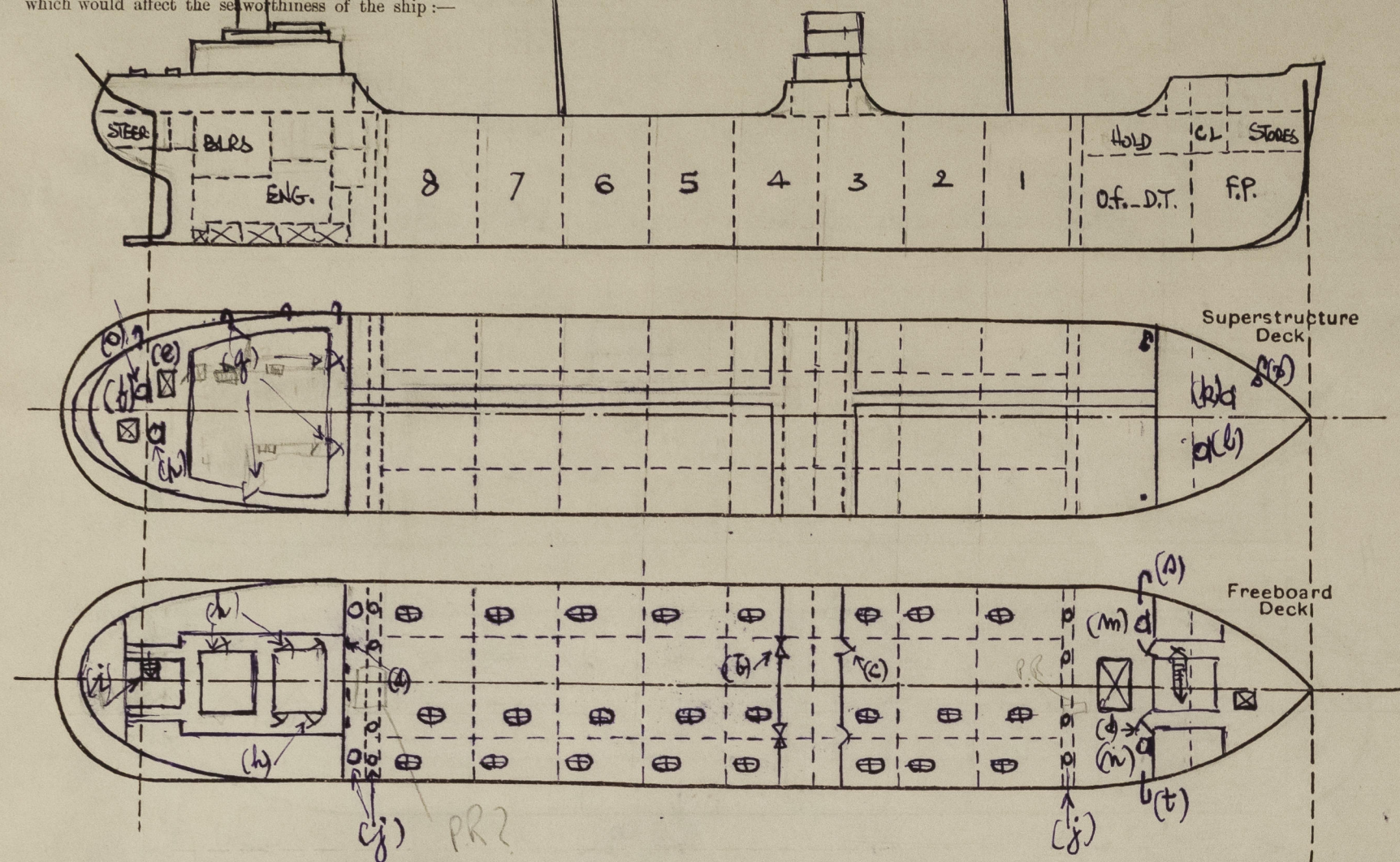

Particulars of fiddle, funnel and ventilator coamings, engine room skylight and other openings in machinery casing tops and their means of closing :-

- F Fiddle: h = 36 in. above deck, of steel, riveted, efficient construction
- F Funnel: Coaming of substantial construction efficiently secured
- V Ventilator: End type, 30 in. diam., coaming efficiently secured (see sketch)

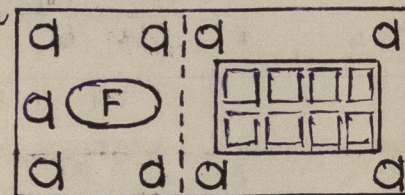

Engine Room Skylight: of steel efficiently constructed and secured to deck plating. Hinged glass covers (p.l.s.) operated from inside by pulley and rods. (See sketch)

Particulars of Flush Bunker Scuttles :-

None

- Hatches on Roop Deck aft: (a) 4-0 x 3-0 ft opening, h. coaming 24 in. efficiently secured to deck, of steel and closed by hinged steel cover
- (b) 3-0 x 3-0 ft opening, h. coaming 24 in. efficiently secured to deck, of steel and closed by hinged steel cover

Particulars of Companionways :-

- (a) Access down to Roop House accommodation and Eng. Room from Roop Deck: 26 x 7 1/2 opening 7 in. sill, and steel doors.
- (b) Access down to Engine Room from Main Deck: 28 x 7 1/2 in. clear opening 9 in. sill closed by ordinary hinged steel door
- (c) Access ladder down to Steering Gear Space from Main Deck: 36 x 48 in. opening in deck closed by hinged steel cover.
- (d) Access to fore and aft cofferdams: 20 in. h. = 24 in. and to S.F. Bulkheads (aft) 30 in. h. = 24 in. closed by hinged steel cover.

Particulars of Ventilators in exposed positions on freeboard and superstructure decks :-

- Forecastle Deck: (a) 12 in. diam. end type ventilator efficiently secured to deck h. coaming = 4-0
- (b) as above to fore and aft bulkheads
- Freeboard Deck: (m) 18 in. diam. end type ventilator efficiently secured to deck and to forecastle bulkheads
- (n) as above both ventilators to dry cargo space above O.F. deep tanks. h. coaming = 10-0
- Roop Deck: (o) 18 in. diam. end type ventilator coaming h. = 7-0 efficiently secured to deck
- (p) as above to fore and aft bulkheads

Ventilator closing appliances in accordance with Rule requirements & coamings over 36 in. height adequately supported.

Forecastle Deck:

- (a) 1 - from F.P. Tank, gooseneck type, diam 5 in, h = 3-0 ft. efficient plating cover provided
- (b) 1 - from O.F. Deep Tank gooseneck type 7 in diam, h above deck 7-0 ft provided with efficient cover and efficiently secured to forecastle end.
- (c) 1 - from O.F. Deep Tank (O.B.) - as above -
- Roop Deck: 1 - 4 in. diam, port and starboard, from O.F. bulkheads and Tanks in E.R. 7 and 5 in diam, h = 2-6 and 1 aft from S.P. Tank all provided with efficient means for closing of openings

Particulars of Gangway Cargo and Coaling Ports :-

None

Particulars of Scuppers and Sanitary Discharge Pipes :-

- Forecastle Space: No sanitary discharge Scuppers to main deck through end bulkhead
- Bridge Space: Sanitary discharge (3 port 3 starb) led through bridge sides above level of main deck; all discharges are fitted with automatic non return valves and positive action valves.
- Roop Space: Sanitary discharge (4 port 4 starb) through shell side plating below level of main deck and above bridge, all fitted with automatic non return valves (steel chests) efficiently secured to ship's sides and with positive action valves readily accessible at all times and provided with indicator showing open and shut positions
- Scuppers from Roop House to Roop Deck above main deck
- Scuppers from Roop Space on main deck led to E.R. Bridge p.l.s.

Particulars of Side Scuttles :-

- Forecastle sides: 3 in. x 6 in. of substantial construction provided with inside hinged W.T. deadlights
- Bridge sides: 3 in. x 6 in. of substantial construction provided with inside hinged W.T. dead lights
- Roop sides: 23 in. x 6 in. (S.S.) and 24 in. x 6 in. (P.S.) substantially constructed and provided with deadlights as above for crew accommodation in Roop Space above main deck.

Vertical distance of Sill of lowest Side Scuttle above top of keel

44-0 ft.

Particulars of Guard Rails :-

- Guard Rails fitted to forecastle and Roop Decks (see sketch) and steel plating substantial bulkheads fitted to bridge deck.
- Chairs fitted to each side of main deck efficiently supported by removable standards secured in sockets welded to deck

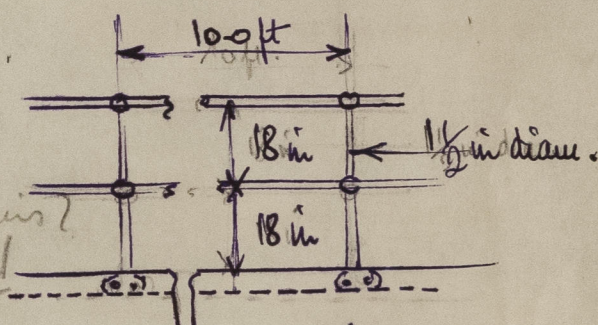

Particulars of Gangways, Lifelines, etc. :-

- Permanent fore and aft gangway on port side near centre line between Roop and Bridge and between Bridge and forecastle (see sketch)
- Chairs fitted on standards in line of guard rails.

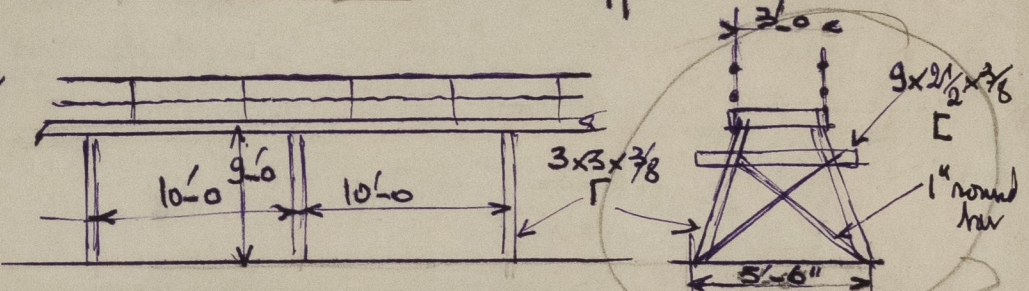

Particulars of Freeing Arrangements.						
	Length of Bulwark	Height of Bulwark	Size of Freeing Ports	Number each side	Area each side	Rule area each side
After Well ...	No Bulwarks					✓
Forward Well ...						
State position of each freeing port ...	After Well :-			✓		
(F. and A. position and height above deck edge)	Forward Well :-			✓		
State whether the freeing ports are fitted with shutters, bars, or rails, and give particulars of such :-				✓		
Additional area where sheer is less than standard.				✓		

PARTICULARS OF PROTECTION TO OPENINGS, ETC.

HATCHWAYS ON FREEBOARD AND SUPERSTRUCTURE DECKS.											
Description of Hatchway		Nº1	Nº2	Nº3	Nº4	Nº5	Nº6	Nº7	Nº8	Dry Cargo Space	
Dimensions of Hatchway		7'0" x 4'0"	no 2 to 8							14'0" x 11'0"	
COAMINGS	Height above Deck	48 in								32 in	
	Thickness	1/4 in								1/4 in	
	Sides										
	Ends										
HATCH BEAMS	Stiffeners										
	Brackets, Stays										
	Number										
	Spacing										
FORE AND AFTERS	Scantling and Sketch										
	Bearing Surface										
	Number										
	Spacing										
HATCH COVERS	Material	Steel									
	Thickness	1/4 in									
	How fitted	hinged (see sketch)									
	Bearing Surface										
Spacing of Cleats											
Number of Tarpaulins											

*Are wood fore and afters steel shod at all bearing surfaces? ☒

Are battens and wedges efficient and in good condition? ☒

Are tarpaulins in good condition and in accordance with rule requirements? ☒

Are lashings provided in accordance with rule requirements? ☒

Particulars of any special features:—

Compartment way in fore-castle fitted with hinged steel door manipulated both sides with 15" sill.

Butterworth openings 13" in diameter fitted with steel covers 5/8" thick secured by 12 studs.

Endorsement at first survey and at surveys for renewal of Certificate:—

The fittings and appliances are in accordance with the particulars shown on this form (or as now modified) and are in good condition.



© 2021

Lloyd's Register Foundation