

Lloyd's Register of Shipping.

SURVEYS FOR FREEBOARD.

NOV -4 1940

"FREE MERCHANT" (CONDITIONS OF ASSIGNMENT.)

GRK REPORT NO 21124

Ship's Name

MARIA THE SAVLIRIS
COULBEG.

Port of Survey

GREENOCK

Official Number

165992

Surveyor's Signature

Kenneth Inglis

Nationality and Port of Registry

BRITISH
British
GLASGOW
London

Date of Survey

WHILE BUILDING.

Disposition and dimensions of superstructures, trunks, deckhouses and machinery casings to be inserted in the diagrams and tabular statement:--

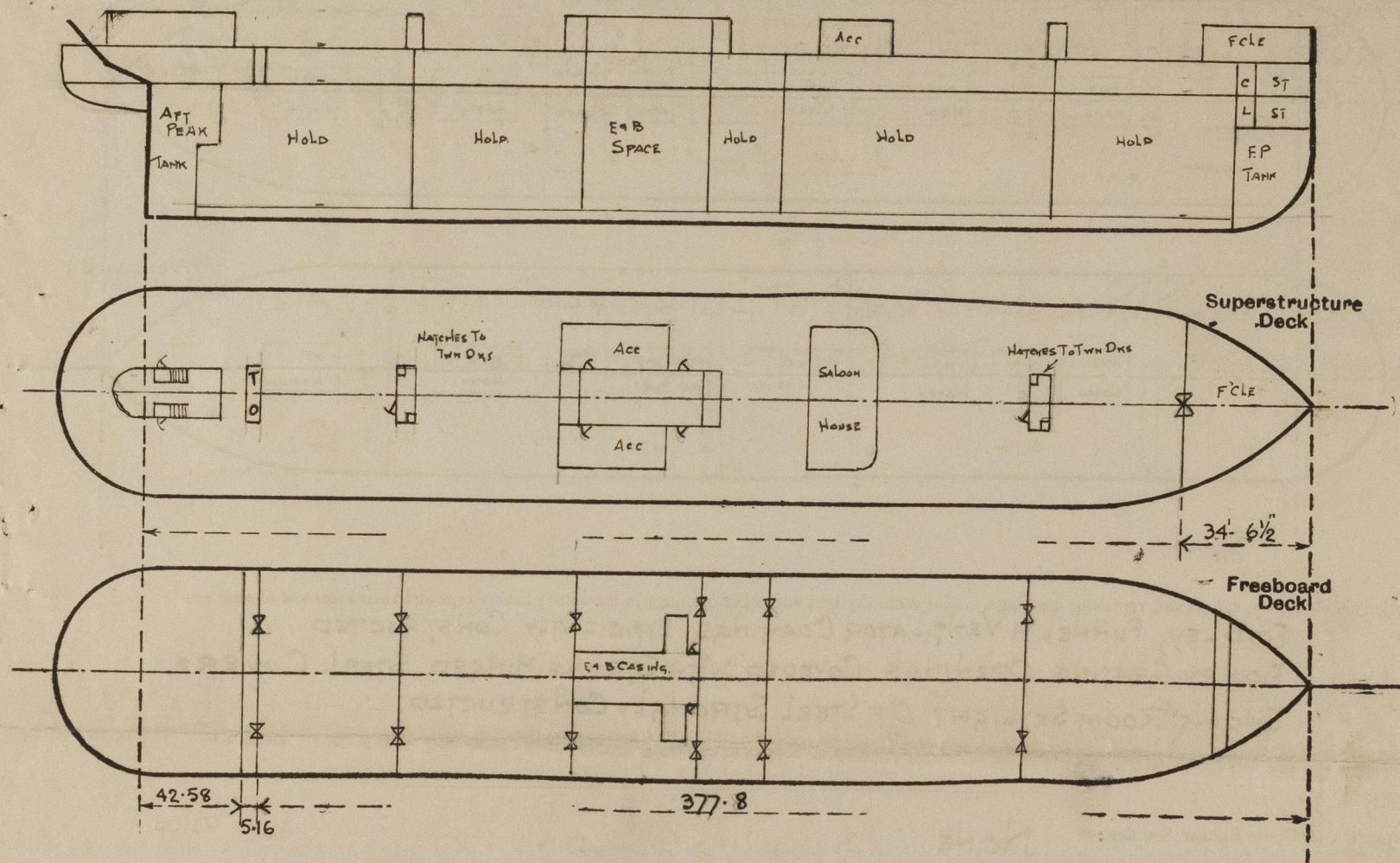

Particulars of Superstructures, Trunks, Casings, Deckhouses.

	Coaming	Plating	Stiffeners	Spacing	End Attachments of Stiffeners	Size of Openings	Height of Sills	Height of Casings
Poop Bulkhead30 ✓	.30 ✓	3½ x 3½ x .30 ✓	30" x 36" ✓	NONE ✓	NONE ✓	✓	9'-0" ✓
Raised Quarter Deck Bulkhead ...	✓							
Bridge, After Bulkhead30 ✓	.30 ✓	3½ x 3½ x .30 ✓	30" x 36" ✓	NONE ✓	2 @ 5'0" x 4'9" ✓	18	9'-0" ✓
Bridge, Forward Bulkhead ...								
Forecastle Bulkhead ON UPPER DK	.30 ✓	.30 ✓	4 x 3 x .32 ✓	26 x 31 ✓	NONE ✓	1 @ 5' x 4' ✓	18"	7'-6" ✓
Trunk, Aft ...	✓							
Trunk, Forward ...	✓							
Exposed Machinery Casings on Freeboard or Raised Quarter Decks ...	✓							
Exposed Machinery Casings on Superstructure Decks35 ✓	.32 ✓	3 x 3 x .30 ✓	23 x 27 ✓	ALT BCKS AT TOP & CONTINUOUS TO 2ND DK ✓	2 @ 5'0" x 2'3" ✓	18 ✓	8'-3" ✓
Machinery Casings within Superstructures not fitted with Class I Closing Appliances32 ✓	.32 ✓	3 x 3 x .30 ✓	23 x 27 ✓		2 @ 5'0" x 2'3" ✓	18 ✓	9'-0" ✓
Deckhouses on Flush Deck Ships ...	✓							

Particulars of Closing Appliances (state if capable of being manipulated from both sides).

Poop Bulkhead ...	NONE - No openings.
Raised Quarter Deck Bulkhead ...	✓
Bridge, After Bulkhead ...	BOLTED PLATES SECURED BY HOOK BOLTS ABOUT 15' APART, BOLTS NOT PASSING THRO' BHD. ✓
Bridge, Forward Bulkhead ...	✓
Forecastle Bulkhead ...	BOLTED PLATE SECURED BY HOOK BOLTS ABOUT 15' APART, BOLTS NOT PASSING THRO' BHD. ✓
Exposed Machinery Casings on Freeboard or Raised Quarter Decks ...	✓
Exposed Machinery Casings on Superstructure Decks ...	2. STEEL DOORS MANIPULATED FROM BOTH SIDES. ✓
Machinery Casings within Superstructures not fitted with Class I Closing Appliances ...	2 STEEL DOORS MANIPULATED FROM BOTH SIDES. ✓
Deckhouses on Flush Deck Ships ...	

The following diagrams should be used to indicate the positions of cargo and coaling hatchways, gangway, cargo and coaling ports, ventilators, companionways, etc., which would affect the seaworthiness of the ship :—

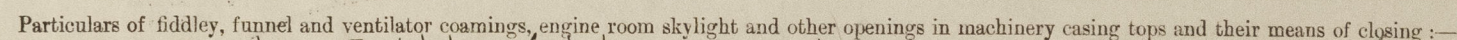

Particulars of Flush Bunker Scuttles:—

Particulars of Companionways :—

Particulars of Ventilators in exposed positions on freeboard and superstructure decks :—

Particulars of Air Pipes in exposed positions on freeboard, raised quarter, or superstructure decks:—

ALL AIR PIPES 18" HIGH &
FITTED WITH WOOD PLUGS.

Particulars of Gangway Cargo and Coaling Ports:—

Particulars of Scuppers and Sanitary Discharge Pipes :—

Particulars of Side Scuttles:—

Vertical distance of Sill of lowest Side Scuttle above top of keel

NO SIDELIGHTS BELOW FREEBOARD DK

Particulars of Guard Rails :—

Particulars of Gangways, Lifelines, etc. :—

NONE

Additional area where sheer is less than standard.

PARTICULARS OF PROTECTION TO OPENINGS, ETC.

HATCHWAYS ON FREEBOARD AND SUPERSTRUCTURE DECKS.										
SUPERSTRUCTURE DECK					FREEBOARD DECK					
Description of Hatchway	No. 1.	No. 2, 4 & 5.	No. 3. CARGO.	No. 3. COAL.	No. 1.	No. 2, 4 & 5.	No. 3. CARGO.	No. 3. COAL.		
Dimensions of Hatchway	31'-6" x 20'	31' x 20'	12'-11" x 20'	15'-6" x 20'	31'-6" x 20'	31' x 20'	15'-6" x 20'	12'-11" x 20'		
COAMINGS	Height above Deck ... 30 Thickness { Sides50 Ends46 Stiffeners ... SEE BELOW Brackets, Stays 2 1/2" DIA ENDS 3 1/2	30 .50 .46 3 1/2	30 .50 .46 1	30 .50 .46 1	9 x 3 x .40	BA COAMING.				
HATCH BEAMS	Number ... 5 Spacing ... 5-3 Scantling and Sketch ... 18 1/2 x 36 Bearing Surface ... 3	5 5-2 14 1/2 x 34 3	4-3 3/4 4 1/2 x 38 3	5-2 14 1/2 x 38 3	5-3 19 x 38 3	5-2 19 x 37 3	5-2 19 x 37 3	6-5 1/2 22 x 38 3		
FORE AND AFTERS	Number ... Spacing ... Unsupported Lengths ... Scantling and Sketch ... Bearing Surface ...	FITTED WITH NELSON ROLLER BEAMS. 9 x 3 x 44 HATCH SIDES THUS								
HATCH COVERS	Material ... W.P. Thickness ... 2 1/2 How fitted ... F4 A Bearing Surface ... 3	W.P. 2 1/2 F4 A 3	W.P. 2 1/2 F4 A 3	W.P. 2 1/2 F4 A 3	W.P. 2 1/2 F4 A 3	W.P. 2 1/2 F4 A 3	W.P. 2 1/2 F4 A 3	W.P. 3 F4 A 3		
Spacing of Cleats	24	24	24	24	24	24	24	24		
Number of Tarpaulins	2	2	2	2	1	1	1	1		
<p>*Are wood fore and afters steel shod at all bearing surfaces? YES.</p> <p>Are battens and wedges efficient and in good condition? YES.</p> <p>Are tarpaulins in good condition and in accordance with rule requirements? YES.</p> <p>Are lashings provided in accordance with rule requirements? YES.</p>										

Particulars of any special features:—

SMALL HATCHES ON SUPERSTRUCTURE DECK

Tonnage Hatch 5'-2" x 20'-0" ✓
12 x 3 1/2 x .46 BA COAMING. 2 1/2" W.P. COVERS FITTED ✓
FORE & AFT SECURED BY HEMP LASHINGS. 3" BEARING ✓
COAL HATCHES P4 S:- 15'-6" x 5'-0". COAMING 30" x .44. FITTED ✓
WITH VERT ANGLE STIFFENERS 2 1/2" W.P. COVERS. WITH ✓
3" BEARING & CLEATS & 2 TARPAILINS. ✓
HATCHES UNDER FORECASTLE: - 4'-0" x 3'-0" TO STORE ✓
2'-6" x 2'-0" TO CHAIN LOCKER ✓
COAMING 9 x 3 1/2 x .44 BA. 2 1/2" W.P. COVERS CLEATS 24" APART ✓
& ONE TARPAILIN. ✓
HATCH ON FORECASTLE DECK 3'-0" x 2'-6" COAMING 24 x .40 ✓
2 1/2" W.P. COVERS, CLEATS 2 TARPAILINS. ✓
COAL SHOOT HATCH ON BOAT DECK 18'-0" x 5'-2" ✓
COAMING 12" x .50 2 1/2" W.P. COVERS, CLEATS 2 TARPAILINS. ✓
ESCAPE HATCHES INSIDE FORECAST HOUSES 4 @ 2'-6" x 2'-0". COAMING 9 x 3 x .40 BA ✓
& 2 1/2" W.P. COVERS. ✓

Endorsement at first survey and at surveys for renewal of Certificate:—

The fittings and appliances are in accordance with the particulars shown on this form (or as now modified) and are in good condition.

SMALL HATCHES ON FREEBOARD DECK

TONNAGE WELL 10'-0" x 4'-8" ✓
TRIMMING HATCHES 10 @ 2'-6" x 2'-0" ✓
10 @ 2'-6" x 2'-6" ✓
ACCESS HATCHES 8 @ 2'-6" x 2'-0" ✓
COAMING 9 x 3 1/2 x .44 BA ✓
COVERS 2 1/2" WOOD ✓
CLEATS 24" MAX SPACING. ✓
FITTED WITH ONE TARPAILIN. ✓



© 2021

Lloyd's Register
Foundation