

22 FEB 1945

Index No. 37893
(For London Office only).

Lloyd's Register of Shipping.

SURVEYS FOR FREEBOARD.

(CONDITIONS OF ASSIGNMENT.)

Ship's Name S. S. "ASHBY PARK"Port of Survey PICTOU, N. S. CANADAOfficial Number 175620Surveyor's Signature Jas. H. NainNationality and Port of Registry CANADIAN, MONTREALDate of Survey During construction

Disposition and dimensions of superstructures, trunks, deckhouses and machinery casings to be inserted in the diagrams and tabular statement: --

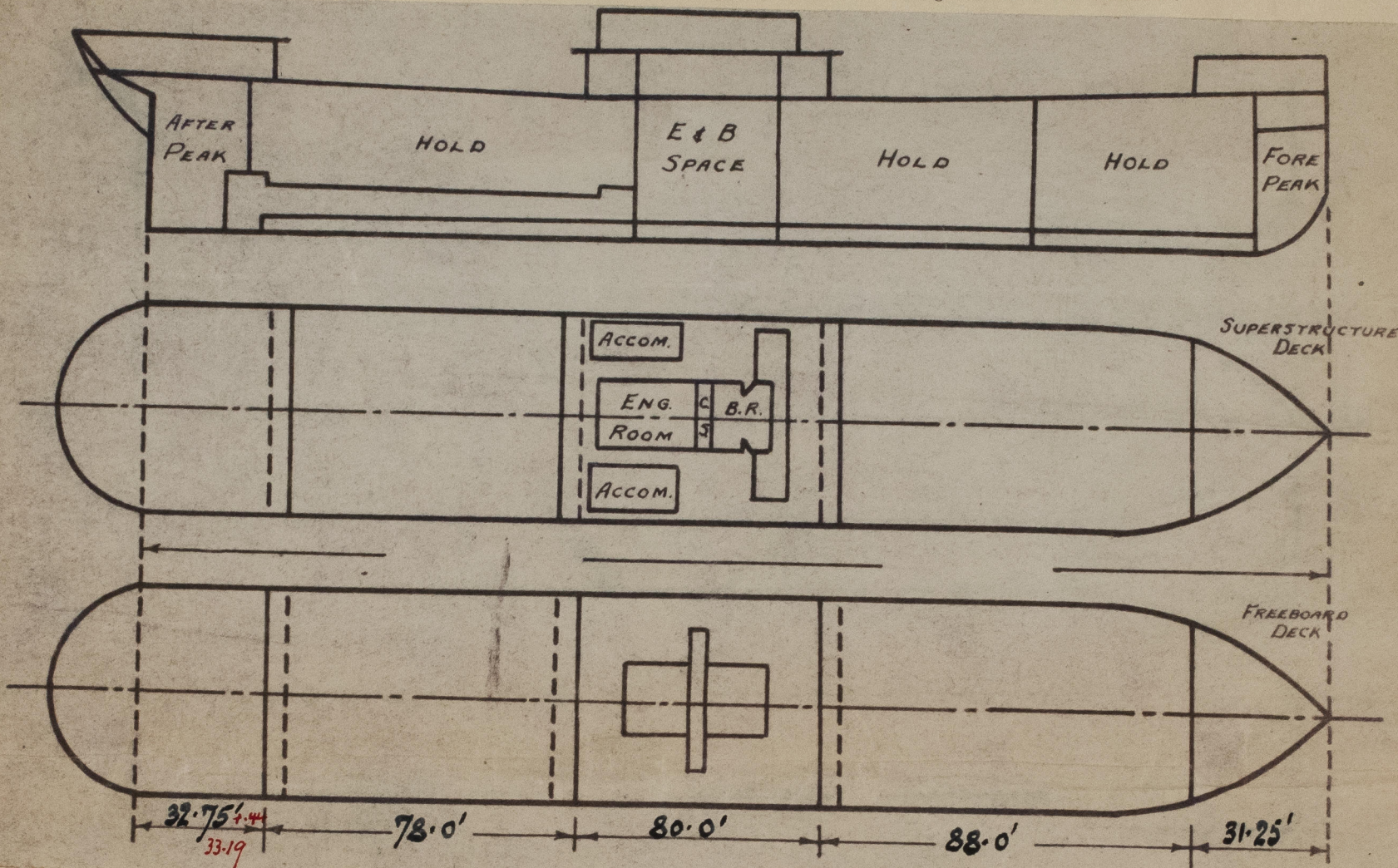

Particulars of Superstructures, Trunks, Casings, Deckhouses.

	Coaming	Plating	Stiffeners	Spacing	End Attachments of Stiffeners	Size of Openings	Height of Sills	Height of Casings
Poop Bulkhead	--	.33	5x3x3/8 O.A.	Not exceed- ing 33"	Lugs top bot.	None	--	7' 6"
Raised Quarter Deck Bulkhead ...								
Bridge, After Bulkhead	--	.375	4x3x5/16 O.A. & Div. Bhds.	Average 2' 4 1/2"	Ends of stfrs. takes rivet in bdry. angle	5'0"x2'6" 4'0"x3'0"	18"	9' 0"
Bridge, Forward Bulkhead	--	.375	8x3 1/2 x .35 B.A.	do	Lugs top and bot.	4'9"x2'10 1/2"	21"	9' 0"
Forecastle Bulkhead	--	.27	4x3x5/16 O.A. & Div. Bhds.	2'3" to 3'6"	Ends of stfrs. rivet in bdry. angle.	5'1"x3'1" 4'0"x2'0"	18"	7' 0"
Trunk, Aft								
Trunk, Forward								
Exposed Machinery Casings on Free- board or Raised Quarter Decks ...		--	None	----				
Exposed Machinery Casings on Super- structure Decks	18"x.34"	.30"	3x2 1/2 x 5/16 O.A.	2' 0"	Bkt. at top Two rivets through dk. beams.	5'0" x 2'0"	18"	7' 4"
Machinery Casings within Superstruc- tures not fitted with Class I Closing Appliances	18"x.30"	.25"	- do -	- do -		- do -	- do -	9' 0"
Deckhouses on Flush Deck Ships ...								

Particulars of Closing Appliances (state if capable of being manipulated from both sides).

Poop Bulkhead	No openings.
Raised Quarter Deck Bulkhead ...	
Bridge, After Bulkhead	Portable steel plates with hook bolts and hinged steel doors, manipulated from both sides.
Bridge, Forward Bulkhead	Hinged steel W.T. doors manipulated from both sides.
Forecastle Bulkhead	Portable steel plates with hook bolts and hinged steel doors, manipulated from both sides.
Exposed Machinery Casings on Free- board or Raised Quarter Decks ...	None
Exposed Machinery Casings on Super- structure Decks	Hinged steel doors, manipulated from both sides.
Machinery Casings within Superstruc- tures not fitted with Class I Closing Appliances	Hinged steel doors, manipulated from both sides.
Deckhouses on Flush Deck Ships ...	



© 2021

Lloyd's Register
Foundation

011646-01656-5178 1/2

Ashby Park.

Hand-drawn technical drawings of a ship's hull and deck plans. The top drawing is a side elevation showing the hull structure with sections labeled N°1, N°2, N°3, N°4, and N°2A, along with hatch covers and scupper (Sc) locations. The middle drawing is a plan view of the SUPERSTRUCTURE DECK, showing the layout of the hull, derrick posts, and various structural elements like S.N.V., V, and E.R. The bottom drawing is a plan view of the FREEBOARD DECK, showing the layout of the hull, derrick posts, and various structural elements like S.C., V, and E.R. The drawings are labeled with dimensions and structural details.

Fiddley openings closed by hinged steel covers. /

(Closing appliances for Air Pipes - Wood Plugs secured by chains to pipes) ✓

Fittings provided at ends of poop, bridge and forecastle decks and life lines rigged.

Additional area where sheer is less than standard.

PARTICULARS OF PROTECTION TO OPENINGS, ETC.

HATCHWAYS ON FREEBOARD AND SUPERSTRUCTURE DECK.											
FREEBOARD DECK											
Description of Hatchway	NO.1	NO.2	NO.3	NO.2A	Access to Holds	Inside Fo'c'sle	Inside Bridge	No.2A Br.Dk.	Coaling Hatchway	Hatchway on Poop	Hatchway on Casing Top
Dimensions of Hatchway	32' x 22'	30' x 22'	32' x 24'	10' x 24'	42' 6" x 2' 6"	4' x 3'	6' x 3'	6' 4" x 16' 0"	12' x 3'	3' 6" x 3' 0"	6' x 12' 6"
COAMINGS	Height above Deck ... Thickness ... Stiffeners <u>RULE ANGLE</u> ... Brackets, Stays ...	31-1/2'50 ... 9x3 1/2 x .48 ... 2" dia. 3' ...	31-1/2'50 ... 9x3 1/2 x .48 ... 2" dia. 3' ...	9x3 1/2 x .44 BA ...	31" ...	9x3 1/2 x .44 BA ...	9x3 1/2 x .44 BA ...	31 .44 ... 7x3x.38 on For. End.	31 .44 ... 3x3x3/8 Vertical	18 .38 ...	8x3 1/2 x .34 BA ...
HATCH BEAMS	Number ... Spacing ... Scantling and Sketch ... Bearing Surface ...	5' 4" ... 5' 0" ... Pl. 20" x .35 ... 4 Angles 5x3 1/2 x .44 ...	5' 4" ... 5' 4" ... Pl. 20" x .38 ... 4 Angles 5x3 x .50 ...	5' 0" ... Pl. 17x .35 ... 4 Angles 5x3 1/2 x .50 ... 4-3/8"	None	None	None	None	None	None	None
FORE AND AFTERS	Number ... Spacing ... Unsupported Lengths ... Scantling* and Sketch ... Bearing Surface ...				None						
HATCH COVERS	Material ... Thickness ... How fitted ... Bearing Surface ...	SPRUCE ... 2-1/2 ... F & A ... 5" x 4"	SPRUCE ... 2-1/2 ... F & A ... 5" x 4"	SPRUCE ... 2-1/2 ... F & A ... 5" x 3"	SPRUCE ... 2-1/2 ... P & S ... 2-1/2	SPRUCE ... 2-1/2 ... P & S ... 2-1/2	SPRUCE ... 2-1/2 ... F & A ... 2-1/2	SPRUCE ... 3" ... F & A ... 3"	SPRUCE ... 2-1/2 ... P & S ... 2-1/2	Hinged Steel W.T. cover & fastening	SPRUCE ... 2-1/2 ... F & A ... 3"
Spacing of Cleats	23-1/2	23-1/2	21	24x19	19	21	19	22	-	20	
Number of Tarpaulins	2	2	1	2	1	1	2	2	-	2	
<p>*Are wood fore and afters steel shod at all bearing surfaces? No fore and afters.</p> <p>Are battens and wedges efficient and in good condition? Yes</p> <p>Are tarpaulins in good condition and in accordance with rule requirements? Yes</p> <p>Are lashings provided in accordance with rule requirements? Ring bolts fitted on side coamings of exposed cargo hatches and all exposed hatches fitted with locking bars.</p>											

Particulars of any special features:— Timber Load Line: ✓

Fo'c'sle - length 31.25 ft. Height - 7' 0" Poop Height - 7' 9" with Deckhouse enclosing Steering Engine. ✓

Machinery casing on Freeboard Deck inside Bridge Space - height 9' 0". ✓

Double bottom tanks fitted within half length of vessel have centre girder unpierced except in way of dry tank under boilers where centre girder has limber holes. ✓

Bulwark fitted in after and forward wells with top rail and stays to deck; freeing ports provided. ✓

Timber sockets for uprights provided on Upper Deck and Bulwark rail in accordance with load line rules. ✓

eye plates provided for lashings and riveted to sheerstrake in accordance with load line rule Clause 91. ✓

Alternative steering arrangement by blocks and wires. ✓

Endorsement at first survey and at surveys for renewal of Certificate:—

The fittings and appliances are in accordance with the particulars shown on this form (or as now modified) and are in good condition.



© 2021

Lloyd's Register Foundation