

LLOYD'S REGISTER OF SHIPPING

ALTERATIONS TO CONDITIONS OF ASSIGNMENT OF LOADLINES

Ship's Name " CINDERALLA ".

Official No. —

Port of Registry Monrovia.

This ship has been under survey at Antwerp.

on February 1958 and the following alterations to the conditions of assignment of loadlines have now been effected/~~found~~:

DECK DOUBLER.

A doubling plate has been fitted on the freeboard deck p&s.

24" wide by .60" thick from fr.61. to fr.86.,

24" x .50" from fr.46 to fr.61 and fr.86 to fr.130,

Doubler riveted to deck and butts welded.

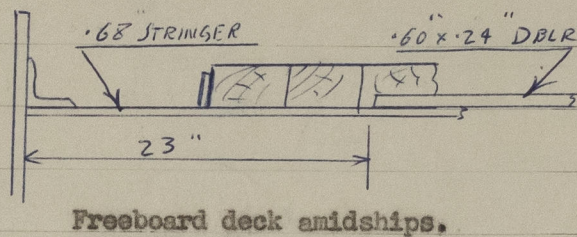
SIDE FRAMES.

Side frames 74, 77, 81 and 83 p&s in Engine Room reinforced with 4 x .50 flats.

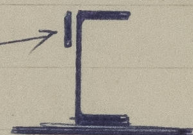

Side frames in tween deck fitted with 3 1/2" x 3 1/2" x .50" reverse bars, forming a 6" deep section, at frames 145 to 166, and at alternate frames from frame 140 to frame 9. Reverse bars efficiently connected at ends.

HATCH WEBS.

Nº. 2, 3, 4 & 5 freeboard deck hatch beams modified, with

18" x .36" web, 4" x 3" x .44" bottom angles and

4 x 3 x .50 top angles, as shown on sketch.

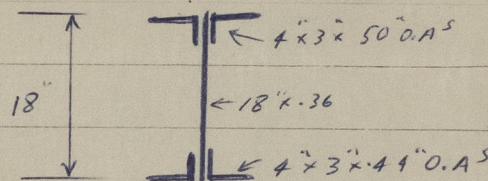
TONNAGE HATCH.

Coaming removed and opening blanked off with .40 plating, 7" x 3 1/2" x .35" B.A. beams and centreline girder 9" x .40 with 3" flange.

LIFELINES.

Supplied for fitting from forecastle to bridge and bridge to aft deckhouse with fittings p&s.

R. Parker

Antwerp

February 1958

R. PARKER.

Antwerp.

February 1958.

A copy of this Report has been placed on board.