

PROPOSED MOTOR SHIP

SINGLE SCREW CARGO VESSEL

TO BE BUILT FOR

THE NORTH COAST S. NAV. CO. LTD.

— SYDNEY, N.S.W. —

DIMENSIONS

LENGTH B.P. 215 F.
BREADTH MLD. 32 F.
DEPTH MLD. 13 F.
HEIGHT OF RAISED DECK 4 F.

SCALE 1/8" = 1 FOOT

JANUARY, 1933



89 APR 1933

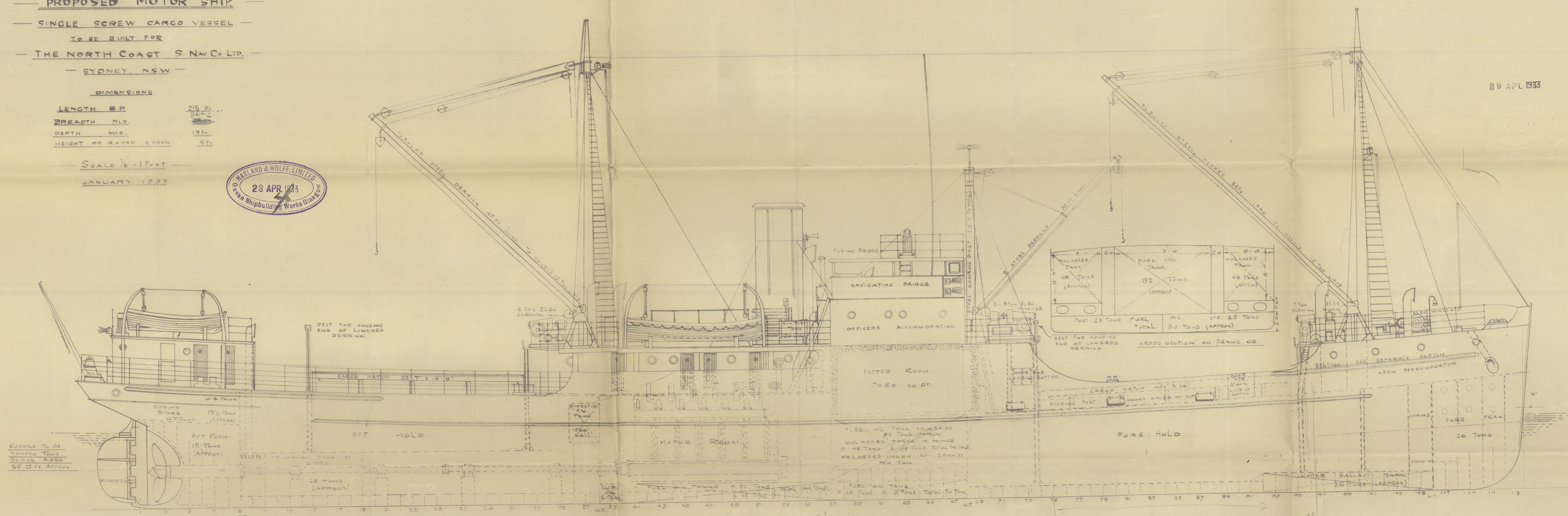

PROFILE

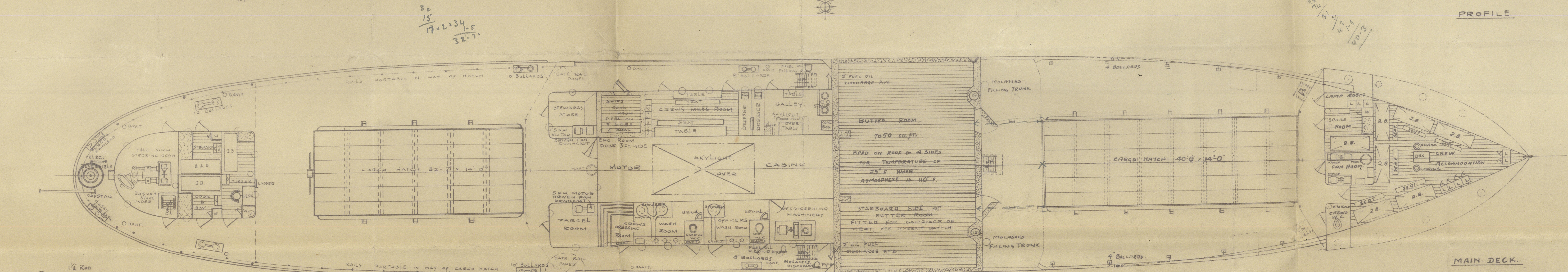

MAIN DECK

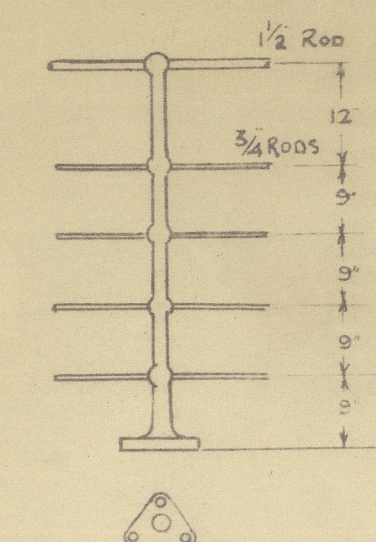

DETAIL OF ROD SPACING IN QUARTER DECK RAILS

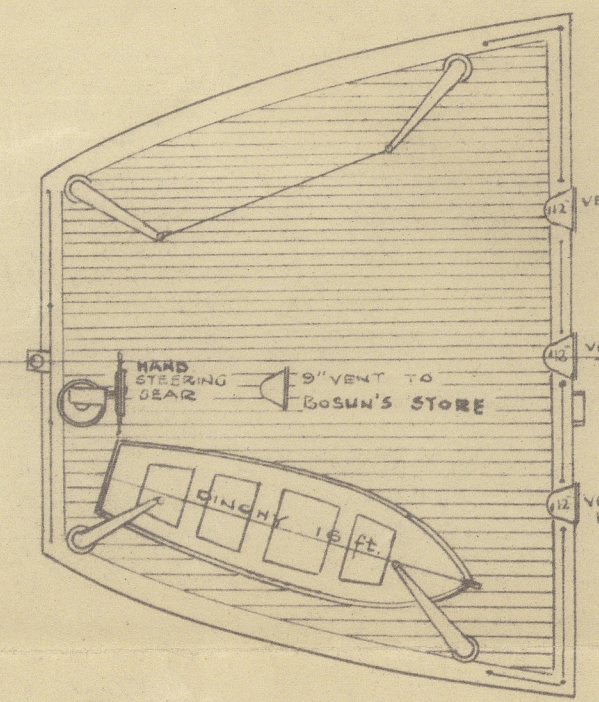

AFT BOAT DECK

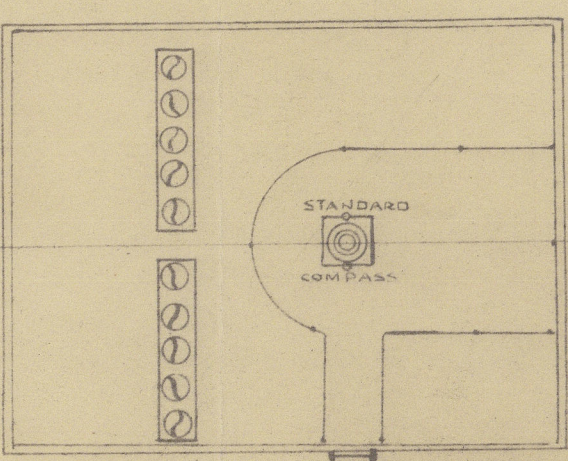

FLYING BRIDGE

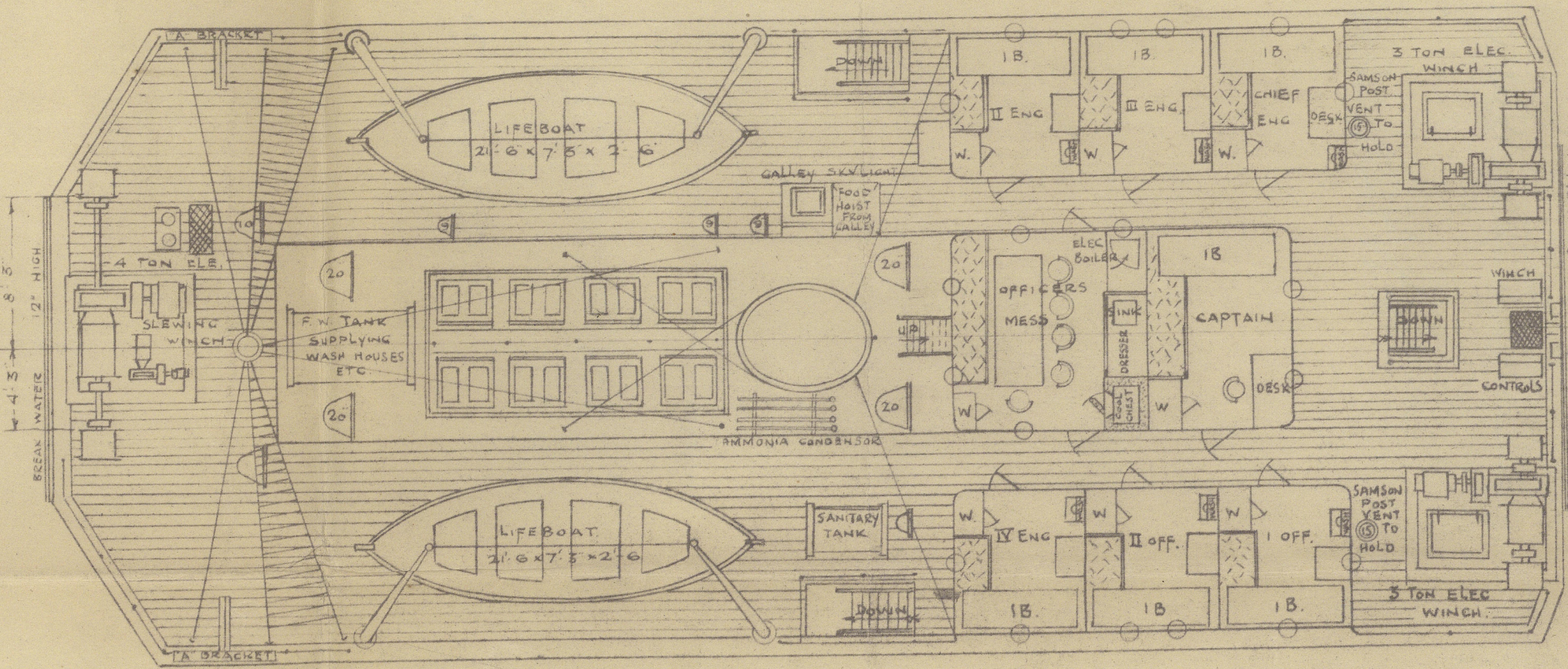

BOAT DECK

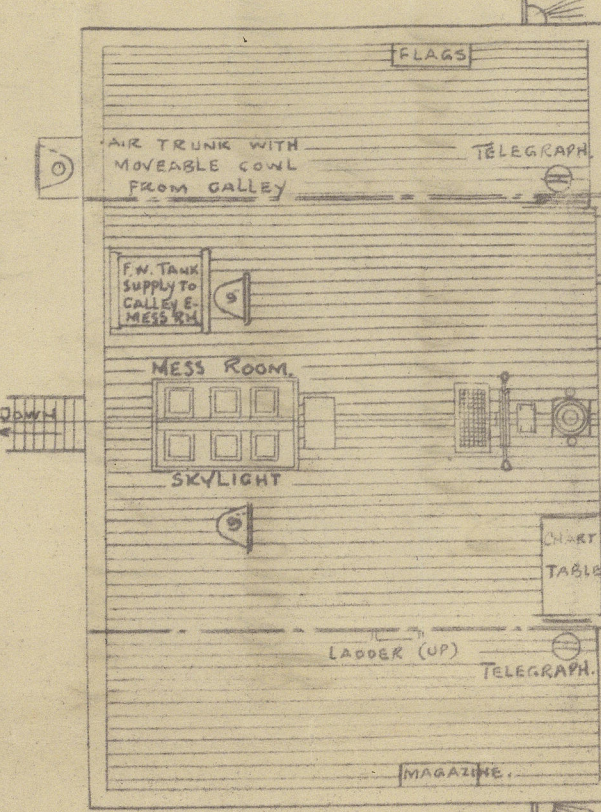

NAV. BRIDGE

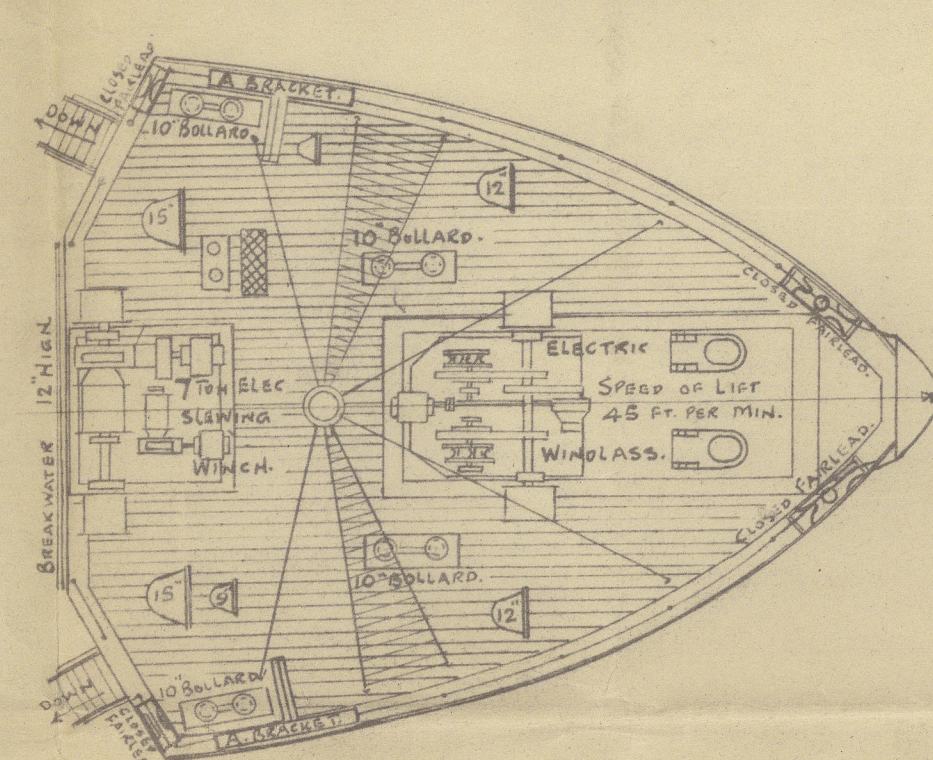

FORECASTLE DECK

General Agent.

Harland Wolff. Prop. Ship for North
Coast S.M. Co. 215' x 26' 6" x 12'. [REF
NIMBIN]

Bk. Sect. appd. 2.5.22.

Now Burmeister Wain No. 609.

S^r M WYRALLAH

© 2021 Lloyd's Register
Foundation

