

lower dk.
Unión de reversos a Cta Baja.

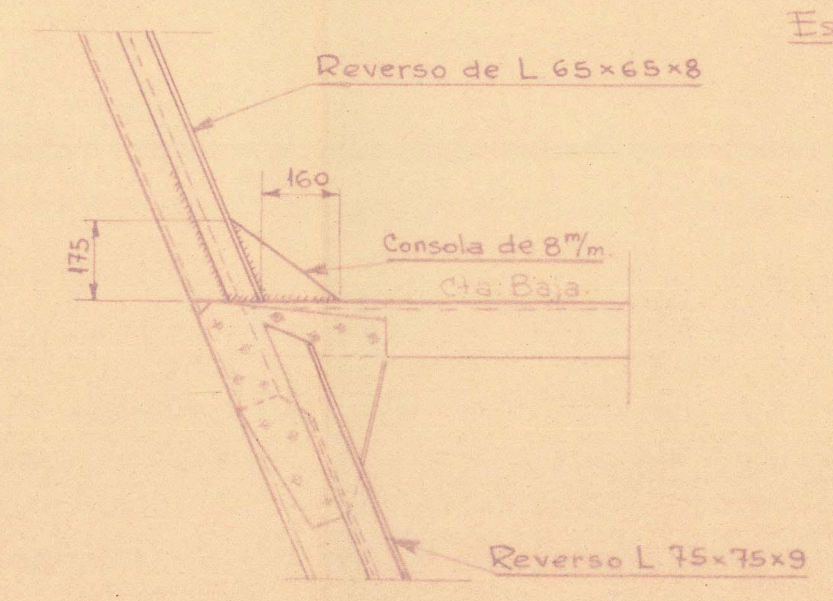

connection of reverse frames at D.B.
Unión de reversos al Doble Fondo.

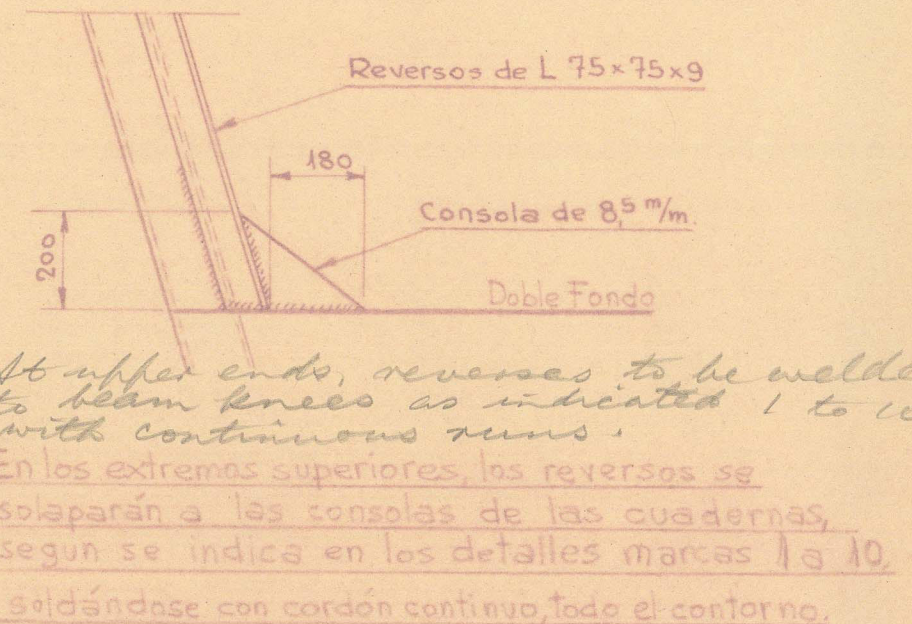

alteration from bulbar to web frame.
Detalle "A" (Transformación del actual mamparo 31 en bularcama)

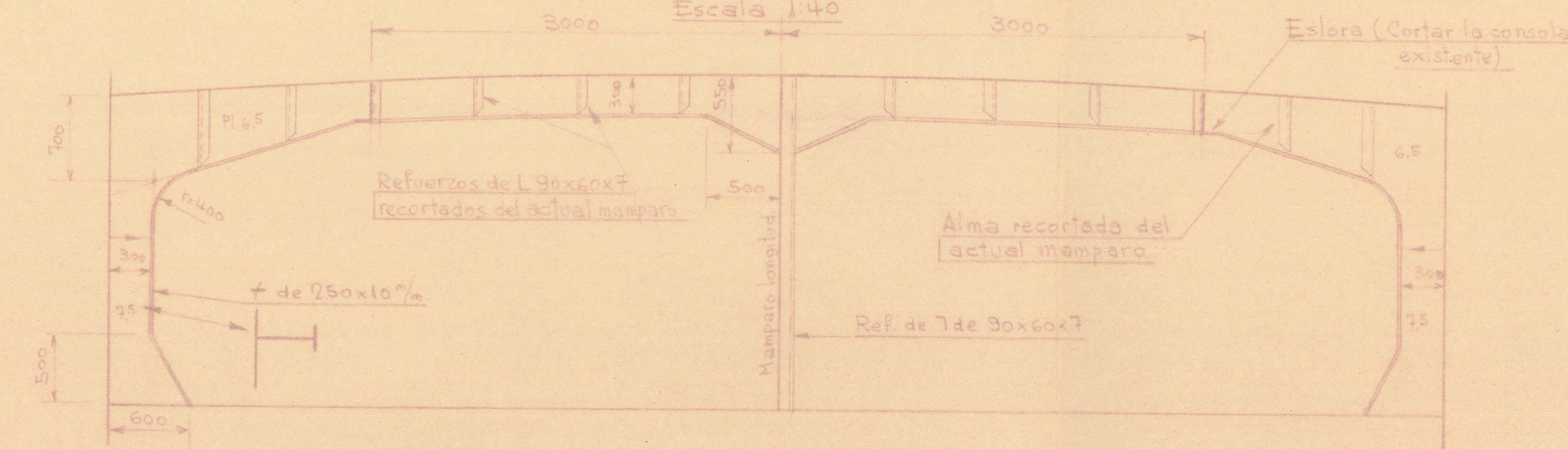

Unión de reversos en Ctas Principales mani dk
Escala 1:15

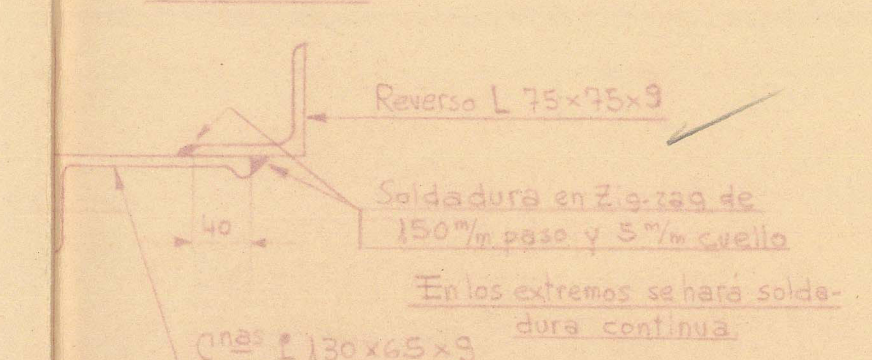

lower dk.
Unión de reversos a Ctas Entrepunte

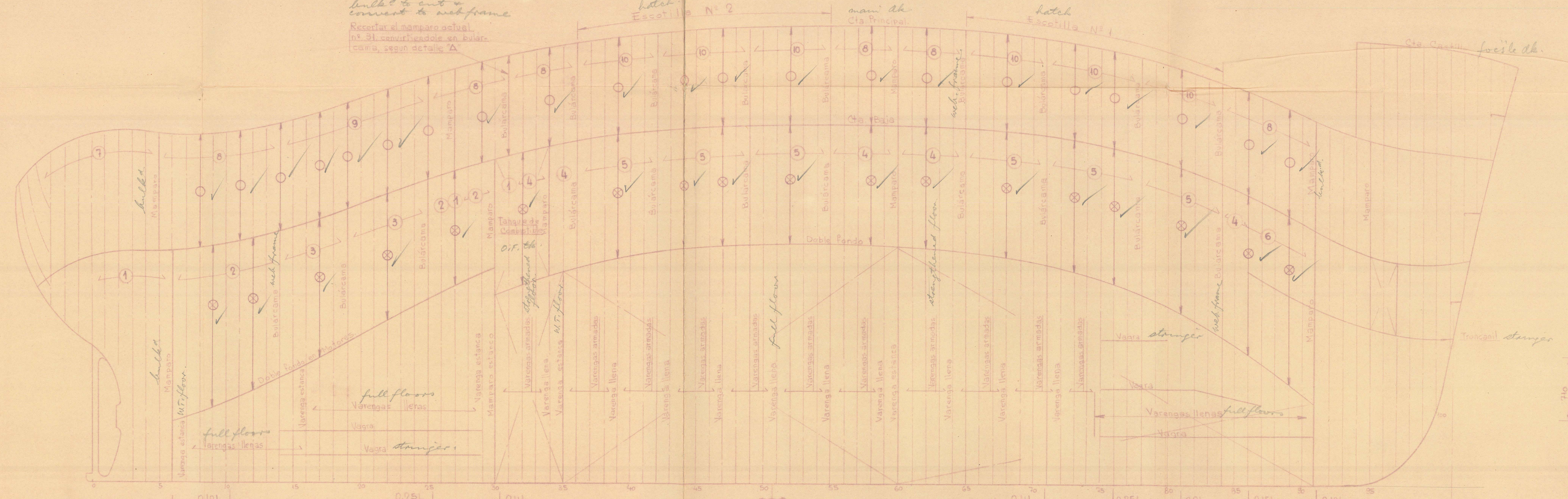
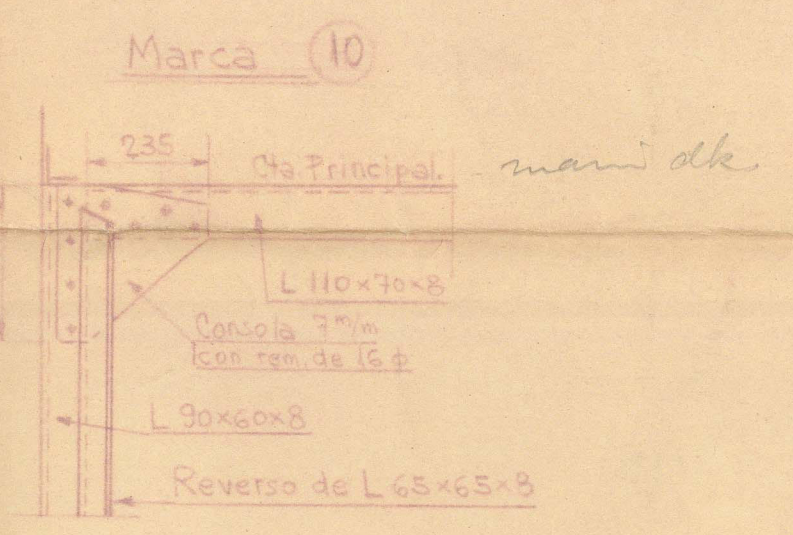
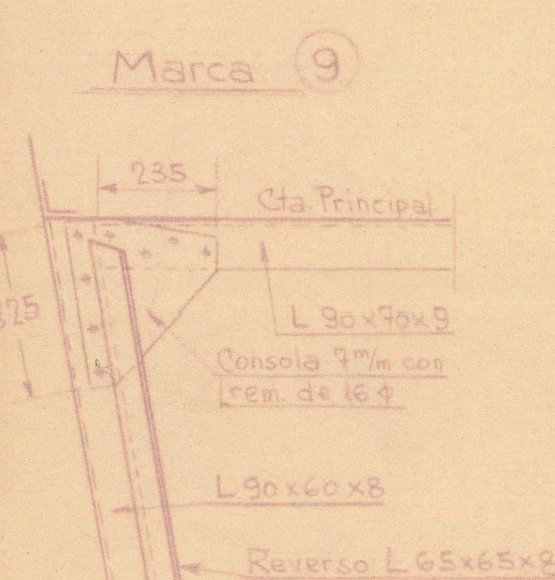
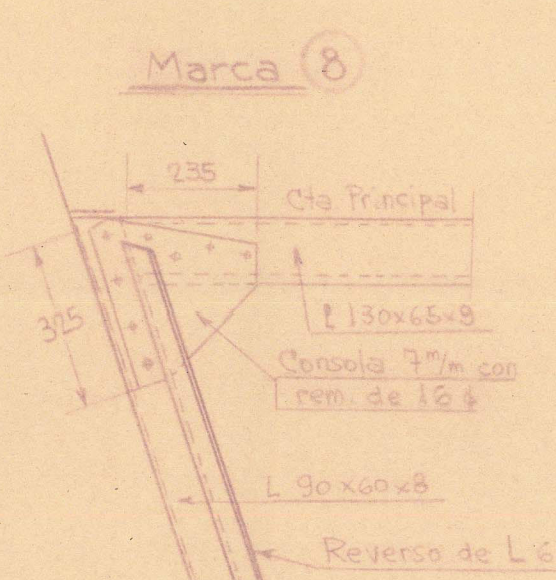
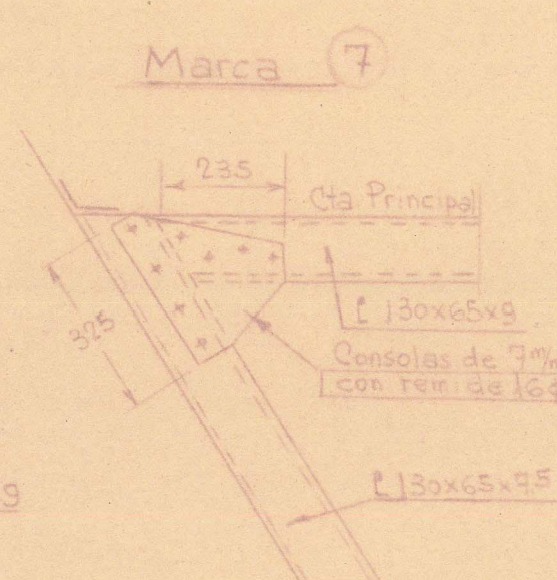
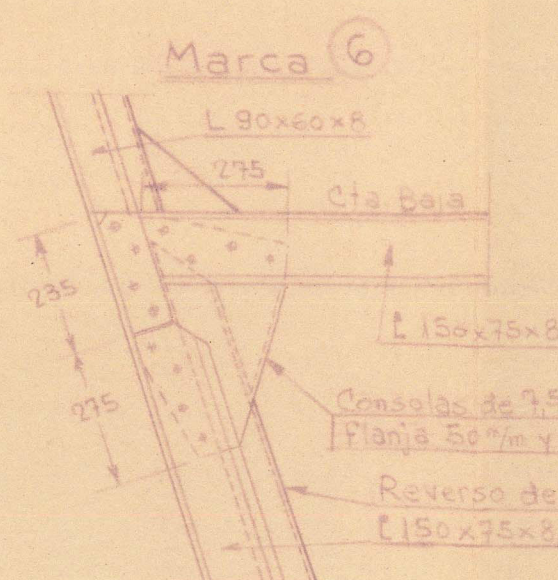
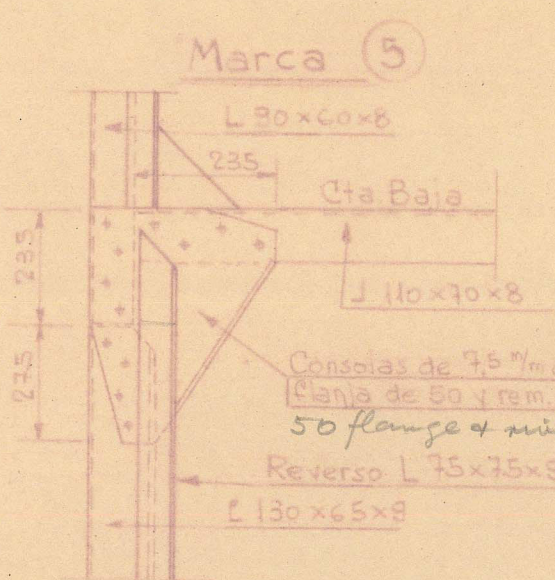
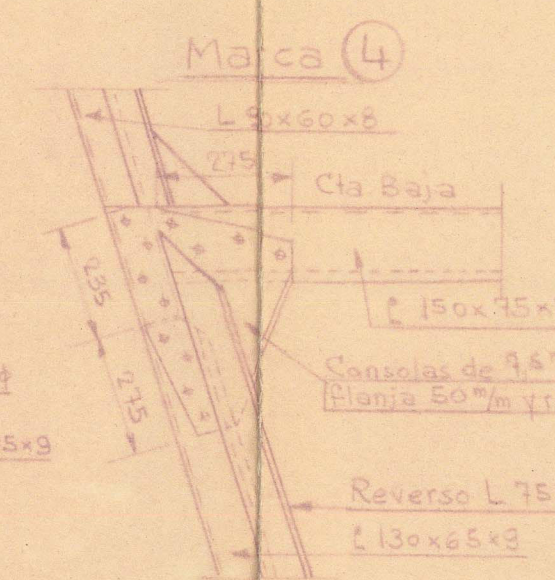
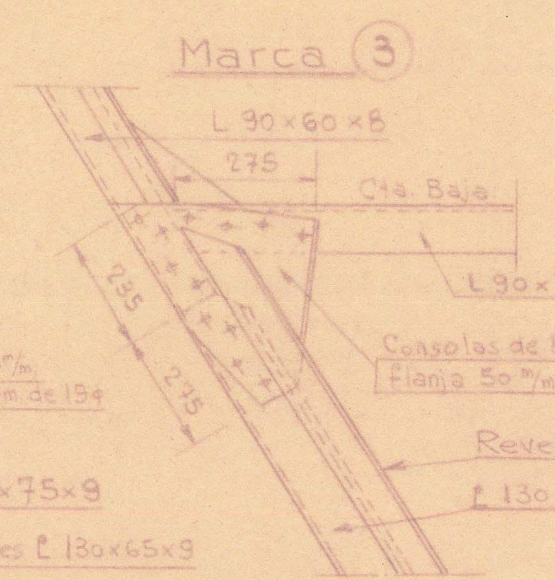
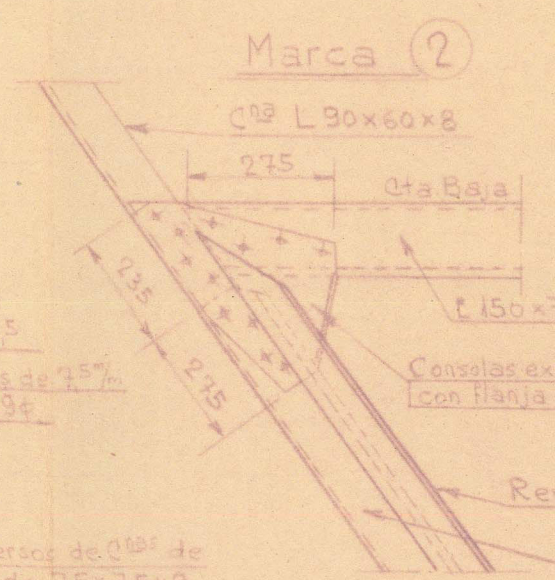
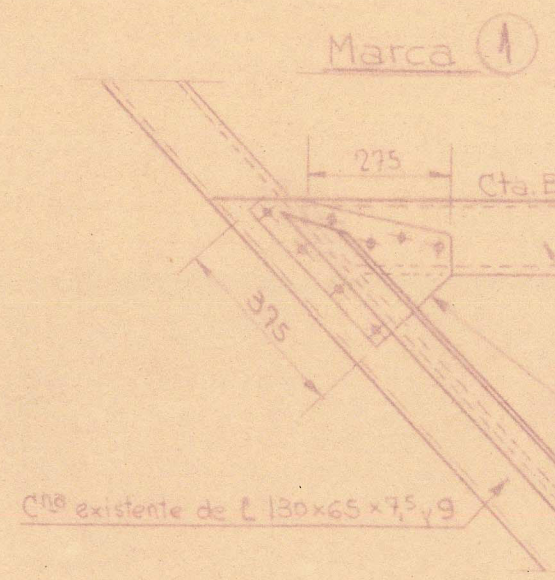
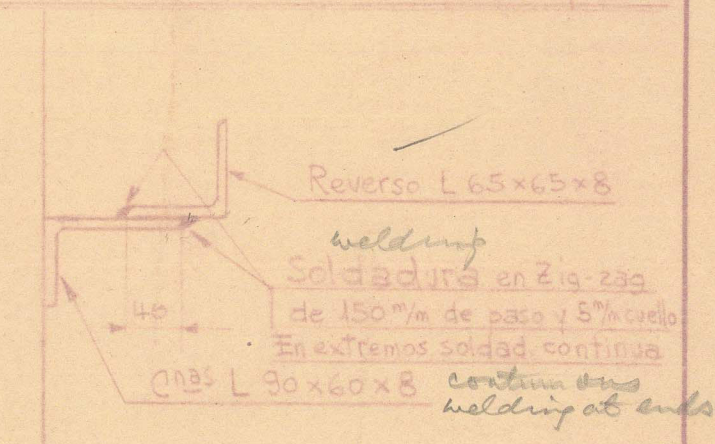

Strengthening of floors
Reforzado de varengas armadas

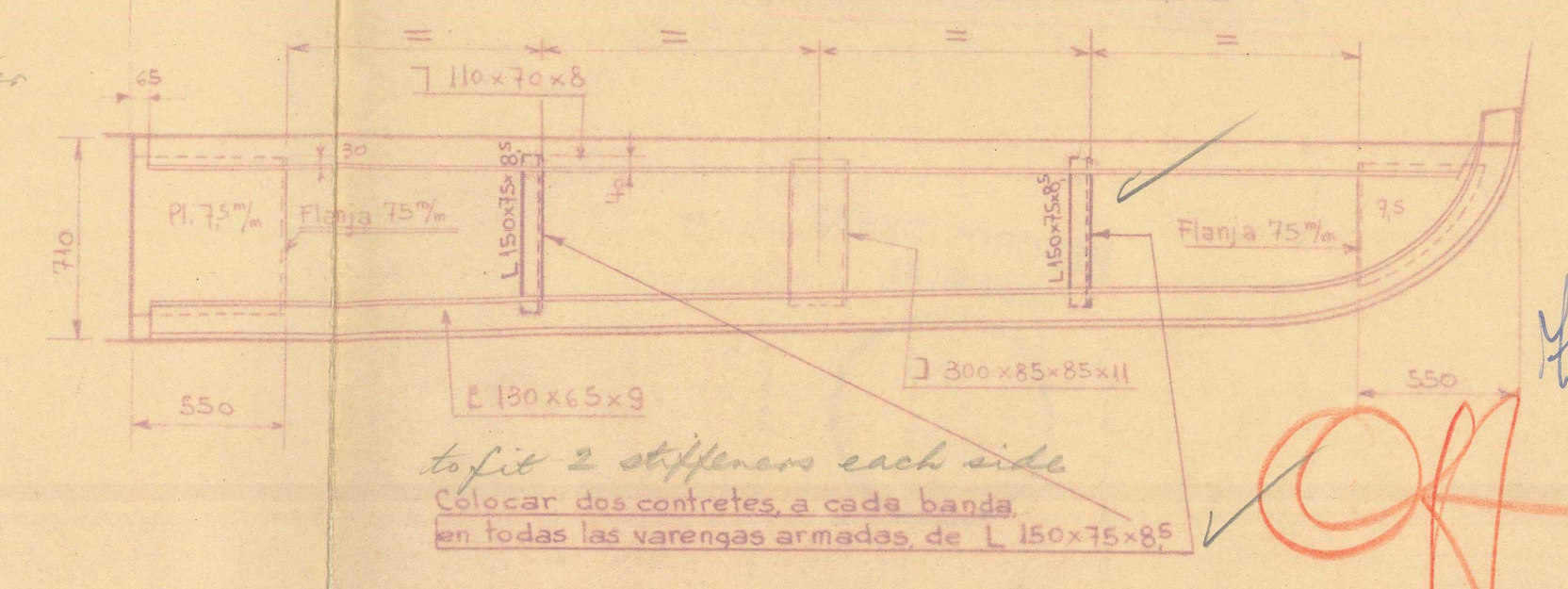

STRENGTHENING OF FRAMES & FLOORS.
ALTERATION FROM CLOSED TO OPEN
SHELTER DECK.

CORCHO HIJOS, S. A.			
PROYECTO	Nº	FECHA	REVISADO
1	A49	15/11/88	15/11/88
Reforzado de cuadernas y de varengas armadas.			
Referencia: Proyecto: Fecha:			
Reforma de la Construcción Nº 45			

reinforce all main frames marked X with reverse angles 75x75x9. Reinforce transverse frames marked O with reverse frames of 65x65x8.
Reforzar todas las cuadernas principales, marcadas X, colocando reversos de L de 75x75x9 - Reforzar las cuadernas de Entrepunte, marcadas O, colocando reversos de L de 65x65x8.

Escala: horizontal 1:100; vertical 1:50

Características del buque	
Longitud entre p.p.	60,75mts
Manga	9,75 "
Puntal	5,45 "
Calado actual	3,55mts
Calado después de transformado	4,15 "

SS/MS " SAN FLORO "	
TO ACCOMPANY... Bks	Rpt. No. 12458
Dated... 26/11/58	
SUBJECT:- Strengthening of frames & floors CSD - CSD	

2 dks

RECORDS DEPT.
LONDON.

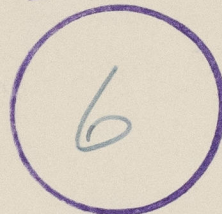

© 2021

Lloyd's Register
Foundation

011421-011426-0045