

**CRUISER STERN:-** 7.1.36.  
 FRAMES 4" x 3" x 40" SPACED 21" APART  
 FORE & AFT RUNNER INTERC. TO DECK 38" x 28" x 38"  
 ANGLE 8" x 30" INTERC. PLATE 4" WEB PLATES FORE  
 SIDE OF N°1 BHD 40" THICK WITH 3" x 3" x 38" FACE ANGLE.  
 16 FLOOR PLATES 38" x 38" x 34" ON FLOOR TOPS.  
 INTERCOSTALS 30" 4" HORIZONTAL FRAMES 4" x 3" x 40" BKT TO WEB  
 WEB FRAME ON E FRAME 30" x 12"  
 CENTRE WASH PLATE 26" 18" x 14" MANHOLES IN  
 WASH PLATE & BULKHEADS FOR ACCESS.  
 CRUISER STERN BEAMS 5" x 3" x 40"

O.T. STEEL BULKHEAD N°1 FRAME  
 PLATING 30" SINGLE FRAME & BEAM 4 1/2" x 4 1/2" x 40"  
 DOUBLE RIVETED BOTH FLANGES. SINGLE  
 VERTICAL STIFFENERS 4 1/2" x 3" x 30" SPACED 24" APART  
 CLEAR OF WEB PLATES ON FORE SIDE. B.A. HORIZON. STIFFENERS ON AFT SIDE 6" x 3" x 34"  
 RUDDER TRUNK ON AFT SIDE  
 N°1 W.T. STEEL BULKHEADS ON B & d FRAMES  
 PLATING 26" SINGLE FRAME 3" x 3" x 40" BEAM 5" x 3" x 40"  
 SINGLE RIVETED BOTH FLANGES. SINGLE VERT  
 STIFFENERS 3" x 3" x 30" SPACED 30" APART

C.L.O. TANK AT FORE  
 END OF CABIN.

**PROFILE AND DECK**  
**N° 611 SHIP.**  
**DIM:- 165'-0" B.P. x 27'-6" B.MLD x 15'-0" DEPTH MLD.**  
**SCALE 1/4" = 1 FOOT.**  
**COOK WELTON & GEMMELL, L.T.P.**  
**SHIPBUILDERS.**  
**BEVERLEY**

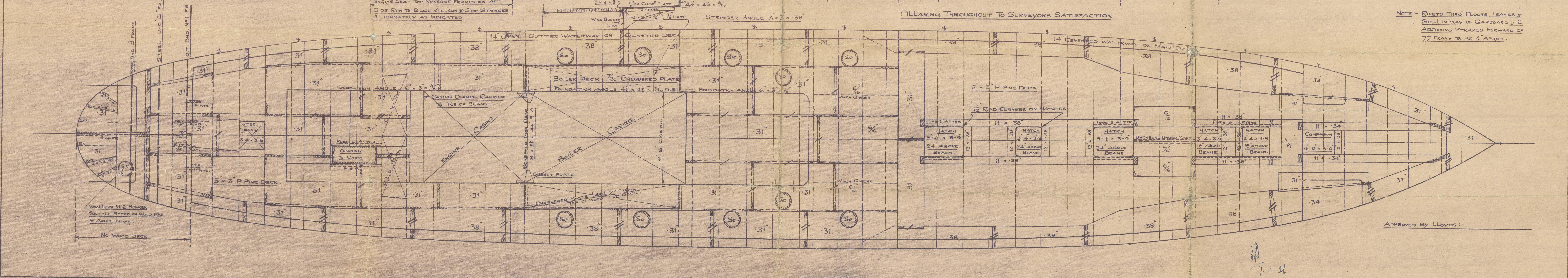
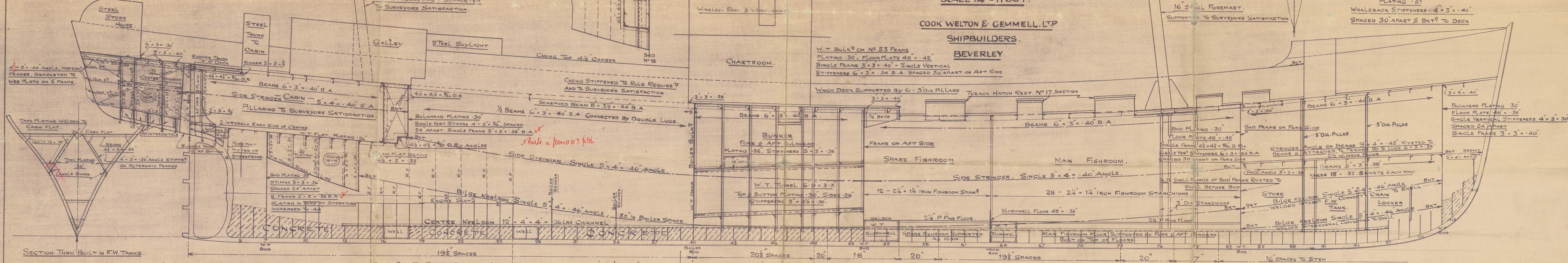

NOTE:- RIVETS THRO FLOORS, FRAMES &  
 SHELL IN WAY OF GARGARD & 2  
 ADJOINING STRAKES FORWARD OF  
 77 FRAME TO BE 4" APART.

Approved By Lloyds:-



COOK WELTON & GEMMELL LTD

YARD No. 611

PROFILE & DECK

S.S.

"Cape

Camerin"

HULL REPORT NO.

46829.



© 2021

Lloyd's Register  
Foundation

011397-011407-0242