

Rpt. 8

Port Lagos.

No. 2371.

Date of writing Report 29/12/59.

When handed in at Local Office 30-12-59.

Received London

Survey held at Burutu.

No. of Visits

First Date 23 -11 - 19 59.

Last Date 24 - 11 - 19 59.

8 JAN 1960

REPORT OF SHIP SURVEYS AND REPAIRS

The Surveyor's attention is drawn to the relevant requirements of Chapters B & C of the Rules.)

No. in R.B.

74710

on the Iron or Steel

S.S.

"PEGASUS 2, 3, 5, 6, 7 & 8

No.2 95

Nos.35 & 6 100

No.7 110

No.8 Tons gross 99

Year Month

When 1951 12

Built at Wallsend On Tyne

By Whom Clelands Successors Ltd.

Owners Mobil Oil Nigeria Ltd.

Owners' address

(If not already in R.B.)

Managers

Port of Registry Lagos.

Surveyed Afloat or in Drydock Both.

Name of Dock Burutu.

Date of last examn. in Drydock

N.B.—Any alterations in existing particulars in the Register Book should be reported and underlined.

Last Report: No.

Port

To be filled in at Head Office.

Particulars of Classification (which must be inserted precisely as in Register Book and Supplement)

Surveys must be reported in the terms of the Rules. The nature and extent of Examinations and Repairs (if any) must be stated in detail, the parts examined and their condition being clearly indicated. For Annual, Special or other Condition Surveys the Summary of Examination and Condition on the back of the Report is to be carefully completed and amplified if necessary in the body of the Report. Outstanding items to complete the Survey should be summarised at the end of the Report. The reasons for Repairs must be stated. Repairs on account of Damage (the alleged cause of which must be stated) should be separated from Repairs due to other causes, and, besides being detailed in the body of the Report, should be summarised in the form below. When, at a Special Survey, the Shell and Deck Plating is drilled the results must be reported on Report 8(Dr). Whenever Anchors or Chain Cables are replaced or retested the necessary particulars are to be given on Report 8(Eq) which is to be attached to this Report.

Give dates and references to any letters relating to this Report

In damage cases where the Surveyor has not made a special damage report he should state whether he offered

his services for this purpose and to whom and why they were declined

None

Freeboard as marked on ship and now

No.2

Nos.3,5&6

Nos.7 & 8

1 ft.

1 ft.

1 ft.

1 3/4

3 1/2

2 3/4

Was a damage report made by anyone else? If so, by whom?

EXAMINATION AND REPAIRS AS PER RULE FOR Docking, Annual Load Line Survey.

Wear & Tear Repairs.

Pegasus 2. 2 mooring bollard stools and deck doubling plates in way renewed.

Pegasus 6. 3 mooring bollard stools and deck doubling plates in way renewed.

Pegasus 7. 1 mooring bollard stool and deck doubling plate in way renewed.

Pegasus 8. 3 mooring bollards, 4 stools & deck doublers in way renewed.

Modifications Pegasus 7 & 8. Plate rudders now removed, the Owners stating that these are never used and are a constant source of damage.

Pump suction in forward ballast tanks repositioned from forward shell plating to the starboard side in No.7 and port side in No.8. New fabricated suction boxes have been fitted.

Due to restricted time on the slipway, the old suction boxes have not been removed from the forward shell plating at this time. The blank flanges fitted to the old boxes are secured to prevent removal.

SRL. Item. It is now recommended that the following item be placed in the SR list.

Pegasus 7 & 8, suction boxes on the forward shell to be removed and shell openings in way to be efficiently closed at the next dry docking.

Annual Load Line Repairs "Pegasus 2" all steel tank cover joints

CONTINUATION OVER OR SHEET 2

	Shell Plates	Frames	R. Frames	Floors and Bracket Floors	Inner Bottom Plates	Deck Plates	Beams	Other Items
SUMMARY OF DAMAGE REPAIRS								
Renewed								
Removed and Fair'd or Repaired								
Fair'd or Repaired in place								

Has a Survey also been held on machinery of the Ship? None

Is Classification Certificate required? If so, to be sent to No

If so, is the Report sent now, or when will it be sent?

Has Interim Certificate been issued? Yes.

GENERAL OBSERVATIONS, OPINION AND RECOMMENDATION AS TO CLASS

State clearly what alteration, if any, is suggested to be made in the existing Classification or Survey or other records of the Ship in the Register Book consequent upon this survey; for example:—"to remain as Classed in the Register Book without fresh record of Docking"; "to remain as Classed and to have record of drydocking 1.55"; or "to remain as Classed and to have record of drydocking 1.55, and the notation of S.S. . . . 1.55".

These barges so far as now seen are eligible in my opinion to remain as now classed with fresh records of Docking Survey 11/59, subject to the fabricated suction boxes on the forward shell plating Pegasus Nos. 7 & 8, being removed and the shell openings efficiently closed at the next dry docking.

R. Guy.
Surveyor to Lloyd's Register of Shipping

R. GUY.

Date of Committee

Minute

THURSDAY 28 JAN 1960

DS 11. 59 Subject

Noted
for
Header



© 2020

Lloyd's Register
Foundation

TABLE 1

PARTS OF THE SHIP AS INDICATED BELOW HAVE BEEN EXAMINED FOR

SURVEY

Items	Now Examined YES NO or NONE	Tanks	Now Examined Internally	Now Tested
Shell plating, sternframe and rudder cleaned, examined and recoated in drydock	Yes	F.P. Tank		
Rudder lifted	None	A.P. "		
Weather Decks, Superstructures and Casings	Yes	D.B. Tanks (indicate Oil Fuel and Cofferdams)		
Hatchways, Covers, closing and securing appliances	Yes			
Ventilator coamings, skylights, companionways and closing appliances	None			
Holds	None	Fresh Water Tanks		
		Deep Tanks		
"Tween Decks	None	Oil Fuel Bunkers and Settling Tanks	No	
		Side Tanks		
Fore Peak Spaces	Not examined	Wing Tanks		
After " "	Not examined	Other Tanks		
Engine Space	None			
Boiler "	None	Cargo Tanks (Tankers)		
Under Engines and Boilers	None			
Tunnel and Well	None			
Coal Bunkers	None	Cofferdams		
Chain Locker	None			
Other Spaces	None	Pump Rooms		
		Have Tanks now Examined been Cleaned as Necessary?		
		Have Strums in Cargo Tanks (of Tankers) been removed?		
		Have Tanks been Retested as necessary after completion of any Repairs?		

Have the spaces now surveyed been cleared and cleaned as necessary? None Surveyed

Have the close ceiling and cargo battens, linings, pipe casings, etc., been removed and replaced as required by the Rules? None

Have the bilges been cleaned out and examined? None Has cement in bottom been examined? No

Has steelwork had rust removed and afterwards been recoated as necessary? Yes

Were inspection plugs or any insulation removed in insulated spaces for examination of steelwork? None

Has a Load Line Survey been held? Yes If so, state which Annual.

Have the shell and deck plating been drilled as per Rule? No If so, Report 8(Dr) to be attached

Have any alterations to the approved scantlings and arrangements now been effected? Nos. 7&8 Yes If so, report details in body of Report.

NOTE:—Indicate which compartments and/or tanks have been examined or tested by giving the identification numbers and inserting the word "Yes", e.g. Holds: Nos. 1, 2 & 3—Yes, or All—Yes.

TABLE 2

The present condition of the following parts in so far as examined is to be reported:—

Shell plating	Good	Ceiling and Cargo Battens	None	Sluice Valves examined and found	None
" " in way of side scuttles	None	Cement or Asphalt	None	Air and Sounding Pipes	Good
Rudder and Sternframe	None	Cargo and other Hatchways	Good	Doubling Plates under Sounding Pipes	Not examined
Decks	Good	Hatches and closing appliances	Good	Small Navigation Mast Pegasus No.2	
Superstructures and their closing appliances	None	Ventilators, their coamings	Good	Masts and Rigging examined and found	Good
Coamings and Casings	Good	and closing appliances		Condition, how ascertained	From deck.
Beams and Fastenings	Not examined	Companionways and Skylights	None	(State if wedges removed)	
Frames	Not examined	Shell Openings	None	Chain Locker	Not examined
Reverse Frames	None	Ash Shoots	None	EQUIPMENT	
Longitudinals	Not examined	Overboard Discharges and Scuppers	None	Equipment Letter	(r)
Transverses	Not examined	Freeing ports	None	Anchors, No. of	2B + 2S Condition Good
Floors	Not examined	Steering Gear (Main and Auxiliary)	None	Cables (State if now ranged and examined)	No
Keelsons	Good	examined and found		" length --	mean diam. --
Stringers	Good	Windlass examined and found	Good	" (on board)	
Inner Bottom Plating	None	Pumps " " "	Not examined	" Rule Length --	Size --
Bulkheads and Tunnel	Not examined	W.T. Doors " " "	None	Hawsers and Warps	Sufficient.
				State if any Anchors or Chain Cable have	
				now been supplied or retested, if so,	No
				complete Report 8(Eq) and attach.	

Have conditions (A) or endorsements (B) of Class (if any) been dealt with? None See Below

REMARKS, REPAIRS, Etc. (Contd.) renewed.

Survey Fee DS £56 - 14 - 0.

Special Damage or Repair Fee (if any)

Travelling Expenses (if chargeable) 10 - 0.

Second Surveyor's Fee (if any)

Date when A/c. Rendered

29th December, 1959.

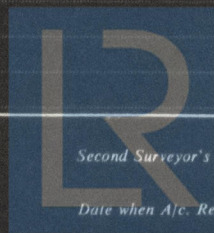

© 2020

Lloyd's Register Foundation