

SECTION AT NO 26B & 27A

BRACKET INWAY WEBS

SECTION AT NO 25C & 27C

"CHANT 58"

CONVERSION TO CARGO CARRIER.

5 AUG 1946

606

Approved  
9.8.46  
[Signature]

SCALE 1" = 1'

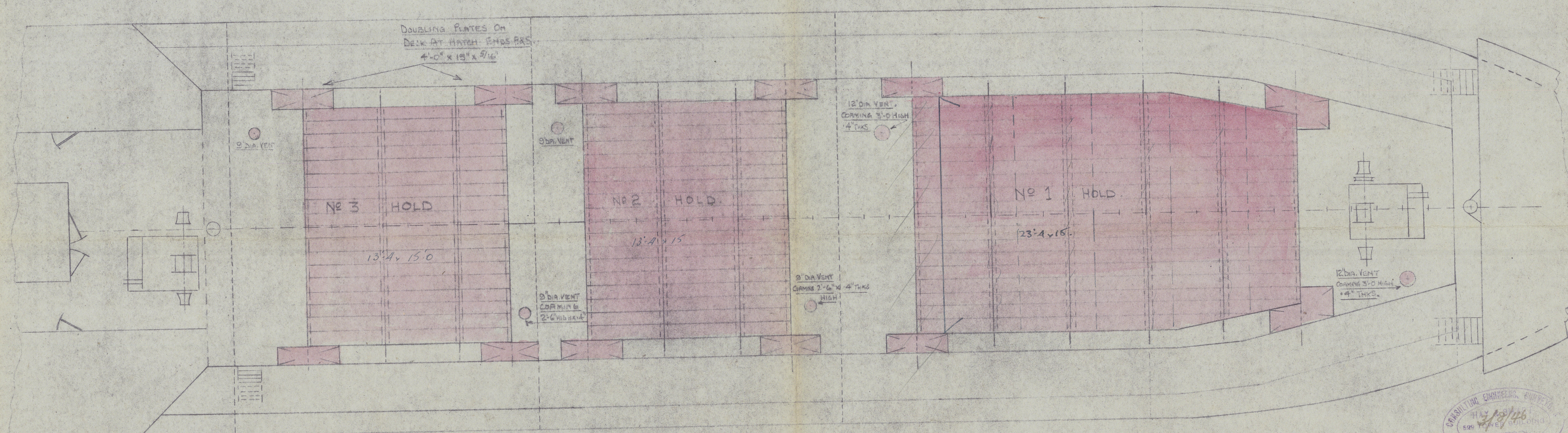
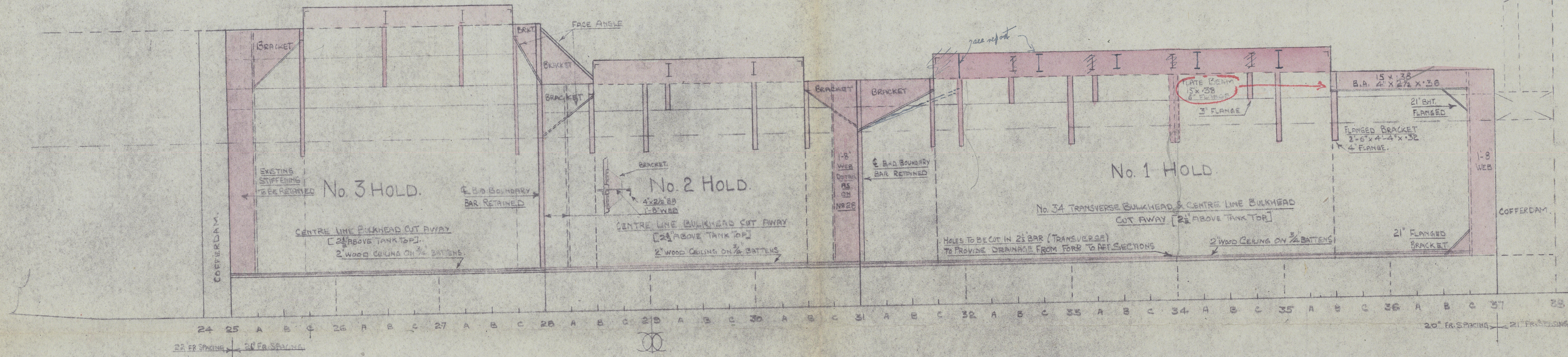



11

Conversion Profile & Deck

5m CHANT 58 - NOW KAMUNI

Liverpool 9.8.16.

Conversion Profile & Deck

Chant 58.

5 AUG 1946

Bag

011235-011243-0186

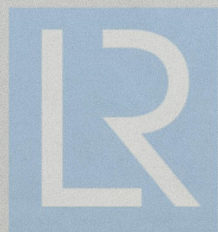

© 2021  
Lloyd's Register  
Foundation