

No 2107

"PADAMYA"

QUARTER WHEEL MOTOR VESSELS  
FOR  
INLAND WATER TRANSPORT BOARD, BURMA  
GENERAL ARRANGEMENT (AS FITTED).  
SCALE:  $\frac{1}{8}$  - 1 FOOT.

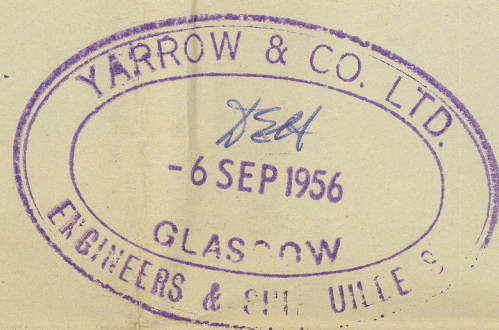

LENGTH OVERALL	148'-6"
LENGTH, HULL, EX. TONGUE	134'-0"
LENGTH, WATER LINE	130'-0"
BREADTH, MOULDED	34'-0"
DEPTH, MOULDED	5'-6"
LOAD DRAUGHT	4'-0"

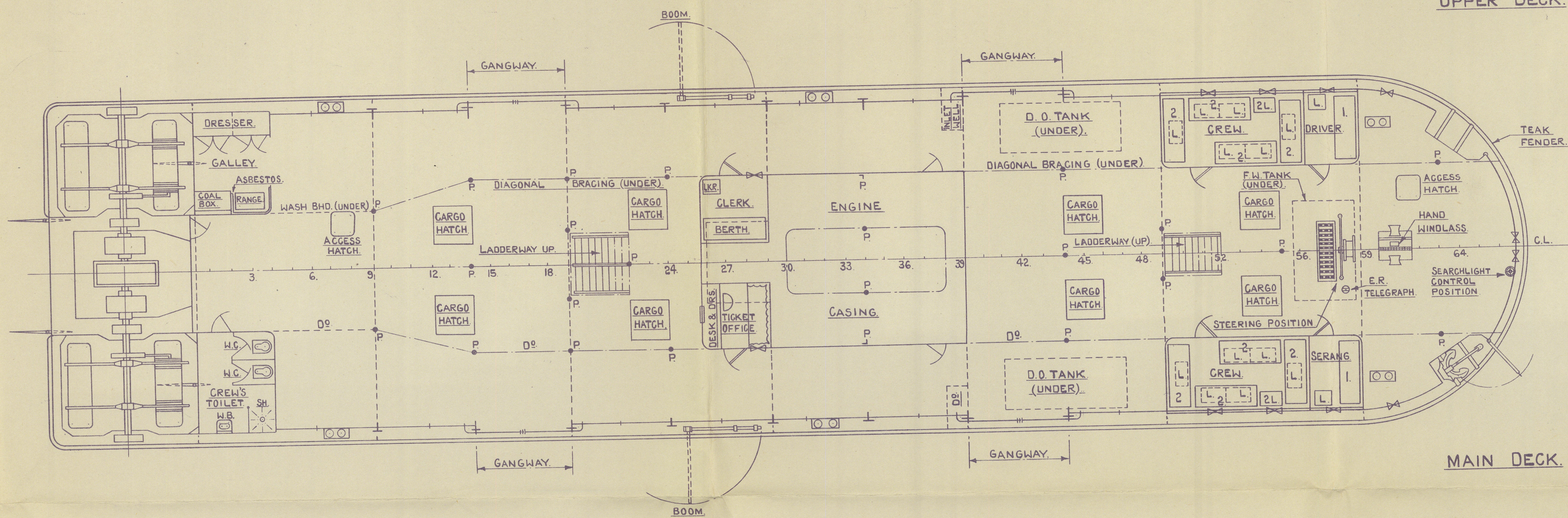
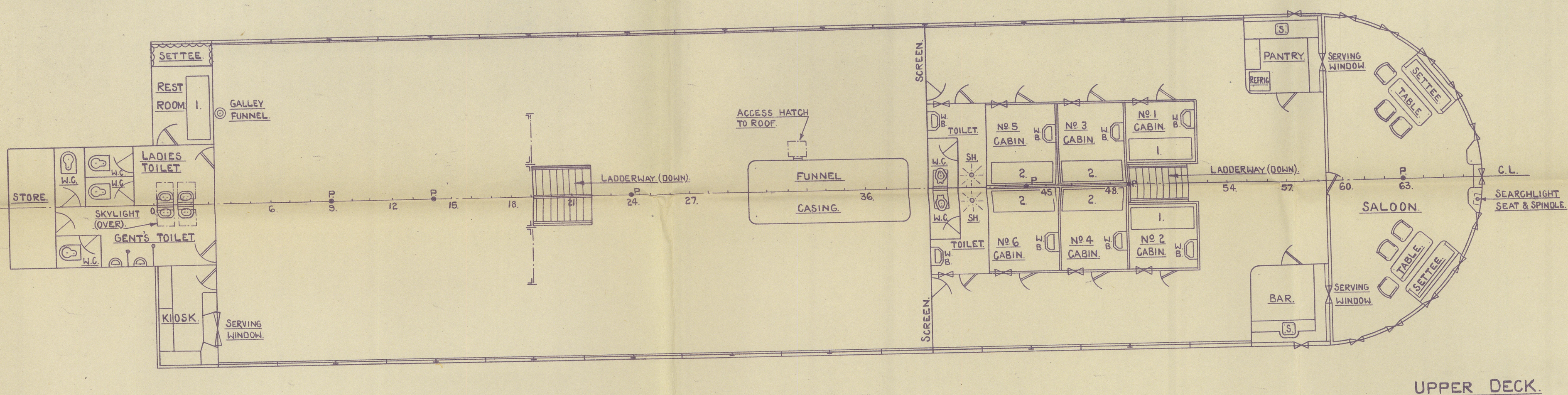
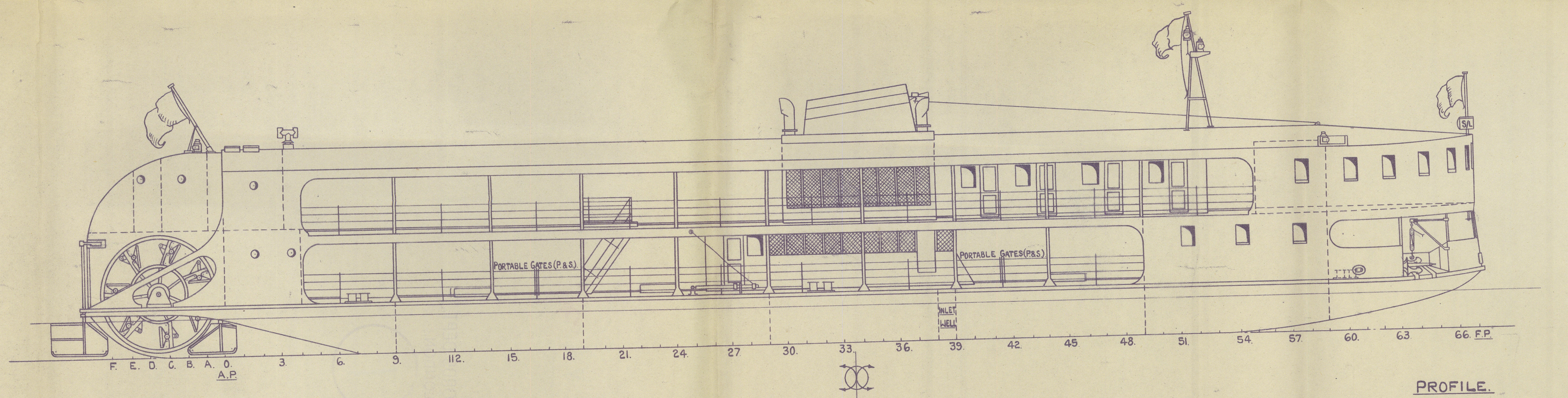

No 40787.

No 40787.



"PADAMYA" 

RECORDS DEPT.,  
LONDON.

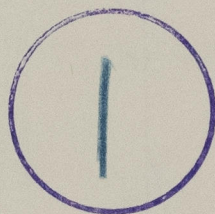

*General Arrangement  
as titled*



© 2021

Lloyd's Register  
Foundation

01147-011206-0094