

Lloyd's Register of Shipping.

SURVEYS FOR FREEBOARD.

(CONDITIONS OF ASSIGNMENT.)

FEB 1949

Ship's Name *M. V. MELTEM*Port of Survey *TRIESTE*

Official Number

Surveyor's Signature *S. J. Lumsden*Nationality and Port of Registry *TURKISH. ISTANBUL.*Date of Survey *FEBRUARY 1949.*

Disposition and dimensions of superstructures, trunks, deckhouses and machinery casings to be inserted in the diagrams and tabular statement:—

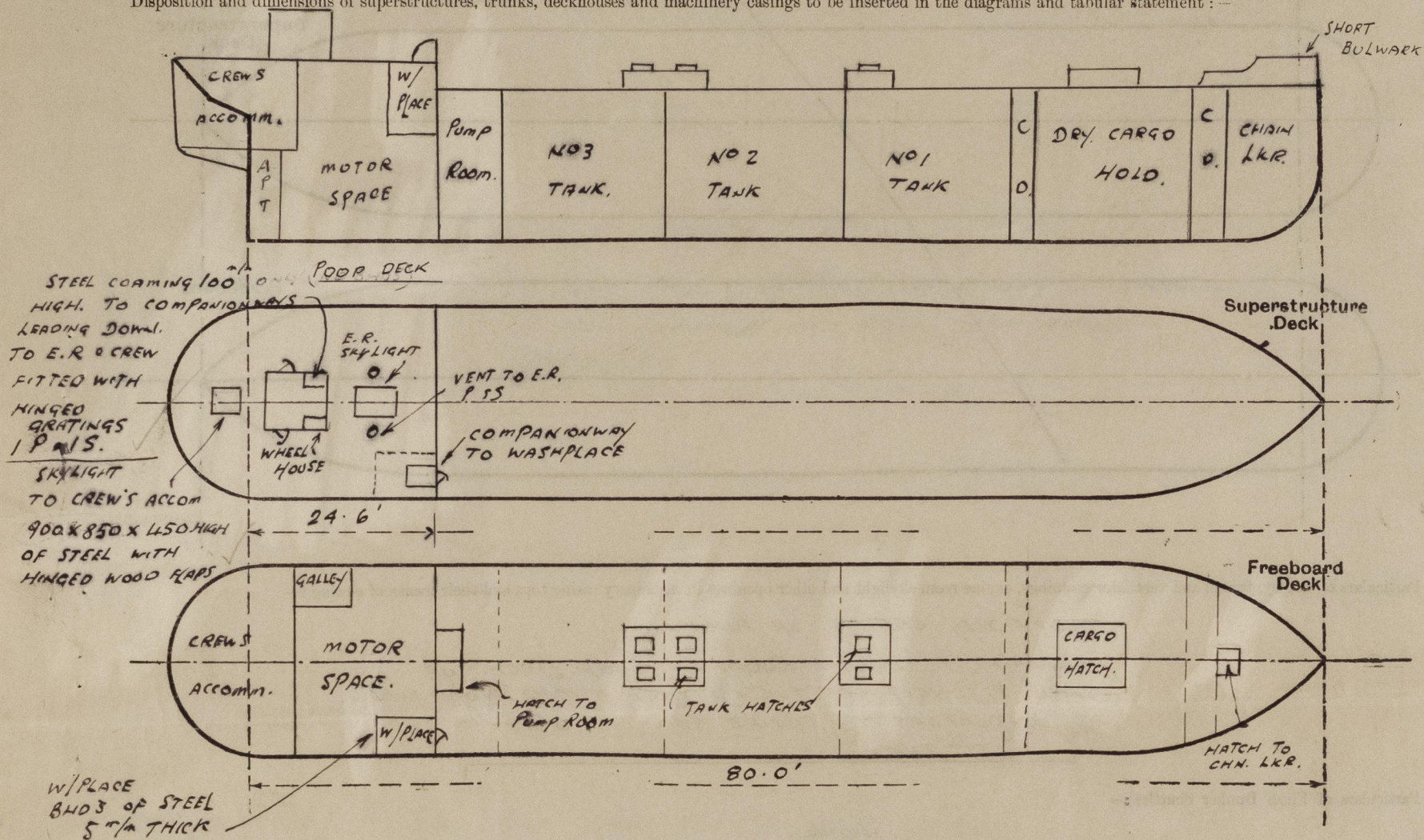

Particulars of Superstructures, Trunks, Casings, Deckhouses.

	Coaming	Plating	Stiffeners	Spacing	End Attachments of Stiffeners	Size of Openings	Height of Sills	Height of Casings
Poop Bulkhead ...	5" m/m	5" m/m	50 x 30 x 5 AND 60 x 60 x 6 ALTERNATELY	300	BRACKETS T.B.	1 @ 1420 x 540 (SEE COMPANIONWAY)	610	1350
Raised Quarter Deck Bulkhead ...								
Bridge, After Bulkhead ...								
Bridge, Forward Bulkhead ...								
Forecastle Bulkhead ...								
Trunk, Aft ...								
Trunk, Forward ...								
Exposed Machinery Casings on Freeboard or Raised Quarter Decks ...								
Exposed Machinery Casings on Superstructure Decks ...								
Machinery Casings within Superstructures not fitted with Class I Closing Appliances ...								
Deckhouses on Flush Deck Ships ...								

Particulars of Closing Appliances (state if capable of being manipulated from both sides).

Poop Bulkhead ...	STEEL DOOR HINGED WITH HANDLE CAPABLE OF BEING OPERATED FROM BOTH SIDES.
Raised Quarter Deck Bulkhead ...	
Bridge, After Bulkhead ...	
Bridge, Forward Bulkhead ...	
Forecastle Bulkhead ...	
Exposed Machinery Casings on Freeboard or Raised Quarter Decks ...	
Exposed Machinery Casings on Superstructure Decks ...	
Machinery Casings within Superstructures not fitted with Class I Closing Appliances ...	
Deckhouses on Flush Deck Ships ...	

PARTICULARS OF PROTECTION TO OPENINGS, ETC.

The following diagrams should be used to indicate the positions of cargo and coaling hatchways, gangway, cargo and coaling ports, ventilators, companionways, etc., which would affect the seaworthiness of the ship:—

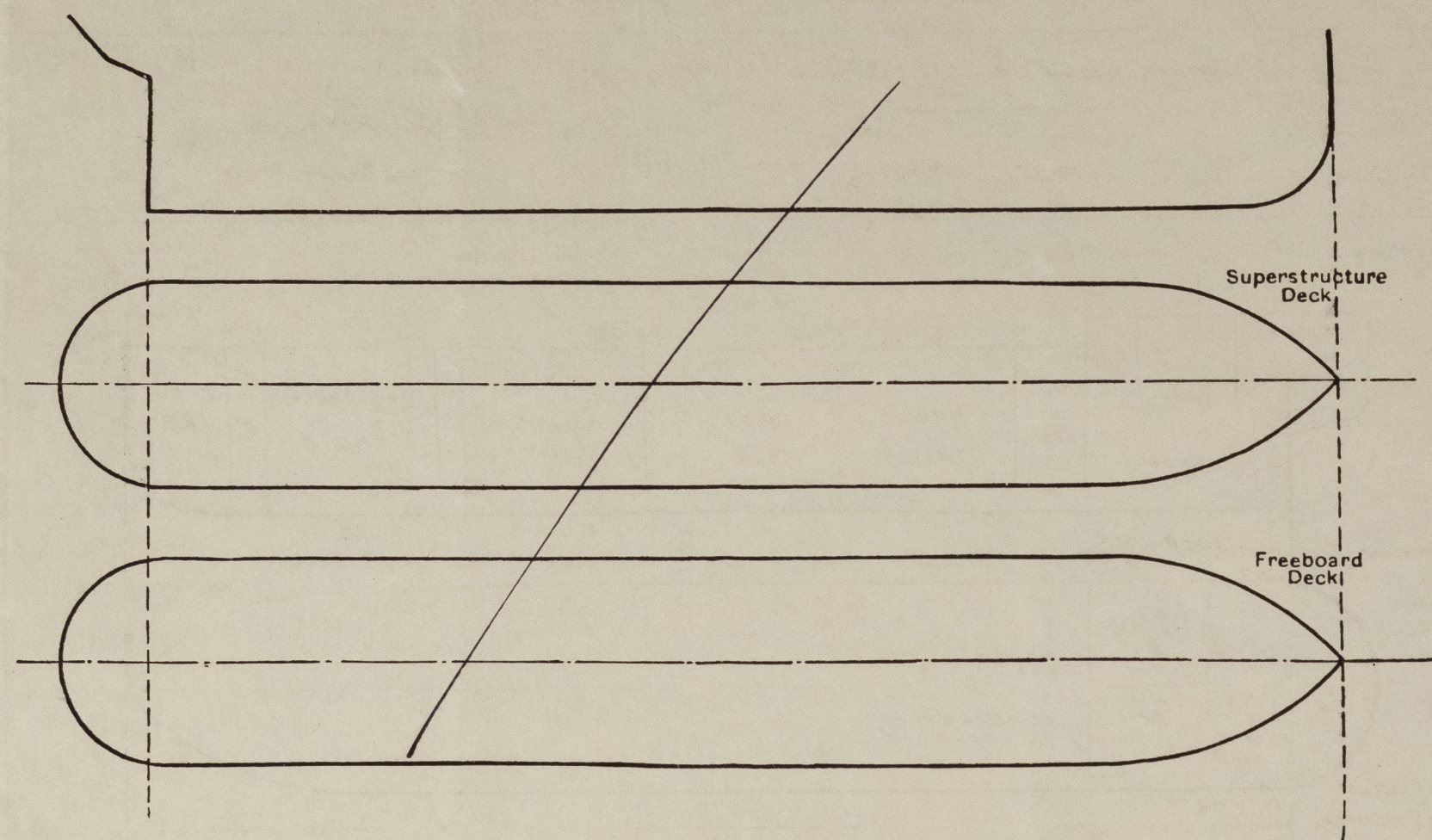

Particulars of fiddley, funnel and ventilator coamings, engine room skylight and other openings in machinery casing tops and their means of closing :—

NO FIDLEY CASING OR FUNNEL.
SKYLIGHT TO ENGINE ROOM ON POOP DECK OF
STEEL STRONGLY CONSTRUCTED WITH HINGED WOOD FLAPS.
2 VENTILATORS TO ENGINE ROOM 300" IN DIA. 600" IN HIGH
X 4" IN THICK.

Particulars of Flush Bunker Scuttles :—

NONE.

Particulars of Companionways :—

1 PORT AND 1 STAB. TO ENGINE ROOM AND CREWS QUARTERS
ACCESS. INSIDE WOOD WHEEL HOUSE. WOOD DOORS TO WHEEL HOUSE 08
OF STRONG CONSTRUCTION. SILLS 200" H. HIGH. NO BUD'S ROUND
COMPANIONWAY. (SEE SKETCH). DOORS OPERATED FROM BOTH SIDES
COMPANIONWAY ON POOP FRONT TO W.C. OF STEEL STRONGLY CONSTRUCTED.
DOOR OF STEEL 1420 X 540. SILL 610. DOOR FITTED WITH HANDLE CAPABLE OF
BEING OPERATED FROM BOTH SIDES

Particulars of Ventilators in exposed positions on freeboard and superstructure decks :—

3-6" DIA. S.D. mushroom nests on Popo 5'. Counting 12" high.

Particulars of Air Pipes in exposed positions on freeboard, raised quarter, or superstructure decks :—

2" OFF TO FORD. COFFERDAM 620^{1/4}" HIGH X 440^{1/4}" DIA. ON UPPER DECK
2 " " Pump Room 620^{1/4}" HIGH. X 70^{1/4}" DIA " " "
2 " " TO MIDSHIP COFFERDAM 620^{1/4}" " X 40^{1/4}" DIA " " "
2 " " TO AFT. PEAK TANK 620^{1/4}" HIGH X 40^{1/4}" DIA. ON POOP DECK

EFFICIENT CLOSING APPLIANCES PROVIDED.

Particulars of Gangway Cargo and Coaling Ports:—

NONE.

Particulars of Scuppers and Sanitary Discharge Pipes :—

1. W-C DISCHARGE S.S. AFT. 45 m/m DIA. D. NRVS
 WITH NON-RETURN VALVE ON SHIPS SIDE. N.E. OF UNDERWATER PATTERN.
 1 WASHBASIN DISCHARGE WITH SCREW DOWN VALVE - NR
 CONTROLLED FROM WASHPLACE. X
 4. PIPE SCUPPERS. POS. DRAINING DIRECTLY OVERBOARD.
 FROM UPPER OK. 40 m/m DIA. ✓

Particulars of Side Scuttles :—

IN POOP SIDES. 180" DIA. OF STRONG CONSTRUCTION
OF ALUMINIUM ALLOY AND FITTED WITH HINGED
DEBO LIGHTS. ✓

Vertical distance of Sill of lowest Side Scuttle above top of keel

2. 6 METRES.

Particulars of Guard Rails :—

ON POOP DECK 900 ¹/₄" HIGH. 2 RODS.
STANCHIONS SPACED 1300 ¹/₄" APART.

ON UPPER DECK 900 ¹/₄" HIGH.
~~THREE WIRES SET UP WITH STRETCHING SCREENS.~~
~~WITH SINGLE WIRE ONLY.~~
STANCHIONS SPACED 1300 ¹/₄" APART.

Particulars of Gangways, Lifelines, etc. :—

~~NO MP~~ Lifelines X
LIFELINES PROVIDED FROM POOP TO FORE ENO

Particulars of Freeing Arrangements.						
	Length of Bulwark	Height of Bulwark	Size of Freeing Ports	Number each side	Area each side	Rule area each side
After Well		NONE				
Forward Well						

State position of each freeing port { After Well :—
(F. and A. position and height above deck edge) { Forward Well :—

State whether the freeing ports are fitted with shutters, bars, or rails, and give particulars of such :—

Additional area where sheer is less than standard.

 © 2021
Lloyd's Re

PARTICULARS OF PROTECTION TO OPENINGS, ETC.

HATCHWAYS ON FREEBOARD AND SUPERSTRUCTURE DECKS.									
Description of Hatchway		TO PUMP ROOM	TO CARGO TANKS		TO CARGO HOLD.	TO CHAIN LOCKER			
Dimensions of Hatchway		1400 X 760	600 X 550		2030 X 1900	600 X 500			
COAMINGS	Height above Deck	400	75		620	300			
	Thickness	Sides	5	5	5	5			
		Ends	5	5	5	5			
	Stiffeners		✓	SEE SKETCH.	2 @	✓			
	Brackets, Stays		✓						
HATCH BEAMS	Number				90 X 25 X 6				
	Spacing				ALG. PLATES				
	Scantling and Sketch				P.S.				
FORE AND AFTERS	Bearing Surface				NONE				
	Number								
HATCH COVERS	Thickness								
	How fitted								
	Bearing Surface								
	Material								
Spacing of Cleats									
Number of Tarpaulins									
<p>*Are wood fore and afters steel shod at all bearing surfaces? ✓</p> <p>Are battens and wedges efficient and in good condition? ✓</p> <p>Are tarpaulins in good condition and in accordance with rule requirements? ✓</p> <p>Are lashings provided in accordance with rule requirements? ✓</p>									

Particulars of any special features:—

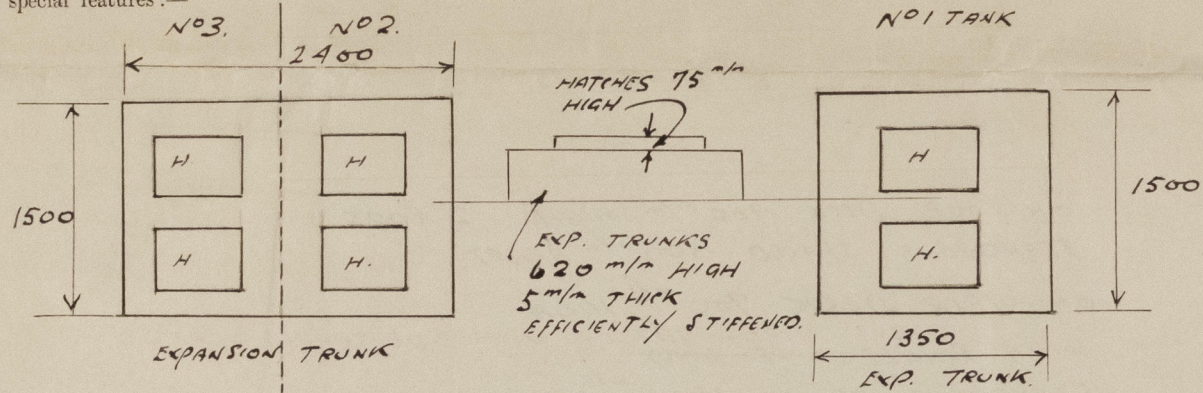

Endorsement at first survey and at surveys for renewal of Certificate:—

The fittings and appliances are in accordance with the particulars shown on this form (or as now modified) and are in good condition.



© 2021

Lloyd's Register
Foundation