

# Lloyd's Register of Shipping.

## SURVEYS FOR FREEBOARD.

### (CONDITIONS OF ASSIGNMENT.)

 Index No. \_\_\_\_\_  
 (For London Office only).

MODAL

Ship's Name *ZEITOUN*Port of Survey *Southampton*Official Number *181698*Surveyor's Signature *W. H. D. D. D.*Nationality and Port of Registry *British London.*Date of Survey *17/11/47.*

Disposition and dimensions of superstructures, trunks, deckhouses and machinery casings to be inserted in the diagrams and tabular statement:—

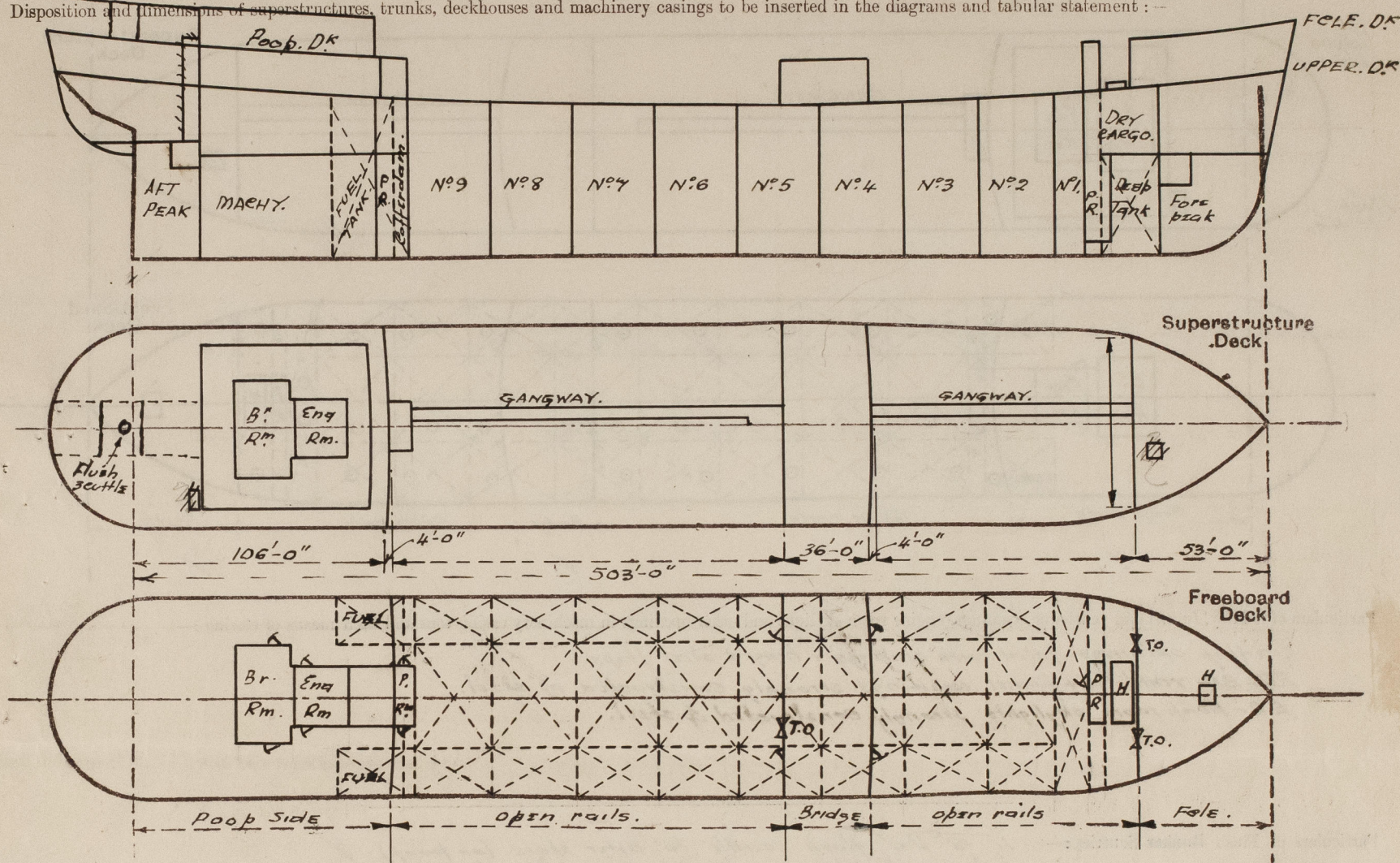

Particulars of Superstructures, Trunks, Casings, Deckhouses.

	Coaming	Plating	Stiffeners	Spacing	End Attachments of Stiffeners	Size of Openings	Height of Sills	Height of Casings
Poop Bulkhead ...	47	47	Flanged plate 9x4x45	30"	Welded top & bottom.	4'-11 1/2" x 2'-4"	18"	8'-0"
Raised Quarter Deck Bulkhead ...								
Bridge, After Bulkhead ...	32	32	4x3x32 OA To be welded	2'-6" x 3'-4"	Welded to U.D.K. + 8" D.K. Longls.	5'-0" x 2'-4" 5'-1" x 4'-1"	18"	8'-0"
Bridge, Forward Bulkhead ...	46	46	9x4x44 plate flanged 4"	2'-6"	Do.	5'-0" x 2'-4"	18"	8'-0"
Forecastle Bulkhead ...	34	34	7x4x45 OA 3 1/2 x 3 x 4 To be welded	1'-6" 2'-6"	Br'gt top & welded to U.D.K.	5'-0" x 3'-0" 5'-6" x 4'-1"	18"	10'-0"
Trunk, Aft ...	NONE.							
Trunk, Forward Pump Room Ent. Aft	47	47	6x4x44 plate flanged 4"	2'-6"	Welded top & bottom to deck.	5'-0" x 2'-2"	18"	4'-10"
Exposed Machinery Casings on Freeboard or Raised Quarter Decks			5x3x32 F To be welded 3 1/2 x 2 1/2 x 32 A welded.	2'-4" x 2'-9" 2'-4"	Welded to P.R. top.	5'-0" x 2'-2"	18"	8'-0"
Exposed Machinery Casings on Superstructure Decks	40	40	3 1/2 x 3 1/2 x 30 To be welded	2'-4"	Continuous Br'gt at top.			8'-6"
Machinery Casings within Superstructures not fitted with Class I Closing Appliances	NONE							
Deckhouses on Flush Deck Ships	NONE							

Particulars of Closing Appliances (state if capable of being manipulated from both sides).

Poop Bulkhead ...	Hinged steel W.T. Door (P+S) capable of being manipulated from both sides
Raised Quarter Deck Bulkhead ...	Hinged steel W.T. Doors capable of being manipulated from both sides
Bridge, After Bulkhead ...	Portable steel plates secured by hook bolts.
Bridge, Forward Bulkhead ...	Hinged steel W.T. doors capable of being manipulated from both sides.
Forecastle Bulkhead ...	Hinged steel W.T. doors capable of being manipulated from both sides.
Exposed Machinery Casings on Freeboard or Raised Quarter Decks	Pump Rooms. Hinged steel W.T. Doors capable of being manipulated from both sides
Exposed Machinery Casings on Superstructure Decks	No openings.
Machinery Casings within Superstructures not fitted with Class I Closing Appliances	No openings.
Deckhouses on Flush Deck Ships	—



# PARTICULARS OF PROTECTION TO OPENINGS, ETC.

The following diagrams should be used to indicate the positions of cargo and coaling hatchways, gangway, cargo and coaling ports, ventilators, companionways, etc., which would affect the seaworthiness of the ship:-

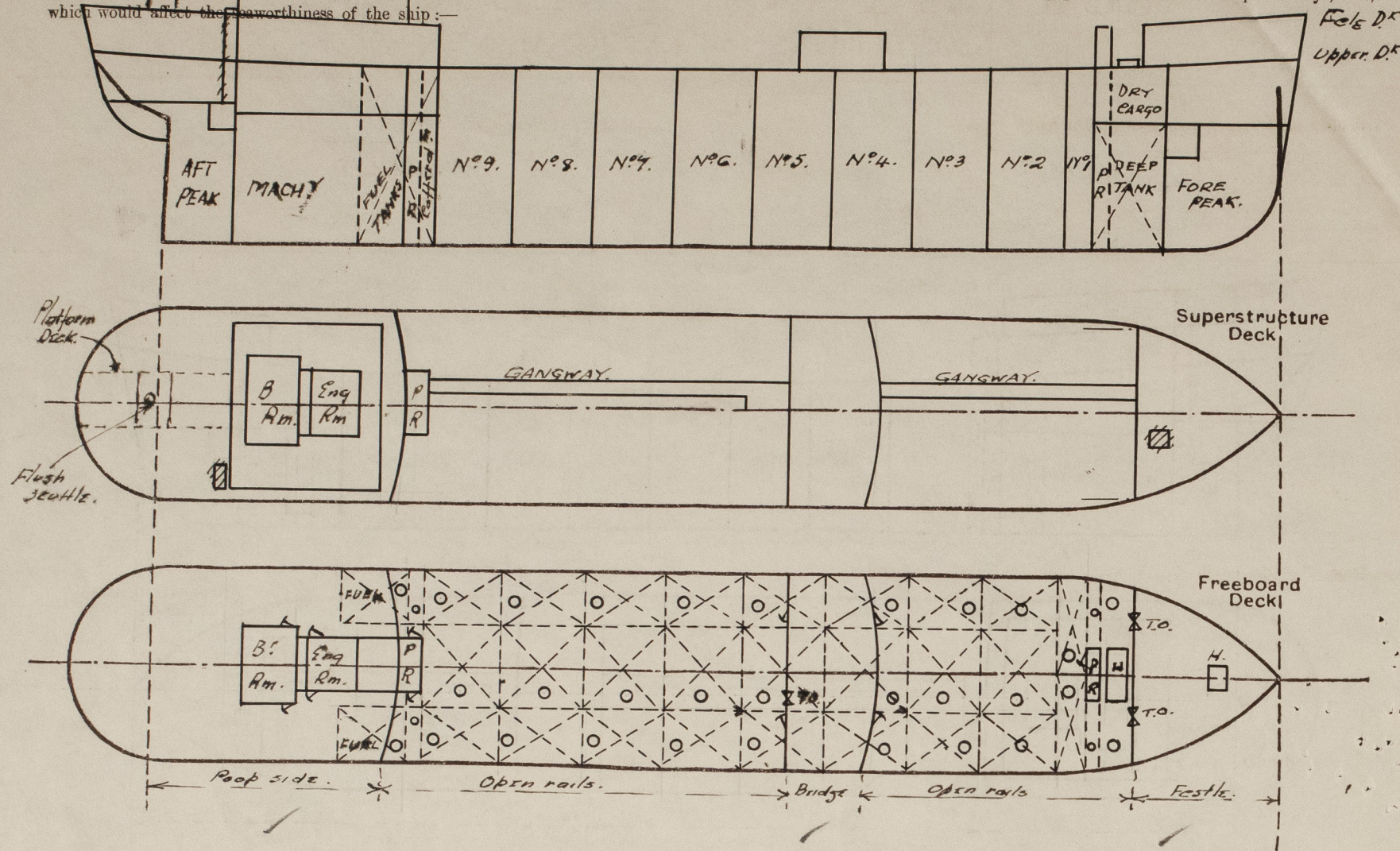

Particulars of fiddle, funnel and ventilator coamings, engine room skylight and other openings in machinery casing tops and their means of closing:-

Fiddle openings fitted with gratings + hinged steel flaps.  
ER + BR ventilator + funnel coamings strongly constructed of steel.  
ER - Pump room skylights strongly constructed of steel.

Particulars of Flush Bulkhead Scuttles:-

1. 18" Dia. Flush scuttle to after store (on poop).  
Substantially constructed of steel having bayonet joints and permanent chain attachment.

Particulars of Companionways:-

Pump Rooms - Hinged steel W.T. doors manipulated from both sides.  
openings 5'-0" x 2'-4" sills 18".  
Poop deckhouse - plating steel, openings in sides + ends 5'-0" x 2'-4", sills 15".  
with hinged steel W.T. doors manipulated from both sides.

Particulars of Ventilators in exposed positions on freeboard and superstructure decks:-

Forecastle Deck 1 - 12" diam 34" x 40 to forecastle store  
Screwed cap fitted  
1 - 12" u 42 x 35 to forecastle store  
hinged steel flap fitted  
upper deck 2 - 14" u 36 x 36 in P.H. top  
2 - 17" u 12' - 6 x 36 to hold hinged steel flap.  
aft. 3 - 24" u 28' - 0 - 34' - 0 x 80" and 50"  
bridge deck 4 - 12" u 34" x 38 - hinged steel flap  
Poop deck 1 - 9" u 31" x 35 to top done with pender top and canvas cover  
2 - 18" u 12' - 0 x 36

Efficient closing appliances provided for all ventilator coamings  
Coamings exceeding 36" in height suitably supported.

Particulars of Air Pipes in exposed positions on freeboard, raised quarter, or superstructure decks:-

Forecastle deck:- All air pipes of efficient construction + height + scappings in accordance with or  
Equivalent to Rules Requirements, Gauge fitted to air pipes to oil compartments.  
Upper deck:-  
Poop deck:-

Efficient closing appliances provided for all air escape pipes.

Particulars of Gangway Cargo and Coaling Ports:-

NONE.

MORAL:

Zeiten.

Particulars of Scuppers and Sanitary Discharge Pipes:-

Scuppers + sanitary discharges from poop accommodation led overboard below the freeboard deck + fitted with substantially constructed storm valves at ship's side.  
Scuppers + sanitary discharges from midship accommodation led overboard above the freeboard deck + fitted with substantially constructed storm valves at ship's side.

Particulars of Side Scuttles:-

Poop Turret Decks:- Side scuttles of strong construction fitted with hinged deadlights permanently attached.

Vertical distance of Sill of lowest Side Scuttle above top of keel

Particulars of Guard Rails:-

At sides of Upper, Forecastle + Poop Decks.  
Stanchions 3'-6" in height spaced 5'-0" - 5'-6" apart + fitted with 2 rails.

Particulars of Gangways, Lifelines, etc.:-

Fore + aft gangway fitted between the forecastle + bridge deck + bridge + poop deck.

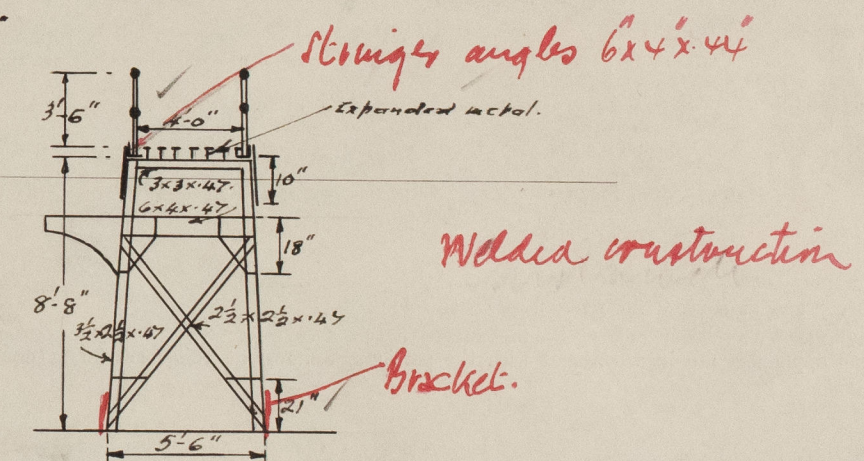

## Particulars of Freeing Arrangements.

	Length of Bulwark	Height of Bulwark	Size of Freeing Ports	Number each side	Area each side	Rule area each side
After Well ...			Open rails			
Forward Well ...			none.			

State position of each freeing port ... (After Well:-  
(F. and A. position and height above deck edge) Forward Well:-

State whether the freeing ports are fitted with shutters, bars, or rails, and give particulars of such:-

Additional area where sheer is less than standard.



PARTICULARS OF PROTECTION TO OPENINGS, ETC.

HATCHWAYS ON FREEBOARD AND SUPERSTRUCTURE DECKS.										
← freeboard deck →										
Description of Hatchway	...	...	In feet to FP store.	To cargo hold.	To cargo oil tanks	to CD's fore + aft.	to Deck tank for.	To. of Benches aft.		
Dimensions of Hatchway	...	...	3'-1" x 3'-1"	15'-0" x 11'-6"	48" Dia.	25" Dia.	25" Dia.	31" Dia.		
COAMINGS	{	Height above Deck	...	30"	30"	33"	22 1/2"	22 1/2"	30"	
		Thickness	...	3/4"	1/2"	1/2"	1/45"	1/45"	1/50"	
		Sides	...							
		Ends	...							
		Stiffeners	...	✓	HORIZONTAL.	✓	✓	✓		
		Brackets, Stays	...	✓	2 each side 3" end.	✓	✓	✓		
HATCH BEAMS	{	Number	...							
		Spacing	...							
		Scantling and Sketch	...							
		Bearing Surface	...	NONE	NONE	NONE	NONE	NONE	NONE	
FORE AND AFTERS	{	Number	...							
		Spacing	...							
		Unsupported Lengths	...							
		Scantling* and Sketch	...	NONE	NONE	NONE	NONE	NONE	NONE.	
		Bearing Surface	...							
HATCH COVERS	{	Material	...	STEEL. W.T.	STEEL. W.T.	STEEL. O.T.	STEEL. O.T.	STEEL. O.T.	STEEL. O.T.	
		Thickness	...	.40	.38	.50	.50	.50	.50	
		How fitted	...	Hinged.	with stiffeners	hinged	hinged	hinged	hinged	
		Bearing Surface	...	✓	hinged F&A. with strongback	✓	✓	✓	with strongback.	
Spacing of Cleats	...	...	...	—	—	—	—	—		
Number of Tarpaulins	...	...	...	—	—	—	—	—		
*Are wood fore and afters steel shod at all bearing surfaces? —										
Are battens and wedges efficient and in good condition? —										
Are tarpaulins in good condition and in accordance with rule requirements? —										
Are lashings provided in accordance with rule requirements? —										

Particulars of any special features:—  
All cargo oil tank hatch covers fitted with ullage doors 10" dia of strong construction secured by strongbacks.

Endorsement at first survey and at surveys for renewal of Certificate:—  
The fittings and appliances are in accordance with the particulars shown on this form (or as now modified) and are in good condition.