

New part of transverse beam n° 114

Section A-A

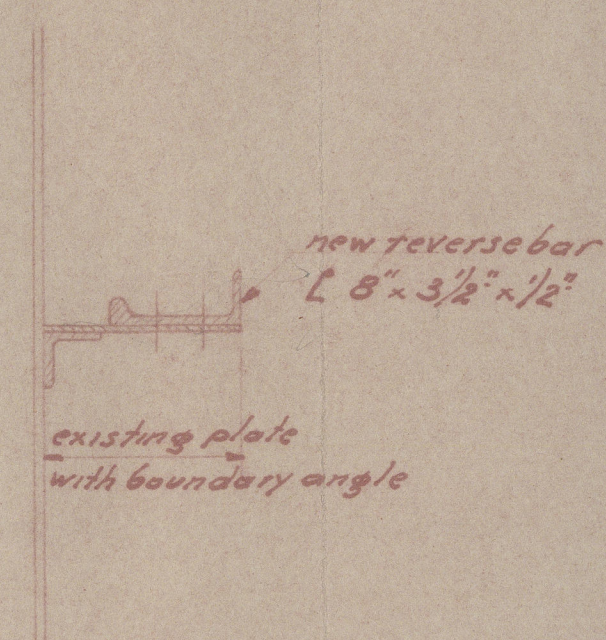

Section B-B

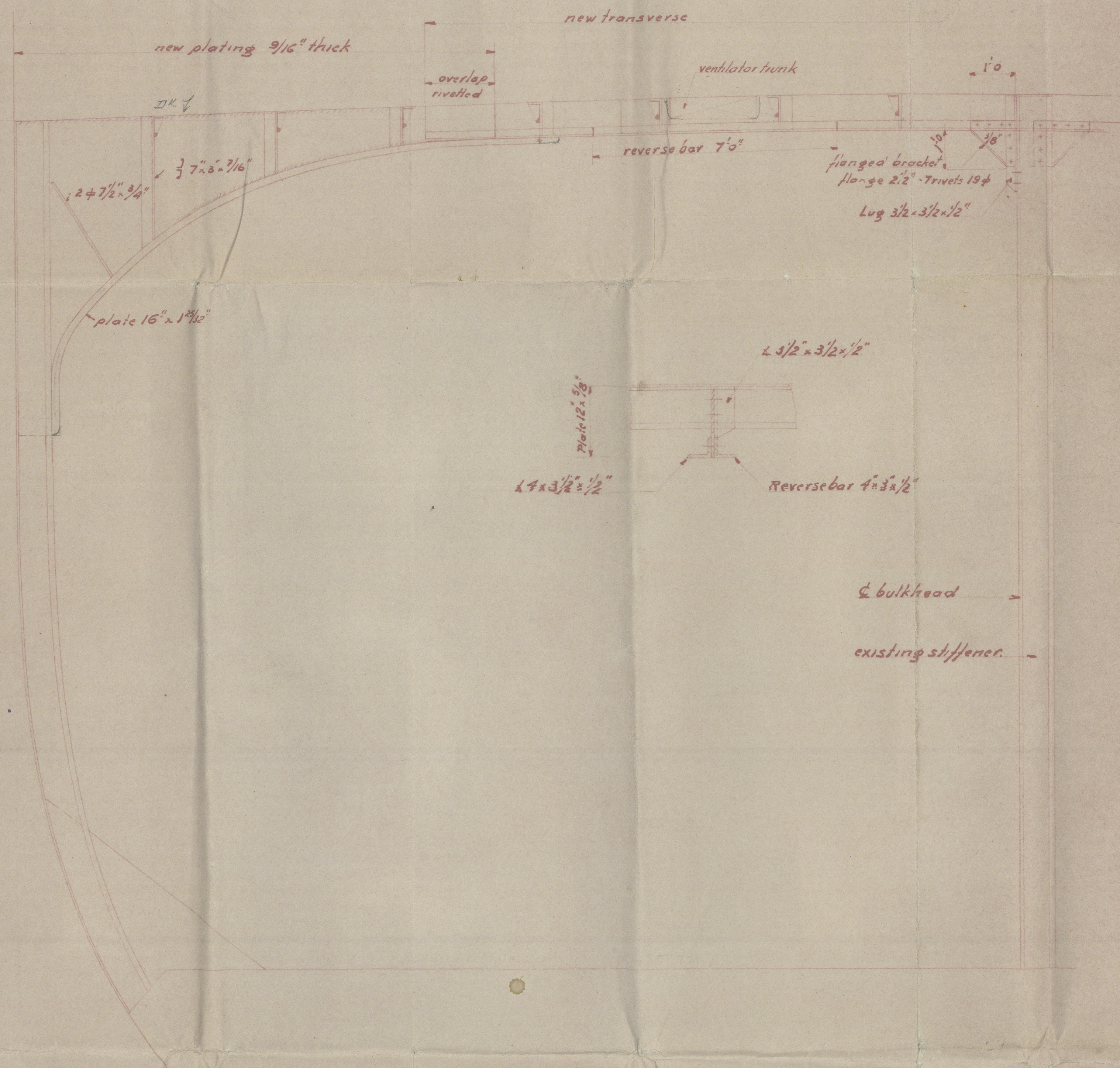
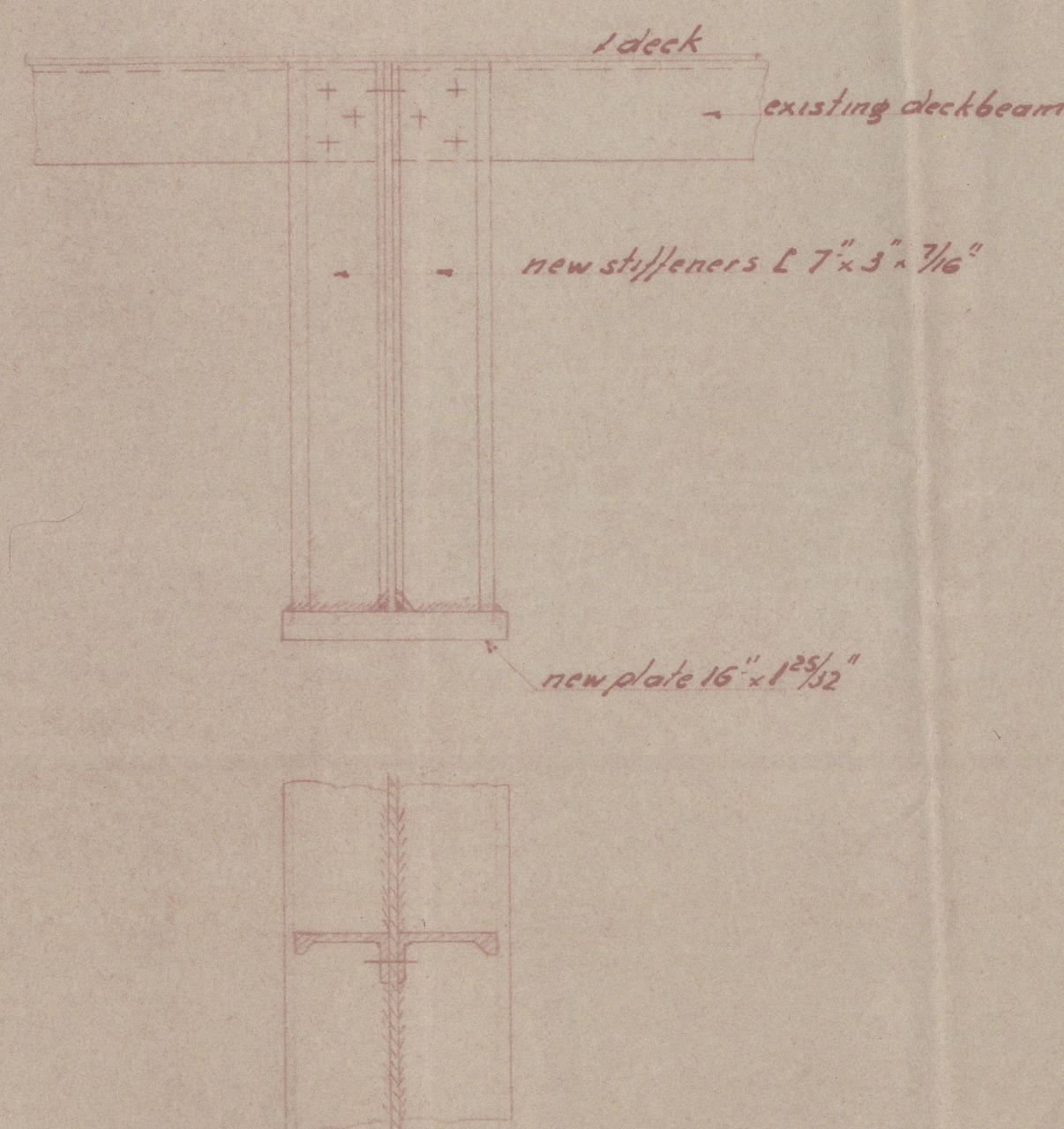

New transverse beam on fr. n° 118

S/S "Markab" (Empire class 1945) P.E. C. TYPE

Additional transverses in way of removed
deeptanks in n°2 hold forward

scale 1/2" = 1'0"

attached to Antwerp Report No 25236
26/3/49

Pl. n° 4881-19-1

010495-010501-0268

Mercantile M.E. & G.D.C. Antwerp