

Lloyd's Register of Shipping.

SURVEYS FOR FREEBOARD.

(CONDITIONS OF ASSIGNMENT.)

Ship's Name *Single screw s/s "RUDOLF"* Port of Survey *Gothenburg*
Official Number *8582* Surveyor's Signature *Bertrand Graner*
Nationality and Port of Registry *Swedish, Gothenburg* Date of Survey *While building*

Disposition and dimensions of superstructures, trunks, deckhouses and machinery casings to be inserted in the diagrams and tabular statement:—

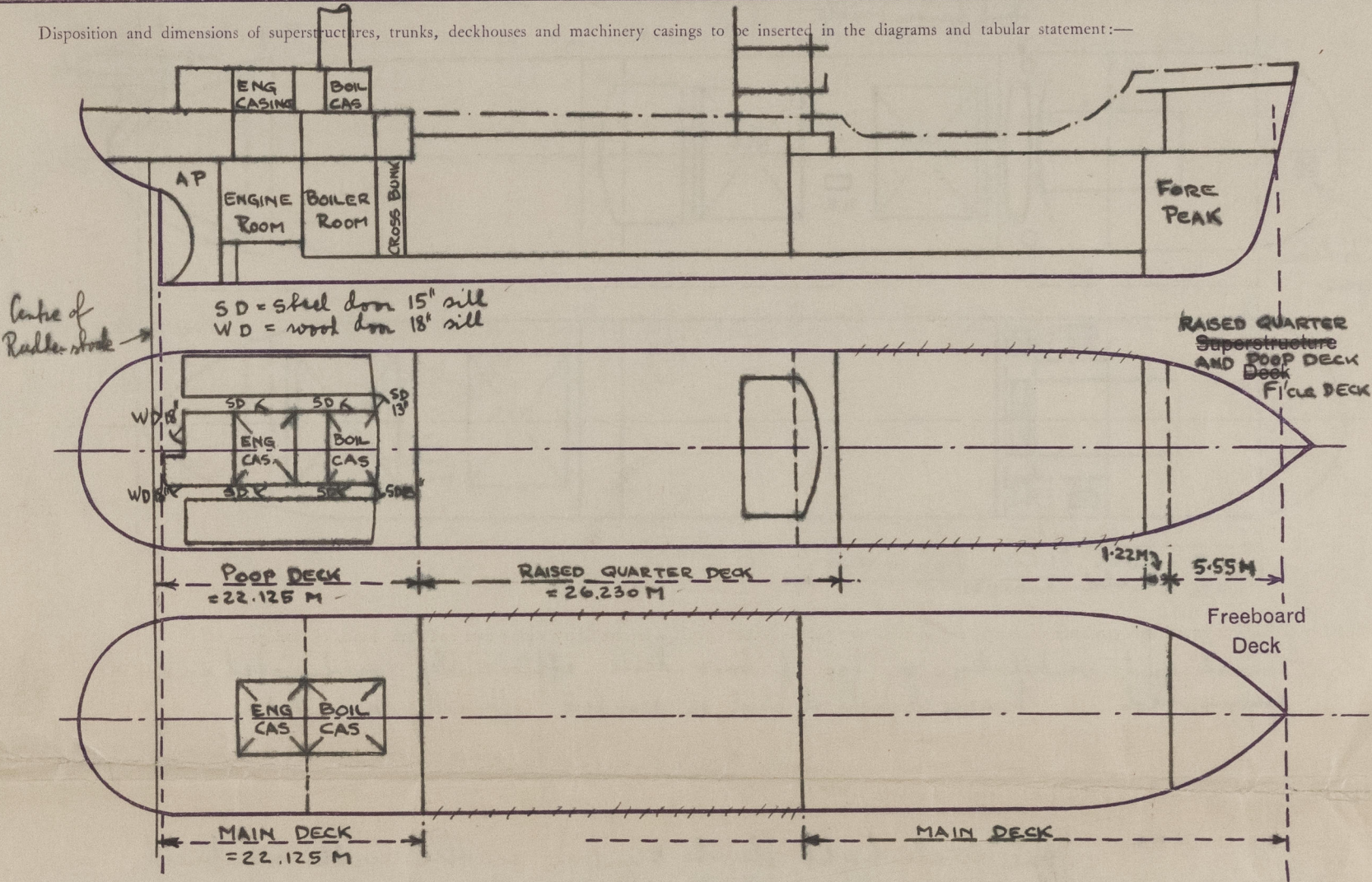

Particulars of Superstructures, Trunks, Casings, Deckhouses.								
	Coaming	Plating	Stiffeners	Spacing	End Attachments of Stiffeners	Size of Openings	Height of Sills	Height of Casings
Poop Bulkhead <i>Frame 36</i>		8.5	75x65x7.5 L	770	Top bracket on every 3rd stiffener	None	✓	
Raised Quarter Deck Bulkhead <i>Sides</i>		8.0	75x150x8 L	500, 600, 700	No attachment	None	✓	
Raised Quarter Deck Bridge, After Bulkhead <i>Centre part</i>		8.0	None	✓	✓	✓	✓	
Bridge, Forward Bulkhead		✓						
Forecastle Bulkhead		7.5x60	100x65x7.5 L	750	No attachment	1/ 950x full height 2/ 950x1500	1/ ✓ 2/ 580	
Trunk, Aft		✓						
Trunk, Forward		✓						
Exposed Machinery Casings on Freeboard or Raised Quarter Deck	BR	6.5	100x65x8 L	610	Continuous top	None	None	
Boiler casing front bulkhead	ER	6.5	100x65x8 L	610	None bottom	None	None	
Boiler casing front bulkhead		6.5	100x65x8 L	660-670	No attachment	None	None	
Machinery casing on poop deck	BR	6.5	100x65x8 L	610	Bracket top	Door size	15"	
Machinery casing within superstructures not fitted with Class I Closing Appliances	ER	6.5	100x65x8 L	610	Continuous bottom	None	None	
Boiler casing front bulkhead on Poop deck		6.5	90x65x6.5 L	660-670	None	None	None	
Deckhouses on Flush Deck Ships								

Particulars of Closing Appliances (state if capable of being manipulated from both sides).

Poop Bulkhead	No opening
Raised Quarter Deck Bulkhead	No opening
Bridge, After Bulkhead	✓
Bridge, Forward Bulkhead	✓
Forecastle Bulkhead	Steel plates with hook bolts not passing through bulkhead. Hook spac 305 mm
Exposed Machinery Casings on Freeboard or Raised Quarter Decks	No openings
Exposed Machinery Casings on Superstructure Decks (Poop Deck)	Hinged steel doors operated from both sides.
Machinery Casings within Superstructures not fitted with Class I Closing Appliances	✓
Deckhouses on Flush Deck Ships	✓

PARTICULARS OF PROTECTION TO OPENINGS, ETC.

The following diagrams should be used to indicate the positions of cargo and coaling hatchways gangway, cargo and coaling ports, ventilators, companionways, etc., which would affect the seaworthiness of the ship:—

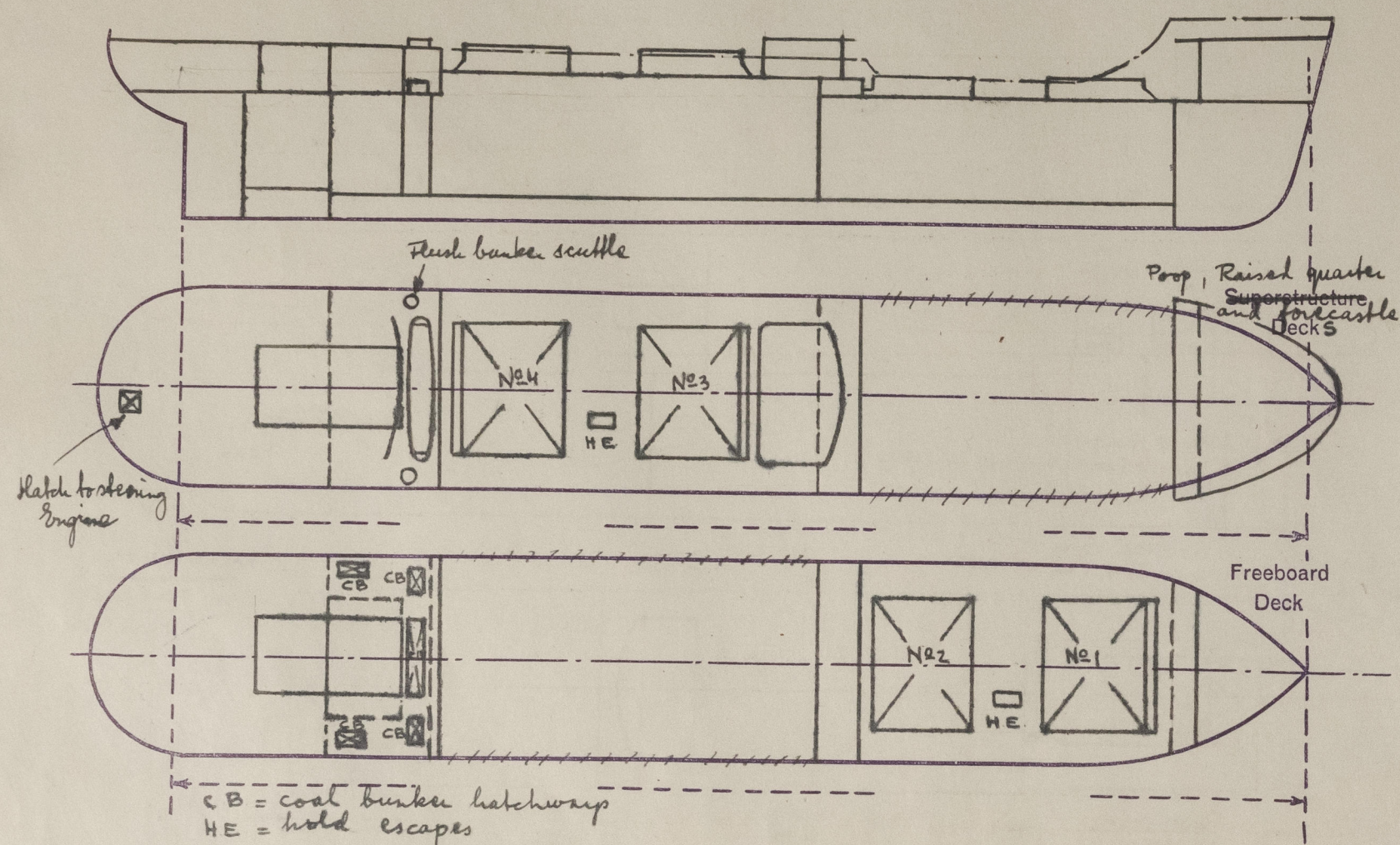

Particulars of fiddle, funnel and ventilator coamings, engine room skylight and other openings in machinery casing tops and their means of closing:—

Tunnel and ventilators on top of boat deck, efficiently constructed and supported. Engine skylight of steel on boat deck, efficiently constructed.

Particulars of Flush Bunker Scuttles:—

one watertight flush bunker scuttle with machined joints on each side on poop deck, of circular shape with cast iron cover and permanently attached to deck. Diameter 420 mm.

Particulars of Companionways:—

None fitted

Particulars of Ventilators in exposed positions on freeboard and superstructure decks:—

All ventilators on main deck, raised quarter deck, poop deck and forecastle deck are more than 915 mm in height and are efficiently constructed and supported. All ventilators provided with means of closing.

Particulars of Air Pipes in exposed positions on freeboard, raised quarter, or superstructure decks:—

All air pipes are 850 mm high of steel pipe and goose neck type and all fitted with means of closing.

Particulars of Gangway Cargo and Coaling Ports:—

None fitted.

Rudolf.

Particulars of Scuppers and Sanitary Discharge Pipes:—

Sanitary discharges from spaces on raised quarter deck are led overboard about 800 mm below the R.Q. deck and fitted with storm valves at ship's sides.

Scuppers and sanitary discharges from poop deckhouse are led overboard about 200-400 mm above main deck and fitted with storm valves.

Scuppers from crew space on main deck aft are led to engine room bilges.

Scuppers from steering engine space are led to engine room bilges.

Scuppers from Tonnage well, one each side, (130 x 135 mm) are led overboard, fitted with storm valve with means of closing same from upper deck.

Particulars of Side Scuttles:—

All side scuttles of substantial construction and fitted with hinged dead lights.

Vertical distance of Sill of lowest Scuttle above top of keel about 7900 mm

Particulars of Guard Rails:—

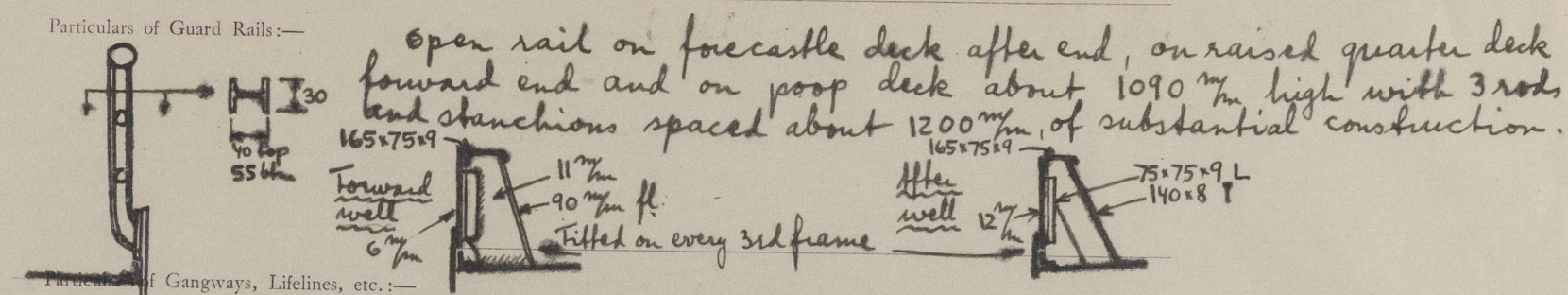

Lifelines provided on port and starboard sides from poop space to bridge. 1 1/2" steel wire.

Particulars of Freeing Arrangements.

	Length of Bulwark	Height of Bulwark	Size of Freeing Ports	Number each side	Area each side	Rule area each side
After Well R.Q. Deck	26.23 m	1090	3125 I 230	3	2.12 m ²	1.605 + 30% = 2.09 m ²
Forward Well Main Deck	21.35 m	1400-1800	2175 I 230	5	2.44 m ²	1.31 + 40% = 1.84 m ²

State position of each freeing port After Well:— 39-45, 50-56, 58-64

(F. and A. position and height above deck edge) Forward Well:— 81-85, 86-90, 92-96, 97-101, 107-111. Height above deck = 250-260 mm

State whether the freeing ports are fitted with shutters, bars, or rails, and give particulars of such:— Not fitted.

Additional area where sheer is less than standard. Fore well (Pitcher + 40%) + 86% fitted

Aft well (Pitcher + 30%) + 32% fitted

PARTICULARS OF PROTECTION TO OPENINGS, ETC.

		Hatchways on Foreboard and Superstructure Decks.				Fore Deck				*Poop Deck*	
Description of Hatchway		No 1	No 2	No 3	No 4	Two hold escapes m. l. h.	Coal bunker port & st after part	Coal bunker port & st fwd part	Coal bunker cr. line	Steel engine	
Dimensions of Hatchway		7200x7350	7200x7700	7200x7700	7200x7700	630x1050	660x1620	650x1200	1220x4000	740x760	
COAMINGS	Height above Deck at G	1175	1175	970	970	130	310	310	310	130	
	Thickness	11	11	11	11	11.5	11.0	11.0	11.0	11.0	
	Stiffeners	200x100x10	200x100x10	200x100x10	200x100x10	✓	1-bar	1-bar	1-bar	1-bar	✓
	Brackets, Stays	3	3	2	2	✓	✓	✓	✓	✓	
HATCH BEAMS	Number										
	Spacing										
FORE AND AFTERS	Scantling and Sketch	Von Tell steel hatches as per approved plan	Von Tell steel hatches as per approved plan			✓	✓	✓	✓	✓	
	Bearing Surface										
	Number										
	Spacing										
HATCH COVERS	Material	Steel	Steel	Steel	Steel	Steel	Wood	Wood	Wood	Steel	
	Thickness	7.0	7.0	7.0	7.0	8.5	60	60	60	9.0	
	How fitted	Hinged WT	Hinged WT	Hinged WT	Hinged WT	Hinged WT	Side-Side	Side-Side	F-A	Hinged WT	
	Bearing Surface	75	75	75	75	12 hinges	See	See	See	4-3/4" loggers	
Spacing of Cleats		625	660	660	660	4-3/4" loggers	420/460	420/490	530/490	✓	
Number of Tarpaulins		✓	✓	✓	✓	✓	2	2	2	✓	

*) Are wood fore and afters steel shod at all bearing surfaces? ✓
 Are tarpaulins in good condition and in accordance with rule requirements? Yes
 Are battens and wedges efficient and in good condition? Yes
 Are lashings provided in accordance with rule requirements? ✓

Particulars of any special features:— Tonnage opening hatch: coaming 250x90x12 E with 70mm wood covers and 2 tarpaulins for temporary closing. Opening of hatchway 7200x1220 (sides) 1235 (centre). Tonnage opening closed by efficient means of temporary closing.

Endorsement at first surveys and at surveys for renewal of Certificate:—

The fittings and appliances are in accordance with the particulars shown on this form (or as now modified) and are in good condition.



© 2021

Lloyd's Register Foundation