

T.S.S. No 859M + 860M.

PROFILE AND DECK PLANS.

SCALE 1/8" = 1 FOOT.

Support under windows, specially made to be to carry on satisfaction.

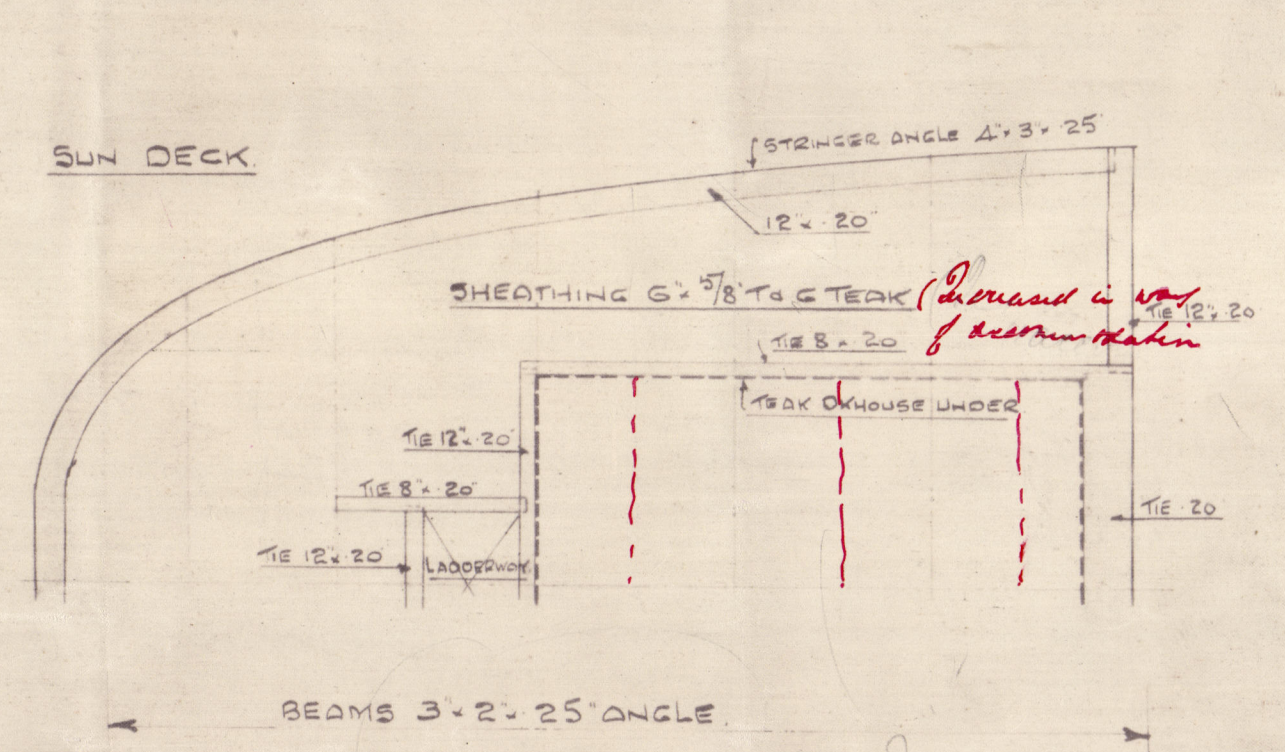
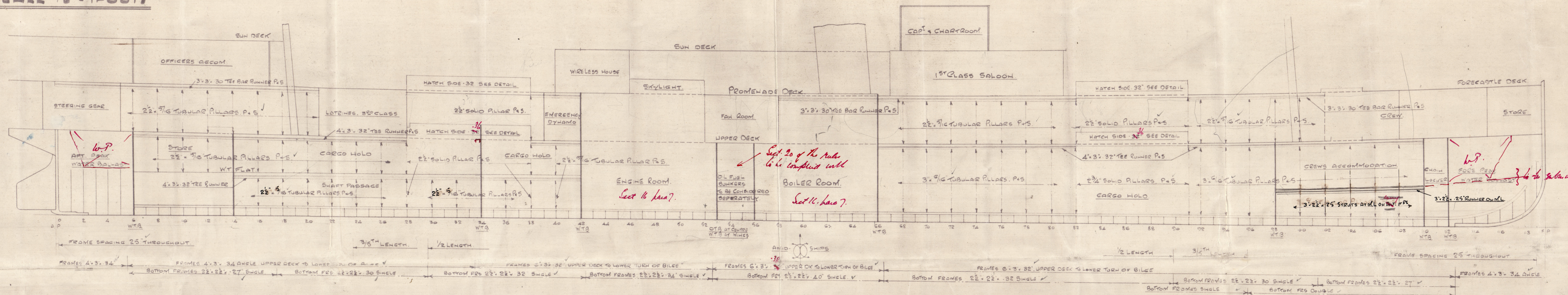

WT BULKHEADS  
PLATING BOTTOM STRAKE 3/4" REMAINING 3/4" STIFFENERS 6" x 3/4" 38' ANGLE SPACED 30" APART EXCEPT ON COLLISION AND WINDLASS SPACED 24" BOUNDARY ANGLES 3" x 3/4" 36" SINGLE  
NOTE END OF STIFFS ARRANGED TO TAKE RIVET THROUGH BOUNDARY BARS

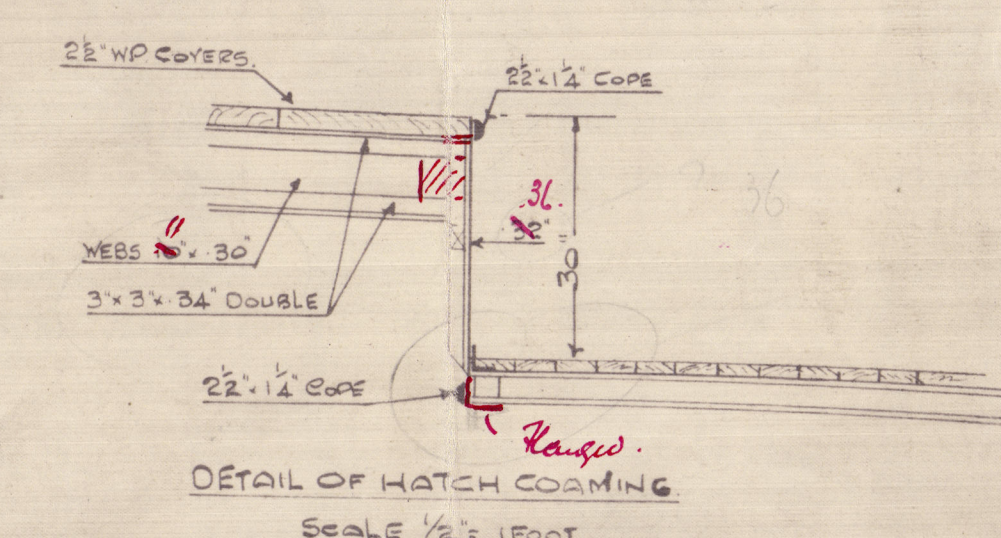
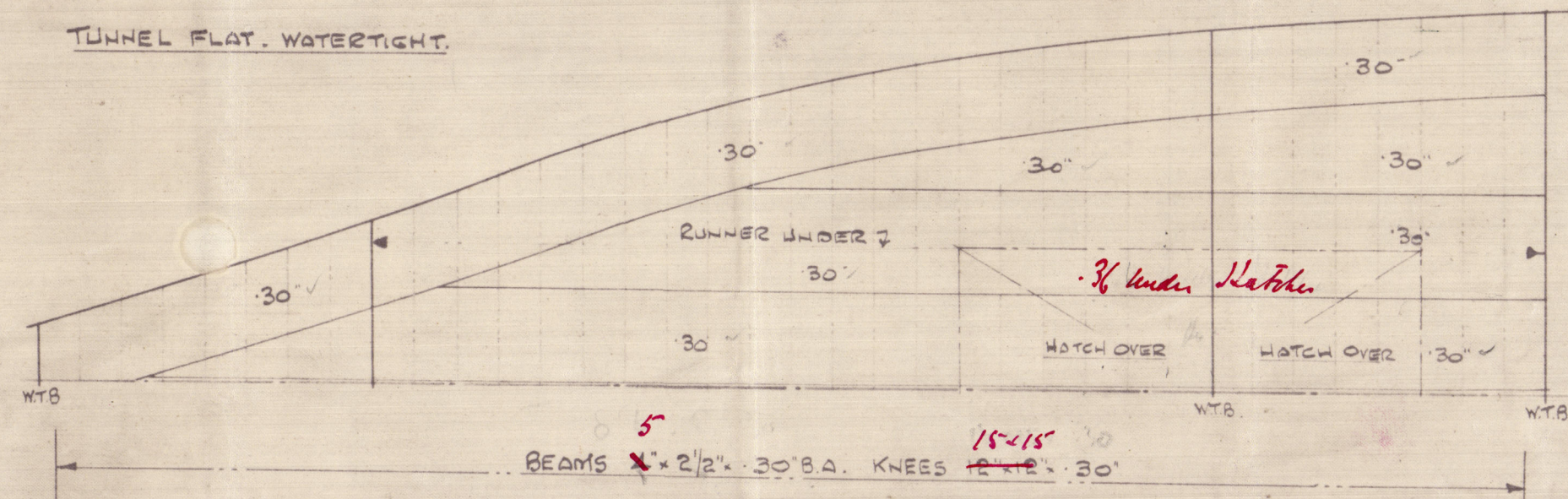
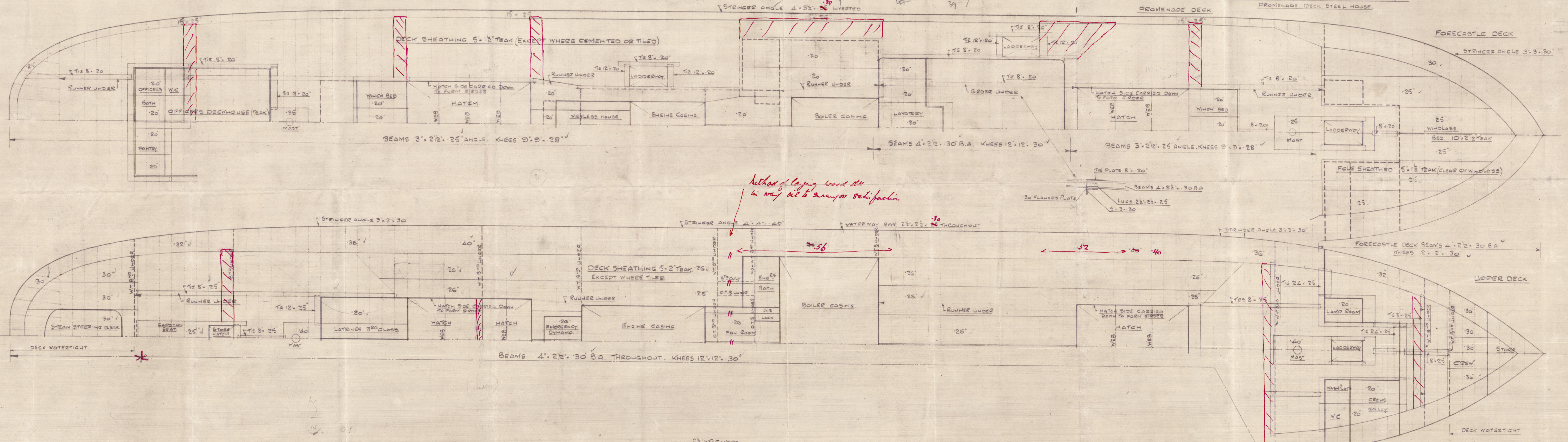
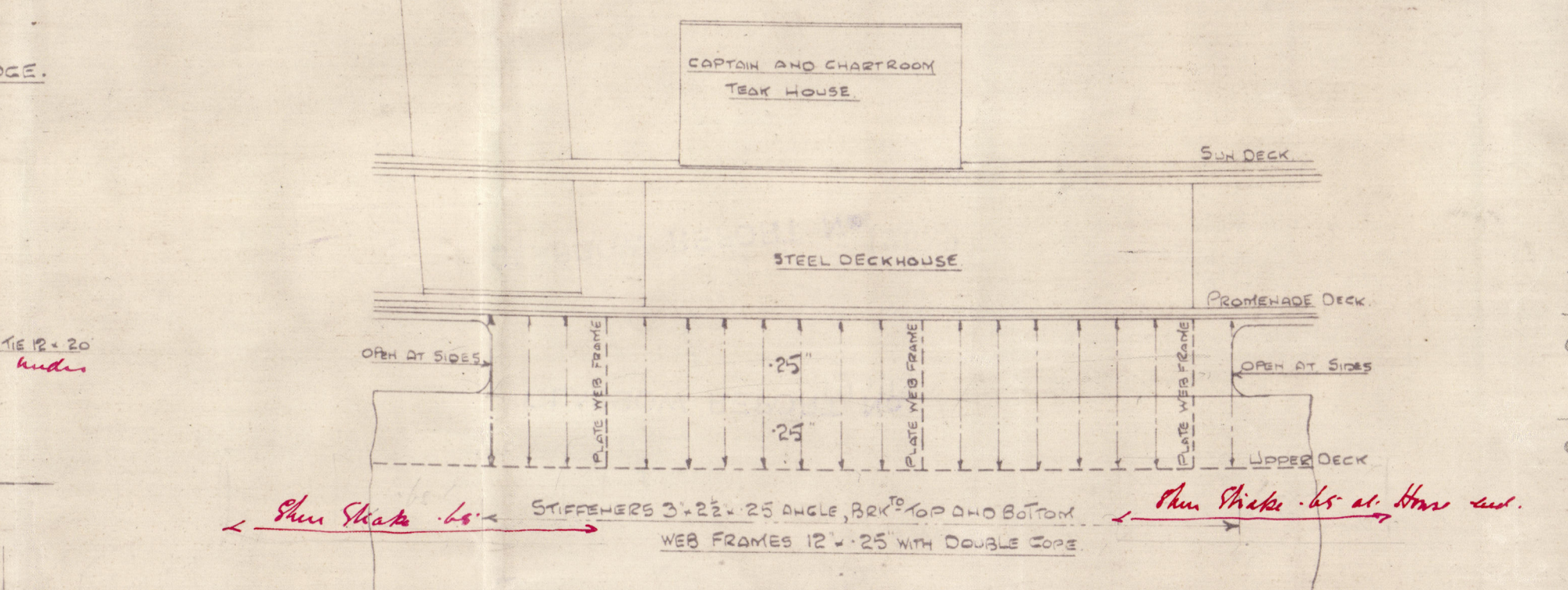
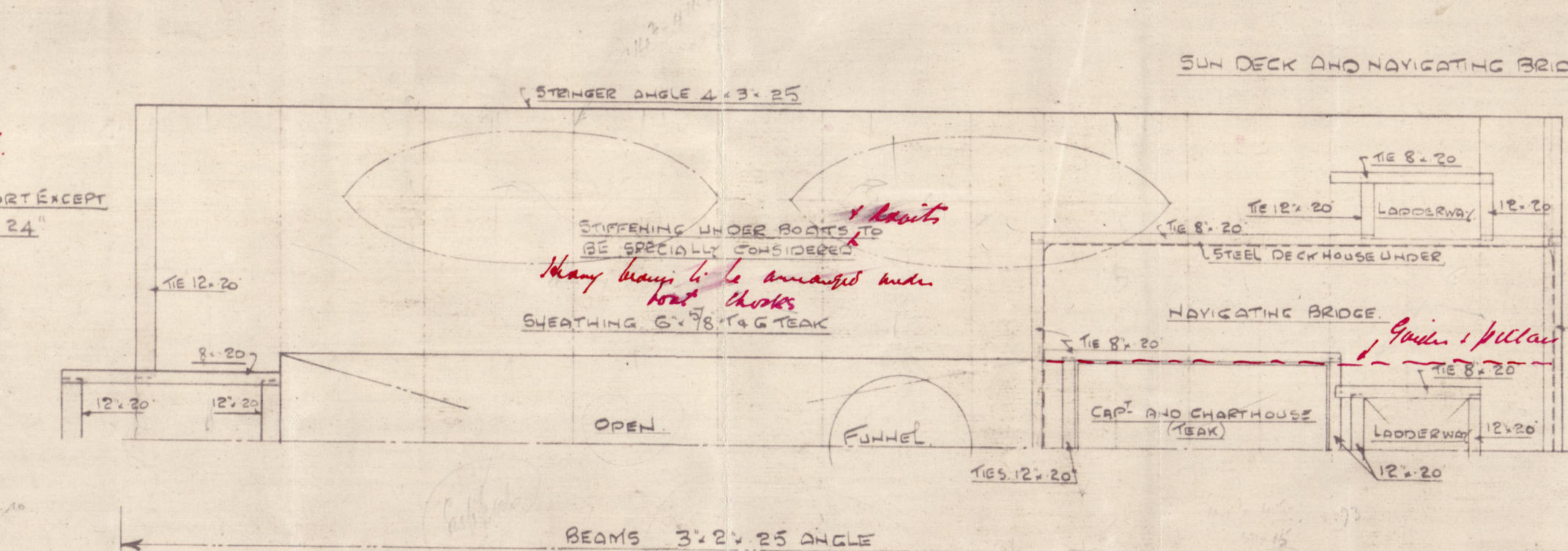
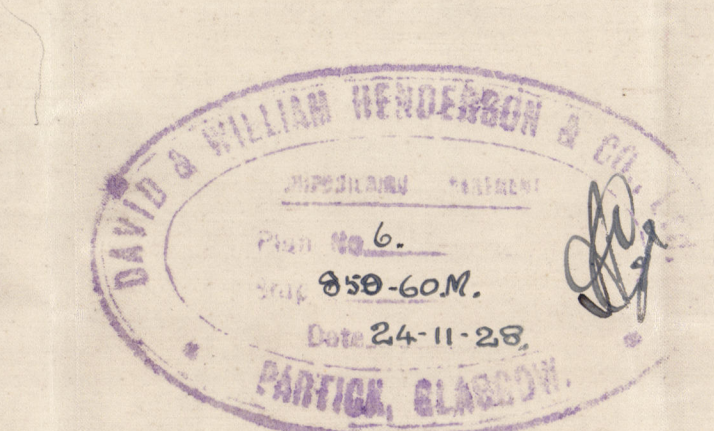

APPROVED  
LLOYD'S REGISTER OF SHIP  
DATE 15.12.28



D. & W. Henderson & Co. Ltd.

No. 859 ~ 860 M.

Profile & decks.

*F. bod*

GLASGOW REPORT No.

49399

*"Irwin"*

GLASGOW REPORT No.

49593

*"Goschen"*

GLASGOW REPORT No.

49682

*T. H. M. M.*



© 2021

Lloyd's Register  
Foundation

010079-010088-0005