

REPORT of SURVEY for REPAIRS, &c.

Report 9th Aug 1920 When handed in at Local Office 9th Aug 1920 Port of **CARDIFF**

Survey held at **Cardiff** Date, First Survey **20th July** Last Survey **5th Aug 1920**

on the **Wood, Iron or Steel** **S/S. SILE (ex War Illius)** Master **F. Duli**

NAME: **6568** Built at **Chepstow** By whom **Monmouth S.B. Co.** When **1920** MONTH **7**

DK. **6261** Owners **Navigazione Generale Italiana** Port belonging to **Genova**

4040 Owners' Address (if not already recorded in Appendix to Register Book).

ved Afloat or in Dry Dock? **Afloat** Name of Dock **Queen Alexandra** Destined Voyage

Cell DBor DBa feet; uE&B feet; f feet; } Particulars of Classification (which must be inserted
Capacity tons. FPT tons; APT tons; MT feet tons. } precisely as in Register Book & Supplements).

All alterations in the existing records should be underlined.

The Vessel has Water Ballast Tanks, state whether the manhole covers have been removed, and the insides examined. Also state the amount of deterioration (if any) found in the thicknesses of the floors, framing, and of the inner bottom plating, especially in the boiler space.

Report, No. **Port**

al Surveys, when held, must be reported in detail and seriatim in the terms of the Rules. State clearly the Repairs, if any, and, in detail, the nature and extent of Examinations and subsequent repairs. Repairs of Damage (the cause of which must be stated) should be separated from Repairs due to other causes: details being detailed in the body of the report, should be summarised in the form shown below. Whenever the ment of Anchors or Chains is reported, the particulars should be clearly stated in the space provided on of this form. State also the dates and initials of any letters respecting this case. **29th July 1920 M**

the cases where the Surveyor has not made a special damage report he is required to state whether he offered his services for this purpose and to whom and why

were declined? **Yes, to Owners representative, 4th July 1920** Was a damage report made by anyone else? If so, by whom? **✓**

S, OR EXAMINATION AS PER RULE, FOR **Damage** **Hand Steering Arrangements** (see Sec. letter

July 1920 M)

Damage to plating and frames caused by striking quay wall of Queen Alexandra dock, Cardiff, on **17th July 1920**, now repaired. Damage confined to starboard side way of **402 hold**.

One indented plate, **3rd below sheer**, removed, faired and refitted; one plate in **4th below sheer** faired in place. Two frames and reverse frames released, faired and riveted in place.

Hand Steering Arrangements

he proposed hand steering arrangement, as approved, not completed. The vessel ing required to proceed before under head extension and hand steering gear **P.T.O**

OF DAMAGE REPAIRS:—	Plates.	Frames.	R. Frames.	Floors.	Beams.	Str. Plates.	Dk. Plates.	Other Items:—
ved	1							
red and Faired or Repaired	1	2						
l or Repaired in place								

CONDITION OF THE	Stringers	Dblg. Plates under Sounding Pipes	Copper, or Y.M. of Wood Vessels
Decks	Inner Bottom Plating	Engine Room Skylights	(State if on Felt.)
	State if Tanks have been examined inside	Coal Bunkers, Open'gs, Lids, &c.	When put on, Month Year
	State if Tanks now tested	Scuppers	Boats
tenings	Bulkheads	Cargo Hatchways	Masts, Yards, &c.
g	Ceiling	Hatches	Condition, how ascertained
ito	Cement or Asphalt (State which.)	Planking of Wood Vessels	(State if wedges removed)
	Rudder	Caulking ditto	Sails
	Steering gear and its connections	Treenails ditto	Equipment letter
Crutches	Windlass	Breasthooks & Stemson ditto	Anchors, No. of
	Have Pumps now been examined and found efficient?	Transoms, Pointers, & Crutches ditto	Cables (State if now ranged)
	Have Sluice Valves now been examined and found efficient?	Timbers of Frame at openings ditto	" length size
	Have Watertight Doors now been examined and found efficient?	Ditto ditto at other places ditto	(on board) size
		Stringers, Clamps & Shells ditto	Hawser & Warps
		Salting ditto	Standing & Running Rigging
		(State if examined.)	

al Observations, Opinion as to Class, Recommendation, &c.:—

State clearly whether any and, if so, what alteration is suggested to be made in the existing classification and notification of the vessel in the Register Book consequent upon survey, thus, for example:—"to remain as now classed in the Register Book without fresh record of Survey," "to remain as classed and to have record of 1,15," or "to remain as classed and to have record of survey, 1,15, and the notations of ss No. 1-15 and ptND15, &c."

This vessel being now as far as seen in good and efficient condition, appears worthy to be classed, as contemplated; the hand steering arrangements to be completed at Owners convenience.

or Section 28) £	✓	Fees applied for, 17 Aug 1920	Alexander Brown Surveyor to Lloyd's Register of Shipping.
Repair Fee (if any) £	5 : 5 : 0	Received by me, 1920	
ences (if chargeable) £	✓		
r's Fee (if any) £	✓		

tee's Minute **FRI SEP. 10 1920**

ter Assigned **As now**

N.D.B. 8,20

010012-010023-0092



Lloyd's Register Foundation

S/S. SILE (see War Jellies)

could be obtained

could be obtained

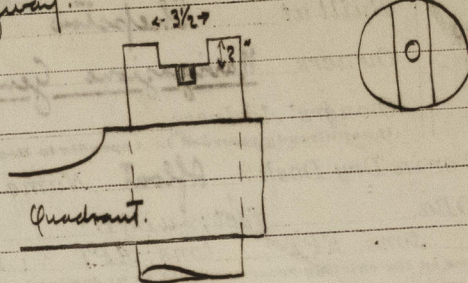
Now done:- Keyway $3\frac{1}{2}$ " wide by 2" deep cut across middle head and a hole $2\frac{1}{2}$ " diam. \times 2" deep bored in bottom of keyway.



In addition is a steam steering gear, This vessel is supplied with wire blocks, etc., for steering by winch.

Alexander Urwin

When Anchors or Cables are supplied, the particulars are to be reported in the following form:—

ANCHORS.

When Anchors.

ANCHORS.

Number of Certificate.	Anchors.*	WEIGHT, EX. STOCK.			WEIGHT OF STOCK.			TEST, PER CERTIFICATE.				WEIGHT REQUIRED by TABLE 30 or 31.			Description of Anchor.	Makers.	Where and when tested at Superintendent.
		Cwts.	qrs.	lbs.	Cwts.	qrs.	lbs.	Tons.	Cwts.	qrs.	lbs.	Cwts.	qrs.	lbs.			
	1st Bower ...																
	2nd "																
	3rd "																
	Collective Weight.																
	Stream																
	Kedge.....																

If Patent name of Patentee.

Clearly stated whether it is a 1st, 2nd, or 3rd bower.

* When a bower anchor is supplied it must be clearly stated whether it is a 1st, 2nd, or 3rd bower.

CHAIN CABLES.

[illegible]

N.B.—If this Report is copied by Copying across, etc.—