

Particolare 3"
Scala 1:5

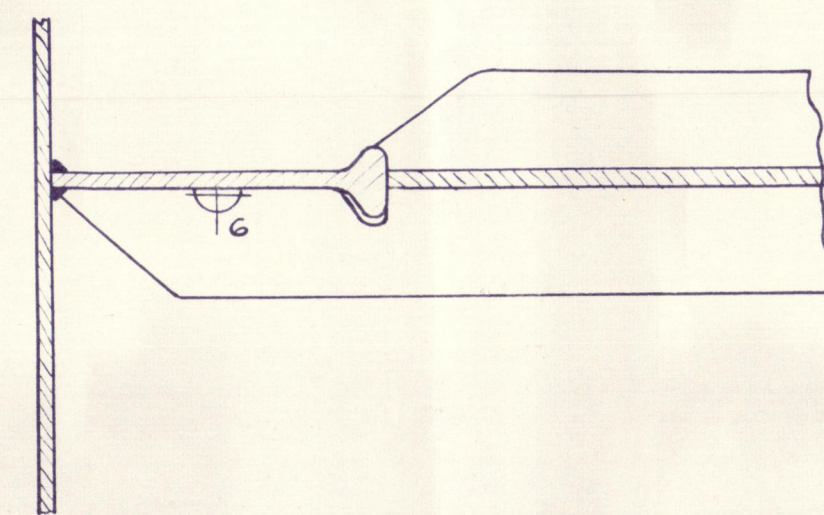

Arquille laterali a 2250 mm dalla M.N.
Scala 1:50

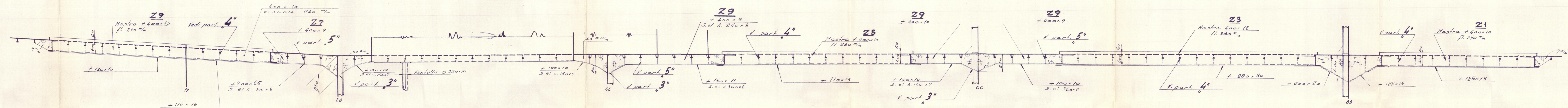

Particolare 4"
Scala 1:5

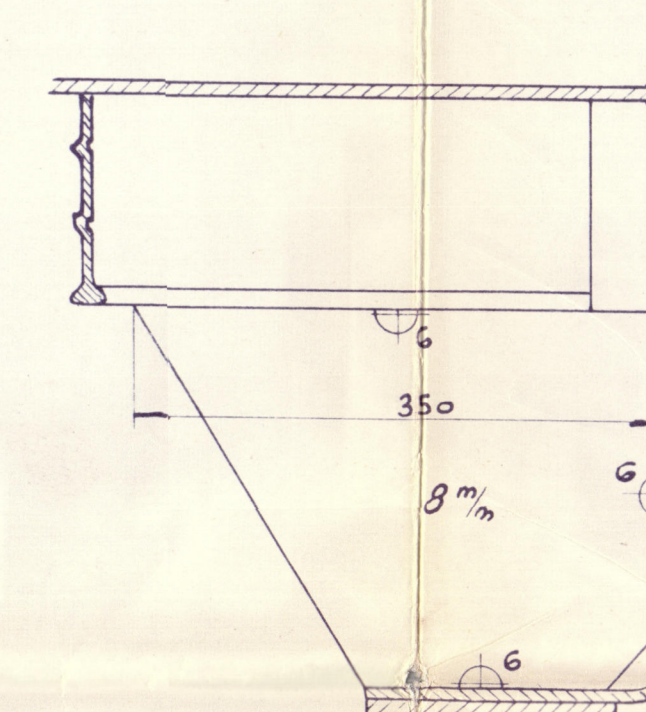

Particolare 6"
Scala 1:5

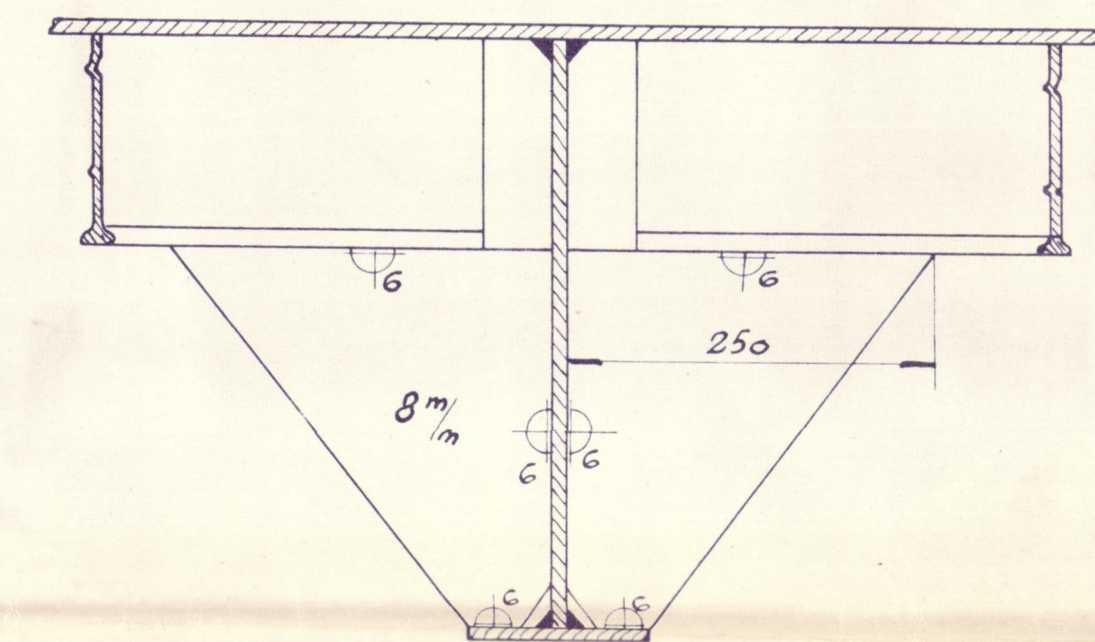

Arquille centrali
Scala 1:50



Particolare 2"
Scala 1:25

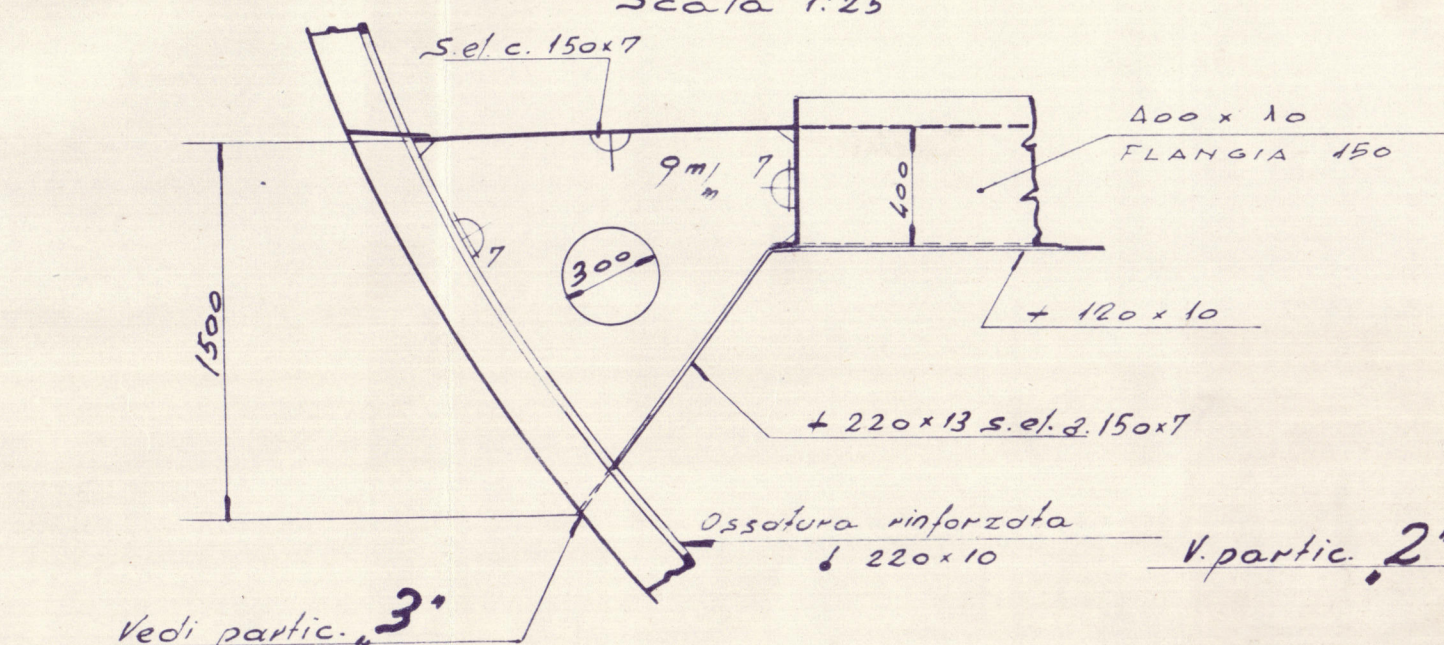

Particolare 5"
Scala 1:5

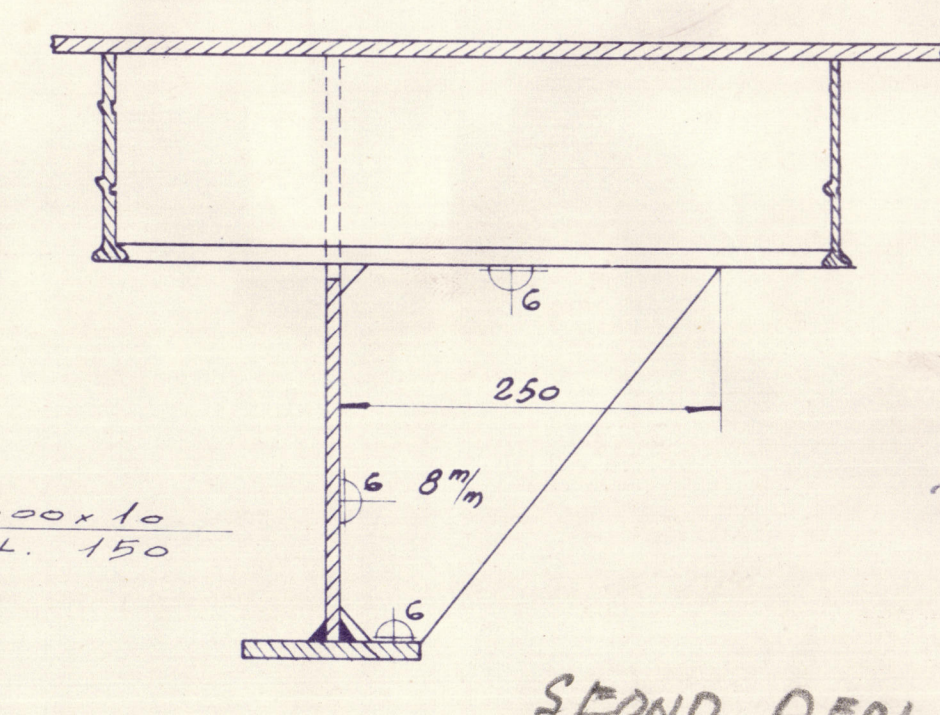

Porte inferiore
Scala 1:50



Particolare 1"
Scala 1:25

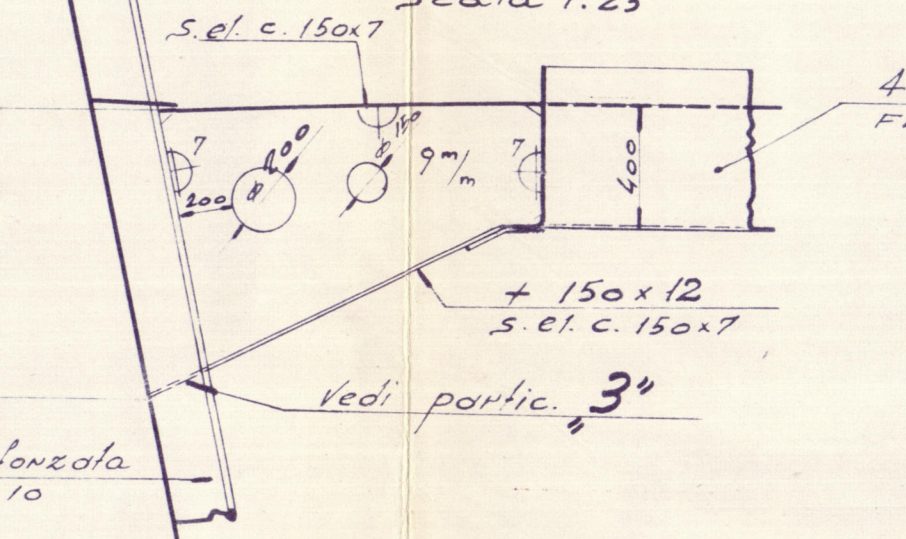

SECOND DECK

Disegno aggiornato in data 11-7-56

Approvato dal RINA in data 3-11-55
Approvato dal L.R. in data 19-10-55
Approvato dal A.B. in data 14-10-55

| | |
|---|--|
| CANTIERE NAVALE GIULIANO S. GIUSTO — TRIESTE — | |
| Motonave da carico | |
| COSTR. N° 45 Modificato | |
| DIS. N° 58 | SCALA: 1:50 - 1:25 - 1:5 |
| Ponte inferiore | |
| DATA: 28-9-55 | DISEGNATO: [signature] CONTROLLATO: [signature] |

004486-004493-187

M.V. "CAPO FARO" 
CANTIERE NAVALE GIULIANO S.GIUSTO
YARD N°. 45
TRIESTE REPORT N°.14470
SECOND DECK

THIS IS A VERIFIED COPY OF THE APPROVED PLAN

SL

RECORDS DEPT..
LONDON.

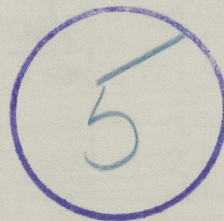

© 2021

Lloyd's Register
Foundation

004486-004487-0187