

# Lloyd's Register of Shipping.

## SURVEYS FOR FREEBOARD.—STEAM SHIPS.

PARTICULARS RELATING TO ALL STEAM SHIPS EITHER FLUSH DECKED, OR WITH TOP GALLANT FORECASTLES, SHORT POOPS AND BRIDGE HOUSES DISCONNECTED, OR WITH TOP GALLANT FORECASTLES HAVING LONG POOPS, OR RAISED QUARTER DECKS CONNECTED WITH BRIDGE HOUSES, OR OTHERWISE.

Port of Survey *Philadelphia Pa.*Date of Survey *while building*Name of Surveyor *J. Lindegreen*

Ship's Name. *now*  
*ex "LYNCHBURG"*  
Number in Register Book *✓*

Port of Registry and Nationality.  
*Ambwarp*  
*American*

Official Number. *✓*Gross Tonnage. *✓*Date of Build. *now building*Particulars of Classification. *\* 100 A1. Contemplated.*

Registered from	LENGTH.	BREADTH.	DEPTH.	UNDER DECK TONNAGE.
300.8	44.00	19.7	2160.3	
300.0	44.24			
300.0	43.58	20.32	21.60	

Efficient of fineness..... *.81*  
Modification necessary { *Cell. 2.13*  
Para. 4 (a) to (e)\* }  
Efficient as corrected ..... *.79*

Stem..... *85* } *127 1/2* ÷ 2 = *63.75* ... Mean *62.27*  
Sternpost..... *42 1/2* } *68 1/2* ÷ 2 = *34.25* ... Mean *62.27*  
at 1/2 of the length from { Stem *46 1/2* } *68 1/2* ÷ 2 = *34.25* ... Mean *62.27*  
Sternpost *22* } *68 1/2* ÷ 2 = *34.25* ... Mean *62.27*  
Mean Sheer ..... *allowed 62.27*  
Standard mean Sheer [Table, Para. 18] ..... *40.00* ✓  
Difference..... *22.27* ÷ 4 = *5.567* ✓  
Limited as Para. 18 (f) ..... *-55* ✓

in Sheer { At front of bridge house.....  
amidships { At after end of forecastle.....  
Para. 18 (e) }

in Sheer { *✓* ÷ 2 =  
Para. 18 (d) }  
uncovered ..... ✓  
Correction ✓

## ALLOWANCE FOR DECK ERECTIONS:—

ard, Table C..... *1-10 1/2* ✓  
tion for Length, if required (Para. 12, 13, and 14) ..... *+ 1* ✓  
ard by Table A. corrected for sheer, and for length, } *4-6 1/4* ✓  
if required (Para. 12, 13, and 14) }  
nce ..... *2-5 1/4* ✓  
age as below..... *28.08%* ✓

on for R. Q. Dk. if engine and boiler openings not }  
vered by bridge house (Para. 11) }  
ee for Deck Erections ..... *-8 1/4* ✓

Length	Length allowed.	Height.
29.00	29.33	7-11 1/2
7.00	75.00	7-11 1/2
29.00	29.00	7-11 1/2
135.33	300.00	44.44

Responding percentage

Para. 12, 13, and 14

*28.08%* ✓

FREEBOARD recommended amidships from centre of Disc to top of Statutory Deck Line, Wood (Iron) Deck:—

Line	above centre of Disc	below
Fresh Water Line	✓	
Indian Summer Line	✓	
Winter Line		✓
Winter North Atlantic Line		✓

State dimensions of freeing port area on back of this form.  
The Surveyor should state whether the fall in sheer as reported is measured relatively to the straight line of keel or to the water line. If measured relatively to water line the vessel's draft at time of survey, and also the usual load draft forward and aft, should be reported.

MARKING FORM

RECEIVED 9 JUL 1928

MARKING FORM

RECEIVED 26 AUG 1928

MARKING FORM

RECEIVED 3- SEP 1928

MARKING FORM

RECEIVED 20 JUL 1928



Do all the Frames extend to the top height in the Poop? *Yes* Raised Quarter Deck? *Yes* Bridge House? *Yes* Forecastle? *Yes*

To what height do the Reverse Frames extend? *Channel frames*

Has the Poop or Raised Quarter Deck an efficient Iron Bulkhead at the fore end? *Yes*

Give particulars of the means for closing the openings in Bulkhead *Hinged wood door*

Is the Poop or Raised Quarter Deck connected with the Bridge House? *No* Has the Bridge House an efficient Bulkhead at the fore end? *Yes*

Give particulars of the means for closing the openings in Bulkhead *Two w.t. steel bolted plates fitted on riveted L bar frames 36" wide*

What is the thickness of the Bridge Front plating? *36* and Coaming plate? *40*

Give scantlings and spacing of the Stiffeners *7" x 3 1/2" x 19 1/2" channels, spaced about 30" apart*

Are bracket plates fitted at each end of the Stiffeners? *Yes* Are hor'l. brackets fitted connecting Bridge Bulk'd. with Bulwarks? *Yes*

Has the Bridge House an efficient Iron Bulkhead at the after end? *Yes*

How are the openings closed? *Two steel hinged w.t. doors 36" wide*

Is the Forecastle at least as high as the main or top-gallant rail? *Yes* Has the Forecastle an efficient Iron or Wood Bulk'd. at after end? *Yes*

Are the Engine and Boiler openings covered by a Bridge, Poop, Raised Quarter Deck, or enclosed by a Strong Iron or Steel Deckhouse? *Covered by Bridge Deck*

If the openings are not so protected are the exposed parts of the Casings efficiently constructed? *Yes*

Give thickness of plating; scantlings and spacing of Stiffeners *Yes*

What is the height of the exposed Casings? *Yes* Are suitable means provided for closing all openings in them in bad weather? *Yes*

Are the Weather Deck Hatchways efficiently constructed and at least equal to the requirements of Section 28 of the Rules for 1904-5? Give particulars below:— *Yes*

Position and Size.		No 1. 30'-0" x 20'-0"		No 2. 30'-0" x 20'-0"		No 3. 30'-0" x 20'-0"		No 4. 30'-0" x 20'-0"			
Item.		Ship.	Rule.	Ship.	Rule.	Ship.	Rule.	Ship.	Rule.	Ship.	Rule.
COAMING.	Height above top of DECK	36"		36"		36"		36"			
	Thickness	50		50		50		50			
	Ends	44		44		44		44			
SHIPPING BEAMS OR WEB PLATES.	Number	5		5		5		5			
	Section and Scantlings	4" x 3" x 1/4"		4" x 3" x 1/4"		4" x 3" x 1/4"		4" x 3" x 1/4"			
	Material	STEEL		STEEL		STEEL		STEEL			
* FORE AND AFTERS.	Number	NONE		NONE		NONE		NONE			
	Section and Scantlings										
	Material										
HATCHES Thickness		3"		3"		3"		3"			
Remarks											

\* The depth of Fore and Afters should be stated from the underside of the hatches in all cases.  
 (If the sill of the lowest side scuttle will be less than 6 inches above the Indian Summer Load Line if assigned under the tables, state vertical distance from top of deck at side amidships to lower edge of lowest side scuttle.)

The following information is to be given in all Cases of vessels dealt with under Paras. 11, 12 (under 15 feet Moulded depth) and under Shelter Deck Rules.  
 What is the thickness of the Bridge Sheerstrake? *Strake between Main and Bridge Sheerstrakes?*

Delete the words { The Crew are, are not, berthed in the bridge house.  
 that do not apply { The arrangements to enable them to go backwards and forwards from their quarters are, are not satisfactory.

Length of Bulwarks in well  
 Area of Freeing Ports required by Para. 11 (e) each side of vessel = Sq. ft.  
 Ft. Tenths. Ft. Tenths. No. } Freeing Ports (each side of vessel) = Sq. ft.  
 Total deficiency or excess = Sq. ft.

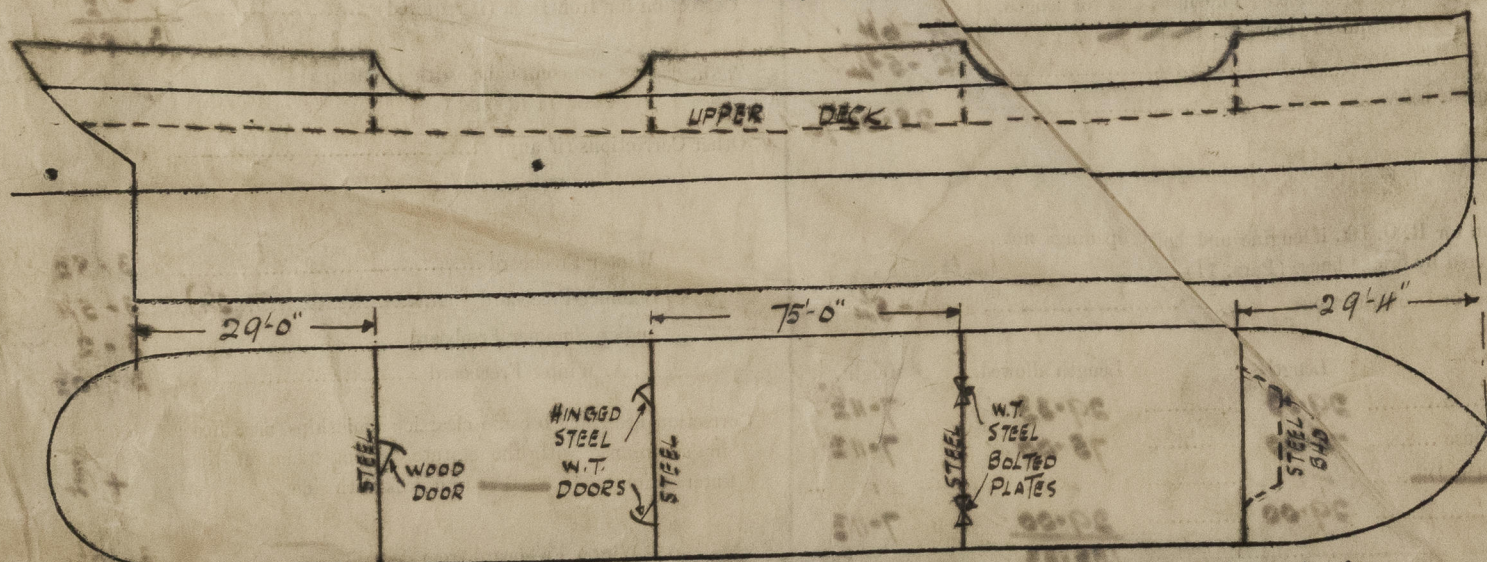

Show hereon line of Floors or Tank Top with position of any Breaks in same; also height of Peak Tank tops, &c., &c.

State any special features in the construction of the Vessel. *This vessel is a sister ship to the same Builders' SS "PIRUA" (No. 1001) Report No. 2778. Copies of the approved plans are in the London Office. The signed Request Form is forwarded herewith.*

Owners  
 Address  
 Fee £5000 to be charged with 1st Entry fee. Received by me