

## EQUIPMENT (Letter, L')

L(B+D)	= 9306
POOPDECK = 52.5 x 7.5	1075
FORECASTLE = 28.2 x 7.0	198
TRUNK = 118.25 x 3.8	455
PUMP ROOM = 2.7 x 7.0	18.9
DECKHOUSE ANCHOR = 13.2 x 0.2	2.6
MOTOR CASING = 3.5 x 4.2	14.8
EN	= 10184

3 DOWN ANCHORS STOCKLESS OF 3075 Kg collective weight

1 UPSTREAM ANCHOR STOCKLESS OF 3627 Kg

385 METRES STUPE CHAIN CABLES OF 35MM DIA, MINIMUM WEIGHT = 10070 Kg

110 METRES STEEL WIRE FOR STRENGTH ANCHOR OF 234, 6.24 SPECIAL FLEXIBLE STEEL WIRE

165 = TANKING, 3" HEMP OR 2 1/4", 6.24 SPECIAL FLEXIBLE STEEL WIRE

165 = HAWKER, 6" = 2", 6.24

165 = HARPER, 5" = 1 1/4", 6.24

## SINGLE-SCREW MOTOR-TANKER

## MIDSHIP-SECTION

Scale 1:25

LENGTH (LLOYDS) . . . . . 60.35 M = 198' 0"

BREADTH . . . . . 9.75 M = 32' 0"

DEPTH . . . . . 4.57 M = 15' 0"

CLASS: LLOYDS REGISTER + 100 A1 CARRYING PETROLEUM IN BULK  
STRENGTHENED FOR NAVIGATION IN ICE

LxD = 2970

L(B+D) = 9306

L/D = 13.2 TO UPPER DECK

L/D = 10.82 TO TRUNK AT SIDE



STIFFENERS IN WAY OF TRUNK

STIFFENERS AT SIDE

STIFFENERS AT SIDE

STIFFENERS AT SIDE

STIFFENERS AT SIDE

STIFFENERS AT SIDE

STIFFENERS AT SIDE

STIFFENERS AT SIDE

STIFFENERS AT SIDE

STIFFENERS AT SIDE

STIFFENERS AT SIDE

STIFFENERS AT SIDE

STIFFENERS AT SIDE

STIFFENERS AT SIDE

STIFFENERS AT SIDE

STIFFENERS AT SIDE

STIFFENERS AT SIDE

STIFFENERS AT SIDE

STIFFENERS AT SIDE

STIFFENERS AT SIDE

STIFFENERS AT SIDE

STIFFENERS AT SIDE

STIFFENERS AT SIDE

STIFFENERS AT SIDE

STIFFENERS AT SIDE

STIFFENERS AT SIDE

STIFFENERS AT SIDE

STIFFENERS AT SIDE

STIFFENERS AT SIDE

STIFFENERS AT SIDE

STIFFENERS AT SIDE

STIFFENERS AT SIDE

STIFFENERS AT SIDE

STIFFENERS AT SIDE

STIFFENERS AT SIDE

STIFFENERS AT SIDE

STIFFENERS AT SIDE

STIFFENERS AT SIDE

STIFFENERS AT SIDE

STIFFENERS AT SIDE

STIFFENERS AT SIDE

STIFFENERS AT SIDE

STIFFENERS AT SIDE

STIFFENERS AT SIDE

STIFFENERS AT SIDE

STIFFENERS AT SIDE

STIFFENERS AT SIDE

STIFFENERS AT SIDE

STIFFENERS AT SIDE

STIFFENERS AT SIDE

STIFFENERS AT SIDE

STIFFENERS AT SIDE

STIFFENERS AT SIDE

STIFFENERS AT SIDE

STIFFENERS AT SIDE

STIFFENERS AT SIDE

STIFFENERS AT SIDE

STIFFENERS AT SIDE

STIFFENERS AT SIDE

STIFFENERS AT SIDE

STIFFENERS AT SIDE

STIFFENERS AT SIDE

STIFFENERS AT SIDE

STIFFENERS AT SIDE

STIFFENERS AT SIDE

STIFFENERS AT SIDE

STIFFENERS AT SIDE

STIFFENERS AT SIDE

STIFFENERS AT SIDE

STIFFENERS AT SIDE

STIFFENERS AT SIDE

STIFFENERS AT SIDE

STIFFENERS AT SIDE

STIFFENERS AT SIDE

STIFFENERS AT SIDE

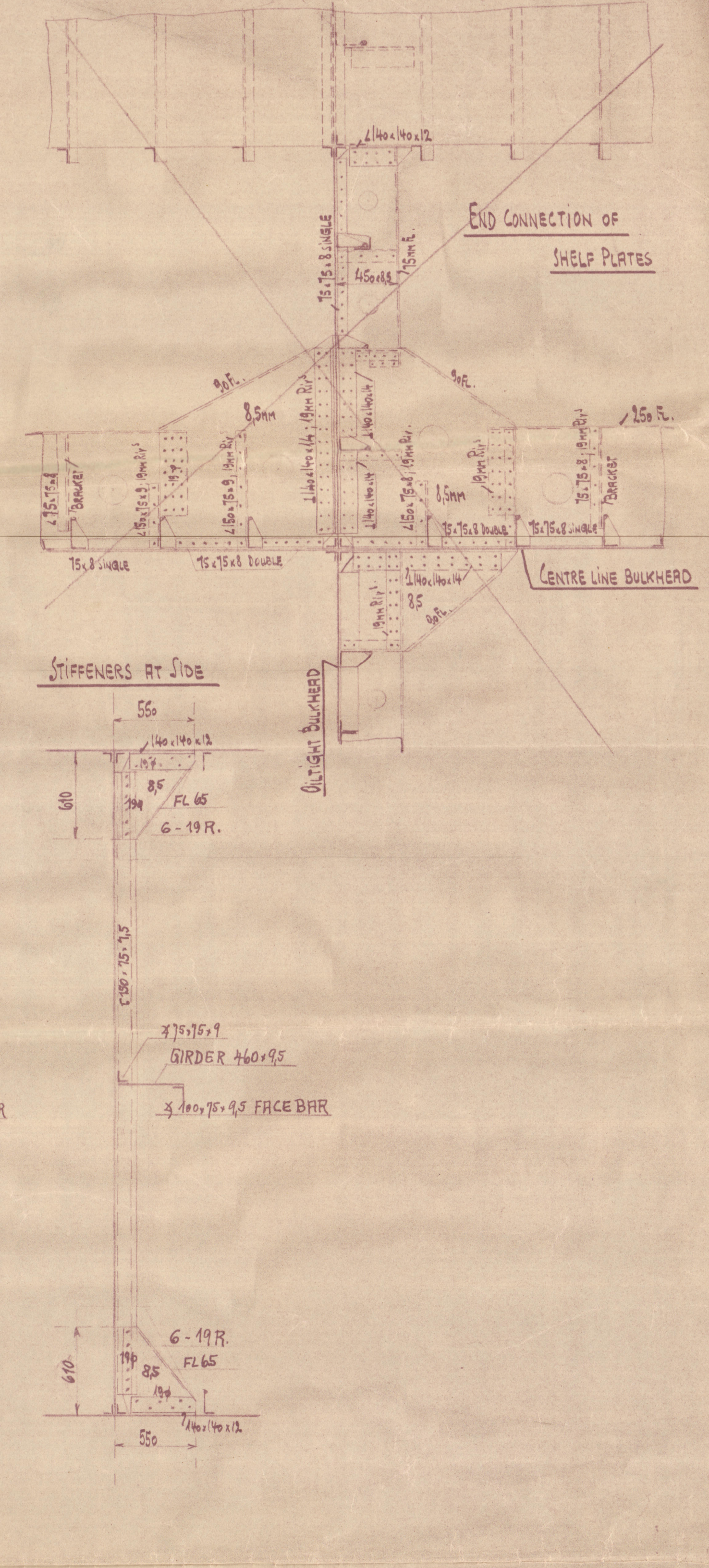

## RIVETING

## SHELL PLATING

SEAMS: DOUBLE RIVETED, WITHIN TANKS, ICE STRENGTHENING AND BOTTOM FORWARD  
SINGLE " ELSEWHERE. SPACING OF RIVETS 3.5 DIA, CLEAR OF OIL 4 DIA

## END LAPS

FLAT KEEL: TREBLE RIVETED FOR 1/4 L, RIVETS SPACED 3 1/2 DIA  
BOTTOM AND BULGE STRAKES: TREBLE FOR 1/4 L TO DOUBLE RIVETS SPACED 3 1/2 DIA  
SIDE PLATING: DOUBLE RIVETED FOR 1/4 L, RIVETS SPACED 3 1/2 DIA  
SHEER STRAKE: TREBLE FOR 1/4 L TO DOUBLE RIVETS SPACED 3 1/2 DIA

## DECK PLATING

SEAMS: ABOVE OIL TANKS DOUBLE RIVETED, RIVETS SPACED 3 1/2 DIA  
CLEAR OF OIL SINGLE RIVETED; RIVETS SPACED 4 1/2 DIA

END LAPS: STRINGER, TRUNK-DECK AND TRUNKSIDE DOUBLE RIVETED; RIVETS SPACED 3.5 DIA

\* STRINGER TREBLE FOR 1/4 L TO DOUBLE  
CLEAR OF OIL SINGLE RIVETED; RIVETS SPACED 4 1/2 DIA  
SPACING OF RIVETS IN STRINGER ANGLE AND TRUNK-SIDE CORNERS 5 DIA  
" " " IN BEAMS = 5 1/2 DIA

## CENTRE LINE BULKHEAD

SEAMS: DOUBLE RIVETED, 3 1/2 DIA APART

END LAPS: DOUBLE RIVETED; RIVETS SPACED 3 1/2 DIA

SPACING OF RIVETS IN STIFFENERS = 6 DIA

" " " IN KEEL AND TOP BARS = 5 DIA

FRAMES TO SHELL RIVETS SPACED = 5 1/2 DIA

## ELEVATION AT BOTTOM GIRDER

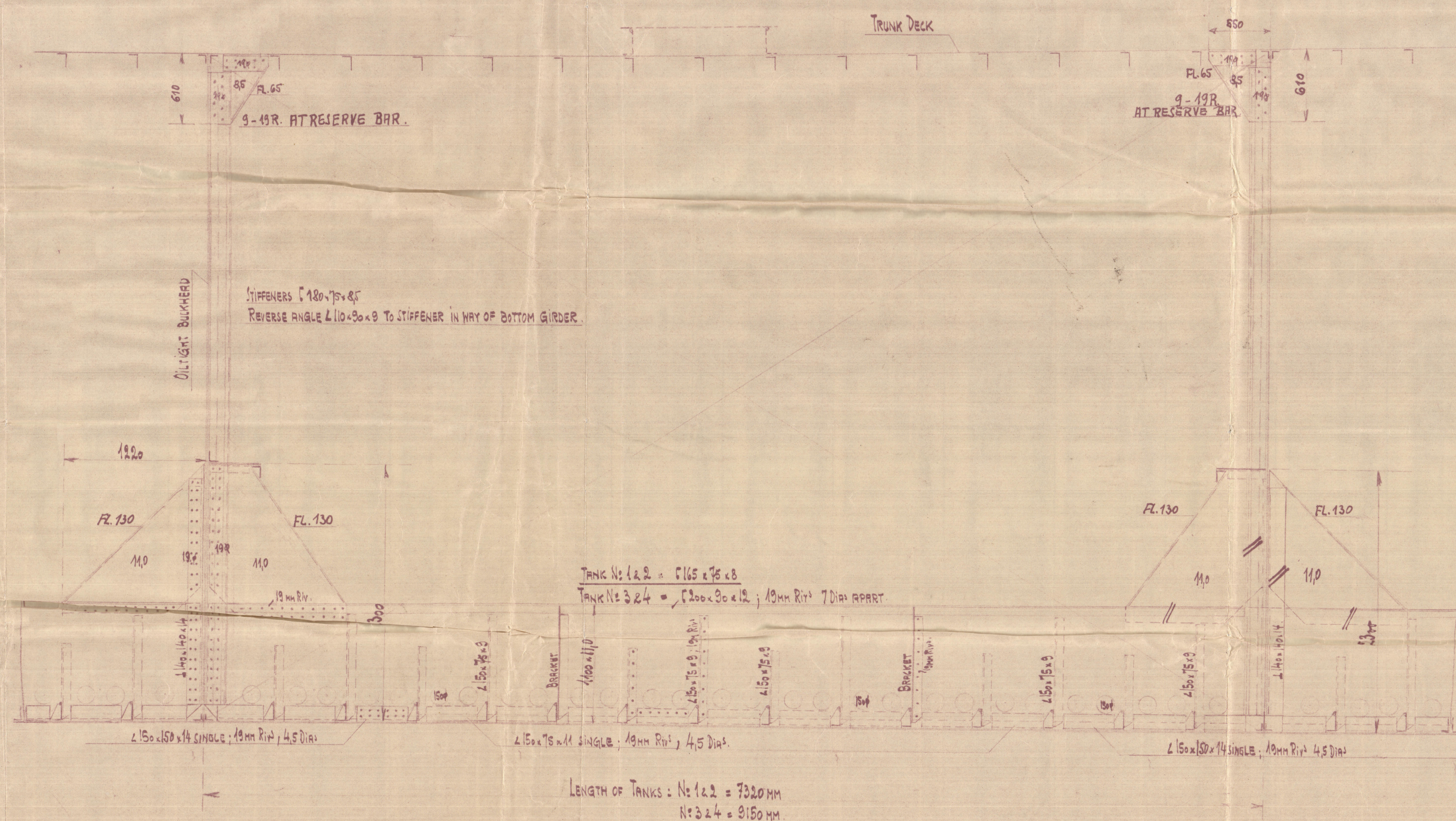
LENGTH OF TANKS: No 1 & 2 = 7020 MM  
No 3 & 4 = 8160 MMDEUTSCHE WERFT  
HAMBURG

D W	DEUTSCHE WERFT HAMBURG	
	SINGLE SCREW MOTORTANKER Midship-Section 2021	
Abt. 1 Gen. 1 1/235 S. 176		Lloyd's Register Foundation

GEÄNDERT NACH DER VON L.R. GENEHMIGTEN  
ZEICHNUNG VOM 23.12.1935. 4.1.1935

009960-009975-0351



OTIS  
M/M. 9972

Midship. Section



© 2021

009962-009975-0351

Lloyd's Register  
Foundation