

MIDSHIP SECTION

VESSEL OF T. S. MINESWEEPER TOWN CLASS

CONVERTED TO
PASSENGER STEAMER

Scale $\frac{1}{2}" = 1 \text{ foot}$

CLASS

TO CLASS 100A FOR SPECIAL SERVICE
IN BRISBANE HARBOUR AND BAY

MEAN LOAD DRAFT ~~NOT TO EXCEED 8'-6"~~

See letter

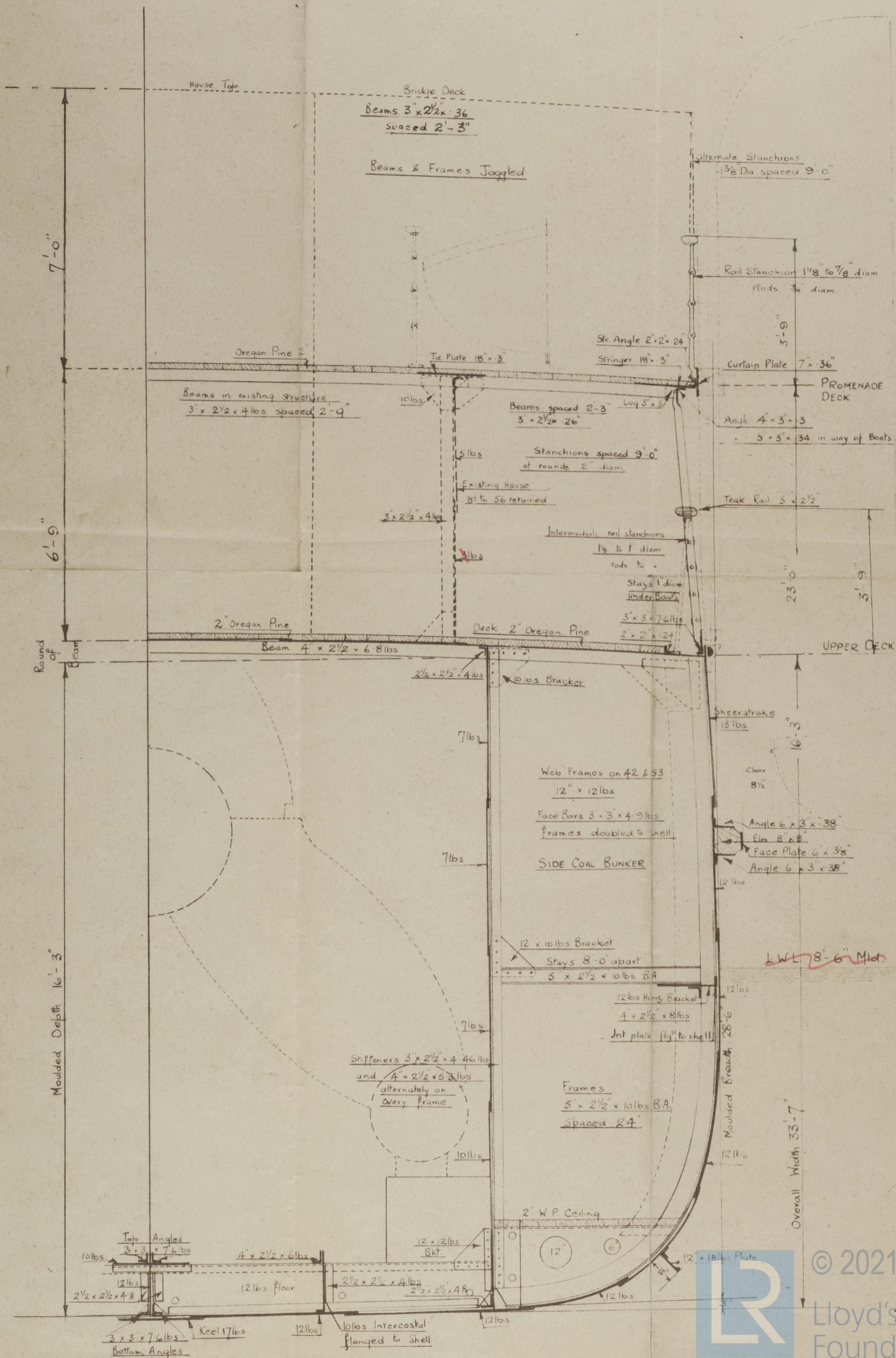

0007 2/2



EASTER
CONSTRUCTION
COMPANY
LIMITED

ENCLOSURE TO

Lloyd's Register
Glasgow