

## MIDSHIP SECTION

VESSEL OF T. S. MINESWEEPER TOWN CLASS

CONVERTED TO  
PASSENGER STEAMER

Scale  $\frac{1}{2}" = 1 \text{ foot}$

CLASS

TO CLASS ~~100A~~ FOR SPECIAL SERVICE  
IN BRISBANE HARBOUR AND BAY  
MEAN LOAD DRAFT ~~NOT TO EXCEED 8' 6"~~

See letter

26.1.23.22:1:23 *Shel*

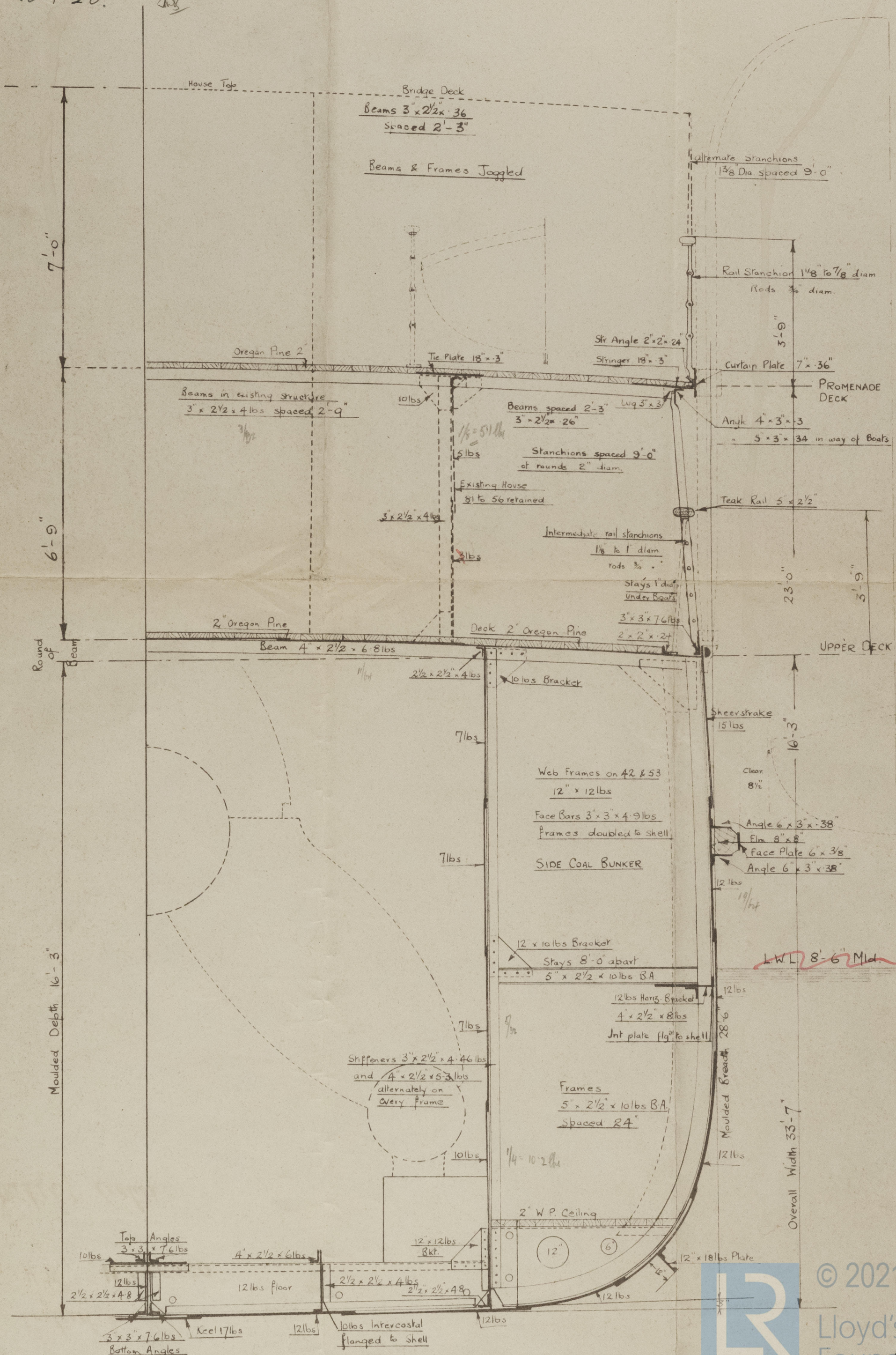

© 2021

W.J.  
26.1.23.

26.1.23.

009757-009770-0005 1/2





**ENCLOSURE TO**

*Lloyd's Register*

*Glasgow*

0005 2/2

Coastal Construction Co.

Contract No. 115.

Re H.M.S. "WEXFORD" <sup>1923</sup>

Midship Section.



© 2021

Lloyd's Register  
Foundation

009757-009770 0005 1/2