

# Lloyd's Register of Shipping.

## SURVEYS FOR FREEBOARD.

### (CONDITIONS OF ASSIGNMENT.)

Ship's Name **HELGA MOLLER** Port of Survey **SHANGHAI.**  
 Official Number **171170** Surveyor's Signature *G. Pinner*  
 Nationality and Port of Registry **BRITISH. SHANGHAI.** Date of Survey **26<sup>th</sup> AUGUST. 1938**

Disposition and dimensions of superstructures, trunks, deckhouses and machinery casings to be inserted in the diagrams and tabular statement:—

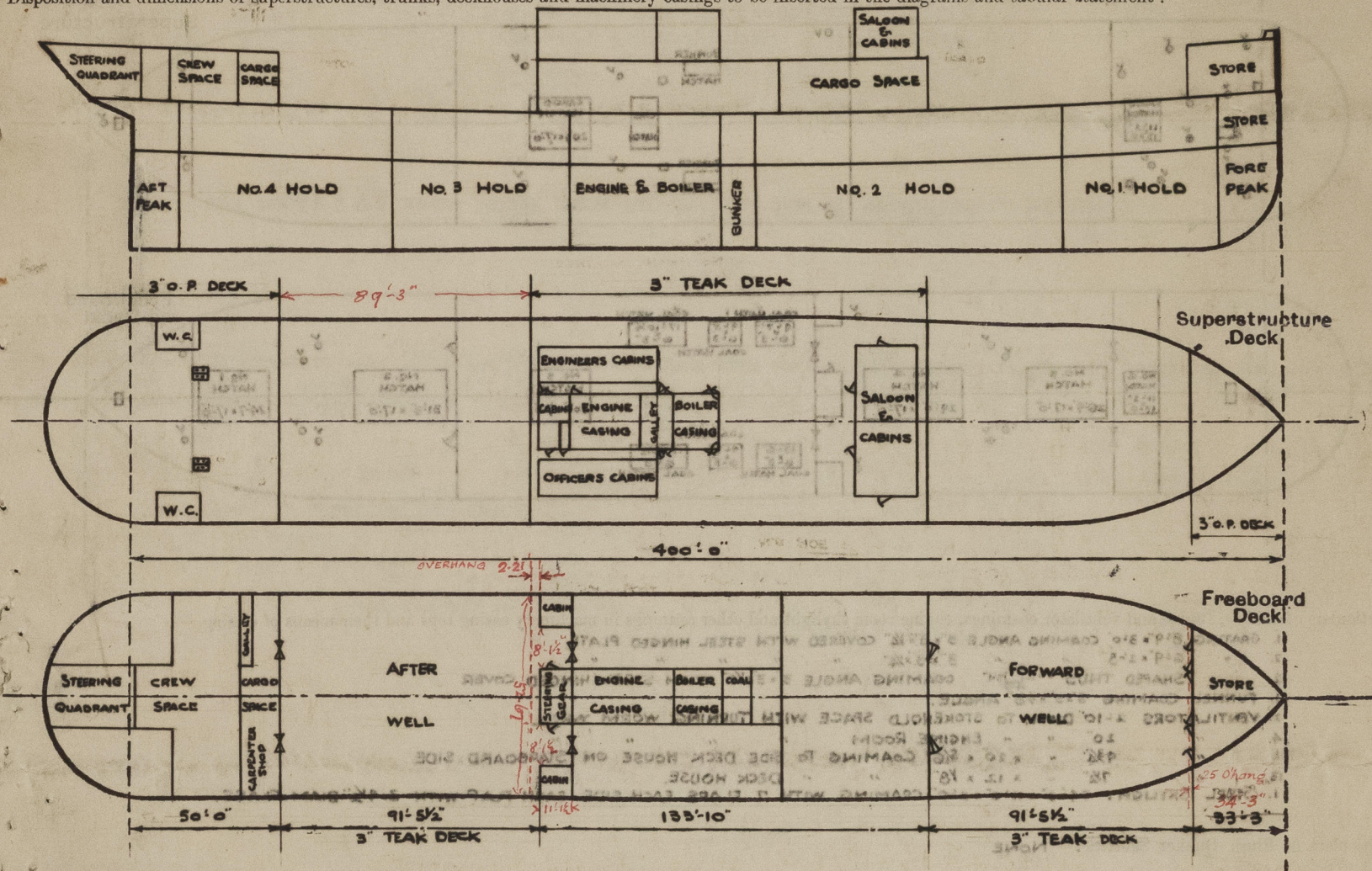

Particulars of Superstructures, Trunks, Casings, Deckhouses.

	Coaming	Plating	Stiffeners	Spacing	End Attachments of Stiffeners	Size of Openings	Height of Sills	Height of Casings
Poop Bulkhead ...	18"	3/8"	7-3-1/2 BA	26 1/2"	BRACKET 17-18-3/8 TOP AND BOTTOM	2-3-1/2 x 4-11"	15"	7-11"
Raised Quarter Deck Bulkhead ...	14 1/2"	3/8"	3 1/2 x 5-3/8"	29"	—	2-3-3/8 x 4-11"	16"	7-11"
Bridge, After Bulkhead ...	18"	3/8"	8 1/2 x 4-1/2 BA	25"	BRACKET 18-18-3/8 TOP AND BOTTOM	2-2-1 x 4-11" TO E.R.	19"	7-11"
Bridge, Forward Bulkhead ...	18"	3/8"	—	—	—	2-3-3/8 x 4-9 1/2"	18 1/2"	7-11"
Forecastle Bulkhead ...	18"	3/8"	—	—	—	2-3-3/8 x 4-10"	18 1/2"	7-11"
Trunk, Aft ...	—	—	—	—	—	2-2-0 x 4-10"	—	—
Trunk, Forward ...	—	—	—	—	—	—	—	—
Exposed Machinery Casings on Freeboard or Raised Quarter Decks ...	—	—	—	—	—	—	—	—
Exposed Machinery Casings on Superstructure Decks ...	13"	8/20"	4 1/2 x 3-3/8"	30"	BRACKET 33-30-7/8 ON TOP	2-2-0 x 5-0" } B.R. 2-2-0 x 3-9" } E.R. 2-3-0 x 4-10" }	14"	7-9"
Machinery Casings within Superstructures not fitted with Class I Closing Appliances ...	—	—	—	—	—	—	—	—
Deckhouses on Flush Deck Ships ...	—	—	—	—	—	—	—	—

Particulars of Closing Appliances (state if capable of being manipulated from both sides).

Poop Bulkhead ...	2. OPENINGS COVERED BY 4" THICK OREGON PINE SLIDING IN 5-1/2 x 1/4 CHANNELS UP AND DOWN.
Raised Quarter Deck Bulkhead ...	2. OPENINGS COVERED BY 3/8" STEEL PLATE IN HALVES FASTENED TO ANGLE FRAME IN WAY OF OPENING BY 14 HOOKS OPERATED OUTSIDE ONLY
Bridge, After Bulkhead ...	2. OPENINGS TO ENGINE ROOM & STEERING GEAR HOUSE COVERED BY 1/4" STEEL HINGED DOOR. OPERATED OUTSIDE ONLY
Bridge, Forward Bulkhead ...	2. OPENINGS COVERED BY 3/8" STEEL HINGED DOOR IN HALVES & CLOSED BY 6 BUTTERFLY BOLTS & NUTS. OPERATED OUTSIDE ONLY
Forecastle Bulkhead ...	2. OPENINGS COVERED BY 1/4" STEEL HINGED DOOR IN HALVES WITH PADLOCK & SPLIT PIN. OPERATED OUTSIDE ONLY.
Exposed Machinery Casings on Freeboard or Raised Quarter Decks ...	2. OPENINGS COVERED BY 1/4" STEEL HINGED DOOR WITH PADLOCK. OPERATED OUTSIDE ONLY.
Exposed Machinery Casings on Superstructure Decks ...	2. OPENINGS TO STOREHOUSE COVERED BY 1/4" STEEL HINGED DOOR. 2. OPENINGS TO VENT FOR CONVEYING ASH FROM BOILER ROOM COVERED BY 1/4" STEEL HINGED DOOR
Machinery Casings within Superstructures not fitted with Class I Closing Appliances ...	2. OPENINGS TO GALLEY COVERED BY 1/4" STEEL HINGED DOOR IN HALVES. 1. OPENING TO ENGINE ROOM IN PORT SIDE ALLEYWAY COVERED BY 1/4" STEEL HINGED DOOR
Deckhouses on Flush Deck Ships ...	PORT SIDE ALLEYWAY WITH 1 WOOD DOOR EACH END. STARBOARD ALLEYWAY WITH 1 WOOD DOOR ON FORE END ONLY.



"HELGA MOLLER"

Particulars of Gangway Cargo and Coaling Ports:— **NONE**

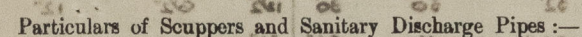

3.	2½"	BORE SCUPPER	PIPES ON STARBOARD SIDE OF BRIDGE DECK LED TO SHIP SIDE 2'6" ABOVE FREEBOARD DECK.
3.	2½"	" " PORT " " " " " " " " " " " " " " " "	2'6"
2.	4"	SANITARY DISCHARGES FROM BRIDGE BATH & W.C. LED TO SHIP SIDE (STARB)	4'-9" BELOW FREEBOARD DECK WITH C.I. STORM VALVE & BRASS FLAP
4.	2½"	" " " " " " " " " " " " " " " "	4'-9"
2.	4"	" " " " " " " " " " " " " " " "	(PORT) 4'-9"
2.	2½"	" " " " " " " " " " " " " " " "	4'-9"
1.	4"	" POOP " W.C. EACH SIDE LED TO SHIP SIDE (P.S.)	4'-9" BELOW FREEBOARD DECK WITH C.I. STORM VALVE & BRASS FLAP
4.	2½"	" UNDER " BATH " " " " " " " " " " " "	(P.S.) 4'-9"
1.	13"	SQUARE ASH SHOOT P.S. FROM BRIDGE DECK LED TO SHIP SIDE 15" ABOVE FREEBOARD DECK.	

- Particulars of Side Scuttles:—

[illegible]

LOWEST SIDE SCUTTLE ABOVE TOP OF KEEL 34'-0" X

HAND RAIL STANCHIONS ON POOP DECK 3'-7 1/2" ABOVE DECK. SPACED 4'-3" APART WITH 3 RAILS, ONE TOP 1 7/8" DIA. TUBE, TWO LOWER 3/4" DIA. ROD.  
 " " " " FORECASTLE DECK 3'-7 1/2" " " " 4'-7" " " " " " 1 7/8" " " " " 3/4" " "  
 BULWARK ON BRIDGE DECK SAME AS BULWARK IN FOR<sup>P</sup> & AFTER WELLS, BULB PLATE STAY 7'-0 1/2" SPACED 3'-2" APART

Particulars of Gangways, Lifelines, etc. :—

RIGGED AS REQUIRED

Particulars of Freeing Arrangements.

1. STEEL SKYLIGHT P. 6.5. ON POOP DECK OVER CREW SPACE 4'-3" X 4'-0" GLASSING 15" 5/16" WITH 4 STEEL HINGED FLAPS. EACH FLAP WITH 1, 1 1/2" DIAM. CLEAR GLASS.

2	18"	DIAM.	x 2' 5" = 5'6"	COAMING ON POOP DECK TO UNDER POOP DECK SPACE.
2	20"	"	x 2' 6" = 5'6"	" " " " " TWEEN DECK & HOLD.
6	7 1/2"	"	x 1' 2 1/2" = 1'4"	" " " " " UNDER POOP DECK SPACE.
2	20 1/8"	"	x 3' 0" = 3'7 1/2"	" IN AFTER WELL TO TWEEN DECK & HOLD.
2	20 1/2"	"	x 2' 4" = 4'4"	" " " " " " " " " " (Deckhead)
2	7 1/2"	"	x 1' 5" = 1'4"	" ON BRIDGE DECK TO UNDER BRIDGE DECK SPACE
4	12"	"	x 2' 9" = 1'4"	" " " " " { 2. TO UNDER BRIDGE DECK SPACE
4	20 1/4"	"	x 3' 0" = 3'7 1/2"	" IN FORWARD WELL TO TWEEN DECK & HOLD.
2	2 1/2"	"	x 13' 5" = 1'4"	" ON FORECASTLE DECK " " " " "
2	7 1/2"	"	x 1' 2 1/2" = 1'4"	" " " " " " " " " " " UNDER FORECASTLE DECK SPACE
1	12"	"	x 2' 0" = 1'4"	" " " " " " " " " " " FORECASTLE STORE & FORE PEAK STORE

State position of each freeing port ... ( After Well :— 12'5", 28'5", 44'5", 60'5", & 76'6" FROM BRIDGE AFT. } 15' ABOVE DECK EDGE ✓  
(F. and A. position and height above deck edge) ( Forward Well :— 25'0", 39'6", 53'6", 67'4" & 81'4" } FORECASTLE  
3. 5" x 3" SEMI-ROUND DRAIN HOLES CUT IN GUNWALE BAR EACH SIDE OF AFTER WELL, 2.5" x 3" SEMI-ROUND DRAIN HOLES CUT IN GUNWALE BAR EACH SIDE OF FORWARD WELL.  
State whether the freeing ports are fitted with shutters, bars, or rails, and give particulars of such :—  
3. 3/4" DIAM. ROD FITTED HORIZONTAL EACH FREEING PORT. ✓  
Additional area where sheer is less than standard.

4.	2½"	"	"	"	AFTER WELL	21"	"	"	TANK 1½" ABOVE DECK.
4.	2½"	"	"	"	ON BRIDGE DECK	21"	"	"	4. 2½" BORE IN FORWARD WELL TO DOUBLE BOTTOM TANK 21"
4.	2½"	"	"	"	"	21"	"	"	ABOVE DECK.
1.	2½"	"	"	"	"	19"	"	"	1. 2½" BORE ON FORECASTLE DECK TO DOUBLE BOTTOM TANK
2.	2½"	"	"	"	"	26½"	"	"	11" ABOVE DECK.
1.	3"	"	"	"	"	19"	"	"	1. 2½" BORE ON FORECASTLE DECK TO FORE PEAK TANK
1.	3½"	"	"	"	"	18"	"	"	19' ABOVE DECK.
1.	3½"	"	"	"	"	20"	"	"	

Additional area where sheer is less than standard.



## PARTICULARS OF PROTECTION TO OPENINGS, ETC.

HATCHWAYS ON FREEBOARD AND SUPERSTRUCTURE DECKS.															1 ON FORECASTLE DECK & 1 UNDER FORECASTLE DECK
FREEBOARD DECK							BRIDGE DECK				POOP DECK			HATCH TO STORE	
Description of Hatchway	No. 1	No. 2	No. 3	No. 4	No. 5	No. 6	CARGO HATCH	COAL HATCH	COAL BUNKER HATCH P.E.S.	HATCH OVER ASH SHOOT	CARGO HATCH	HATCH TO CAPSTAN SHOP	HATCH TO STEERING QUADRANT SPACE	HATCH TO STORE	
Dimensions of Hatchway	24'-7" 17'-0"	31'-3" 17'-0"	26'-1" 17'-0"	29'-0" 17'-0"	26'-9" 17'-0"	11'-2" 13'-0"	20'-1" x 17'-0"	8'-0" x 16'-6"	11'-3" x 5'-0"	2'-2" x 2'-3"	11'-2" 13'-2"	2'-0" 2'-0"	1'-9" x 1'-10 1/2"	4'-5" x 3'-3"	
COAMINGS	Height above Deck ... 42" Thickness ... 8/30 Stiffeners ... 1/2" x 1/2" Brackets, Stays ...						42"	31"	32"	30"	30"	13/2"	6/2"	12"	
HATCH BEAMS	Number ... 3 Spacing ... 6'-2" Scantling and Sketch ...						3	1 CHANNEL			5'-7"				
FORE AND AFTERS	Number ... 4 Spacing ... 6'-2" Unsupported Lengths ... 17'-0" Scantling* and Sketch ...						4	1 CHANNEL			5'-7"				
HATCH COVERS	Material ... O.P. Thickness ... 3/4" How fitted ... F.E.A. Bearing Surface ... 1/8"						O.P.	O.P.	O.P.	1/8" THICK	O.P.	W.T. STEEL HINGED COVER	1/4" THICK STEEL HINGED COVER	O.P.	
Spacing of Cleats	2'-0"	2'-0"	2'-0"	2'-0"	2'-0"	2'-0"	2'-0"	1'-11"	2'-2"	—	2'-0"	—	—	2 CLEATS EACH SIDE	
Number of Tarpaulins	3	3	3	3	3	3	3	3	3	—	3	—	—	3	

\*Are wood fore and afters steel shod at all bearing surfaces? —

Are battens and wedges efficient and in good condition? YES

Are tarpaulins in good condition and in accordance with rule requirements? YES

Are lashings provided in accordance with rule requirements? YES

**MATCHES OVER SIDE BUNKER ON FREEBOARD DECK.**

1. EACH SIDE 17'-10 1/2" x 6'-3"

1. ON PORT 9'-3" x 6'-3"

1. ON STARBOARD 13'-6" x 6'-3"

1. HATCH TO AFTER PEAK ON FREEBOARD DECK IN WAY OF POOP 6'-0" x 5'-3" WITH 3" WOOD COVER

COAMING 3'-0" x 3'-0" 2 1/2" HATCH COVER BEARING SURFACE 2 1/2" HATCH COVER FITTED THRTWARTSHIP balling arounds. & 1 tarpaulins.

Particulars of any special features :—

Endorsement at first survey and at surveys for renewal of Certificate :—

The fittings and appliances are in accordance with the particulars shown on this form (or as now modified) and are in good condition.

G. Pinneri P.