

MIDSHIP SECTION

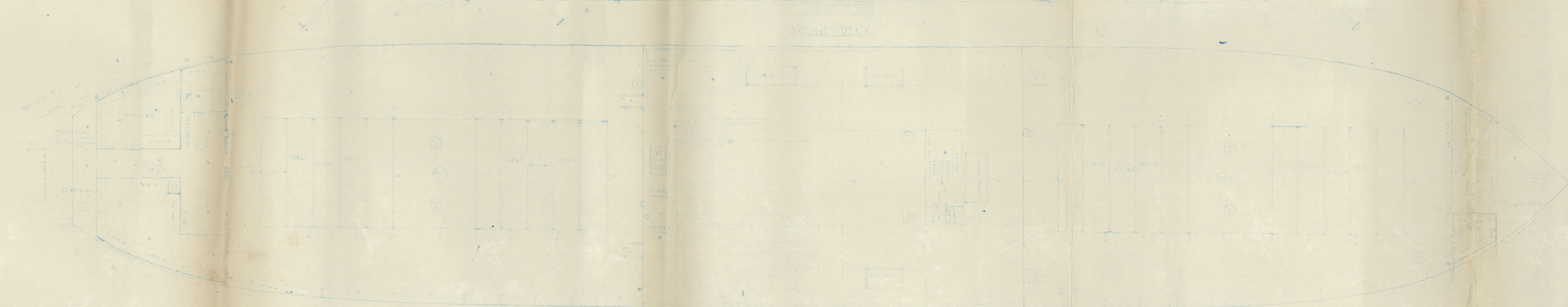
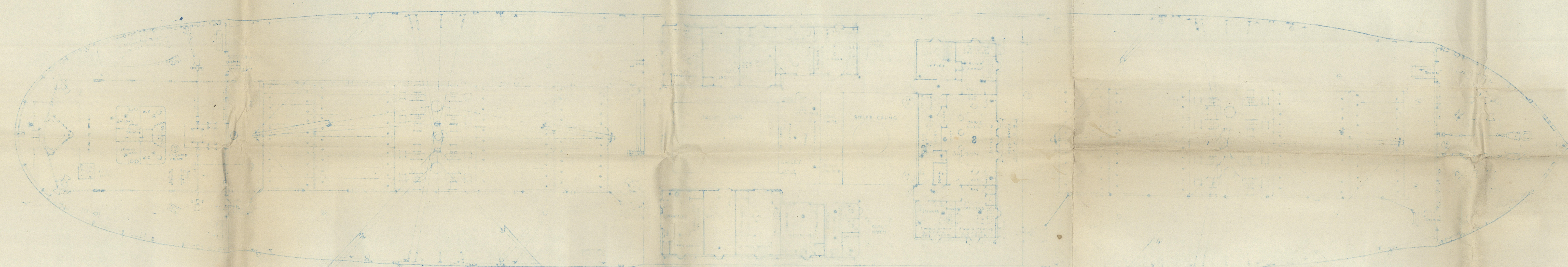
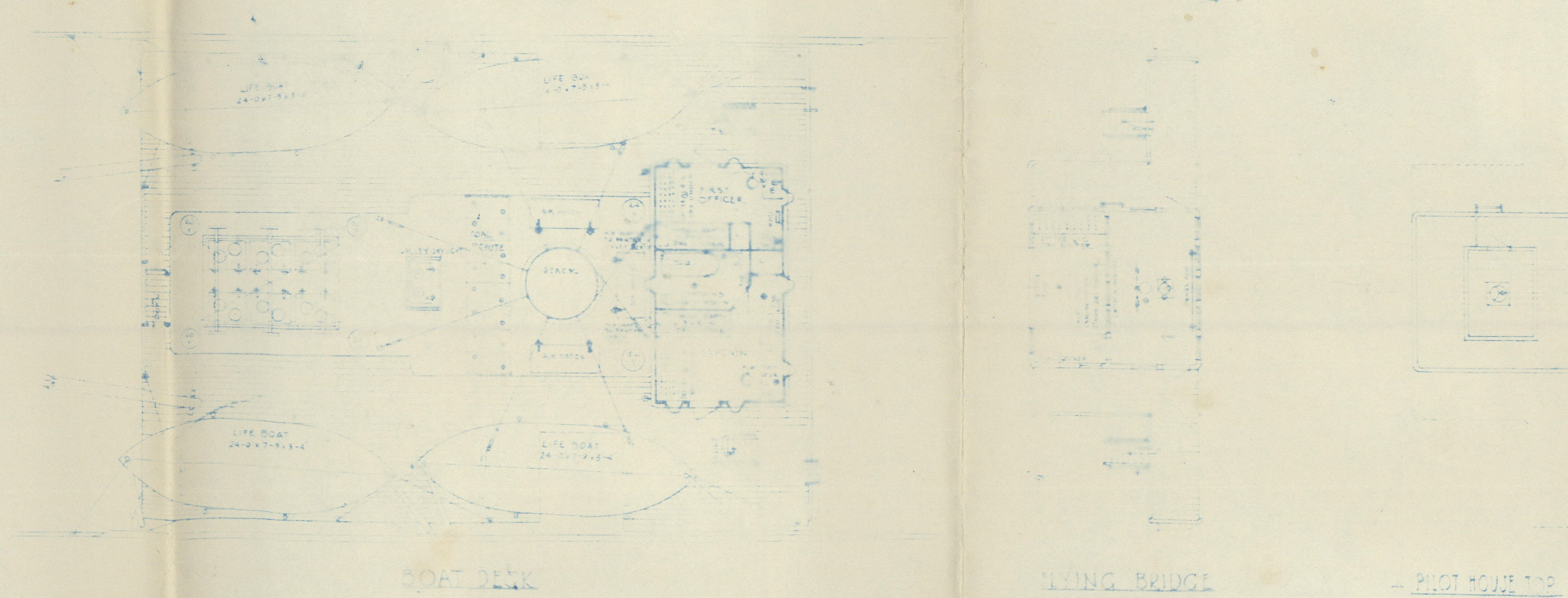

PRINCIPAL DIMENSIONS	
LENGTH OVER ALL	281'-0"
LENGTH BTW. PERPENDICULARS	251'-0"
MOULDED BREADTH	43'-6"
MOULDED DEPTH	24'-0"
GROSS TONNAGE	3,500
NET TONNAGE	2,500
MAXIMUM CARRYING CAPACITY ADHPT	3,500 TONS
LOADED SUMMER WINDWARD DRAFT	27'-10"
LENGTH OF POOP DECK	35'-0"
BRIDGE	25'-0"
FORECASTLE DECK	25'-0"
FORWARD HOLD	94'-0"
ENGINE & BOILER SPACE	42'-0"
AFT HOLD	26'-0"
ENGINE AND BOILERS	
ENGINE	TRIPLE EXPANSION
CYLINDERS	20 x 33 x 26
STROKE	40"
2 BOILERS	DIA. 15' 0" LENGTH 11' 0"
HEATING SURFACE	5,000 sq. ft. 2 BOILERS
PRESSURE	150 LBS. PER SQ. IN.

APPROVED
SEP 30 1927
LLOYD'S REGISTER OF SHIPPING
NEW YORK

5/8 "CERRO GORDO"

LONDON COPY

DAUGALL & SONS LTD
PHILADELPHIA