

N<sup>o</sup> 881 T S.S. AMUR MARU.

# MIDSHIP SECTION

LENGTH B.P 425'-0" BREADTH M<sup>ld</sup> 56'-3" DEPTH M<sup>ld</sup> 32'-6"

ISHERWOOD SYSTEM.

SCALE 1/2 IN. TO ONE FT.

## NUMERALS

BREADTH M <sup>ld</sup>	56.25	TRANSVERSE N <sup>o</sup>	
DEPTH	32.50	LONGITUDINAL N <sup>o</sup>	
LENGTH	88.75		
	425		
L/D SHELTER DECK	10.49		

## EQUIPMENT.

2 BOWERS STOCKLESS	73 1/2 CWTs	} TOTAL 220 1/2 C.WTS.
1 " " "	73 1/2 " "	
1 STREAM EX. STOCK	20 1/2 " "	
1 KEDGE " " "	9 " "	
300 FATHOMS 2 5/8" STEEL CHAIN CABLE.		
120 " 5" STEEL WIRE	2 @ 90 FATHOMS 7" CIR.	
130 " 5 1/2" " " TOWLINE.	3 STRADS WARP LAID	
2 @ 100 " 8" HAWSER OR 2 3/4" STEEL WIRE.	2 @ 90 FATHOMS 7" CIR.	
2 @ 100 " 8" WARP OR 2 3/4" " "	3 STRANDS CABLE LAID.	

KEEL BUTTS QUADRUPLE OVERLAPS TO TREBLE AT ENDS.  
SHELL PLATING BUTTS TREBLE RIVETED OVERLAPS FOR & AFT.  
SHELTER DECK SHEERSTAKE BUTTS QUADRUPLE OVERLAPS FOR 1/2 L. TO TREBLE AT ENDS.  
SHELTER DECK STRINGER BUTTS TREBLE OVERLAPS FORE & AFT.  
" " PLATING BUTTS DOUBLE OVERLAPS FOR 1/2 L. TO SINGLE AT ENDS.  
UPPER DECK STRINGER BUTTS TREBLE OVERLAPS FORE & AFT.  
" " PLATING BUTTS DOUBLE OVERLAPS TO SINGLE AT ENDS.  
2<sup>ND</sup> DECK STRINGER BUTTS DOUBLE OVERLAPS FORE & AFT.  
" " PLATING BUTTS DOUBLE OVERLAPS TO SINGLE AT ENDS.  
TANK TOP CENTRE STRAKE BUTTS TREBLE OVERLAPS TO DOUBLE AT ENDS.  
" " REMAINDER BUTTS DOUBLE OVERLAPS TO SINGLE AT ENDS.  
TANK SIDE BUTTS TREBLE FORE & AFT.  
CENTRE GIRDER BUTTS TREBLE OVERLAPS FORE & AFT.

## THICKNESS OF LONGITUDINAL BRACKETS.

BRACKETS CONNECTION DECK LONGITUDINALS TO BULKHEADS .40" THICK.  
" " SIDE " IN TWEEN DECKS TO BULKHEADS .40" THICK.  
" " " " " HOLDS TO BULKHEADS .44" THICK.  
" " TANK TOP & SHELL LONGITUDINALS TO TANK DIVISIONS .40" THICK.

TANK TOP CENTRE 4.5" x .52" - .42"  
DOUBLE CONTINUOUS WHERE C<sup>s</sup> GIRDER TOP BARS ARE INTERLY.  
3 1/2 x 3 1/2 x .52" - .48" INTERCOSTAL.  
CENTRE GIRDER 4.5 x .54" - .44"  
DOUBLE 6" x 6" x .44".  
4 1/2 x 4 1/2 x .60" - .56".  
FORE & AFT BRACKET UNDER PILLAR.

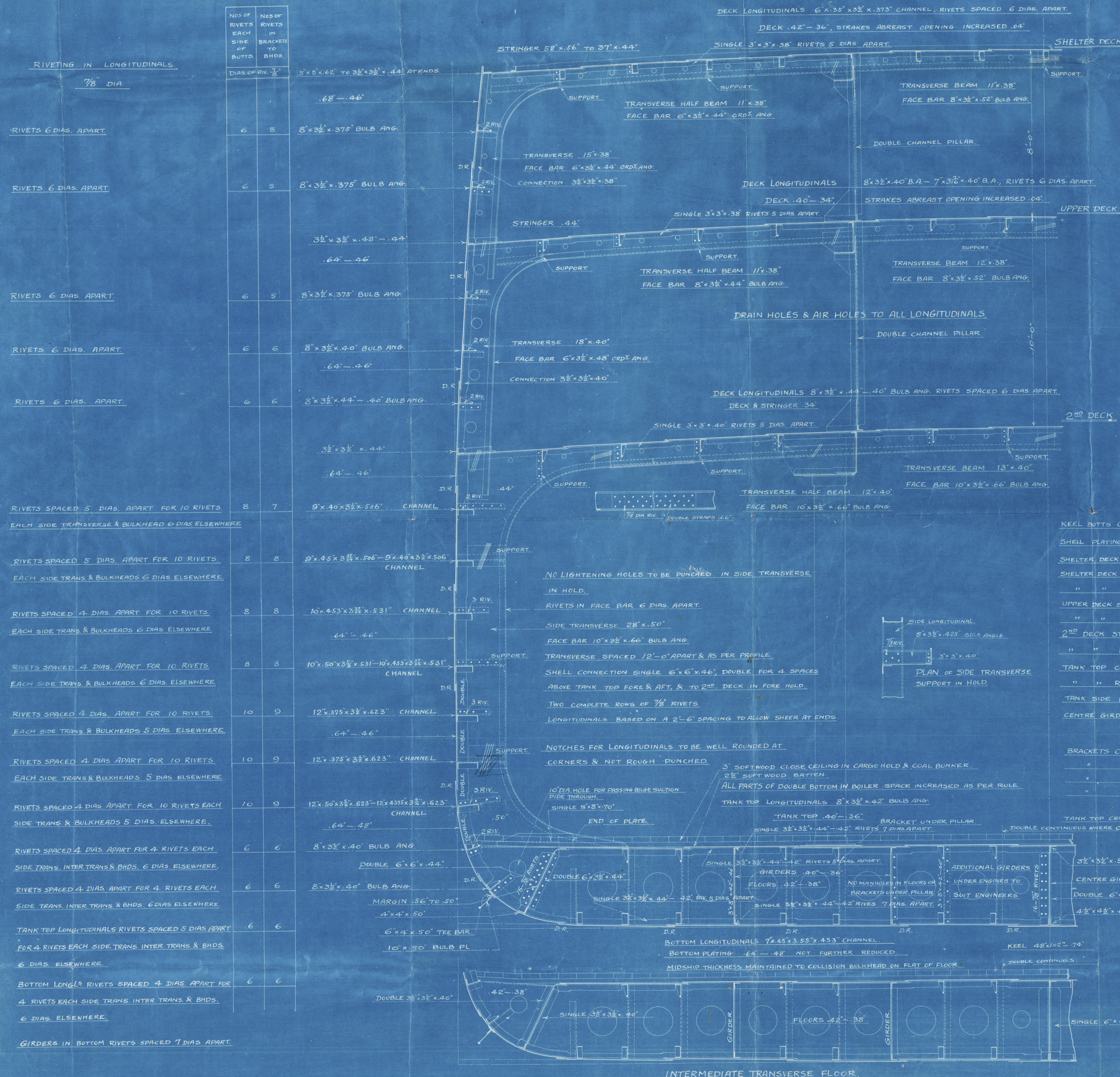
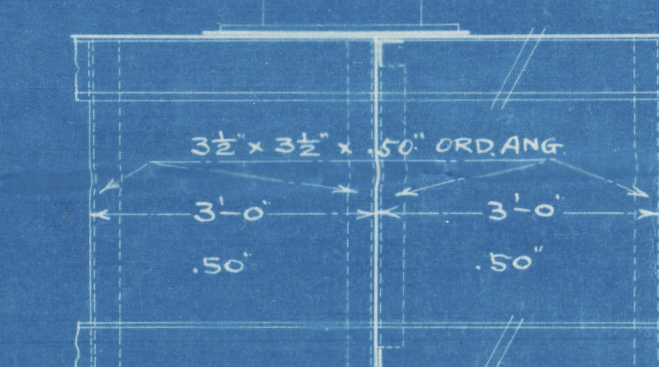

RIVETING IN LONGITUDINALS.	NOS OF RIVETS EACH SIDE OF BUTTS	NOS OF RIVETS IN BRACKETS TO BHDS.
7/8" DIA.		
RIVETS 6 DIAS. APART.	6	5
RIVETS 6 DIAS. APART.	6	5
RIVETS 6 DIAS. APART.	6	5
RIVETS 6 DIAS. APART.	6	6
RIVETS 6 DIAS. APART.	6	6
RIVETS SPACED 5 DIAS. APART FOR 10 RIVETS EACH SIDE TRANSVERSE & BULKHEAD 6 DIAS. ELSEWHERE	8	7
RIVETS SPACED 5 DIAS. APART FOR 10 RIVETS EACH SIDE TRANS. & BULKHEADS 6 DIAS. ELSEWHERE	8	8
RIVETS SPACED 4 DIAS. APART FOR 10 RIVETS EACH SIDE TRANS. & BULKHEADS 6 DIAS. ELSEWHERE	8	8
RIVETS SPACED 4 DIAS. APART FOR 10 RIVETS EACH SIDE TRANS. & BULKHEADS 6 DIAS. ELSEWHERE	8	8
RIVETS SPACED 4 DIAS. APART FOR 10 RIVETS EACH SIDE TRANS. & BULKHEADS 5 DIAS. ELSEWHERE	10	9
RIVETS SPACED 4 DIAS. APART FOR 10 RIVETS EACH SIDE TRANS. & BULKHEADS 5 DIAS. ELSEWHERE	10	9
RIVETS SPACED 4 DIAS. APART FOR 10 RIVETS EACH SIDE TRANS. & BULKHEADS 5 DIAS. ELSEWHERE	10	9
RIVETS SPACED 4 DIAS. APART FOR 4 RIVETS EACH SIDE TRANS. INTER TRANS. & BHDS. 6 DIAS. ELSEWHERE	6	6
RIVETS SPACED 4 DIAS. APART FOR 4 RIVETS EACH SIDE TRANS. INTER TRANS. & BHDS. 6 DIAS. ELSEWHERE	6	6
TANK TOP LONGITUDINALS RIVETS SPACED 5 DIAS. APART FOR 4 RIVETS EACH SIDE TRANS. INTER TRANS. & BHDS. 6 DIAS. ELSEWHERE	6	6
BOTTOM LONG <sup>s</sup> RIVETS SPACED 4 DIAS. APART FOR 4 RIVETS EACH SIDE TRANS. INTER TRANS. & BHDS. 6 DIAS. ELSEWHERE	6	6
GIRDERS IN BOTTOM RIVETS SPACED 7 DIAS. APART.		



Amur Maru.

O. I. W 881

Mid. Sea.

Kobe Rpt No 2544

N/ M "Mansei Maru"



© 2020

Lloyd's Register  
Foundation

009469-009480-0152