

<u>LENGTH BETWEEN PERPS.</u>	<u>164'-0" ✓</u>
<u>BREADTH MOULDED</u>	<u>33'-0" ✓</u>
<u>DEPTH</u>	<u>8'-6" ✓</u>

— MIDSHIP SECTION —

— S.S. N^o 243. —

— To CLASS A.I. AT LLOYDS —

— PORTSMOUTH & ISLE OF WIGHT. —

— EQUIPMENT. —

ANCHORS 2 BOWERS STOCKLESS 12 CWT'S EACH. ✓

1 STREAM $1\frac{3}{4}$ " Ex. Stock. ✓

1 KEDGE $\frac{3}{4}$ " " " ✓

CABLES 120 FATHOMS 1" DIA. STUD CHAIN CABLE ✓

50 " $\frac{3}{4}$ " STREAM CHAIN ✓

ALL TESTS & WEIGHTS AS PER RULES ✓

FRAMES

IN WAY OF FORECASTLE, ALL TO PROMENADE DECK. ✓
 " " " SIDE PLATING, ALTERNATELY TO " " ✓
 " " " BULWARK, " " RAIL &
EVERY 4TH. TO PROMENADE DECK.

RIVETING

7.
BUTTS OF ALL STRINGERS & TIES LAPPED & D.R. ✓
" " KEEL PLATE " " " " ✓
" " SWELL TO MAIN DECK " " " " ✓
ALL LANDINGS EXCEPT KEEL & SNEERSTAKE S.P. ✓
ALL RIVETS % D.R. EXCEPT STEM, STERNPOST & RUDDER ✓
KEEL & SNEERSTAKE BUTTS & LANDINGS ✓

SCANTLINGS

STEM OF IRON $6' \times 1\frac{1}{2}'$ ✓
STEM POST " INNER POST $6' \times 8\frac{1}{4}"$ ✓
 " " OUTER " $5' \times 3\frac{1}{2}"$ ✓
RUDDER " STOCK $9\frac{1}{2}'$ DIA. HEEL $3\frac{1}{2}'$ DIA. ✓
PINLES $2\frac{1}{2}'$ DIA. SINGLE PLATE $\frac{5}{16}"$ THICK ✓
FRAMES ANGLE $3' \times 2\frac{1}{2}' \times \frac{5}{16}"$ SPACED $15" C^{RS}$ ✓
REL FRAMES " $2\frac{1}{2}' \times 2\frac{1}{2}' \times \frac{5}{16}"$ TO MAIN DECK & UPPER ✓
TURN OF BILGE ALTERNITELY DOUBLE ✓
CROSS FLOORS H E B SPACE ✓
BULKHEADS 6 WT OF STEEL $\frac{5}{16}"$ THICK ✓
SEE ALSO NOTE VERY STIFFS $2\frac{1}{2}' \times 2\frac{1}{2}' \times \frac{5}{16}"$ SPACED $36"$ ✓
ON PROFILE ONE HORIZONTAL STIFF $2\frac{1}{2}' \times 2\frac{1}{2}' \times \frac{5}{16}"$ ✓
SINGLE FRAME $3\frac{1}{2}' \times 3\frac{1}{2}' \times \frac{5}{16}"$ ✓
FLOORS $11' \times \frac{5}{16}"$ FOR ALL TO $\frac{5}{16}"$ IN E & B SPACE $22"$ ✓

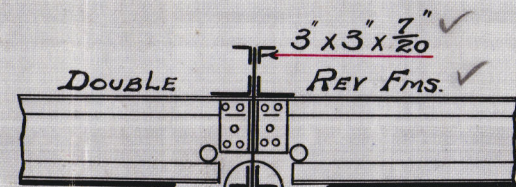

SECTION IN WAY OF
E. & B. SPACE ✓

SCALE $\frac{1}{2}$ INCH = ONE FOOT.

DRAWING No.

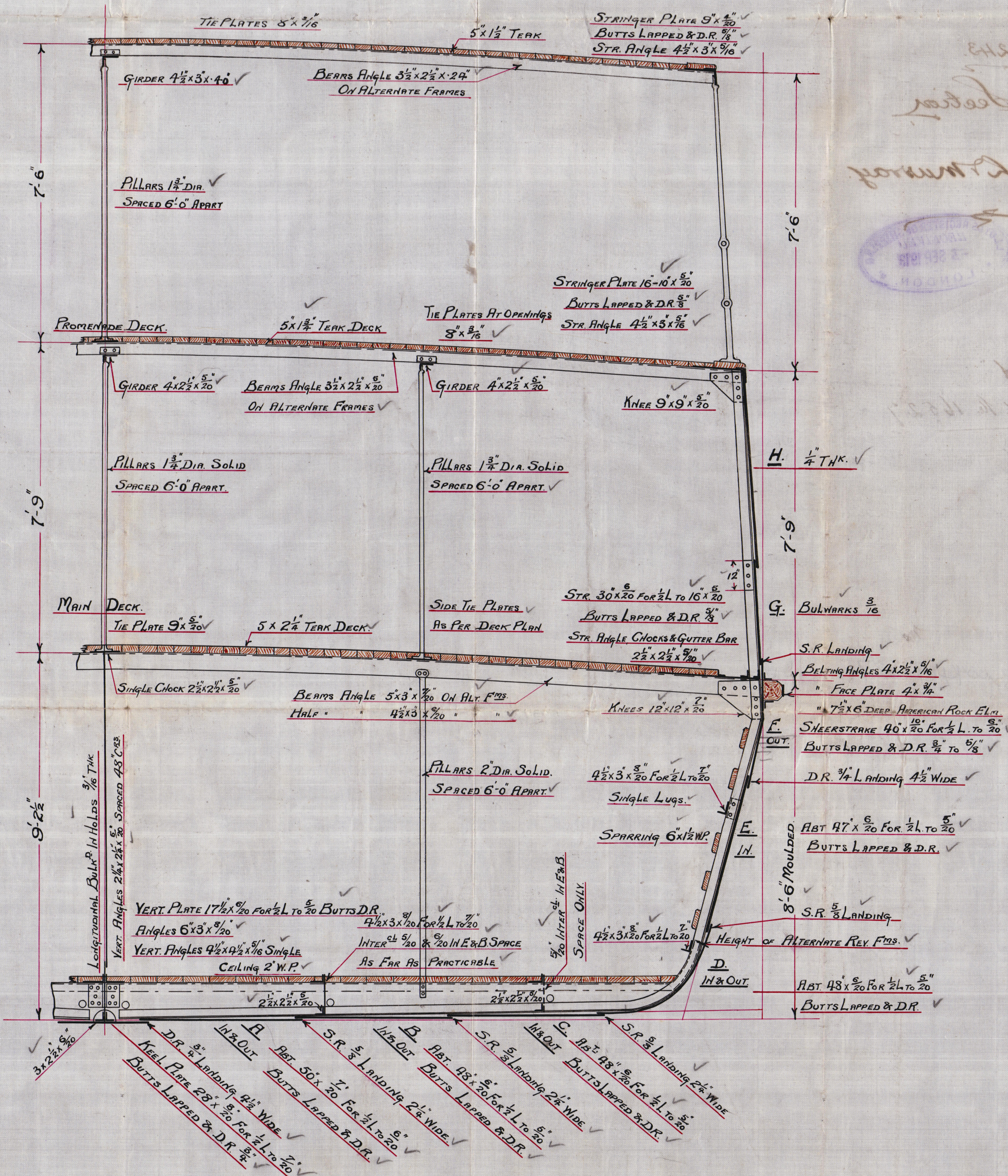

2 1/2" x 1 1/4" Hollow COPES

Jan 10.3.19

S/S. N° 243.

Midship Section

Messrs.

Murdoch & Murray.



S/S. "Ant"

Greenock Report No. 16527



© 2020

Lloyd's Register
Foundation

009418-004270271