

8.9.10



# PONTOON BUCKET DREDGER N° 397

## PROFILE AND DECK PLAN

DIMENSIONS:- 142'-0" x 35'-0" x 12'-0" MOULDED

SCALE:- 1/8" INCH = ONE FOOT

TO CLASS 100A1 DREDGER AT LLOYDS

### SCANTLINGS:-

ENGINE CASING & BOILER CASINGS	TOP PLATING	30"
	SIDE	25"
	BEAMS	4" x 3" x 35 ANGLE
	STIFFENERS	3" x 2 1/2" x 30
	COAMING	32"

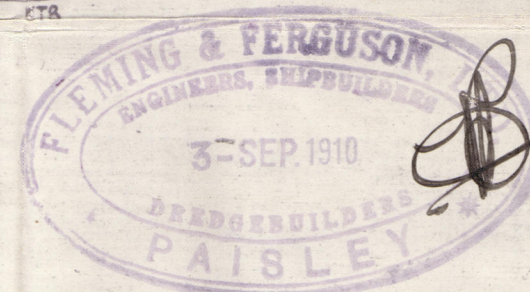
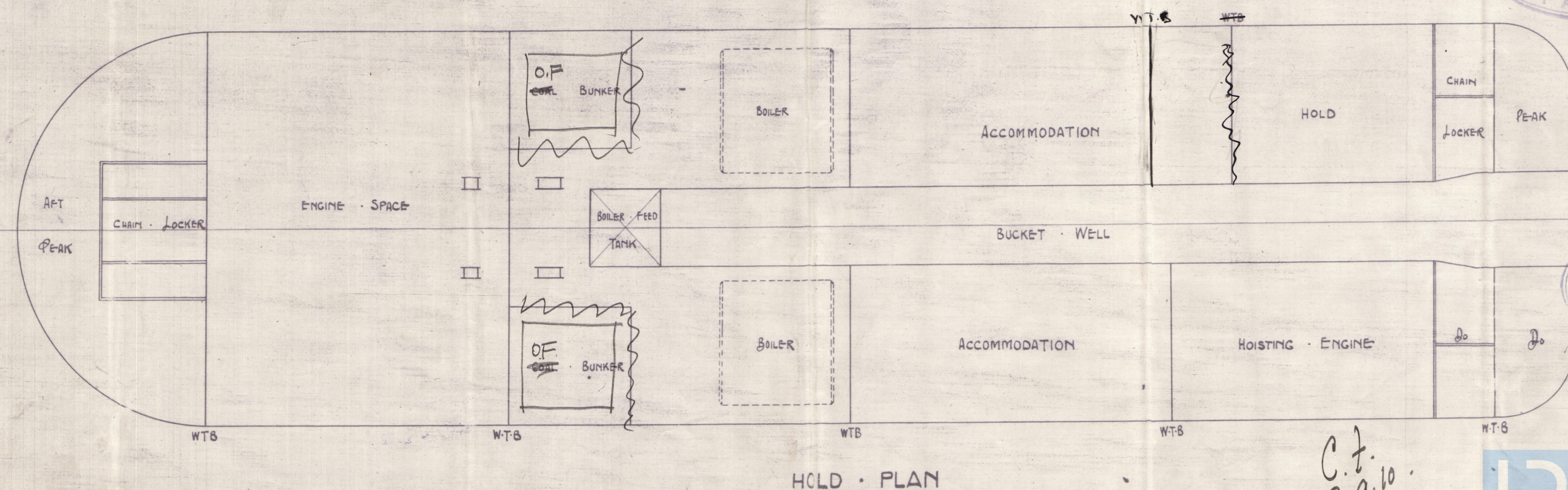
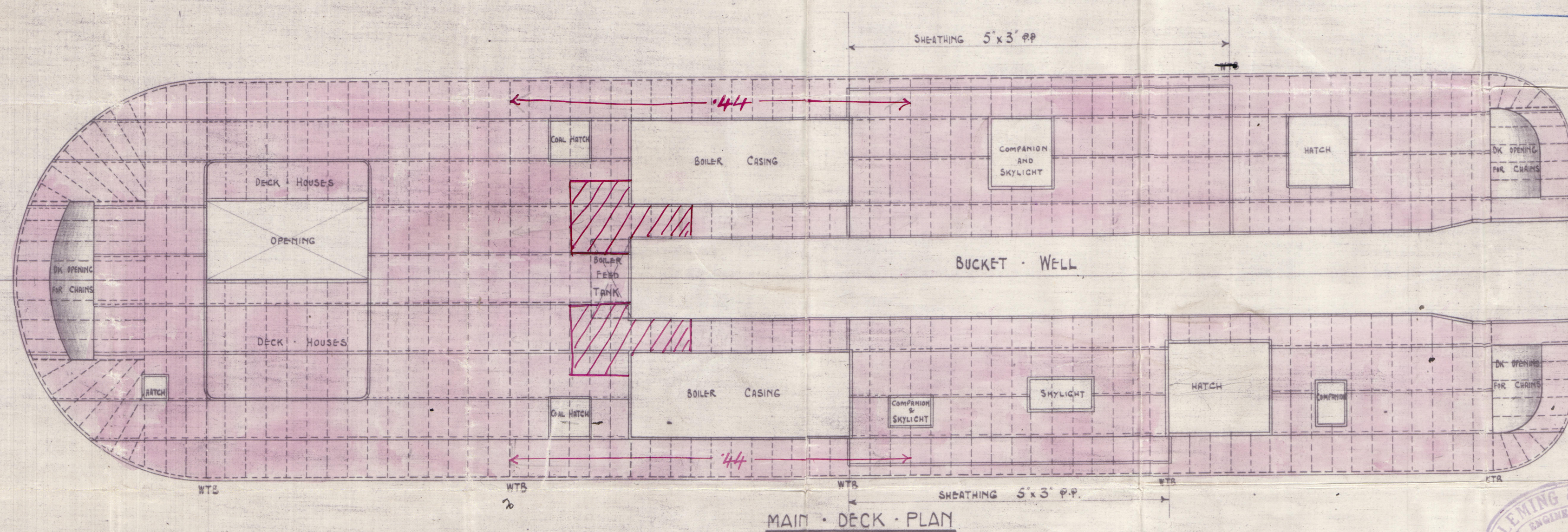
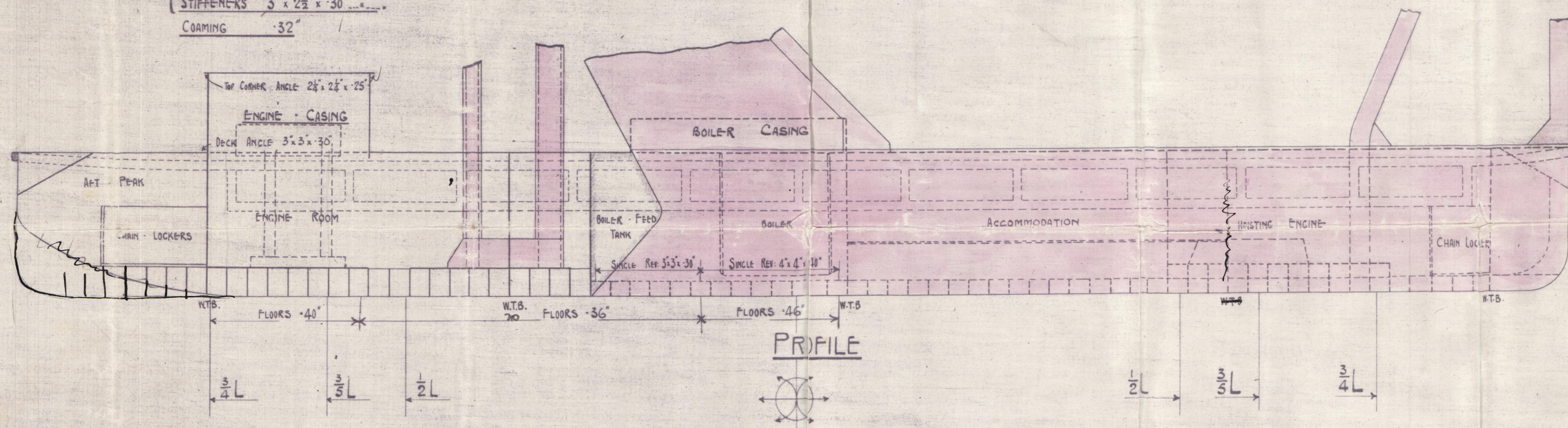

C.T.  
8.9.10



© 2020  
Lloyd's Register  
Foundation

Messrs Fleming & Ferguson & Co  
Profile & Deck Plan  
~~Proposed~~ Bridge

Nº 397

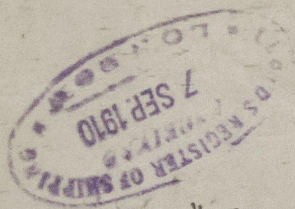

S/S "INDIA"

Glasgow Report Nº 30267



© 2020

Lloyd's Register  
Foundation

009008-009014-0062