

# S. S. N<sup>o</sup> 686. PROFILE.

SCALE  $\frac{1}{8}$ " IN = ONE FOOT.

## Upper Deck

Midship Beams	8" x 3" x $\frac{11}{16}$ "	Bull Angles
Half	8" x 3" x $\frac{10}{16}$ "	
End	$\frac{2}{3}$ L 8" x 3" x $\frac{10}{16}$ "	
Bridge Space Beams	9" x 3" x $\frac{12}{16}$ "	
"	$\frac{1}{2}$ 8" x 3" x $\frac{10}{16}$ "	

Beams marked A 12" x  $\frac{11}{16}$ " Bulls ~~Single Ang 6" x 4" x  $\frac{10}{16}$ "~~  
B.  $\frac{3}{4}$  x  $\frac{1}{2}$  Ang 9" x 3" x  $\frac{12}{16}$ "

## Bridge Deck

Beams - Bull Angs 6" x 3" x  $\frac{9}{16}$ "  
 $\frac{1}{2}$  5" x 3" x  $\frac{8}{16}$ "

## Forecastle Deck

Forecastle Beams Bulls 9" x  $\frac{9}{16}$ " 2 Angs 3" x 3" x  $\frac{7}{16}$ "  
End Beams  $\frac{2}{3}$  L 8" x  $\frac{8}{16}$ " " " 3" x 3" x  $\frac{6}{16}$ "

Deck Plating doubled at corners of all large  
Hatchways & Deck Openings

Alternate Riv Bars to  
Forecastle Deck

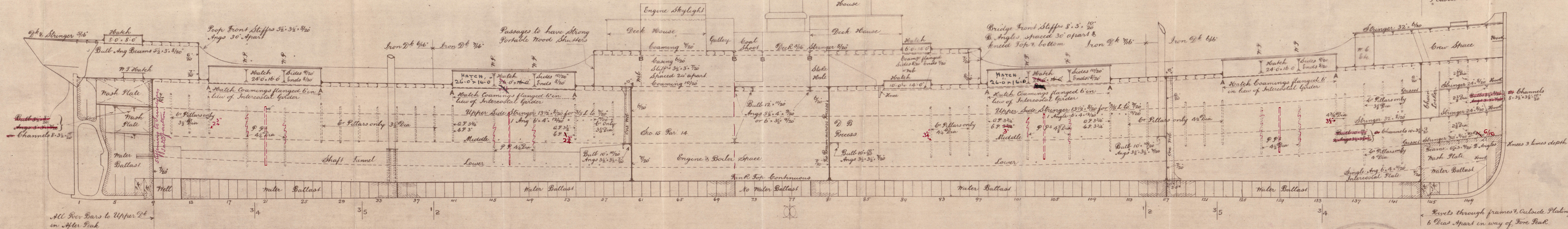

All Riv Bars to Upper D<sup>t</sup>  
in After Peak  
Rivets thro Frames & Outside  
Plating 6 Diags apart.

686



686

© 2021

Lloyd's Register  
Foundation

008855-008862-0236



Profile

W Gray Mould.

No. 686

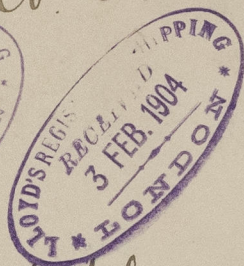

S.S. "Uppland"

Uppl Report No. 12270



© 2021

Lloyd's Register  
Foundation