

LENGTH OVER ALL	335-10 $\frac{1}{2}$ " = 102.375 M
" BETWEEN PP	316-0" = 96.925 M
BREADTH MOULDED	44'-6" = 13.565 M
DEPTH MOULDED TO MAIN DECK	19'-3" = 5.667 M
" " " SHELTER DECK	27'-3" = 8.306 M
DRAFT ON SUMMER FREEBOARD	18'-9 $\frac{1}{2}$ " = 5.725 M
D.W. INCL. BUNKERS 3500 TONS	

ONE NINE CYLINDERS DIESEL MOTOR, SOLID INJECTION	
TWO CYCLE, SINGLE ACTING	3000 I.H.P.
DIAMETER OF CYLINDERS	$1'-7\frac{1}{4}" = 500\text{ mm}$
LENGTH OF STROKE	$2'-11\frac{1}{4}" = 900\text{ mm}$
REVOLUTIONS PER MINUTE	130
DIAMETER OF PROPELLER	$13'-6" = 4115\text{ mm}$
PITCH OF PROPELLER	$11'-6" = 3505\text{ mm}$

	UNDER DECK	GROSS	NET
SWEDISH	1558,57	2070,76	1372,08
ENGLISH	1558,57	2076,34	1059,76

CAPACITIES OF CARGO SPACES			
COMPARTMENT	"GRAIN"		"BALE"
	TO CEILING SHELLPLATING AND DECKPLATING, HATCHWAYS INCL.		TO CEILING, SPARRINGS AND LOWER EDGE OF BEAMS, HATCHWAYS INCL.
#1 HOLD	13915CBFT =	394CBH.	12360CBFT = 350CBH.
#2 LOWER HOLD (REFR.)	11500 " =	326 "	11500 " = 326 "
#2 " TWEENDEK (REFR.)	10700 " =	303 "	10700 " = 303 "
#3 " HOLD (REFR.)	8600 " =	245 "	8600 " = 245 "
#3 " TWEENDEK (REFR.)	10200 " =	289 "	10200 " = 289 "
#4 HOLD	34965 " =	990 "	32490 " = 920 "
#5 "	18896 " =	535 "	17130 " = 485 "
SUM OF HOLDS	108775 "	3080 "	102960 " = 2916 "
SHELTER TWEENDEK FR#68F-128	52350 "	= 1488 "	49160 " = 1392 "
" " " 52-68F	10100 "	= 286 "	9430 " = 267 "
" " " 16-58	32490 "	= 920 "	30785 " = 870 "
TONNAGE OPENING	1500 "	= 37 "	1235 " = 35 "
TOTAL	205815 "	= 5811 "	193550 " = 5480 "

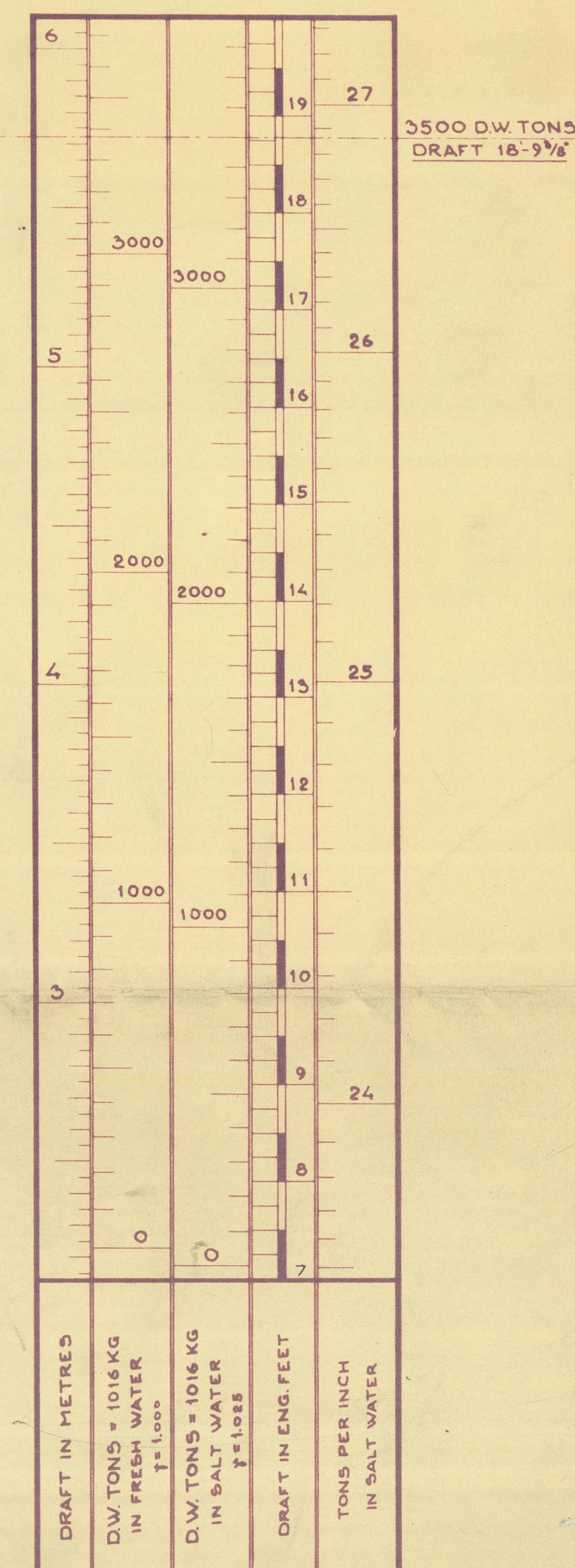
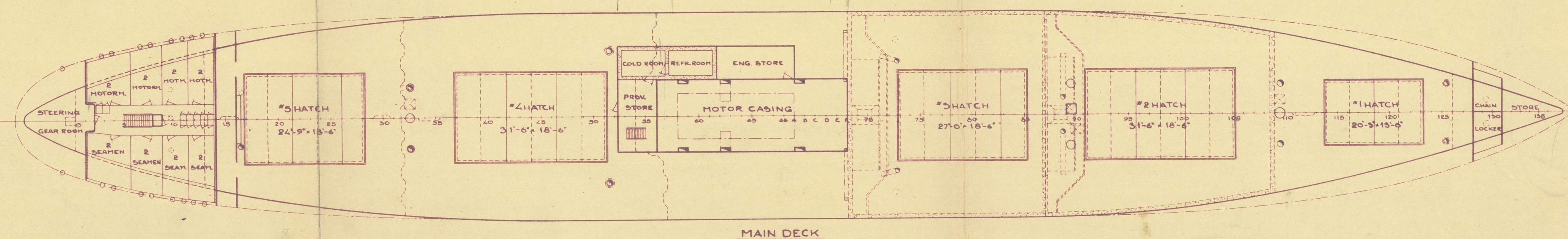
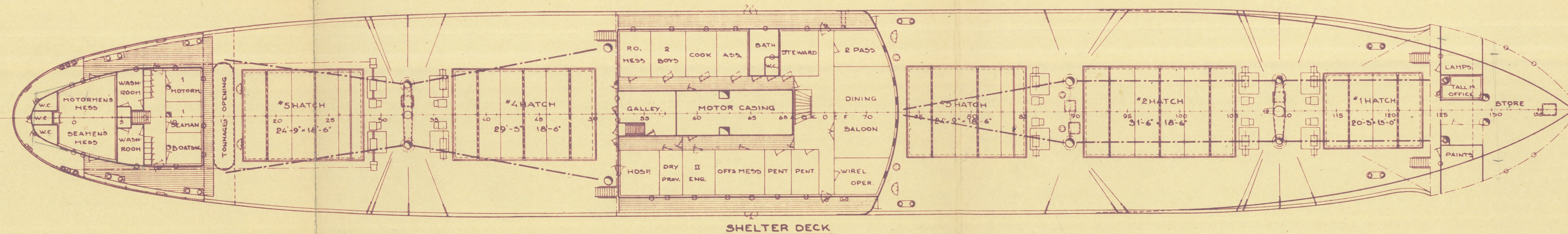
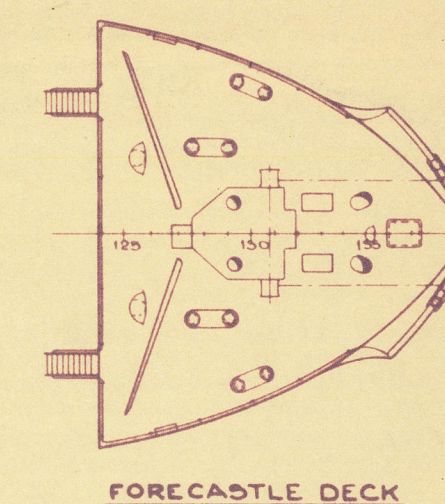
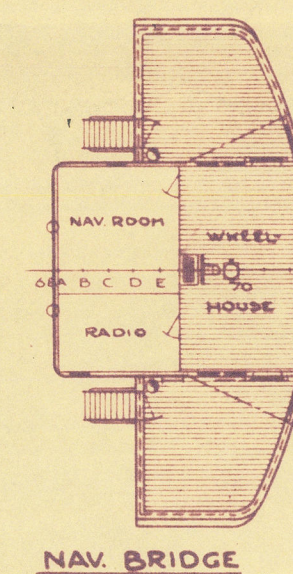
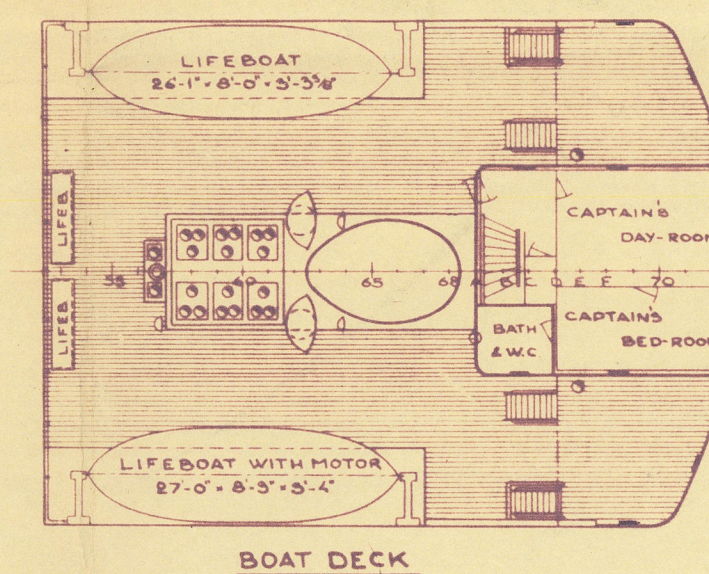
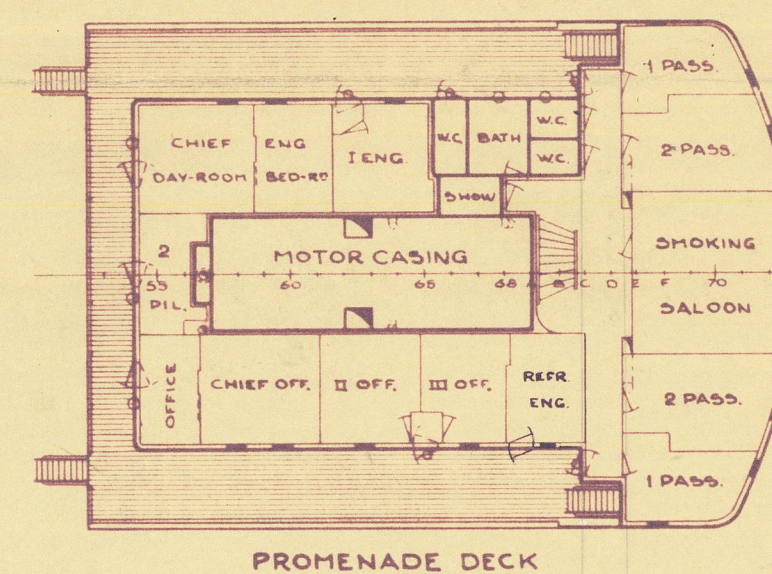
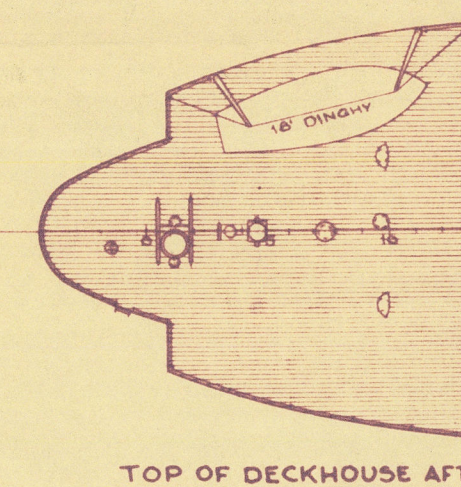

M/S WILHELMINA

YARD № 327

BUILT BY ERIKSBERGS MEK. VERKSTADS A.-B. GÖTEBORG 1944

FOR
REDERIAKTIEBOAGET FREDRIKA

STOCKHOLM SWEDEN

CLASS: LLOYD'S REGISTER + 100A.1 STRENGTHENED FOR NAV. IN ICE

SCALE 1:200

© 2021
Lloyd's Register
DRAWING *327-101

008753-008758-0238