

48 128

Lloyd's

TRAWLER "MULL" OXNA
& "COPINSAY" Tor. rept No. 7884

28 DEC 1946

CONVERSION TO PASSENGER & CARGO VESSEL.

BULKHEADS, GIRDERS, HATCHWAYS...

RE: D2232T/46 DATED 12-10-46 (11259)

SCALE: 1/4 INCH TO ONE FOOT.

PORTSMOUTH YARD
16 DEC 1946
CONSTRUCTION DEPT.

PORTSMOUTH
M.C.D. 023880
30-10-1946
4 SHEETS - SHEET 3.

SHEET 1. GENERAL ARRANGEMENT, FORWARD.

SHEET 2. DETAILS.

SHEET 3. GENERAL ARRANGEMENT, AFT.

SHEET 4. DETAILS.

REDUNDANT STRUCTURE & FITTINGS TO BE REMOVED.

"Copinsay" - Longway Report No. 7884 (7.4.48)

FOR WINDING GEAR SEE Pg M.C.D. 023945.

PROFILE

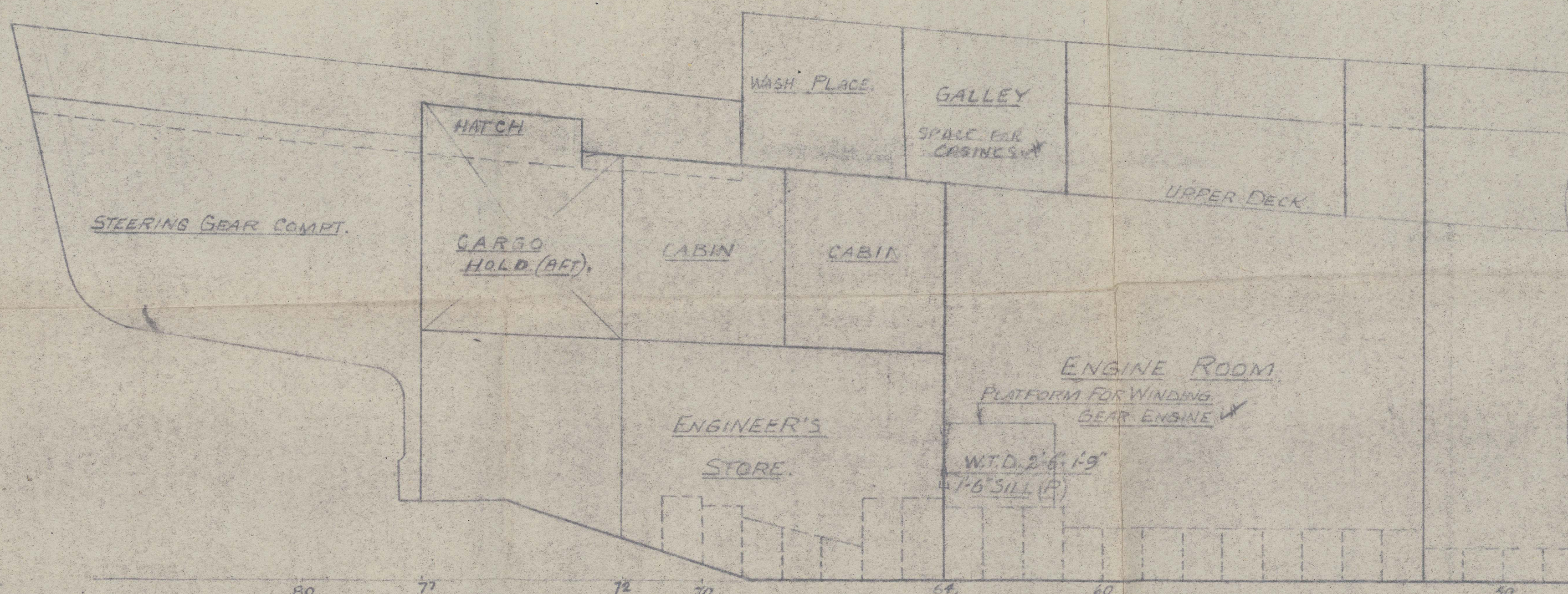

PART PLAN OF UPPER DECK

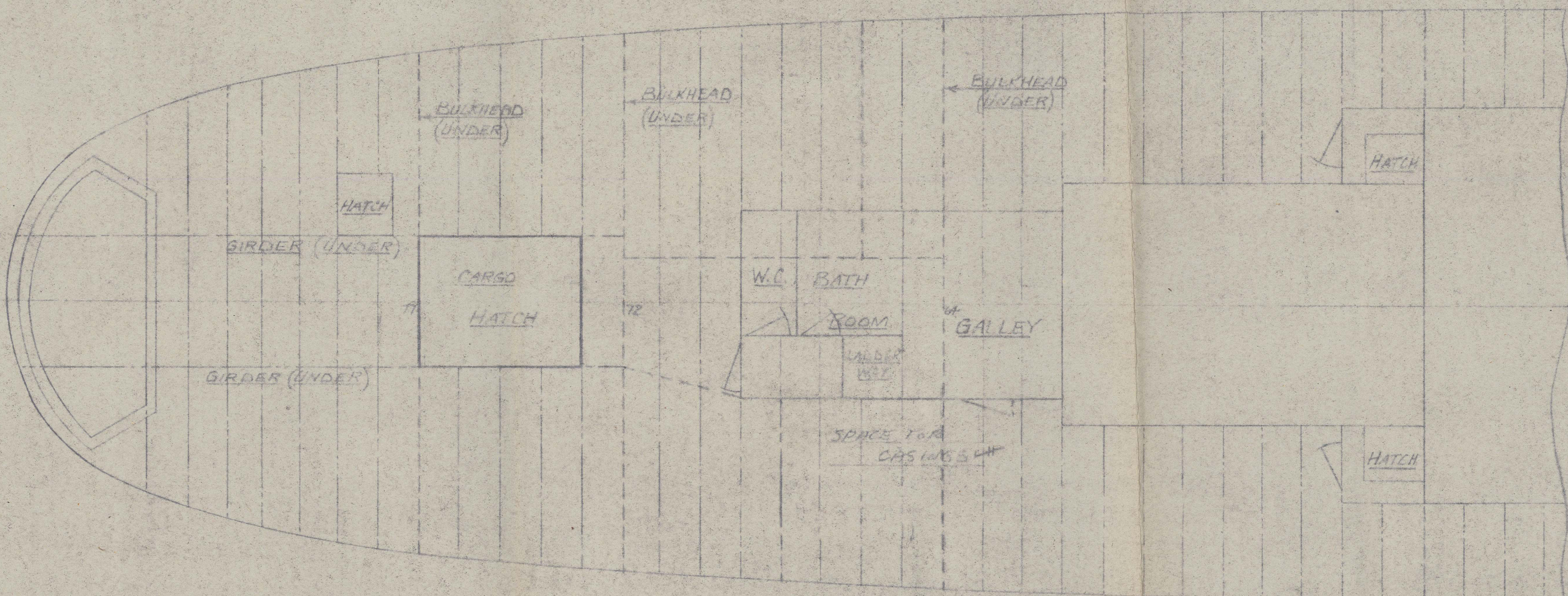

PART PLAN OF HOLD

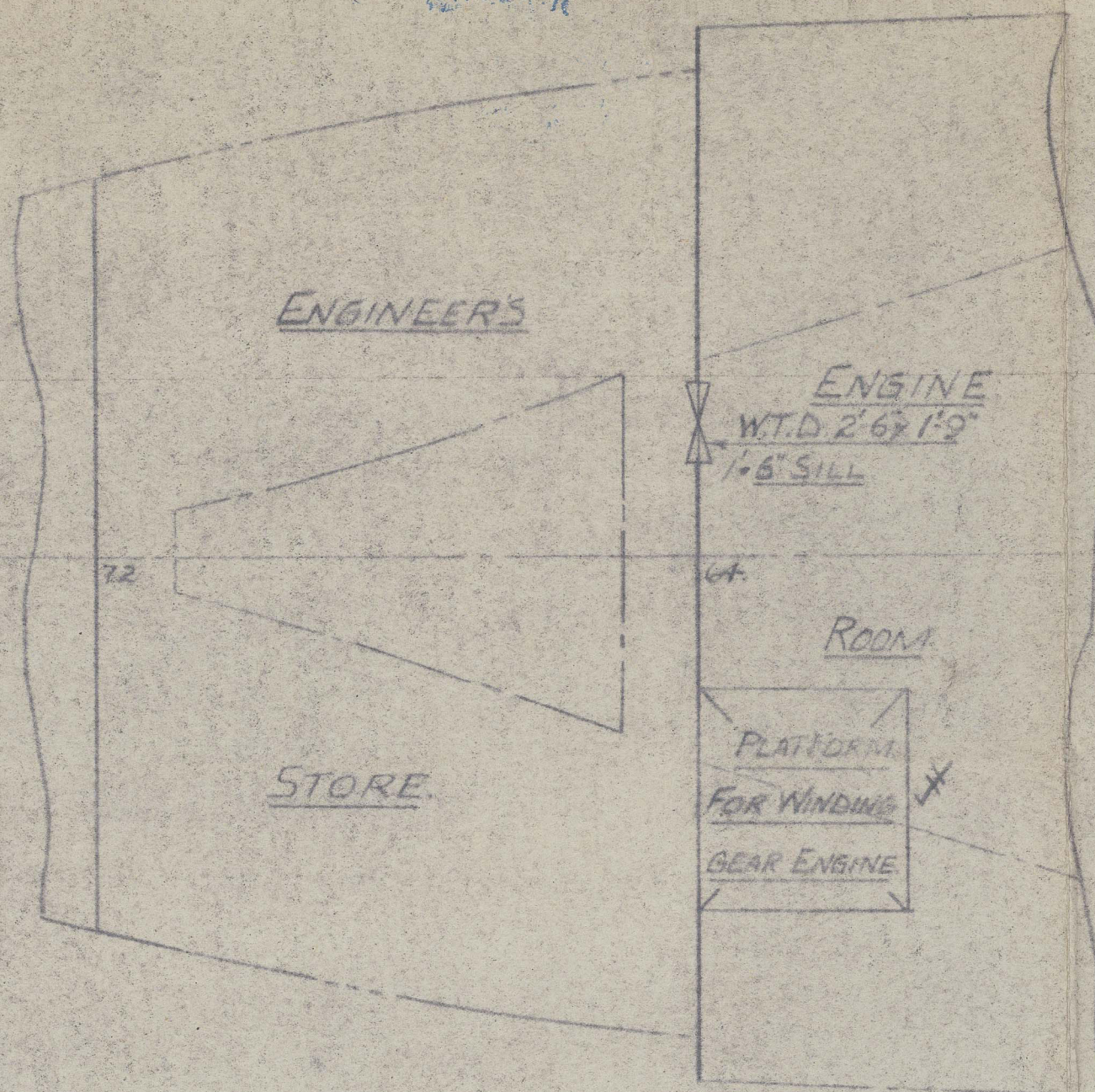

PART PLAN OF LOWER DECK

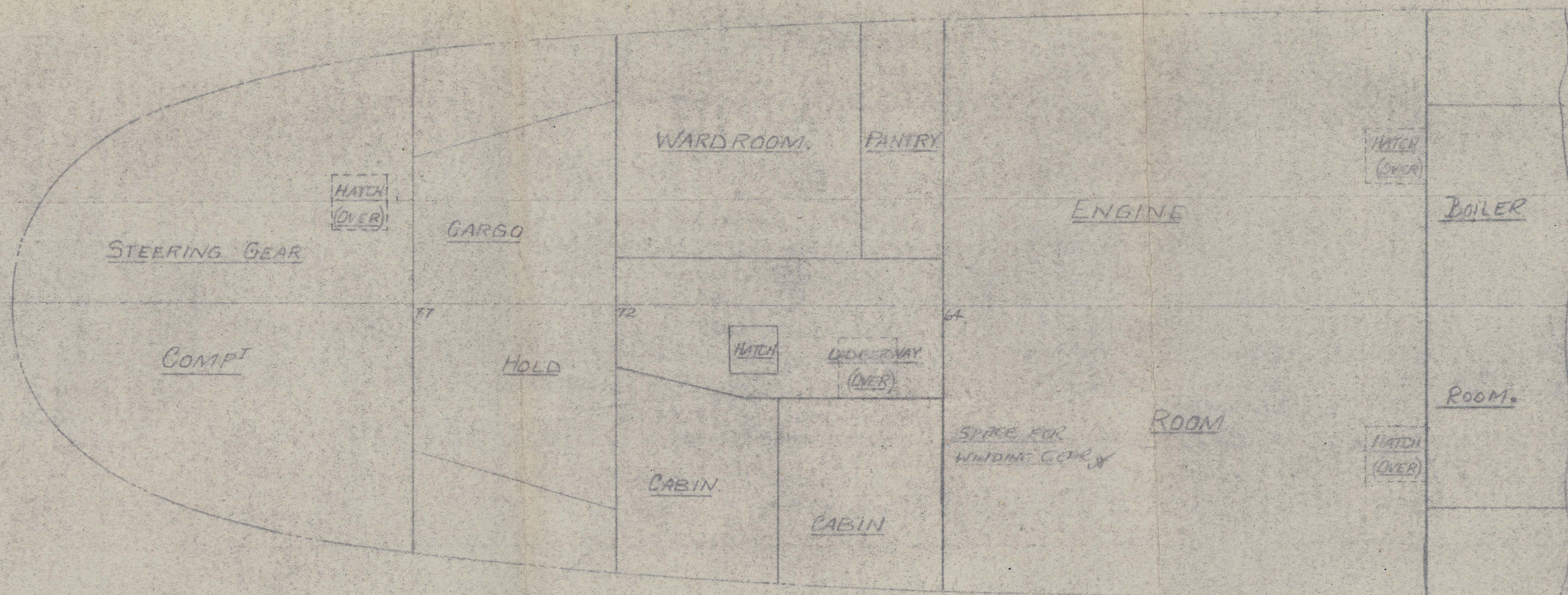

PREPARED BY
TRACED
EXAMINED

28-12-46

