

PARTICULARS OF PROTECTION TO OPENINGS, ETC.

HATCHWAYS ON FREEBOARD AND SUPERSTRUCTURE DECKS

Description of Hatchway
Dimensions of Hatchway	
COAMINGS	Height above Deck	
	Thickness		
	Sides		
	Stiffeners		
HATCH BEAMS	Brackets, Stays	
	Number		
	Spacing		
	Scantling and Sketch		
FORE AND AFTERS	Bearing Surface	
	Number		
	Spacing		
	Unsupported Lengths		
HATCH COVERS	Scantling* and Sketch	
	Bearing Surface		
	Material		
	Thickness		
Spacing of Cleats	
	Number of Tarpaulins	

*Are wood fore and afters steel shod at all bearing surfaces?
 Are battens and wedges efficient and in good condition?
 Are tarpaulins in good condition and in accordance with rule requirements?
 Are lashings provided in accordance with rule requirements?

Particulars of fiddle, funnel and ventilator coamings:—

Particulars of Flush Bunker Scuttles:—

Particulars of Companionways:—

Particulars of Ventilators in exposed positions on freeboard and superstructure decks:—

Particulars of Air Pipes in exposed positions on freeboard, raised quarter, or superstructure decks:—

Particulars of Gangway Cargo and Coaling Ports:—

pt. 9a.
 port of

Kobe.

Continuation of Report No. dated 21/4/36.

on the "MITWO"

S.S. "MITWO", 5492 gross tons, of Bergen.

Continuation of Report C 11, for Ordinary Cargo Load Lines.

Vessel surveyed afloat at Imoshima on the 2nd and 3rd March, 1936 and the following items now placed in order. See Oslo assignment letter dated 10th December, 1935.

- (1) One tarpaulin provided for each of the hatchways in the bridge space.
- (2) Two tarpaulins provided for the hatchways to the chain lockers and fore peak in the open forecastle.
- (3) Intermediate cleats fitted on the coaming of No. 3 hatchway on the freeboard deck.
- (4) Lifelines provided for the use of the crew in all parts of the ship which might have to be used in the regular working thereof.

Y. Jo.

SURVEYOR TO LLOYD'S REGISTER.

Noted
 8/12/36
 6.5.30.



© 2020

Lloyd's Register
 Foundation

0103 2/3

Kobe, 15th April, 1936.

Port of Survey, Innoshima.

Date of Survey, 2nd & 3rd March,
1936.

Name of Surveyor, Y. Jo.

Particulars of Classification.

* 100 A. 1.

Vessel now surveyed for Timber Freeboards in accordance with Secretary's letter of the 17th August, 1932 and telegrams of 27th March, 1936 and the Statutory Rules.

Nos.2 & 4 double bottom tanks have been divided on the middle line, tested and found tight. /

No. 3 was already divided. Additional suction and sounding pipes fitted as required.

The bulwarks, 3'-8" high have been examined and found to be strongly constructed with stays about 6'-0" apart at or about the beams.

Steering is effected by means of a telemotor the connections passing through the tunnel and therefore accessible. ^{Alternative} Alteration steering is provided by suitable leads from guardrant to hand wheels on poop deck.

Eye plates for lashings have been riveted to the sheer strake in the wells and deck sockets fitted on the stringer plates near the eye plates as shown in the plan.

Timber freeboard marks cut in and verified, see verification form herewith.

Position of eye plates and deck sockets.

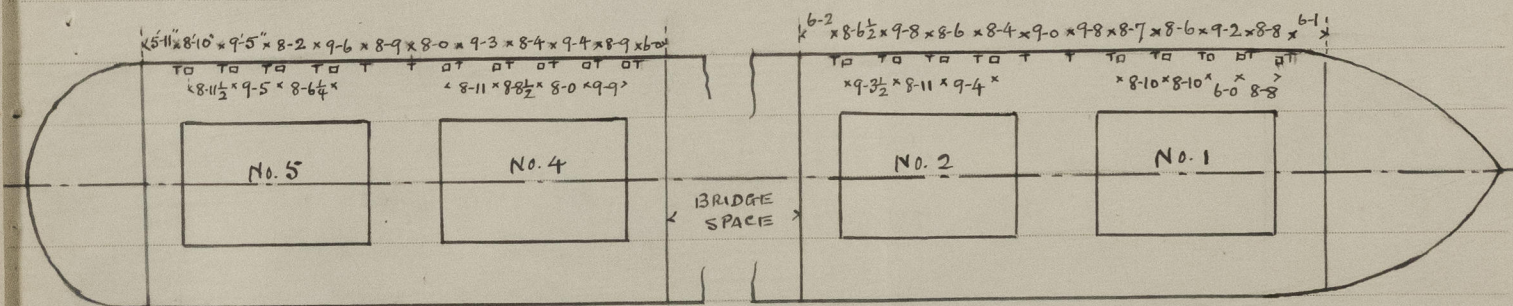

DETAILS OF EYE PLATES AND SOCKETS ETC.

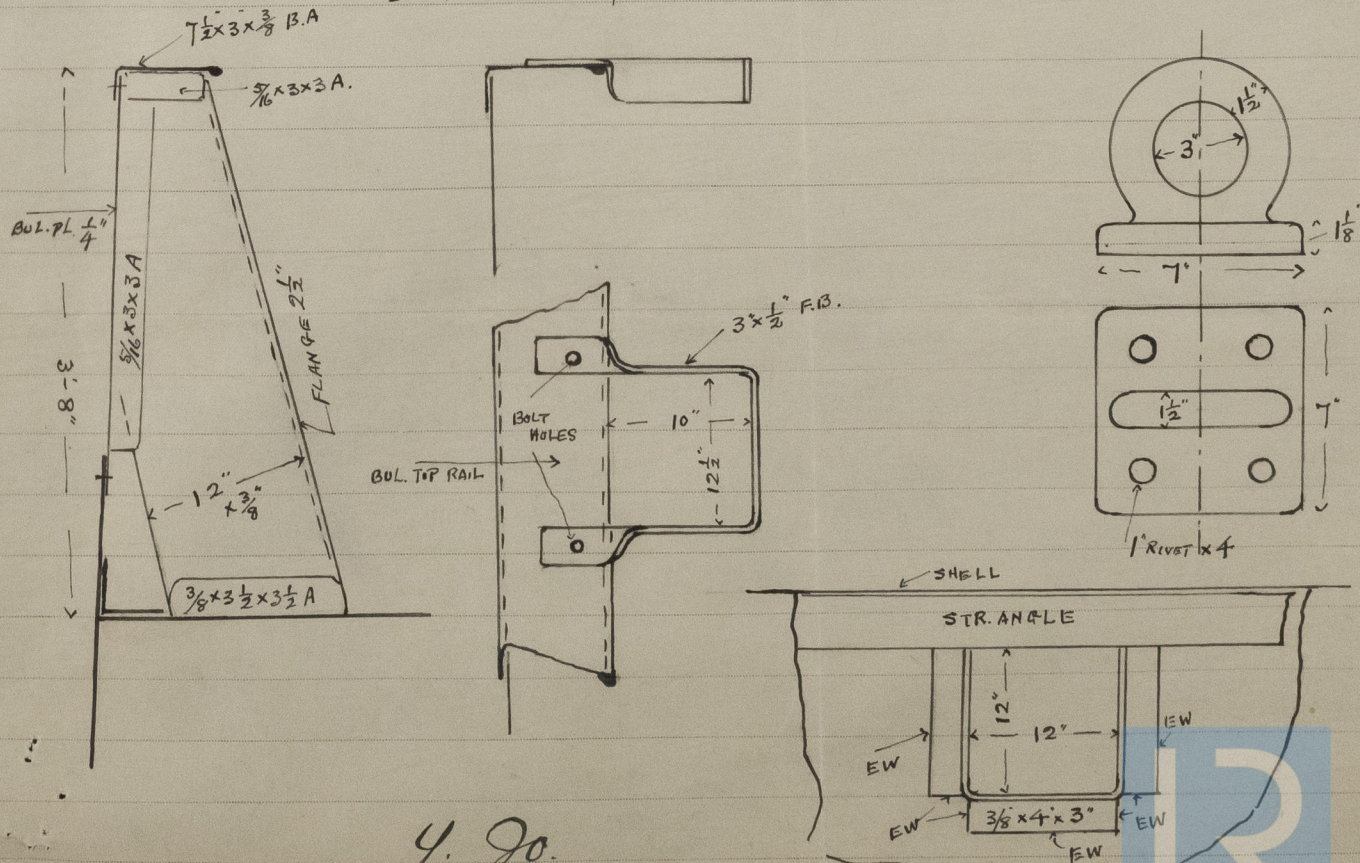

4. 90.

Surveyor to Lloyd's Register
of Shipping, Kobe.