

MITWO

PARTICULARS OF PROTECTION TO OPENINGS, ETC.

HATCHWAYS ON FREEBOARD AND SUPERSTRUCTURE DECKS											
up on deck											
Description of Hatchway	no 1	no 2	no 3	no 4	no 5	no 6	no 7	no 8	no 9	no 10	no 11
Dimensions of Hatchway	32'6" x 26'0"	34'5" x 26'	11'0" x 18'2"	24'8" x 26'0"	30'3" x 26'0"	30'4" x 32"	10'9" x 18'	8'3" x 4'0"	23' x 20'	30' x 30'	29' x 29'
COAMINGS	Height above Deck	30"	30"	10" BA	30"	30"	10" x 1/2" BA	30"	18"	27"	24"
	Thickness	7/16	7/16	7/16	7/16	7/16	7/16	7/16	7/16	7/8	3/8
	Stiffeners	8 1/2" BA	8 1/2" BA	8 1/2" BA	8 1/2" BA	8 1/2" BA	8 1/2" BA	8 1/2" BA	8 1/2" BA	8 1/2" BA	8 1/2" BA
	Brackets, Stays	2	2	2	2	2	2	2	2	2	2
HATCH BEAMS	Number	6	6	6	6	6	6	6	6	6	6
	Spacing	4'7"	4'9"	5'0"	5'0"	5'0"	5'0"	5'0"	5'0"	5'0"	5'0"
	Scantling and Sketch	4 x 3 1/2" angles	4 x 3 1/2" angles	4 x 3 1/2" angles	4 x 3 1/2" angles	4 x 3 1/2" angles	4 x 3 1/2" angles	4 x 3 1/2" angles	4 x 3 1/2" angles	4 x 3 1/2" angles	4 x 3 1/2" angles
	Bearing Surface	3 1/2"	3 1/2"	3 1/2"	3 1/2"	3 1/2"	3 1/2"	3 1/2"	3 1/2"	3 1/2"	3 1/2"
FORE AND AFTERS	Number	3	3	3	3	3	3	3	3	3	3
	Spacing	4'5"	4'5"	4'5"	4'5"	4'5"	4'5"	4'5"	4'5"	4'5"	4'5"
	Unsupp'd Lengths	10'5"	10'5"	10'5"	10'5"	10'5"	10'5"	10'5"	10'5"	10'5"	10'5"
	Scantling and Sketch	3 x 3 x 40 angles	3 x 3 x 40 angles	3 x 3 x 40 angles	3 x 3 x 40 angles	3 x 3 x 40 angles	3 x 3 x 40 angles	3 x 3 x 40 angles	3 x 3 x 40 angles	3 x 3 x 40 angles	3 x 3 x 40 angles
HATCH COVERS	Material	wood	wood	wood	wood	wood	wood	wood	wood	wood	wood
	Thickness	2 3/4"	2 3/4"	2 3/4"	2 3/4"	2 3/4"	2 3/4"	2 3/4"	2 3/4"	2 3/4"	2 3/4"
	How fitted	for raft	for raft	for raft	for raft	for raft	for raft	for raft	for raft	for raft	for raft
	Bearing Surface	2 1/2" x 4"	2 1/2" x 4"	2 1/2" x 4"	2 1/2" x 4"	2 1/2" x 4"	2 1/2" x 4"	2 1/2" x 4"	2 1/2" x 4"	2 1/2" x 4"	2 1/2" x 4"
Spacing of Cleats	22"	22"	22"	22"	22"	22"	22"	22"	22"	22"	22"
Number of Tarpaulins	3	3	3	3	3	3	3	3	3	3	3

Particulars of fiddle, funnel and ventilator coamings:—
Fiddle gratings protected by hinged steel covers permanently attached. Funnel Room skylights of steel strongly constructed.

Particulars of Flush Bunker Scuttles:—

None.

Particulars of Companionways:—

Two steel companionways on poop deck leading to accommodation. Sills 10" high, openings 5' x 2.25'; Doors - 1/2" steel, hinged & operable from both sides.

Particulars of Ventilators in exposed positions on freeboard and superstructure decks:—

Coamings 26" high; Deck top, riveted to deck; all in good condition with wood plugs and canvas covers. Ventilators as follows:—
Forecastle Deck - two 18" dia on 9" dia; forward well six 18" dia; Bridge Deck - two 18" dia; after well - four 18" dia; Poop two 18" dia, four 12" dia & four 10" dia.

Particulars of Air Pipes in exposed positions on freeboard, raised quarter, or superstructure decks:—

Forecastle Deck 3, 6" dia & 22" high; after well 2, 3" dia 36" high
Fore well 1, 6" dia & 6" high (to forecastle) Poop Deck 2, 6" dia 6" high
Bridge Deck 2, 4" dia 32" high; 1, 3" dia 26" high
Wood plug & canvas cover provided.

Particulars of Gangway Cargo and Coaling Ports:—

None.

Particulars of Scuppers and Sanitary Discharge Pipes:—

No discharge below freeboard deck.

Particulars of Side Scuttles:—

No side scuttles below freeboard deck. Side scuttles to Poop, Bridge & Forecastle efficiently constructed & fitted with hinged deadlights.

Particulars of Guard Rails:—

Guard rails on forecastle 39" high & on poop 43" high supported by Manchions about 5' apart. In other exposed places bulwarks are fitted.

Particulars of Gangways, Lifelines, etc.:—

None.

The crew are berthed in poop and on the bridge.
Lifeline

Particulars of Freeing Arrangements.

	Length of Bulwark	Height of Bulwark	Size of Freeing Ports	Number each side	Area each side	Rule area each side
After Well	99.7'	3.6'	4.0' x 1.3'	4	20.8 ft ²	19.94
Forward Well	100.0'	3.6'	4.0' x 1.3'	4	20.8 ft ²	20.00

State position of each freeing port:—
(F. and A. position and height above deck edge) { After Well: from Bridge 11.9' → 19.6' → 19.5' → 20.0' → aft.
Forward Well: from Bridge 11.1' → 20.8' → 19.8' → 20.1' → fwd.
State whether the freeing ports are fitted with shutters, bars, or rails, and give particulars of such:— Two horizontal rails; no shutters.
Additional area where sheer is less than standard.

Particulars of Superstructures, Trunks, Casings, Deckhouses.

	Coaming	Plating	Stiffeners	Spacing	End Attachments of Stiffeners	Size of Openings	Height of Sills	Height of Casings
Poop Bulkhead	7/16"	7/16"	6 x 3 1/2 x 3/8 L	32	-	5.0' x 2.0'	18"	7.9'
Raised Quarter Deck Bulkhead								
Bridge, After Bulkhead	7/16"	3/8"	4 x 3 1/2 x 3/8 L	30	-	5.0' x 3.3'	18"	7.9'
Bridge, Forward Bulkhead	1/2"	7/16"	9 x 3 1/2 x 3/8 BA	33	Bracketed to b.	5.0' x 3.5'	18"	7.9'
Forecastle Bulkhead								
Trunk, Aft								
Trunk, Forward								
Exposed Machinery Casings on Freeboard or Raised Quarter Decks								
Exposed Machinery Casings on Superstructure Decks	7/16"	3/8"	3 1/2 x 3 1/2 x 3/8 L	28"	Bkt. at top	5' x 2'	18"	7.5'
Machinery Casings within Superstructures not fitted with Class I Closing Appliances	7/16"	3/8"	3 1/2 x 3 1/2 x 3/8 L	28"	ditto	5' x 2'	18"	7.9'
Deckhouses on Flush Deck Ships								

Particulars of Closing Appliances (state if capable of being manipulated from both sides).

Poop Bulkhead	Two hinged steel doors, Class I, manipulated outside only.
Raised Quarter Deck Bulkhead	
Bridge, After Bulkhead	Two steel plate covers, Class II, attached by hooked bolts from outside.
Bridge, Forward Bulkhead	Two hinged steel doors, Class I, manipulated outside only.
Forecastle Bulkhead	Open (see sketch over page)
Exposed Machinery Casings on Freeboard or Raised Quarter Decks	
Exposed Machinery Casings on Superstructure Decks	Two steel doors to stowhold & one door to Eng. Rm. operable both sides.
Machinery Casings within Superstructures not fitted with Class I Closing Appliances	Two steel doors to Eng. Room operable outside.
Deckhouses on Flush Deck Ships	

Superstructure bulkheads, trunks, deckhouses, casings, cargo and coaling hatchways, extent and thickness of sheathing on the freeboard deck, gangway, cargo and coaling ports, and any other openings, etc., which would affect the seaworthiness of the ship are to be shown on the following sketches:—

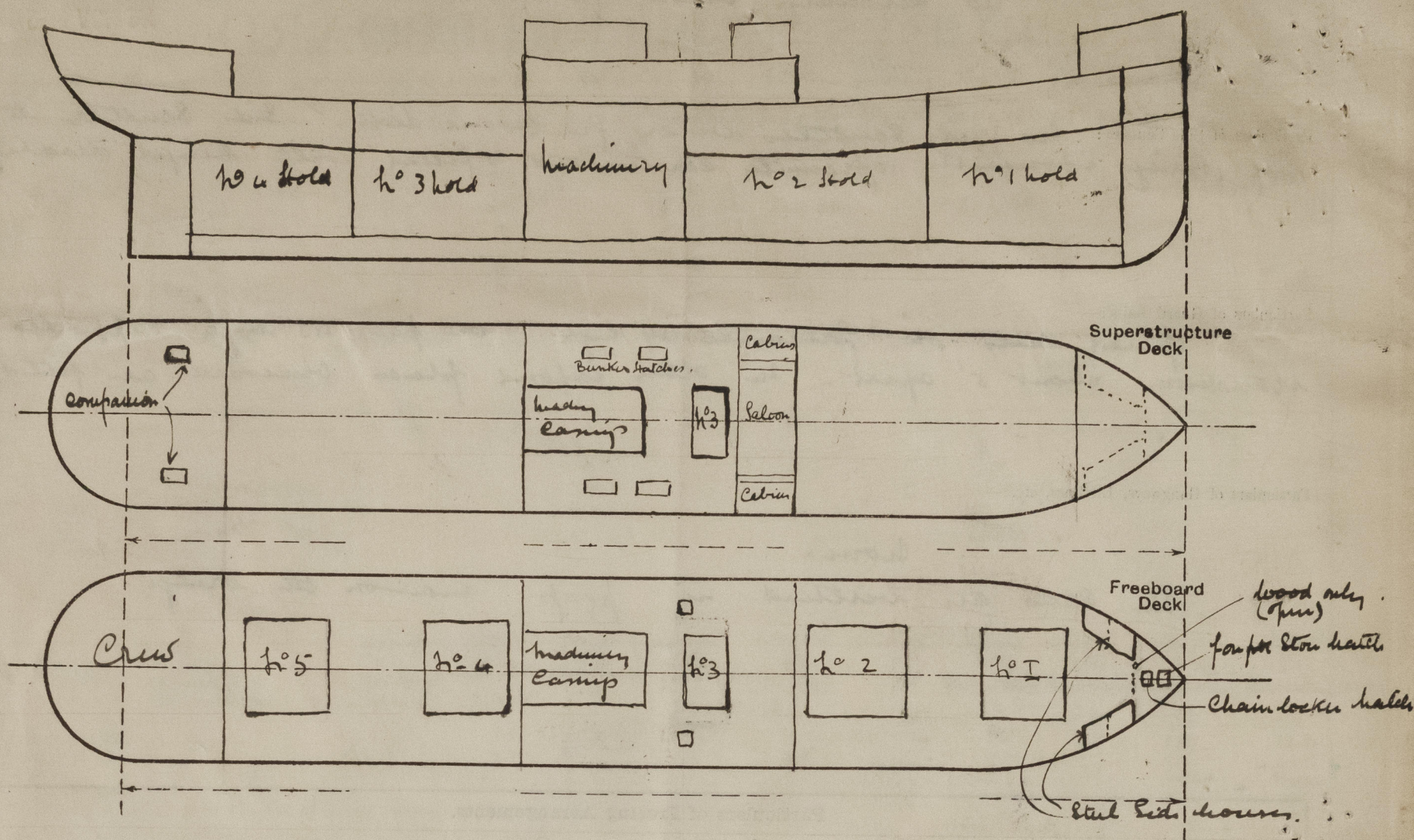

State any special features in the construction of the ship:—

The vessel has been surveyed in dry dock. Bottom & rudder cleaned & examined & found in good condition and recoated. Part of hold, twin decks and bunkers examined and found in good condition. Decks, hatches, coamings, casings, closing appliances, ventilators and general equipment examined and found in good condition.

note Special Survey No 3 was held on this vessel in Nov 1933.

The present certificate was examined & the following particulars noted:—
"CANADIAN PROSPECTOR" Official No 141729, Montreal, Quebec.

Gross Tons 5492.

Freeboard from Deck
Tropical 5' - 5 1/4"
Summer 5' - 11 1/2"
Winter 6 - 5 3/4"

Load line
6 1/2" above summer } Allowance for fresh water
— } for all freeboards 6 3/4"
6 1/2" below summer

Upper edge of deck line from which other freeboards are measured nil inches above top of steel upper deck at side.

This certificate remains in force until 15th April 1937. Issued at Ottawa on 26th Day of May 1933

Bridge & on end Class I closing appliance, 2 w.t. steel hinged doors
Bridge after end Class II " 2 Portable steel plates
Pop. Class I " 2 w.t. steel hinged doors.

Builder's name and yard number

Names of sister ships

Owners

Fee £ 24 : 0 : 0

Received by me



© 2020

Lloyd's Register Foundation