

SURVEYS FOR FREEBOARD.

Particulars of Classification **4-100A1**

Coefficient of fineness for use with Tables

Depth for Freeboard (D) =

If restricted by superstructures

$$\text{Correction} = \frac{\text{Diff}^e}{4} \times \left(1 - \frac{S_1}{L}\right) =$$

Deduction =

" " aft of " =

If limited on account of midship superstructure

If limited to maximum allowance of $1\frac{1}{2}$ ins. per 100 ft.

Addition for Winter North Atlantic Freeboard (if required) =

$$\text{Deduction} = \frac{\Delta}{40 T} \text{ inches}$$

Other corrections, scantlings, etc.

Summer Freeboard =

~~Water North Atlantic~~ 32

10m,2,31

MARKING FORM

Foundatio

111111

1970

PARTICULARS OF PROTECTION TO OPENINGS, ETC.

HATCHWAYS ON FREEBOARD AND SUPERSTRUCTURE DECKS									
Description of Hatchway	No 1	No 2	No 2A	No 3	No 4	No 2A	Superstructure	Coaling Hatch	on Superstructure
Dimensions of Hatchway	26' 6" x 23' 0"	20' 0" x 10' 2" x 15'	10' 2" x 15'	20' 0" x 10' 2" x 15'	20' 0" x 10' 2" x 15'	10' 2" x 15'	10' 2" x 15'	5' 8" x 18"	5' 8" x 18"
COAMINGS	Height above Deck ... 2' 7 1/2"	9' 3" x 8' 4"	9' 3" x 8' 4"	9' 3" x 8' 4"	9' 3" x 8' 4"	9' 3" x 8' 4"	9' 3" x 8' 4"	5' 8" x 18"	5' 8" x 18"
COAMINGS	Thickness ... 13/16"	13/16"	13/16"	13/16"	13/16"	13/16"	13/16"	13/16"	13/16"
COAMINGS	Sides ... 13/16"	13/16"	13/16"	13/16"	13/16"	13/16"	13/16"	13/16"	13/16"
COAMINGS	Ends ... 13/16"	13/16"	13/16"	13/16"	13/16"	13/16"	13/16"	13/16"	13/16"
COAMINGS	Stiffeners ... 2" x 3" x 10'	2" x 3" x 10'	2" x 3" x 10'	2" x 3" x 10'	2" x 3" x 10'	2" x 3" x 10'	2" x 3" x 10'	2" x 3" x 10'	2" x 3" x 10'
COAMINGS	Brackets, Stays ... 2" x 3" x 10'	2" x 3" x 10'	2" x 3" x 10'	2" x 3" x 10'	2" x 3" x 10'	2" x 3" x 10'	2" x 3" x 10'	2" x 3" x 10'	2" x 3" x 10'
HATCH BEAMS	Number ... 4	1 in Centre	1 in Centre	1 in Centre	1 in Centre	1 in Centre	1 in Centre	1 in Centre	1 in Centre
HATCH BEAMS	Spacing ... 5' 4"	at ends 10'	at ends 10'	at ends 10'	at ends 10'	at ends 10'	at ends 10'	at ends 10'	at ends 10'
HATCH BEAMS	Scantling and Sketch	3 1/2"	3 1/2"	3 1/2"	3 1/2"	3 1/2"	3 1/2"	3 1/2"	3 1/2"
Bearing Surface	3 1/2"	in Centre	in Centre	in Centre	in Centre	in Centre	in Centre	in Centre	in Centre
FORE AND AFTERS	Number ... 2	3 x 4	3 x 4	3 x 4	3 x 4	3 x 4	3 x 4	3 x 4	3 x 4
FORE AND AFTERS	Spacing ... 3' 9" x 2'	3' 9" x 2'	3' 9" x 2'	3' 9" x 2'	3' 9" x 2'	3' 9" x 2'	3' 9" x 2'	3' 9" x 2'	3' 9" x 2'
FORE AND AFTERS	Unsupported Lengths	3' 9" x 2'	3' 9" x 2'	3' 9" x 2'	3' 9" x 2'	3' 9" x 2'	3' 9" x 2'	3' 9" x 2'	3' 9" x 2'
FORE AND AFTERS	Scantling and Sketch	3' 9" x 2'	3' 9" x 2'	3' 9" x 2'	3' 9" x 2'	3' 9" x 2'	3' 9" x 2'	3' 9" x 2'	3' 9" x 2'
Bearing Surface	3 1/2"	3 1/2"	3 1/2"	3 1/2"	3 1/2"	3 1/2"	3 1/2"	3 1/2"	3 1/2"
HATCH COVERS	Material ... 2"	2"	2"	2"	2"	2"	2"	2"	2"
HATCH COVERS	Thickness ... 2"	2"	2"	2"	2"	2"	2"	2"	2"
HATCH COVERS	How fitted ... 2"	2"	2"	2"	2"	2"	2"	2"	2"
HATCH COVERS	Bearing Surface ... 2"	2"	2"	2"	2"	2"	2"	2"	2"
Spacing of Cleats	2' 1" x 2' 4"	2' 1" x 2' 4"	2' 1" x 2' 4"	2' 1" x 2' 4"	2' 1" x 2' 4"	2' 1" x 2' 4"	2' 1" x 2' 4"	2' 1" x 2' 4"	2' 1" x 2' 4"
Number of Tarpaulins	3	3	3	3	3	3	3	3	3

Particulars of fiddle, funnel and ventilator coamings:—
 Fiddle gratings 4' 6" above superstructure deck.
 are fitted with ringed plates. Coamings 4' 6" x 3' 9" x 2' 1" height of superstructure.
 Small gratings 7' x 1' 5" on each side of funnel casing each covered with 1/8" plate. Coamings 4' 6" x 3' 9" x 2' 1" height of superstructure.
 fitted with inside bracing 3' 9" x 2' 1" x 1/8" angle stiffeners.

Particulars of Flush Bunker Scuttles:—
 Nil. one small hatch 29" x 24 1/2" leading to main deck.
 Cooper slight of Coaming 15' 1/2" thickness 4' 6" and fitted
 with locking hatch & Coamings. Two small skylights to
 port accommodation 30' 6" x 4' 6" x 3' 6" height 22' Coamings
 of 3/16" plate & fitted with ringed plates & glass plates.
 & hatch hatch from aft end of funnel 2' 9" x 2' 4" Coamings
 15' 1/2" high 1/8" plate & fitted with fitted Coamings.
 1 only Companion way on port.

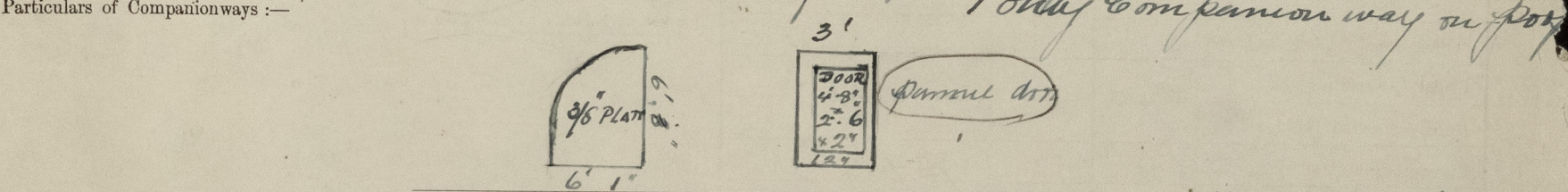

Particulars of Ventilators in exposed positions on freeboard and superstructure decks:—
 of one vent. to No 1 hold 28" (to Quarters are in height 18" Coaming)
 on freeboard deck 4' 6" x 3' 9" x 2' 1" height 18" Coaming
 with Coamings 3' 1" above the deck on superstructure deck 2' 1" x 15" vent with 30" Coaming
 to quarters trunk 2' 9" vent with 20" Coaming to freeboard deck 2' 1" x 15" vent with 30" Coaming
 with 16" Coaming to Quarters one freeboard deck 2' 1" x 15" vent with 30" Coaming
 to No 2 hold 16" vent with 18" Coaming to Quarters one 6' 2" x 2' 4" Coamings
 to No 2 hold 16" Coamings to Quarters one 12" vent with 30" Coaming to Quarters one 6' 2" x 2' 4" Coamings
 Particulars of Air Pipes in exposed positions on freeboard, raised quarter, or superstructure decks:—
 on fore-castle 1 Bonnet air pipe to fore-castle tank & one to No 1 tank hatch
 13' to bottom of neck freeboard deck 4' 6" x 3' 9" x 2' 1" Small air pipe close to fore-castle
 B.H. 6' above deck leading to No 1 tank. One air pipe on each side under fore-castle
 to No 2 tank 3' 4" above deck on superstructure deck 2 air pipes to No 3. 3' 4" above
 the deck on freeboard deck 2 air pipes 3' 5" above deck. On port 1 air vent
 to all peak tank 13' above deck. Spongy air wooden plugs & Coamings in position.

Particulars of Gangway Cargo and Coaling Ports:—
 Nil.

Particulars of Scuppers and Sanitary Discharge Pipes —

None below freeboard deck.
 Scuppers in Superstructure 10' dia. fitted with
 ringed deadlight permanently attached to scupper.
 Particulars of Side Scuttles:—
 None below freeboard deck.
 Scuppers 2 each side of deck 4' x 2 1/2".
 3 Scuttles each side of deck 4' x 2 1/2".

Particulars of Guard Rails:—
 3' above ship deck on fore-castle & poop
 timbers 1 1/2" dia spaced 5' 2" apart.

Particulars of Gangways, Lifelines, etc.:—
 None!
 Provision made for rigging lifelines as
 required by rule.

Particulars of Freeing Arrangements.						
	Length of Bulwark	Height of Bulwark	Size of Freeing Ports	Number each side	Area each side	Rule area each side
After Well	85' 6"	3' 8 1/2"	3' x 1' 6"	4	18 sq ft	17.1 sq ft
Forward Well	86' -	3' 8 1/2"	3' x 1' 6"	4	18 sq ft	17.2 sq ft

State position of each freeing port (F. and A. position and height above deck edge) After Well:—
 Forward Well:—
 State whether the freeing ports are fitted with shutters, bars, or rails, and give particulars of such:—
 Additional area where sheer is less than standard.

Particulars of Superstructures, Trunks, Casings, Deckhouses.								
	Coaming	Plating	Stiffeners	Spacing	End Attachments of Stiffeners	Size of Openings	Height of Sills	Height of Casings
Poop Bulkhead	24" x 7/16"	3/8" x 6" x 3/4" x 7/16"	28" to 36"	None	None	None	7' 6"	7' 6"
Raised Quarter Deck Bulkhead	1/16" x 3/16"	5/16" x 3" x 3/4" x 1/4"	36"	None	None	2 doors 5' 3" x 1' 9" dm	7' 6"	7' 6"
Bridge, After Bulkhead	24" x 7/16"	3/8" x 6" x 3/4" x 7/16"	29"	None	None	2 doors 5' 3" x 1' 9" dm	7' 6"	7' 6"
Bridge, Forward Bulkhead	24" x 7/16"	3/8" x 6" x 3/4" x 7/16"	29"	None	None	2 doors 5' 3" x 1' 9" dm	7' 6"	7' 6"
Fore-castle Bulkhead	24" x 7/16"	3/8" x 6" x 3/4" x 7/16"	31"	None	None	2 doors 5' 3" x 1' 9" dm	7' 6"	7' 6"
Trunk, Aft	24" x 7/16"	3/8" x 6" x 3/4" x 7/16"	31"	None	None	2 doors 5' 3" x 1' 9" dm	7' 6"	7' 6"
Trunk, Forward	24" x 7/16"	3/8" x 6" x 3/4" x 7/16"	31"	None	None	2 doors 5' 3" x 1' 9" dm	7' 6"	7' 6"
Exposed Machinery Casings on Freeboard or Raised Quarter Decks								
Exposed Machinery Casings on Superstructure Decks								
Machinery Casings within Superstructures not fitted with Class I Closing Appliances								
Deckhouses on Flush Deck Ships								

Particulars of Closing Appliances (state if capable of being manipulated from both sides).	
Poop Bulkhead	None no openings.
Raised Quarter Deck Bulkhead	None no openings.
Bridge, After Bulkhead	Two openings closed by clip brails from both sides.
Bridge, Forward Bulkhead	Two clip doors fitted from outside.
Fore-castle Bulkhead	Three doors opening from both sides (2 clip doors).
Exposed Machinery Casings on Freeboard or Raised Quarter Decks	Ship doors protected by bridge bulkheads.
Exposed Machinery Casings on Superstructure Decks	Two clip doors to fore-castle & two to engine room.
Machinery Casings within Superstructures not fitted with Class I Closing Appliances	
Deckhouses on Flush Deck Ships	

Superstructure bulkheads, trunks, deckhouses, casings, cargo and coaling hatchways, extent and thickness of sheathing on the freeboard deck, gangway, cargo and coaling ports, and any other openings, etc., which would affect the seaworthiness of the ship are to be shewn on the following sketches:—

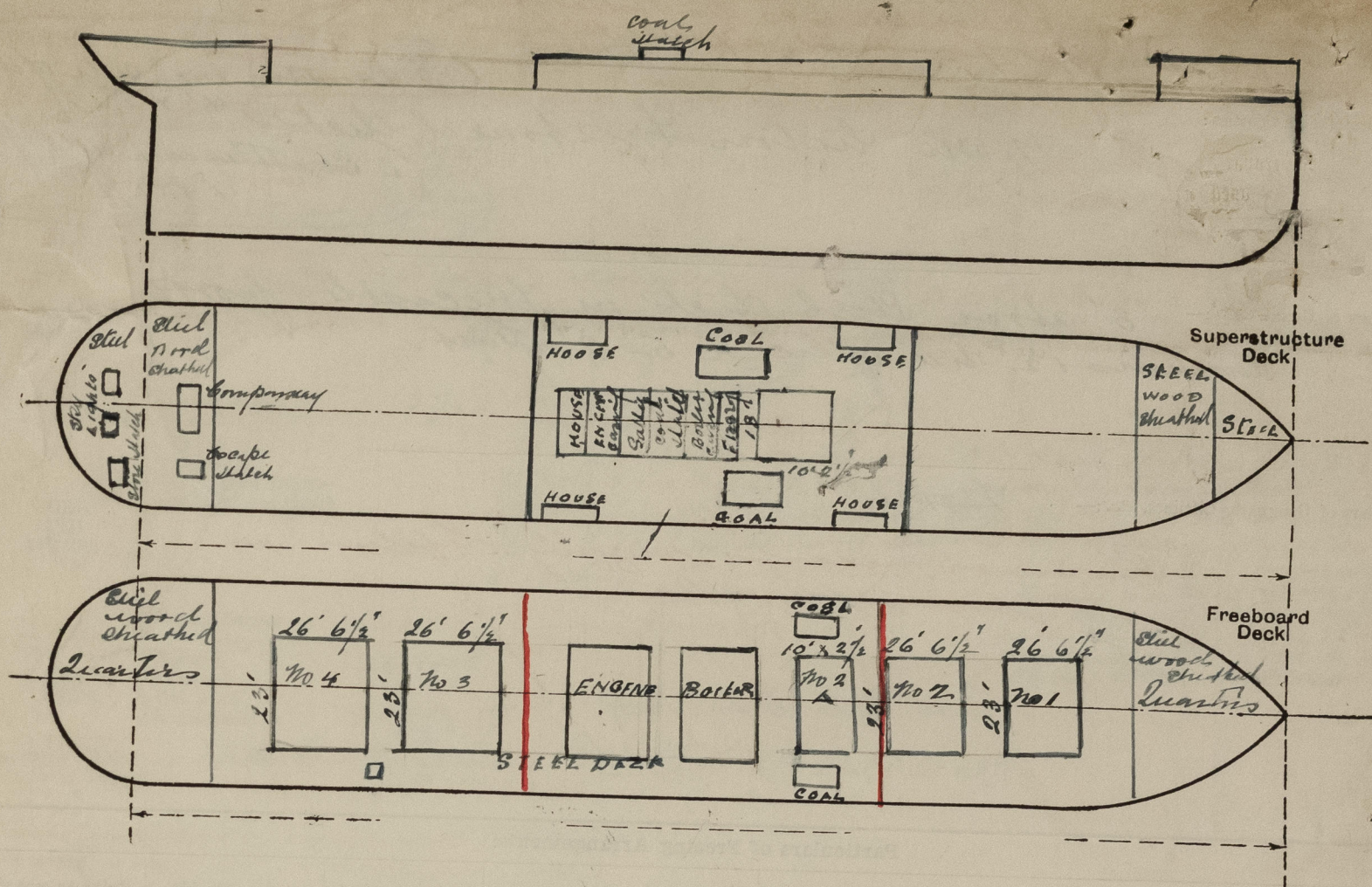

State any special features in the construction of the ship:—

Builder's name and yard number: *N. Gray & Co Ltd. West Hartlepool No 895*

Names of sister ships: _____

Owners: *Union S. S. Co Ltd Mellington N. 3*

Fee £ *6 : 5 : 0*

Received by me: *H. J. Bramford*



© 2020

Lloyd's Register Foundation