

AMERICAN COMMITTEE 15 DEC 1936

of

# Lloyd's Register of Shipping

17 BATTERY PLACE

NEW YORK

Appointed by the Department of Commerce to Assign Load Lines under the Provisions of the Act of March 2, 1929.

## REPORT OF ANNUAL LOAD LINE INSPECTION

PORT OF MOBILE, ALABAMA

DATE November 2nd 1936

THIS IS TO CERTIFY that the undersigned Surveyor to this Society did at the request of Atlantic Refining Company

and the S.S. "H.C. FOLGER" Official Number 214615

Philadelphia, Pa. at Mobile, Alabama

the 2nd day of November 1936, for the purpose of inspecting

protection of openings, (b) guard rails, (c) freeing ports, (d) means of access to

v's quarters, and found same to have been maintained in an effective condition; also,

no alterations had been made to hull or superstructures which would affect the cal-

cations determining the position of the load lines.

Renewal Survey has been completed, the present Certificate extended until May 2nd 1937 and fresh Certificates will be issued by the New York office.

*[Signature]*

Surveyor.

Is fee paid no

Surveyors should note that there is only one valid certificate, and the above endorsement should be made thereon. No entry should be made on a certified copy of the certificate unless original certificate has been produced to and endorsed by the Surveyor.

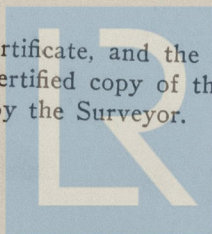

© 2021

Lloyd's Register Foundation

007219-007234-0127



6570  
15/12/36

AMERICAN COMMERCE DEC 1936

REGISTERED IN THE

NEW YORK

NEW YORK

NOTICE TO CERTIFY THAT THE UNDERSIGNED



© 2021

Lloyd's Register  
Foundation

DATE OF INSPECTION

THIS IS TO CERTIFY THAT THE UNDERSIGNED

has been duly inspected and found to be in accordance with the provisions of the Act of 1906 and the Regulations thereunder.

10/12/36

PRIN

Note:-  
+Where the p  
\*Upon made