

Lloyd's Register of British & Foreign Shipping.

WIDEN 20 FEB 1908
1908 20 FEB 1908

SURVEYS FOR FREEBOARD.-STEAM SHIPS.

PARTICULARS RELATING TO ALL STEAM SHIPS EITHER FLUSH DECKED, OR WITH TOP GALLANT FORECASTLES, SHORT POOPS AND BRIDGE HOUSES DISCONNECTED, OR WITH TOP GALLANT FORECASTLES HAVING LONG POOPS, OR RAISED QUARTER DECKS CONNECTED WITH BRIDGE HOUSES, OR OTHERWISE.

Port of Survey *Nagasaki*Date of Survey *5 Dec 08*Name of Surveyor *E. D. Cuthbert*

Ship's Name.

*ATSUTA MARU**Nº 197*

Number in Register Book

Port of Registry and Nationality.

Tokio
Japanese

Official Number.

8628

Gross Tonnage.

Date of Build.

1908

Particulars of Classification.

+100 Al. Contemplated

Registered dimensions from Ship's Register.

LENGTH.

464.25

BREADTH.

56.22

DEPTH.

31.54

UNDER DECK Tonnage.

*6873.06*Moulded Depth as measured.....*34'-6"*

NOTE.—If the depth is measured when vessel is afloat, the details of measurement should be reported.

Length on LOADLINE

*464.25*Frame Depth $\frac{1}{2}$ Rule*7*Ceiling *Antea* Sheer *34*

Peak

Tanks

included

CORRECTED DIMENSIONS.

*464.25**55.47**31.88**6873.06*

CORRECTION FOR LENGTH.

Length of Ship on Loadline.....*464.25*Length in Table*414*Difference*50.25*Correction for 10ft., Table A.*1.7* Table C.× Difference divided by 10*8.54* (if required.)If $\frac{1}{10}$ th length covered divide by 2 *+ 4 1/2*

CORRECTION FOR IRON DECK.

Proportion covered, if less than $\frac{1}{10}$ th length covered*643.624*Thickness of usual wood deck, less stringer.....*3 1/2**3" wood sheathing, difference 1/2 correction - 1/4*

CORRECTION FOR ROUND OF BEAM.

Breadth at Gunwale amidships.....*55-8*Round of Beam.....*14*Normal round*14*Difference*÷ 2 =*Proportion of Deck uncovered (Para. 19) *1/4*

NOTE.—The round of beam should be reported on the full breadth of vessel at the gunwale.

Freeboard, Table A*9-7 1/4*Correction for Sheer*9-7 1/4*Correction for Length*+ 4 1/2*Allowance for Deck Erections*9-9 1/4*Correction for Round of Beam.....*- 1-2 1/4*Correction for fall in Sheer (if any)*8-6 1/4*Correction for Iron Deck (if required)*- 1/4*

Additions for non-compliance with provisions of

Para. 11 (d) and (e) $\frac{1}{4}$ Other Corrections (if any).....*8-6 1/4*Winter Freeboard*8-6 1/4*Summer Freeboard*7-11 1/4*Indian Summer Freeboard*7-8 1/4*N. A. Winter Freeboard*8-1 1/2*Correction necessary because clearside amidships, measured in accordance with the Statute, is not taken at the intersection of the wood or iron deck with side. *2 1/4*Winter Freeboard from deck line*8-8 1/4*Summer " " " "*8-15 1/4*Indian Summer " " " "*7-7 1/4*N. A. Winter " " " "*8-1 1/2*

ALLOWANCE FOR DECK ERECTIONS:—

Freeboard, Table C.....*9-7 1/4 - 1-1*Correction for Length, if required (Para. 12, 13, and 14) *6-7 1/4*Freeboard by Table A, corrected for sheer, and for length, if required (Para. 12, 13, and 14) *9-4 1/4*Difference*3-0*Percentage as below.....*41.3%*Correction for R. Q. Dk. if engine and boiler openings not covered by bridge house (Para. 11) *15 1/4*Allowance for Deck Erections *15 1/4*

Length. Length allowed. Height.

Forecastle, flush deck *53-10**53-10**7-9*Bridge House*175-6**175-6**7-9*Raised Qr. Dk.*60-8**60-8**7-9*Total*290**290**624*Length of Ship*464.25**464.25**624*Responding percentage *41.3%*Para. 11, 12, 13, or 14) *41.3%*

FREEBOARD recommended amidships from centre of Disc to top of Statutory Deck Line, Wood (Iron) deck:—

Fresh Water Line

above centre of Disc

Indian Summer Line

" " *Amended Table*

Winter Line

below " *March, 1908*

Winter North Atlantic Line

" " "

If the frames, skin planking, or ceiling are of unusual thickness the breadth of vessel to inside of ceiling should be reported if possible.

In vessels obtaining an allowance for deck erections under Para. 11 where the sheer drops abaft amidships the height of the R. Q. D. is to be taken from the level of the top of the amidships beam.

In flush-decked vessels the total standard mean sheer means the sheer measured at the stem and stern-post. In vessels having poops and forecastles, it means the sheer measured at points distant one-eighth of the vessel's length from stem and stern-post.

State dimensions of freeing port area on back of this form.

The Surveyor should state whether the fall in sheer as reported is measured relatively to the straight line of keel or to the water line. If measured relatively to water line the vessel's draft at time of survey, and also the usual load draft forward and aft, should be reported.

RECEIVED 22 FEB 1908

F.T.O.

006760-006771-0269

Do all the Frames extend to the top height in the Poop? *yes* Raised Quarter Deck? *no* Bridge House? *yes* Forecastle? *yes*
 To what height do the Reverse Frames extend? *Upper dk for 35' in. before & abaft that to upr. M. & alternately, and to 4' to 8' & Main dk alternately.*
 Has the Poop or Raised Quarter Deck an efficient Iron Bulkhead at the fore end? *yes*
 Give particulars of the means for closing the openings in Bulkhead *Hinged iron W. T. doors*
 Is the Poop or Raised Quarter Deck connected with the Bridge House? *no* Has the Bridge House an efficient Bulkhead at the fore end? *yes*
 Give particulars of the means for closing the openings in Bulkhead *Hinged iron W. T. doors*
 What is the thickness of the Bridge Front plating? *9/16* and Coaming plate? *10/16*
 Give scantlings and spacing of the Stiffeners *7 1/2 x 3 1/2 x 13/20 Bulk angles spaced 30" apart*
 Are bracket plates fitted at each end of the Stiffeners? *yes* Are hor'l. brackets fitted connecting Bridge Bulk'd. with Bulwarks? *yes*
 Has the Bridge House an efficient Iron Bulkhead at the after end? *yes*
 How are the openings closed? *Storm boards half height in riveted channels*
 Is the Forecastle at least as high as the main or top-gallant rail? *yes* Has the Forecastle an efficient Iron or Wood Bulk'd. at after end? *yes*
 Are the Engine and Boiler openings covered by a Bridge, Poop, Raised Quarter Deck, or enclosed by a Strong Iron or Steel Deckhouse? *yes*
 If the openings are not so protected are the exposed parts of the Casings efficiently constructed? *no*
 Give thickness of plating; scantlings and spacing of Stiffeners *no*
 What is the height of the exposed Casings? *no* Are suitable means provided for closing all openings in them in bad weather? *yes*
 Are the Weather Deck Hatchways efficiently constructed and at least equal to the requirements of Section 28 of the Rules for 1904-5? Give particulars below: *yes*

Position and Size.	N ^o 1 4' 6" x 16		N ^o 2 28' 2" x 18		N ^o 3 17' 4" x 16 on bridge dk		N ^o 4 23' 10" x 18		N ^o 5 21' 8" x 18	
Item.	Ship.	Rule.	Ship.	Rule.	Ship.	Rule.	Ship.	Rule.	Ship.	Rule.
COAMING										
Height above top of DECK	30	30 24	30	30 24	24	18	30	30 24	30	30 24
Thickness { Sides.....	9/16	9/16	10/16	10/16	9/16	9/16	10/16	9/16	9/16	9/16
Ends.....	8/16	8/16	9/16	9/16	8/16	8/16	9/16	8/16	8/16	8/16
SHIFTING BEAMS OR WEB PLATES										
Number.....	1	1	3	3	2	2 1	2	2	2	2
Section and Scantlings.....	web 8/16	web 8/16	webs 9/16	webs 9/16	webs 8/16	webs 8/16	webs 9/16	webs 8 1/16	webs 8/16	webs 8/16
Material.....	steel	steel	steel	steel	steel	steel	steel	steel	steel	steel
FORE AND AFTERS										
Number.....	3	3	3	3	3	3	3	3	3	3
Section and Scantlings.....	1 bulb plate 10 x 10/16	do	1 bulb plate 11 x 10/16	do	Same as N ^o 1.	do	Same as N ^o 2	do	Same as N ^o 2	do
Material.....	2 7 x 5 x 1/16		2 8 x 5 x 1/16	steel						
HATCHES Thickness.....	3	do	3	do	3	do	3	do	3	do
Remarks.....	wood		wood		wood		wood		wood	

* When the Fore and Afters are of wood the depth should be stated from the underside of the hatches:—

(If the sill of the lowest side scuttle will be less than 6 inches above the Indian Summer Load Line if assigned under the Rules, state vertical distance from top of deck at side amidships to lower edge of lowest side scuttle.)

The following information is to be given in all Cases of vessels dealt with under Paras. 11, 12 (under 15 feet Moulded depth) and under Shelter Deck Rules:—

What is the thickness of the Bridge Sheerstrake? *16/16* Strake between Main and Bridge Sheerstrakes? *13/16*
 Delete the words { The Crew ~~are~~, are not, berthed in the bridge house.
 that do not apply { The arrangements to enable them to get backwards and forwards from their quarters are, are not satisfactory.

Length of Bulwarks in well *aft 84-6*
400 88-10
 Area of Freeing Ports required by Para. 11 (e) each side of vessel = *34.66* Sq. ft.

Ft.	Tenths.	Pt.	Tenths.	No.
4	5	x	1.29	x 3
4	75	x	1.29	x 3

 Freeing Ports (each side of vessel) = *35.8* Sq. ft.
 Total deficiency or excess = *7.14* Sq. ft.

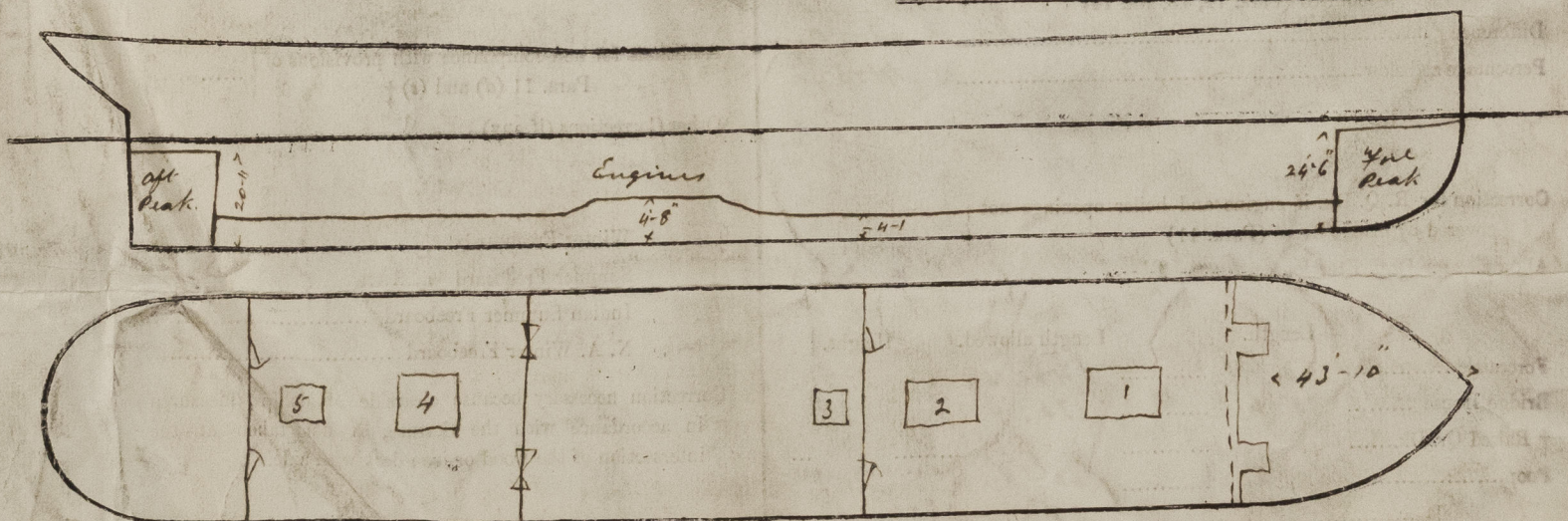

Show hereon line of Floors or Tank Top with position of any Breaks in same; also height of Peak Tank tops, &c., &c.

State any special features in the construction of the Vessel *Sister vessel to "Hirano Maru" Request for survey is enclosed. Plans will be forwarded in a few days.*

Owners *Nippon Yusen Kaisha*

Address *Tokio*

Fee £ *1*

Received by me *no*



© 2021

Lloyd's Register Foundation