

MIDSHIP SECTION.

T.S.M.V. ATAGO MARU.

SCALE $\frac{1}{2} = 1$ FOOT

DIMENSIONS.
 140'-0" B.P. x 57'-0" MLD x 57'-3" EXTREME x 58'-6" MLD TO UPPER DECK
 TO CLASS 100 A1 AT LLOYD'S SPECIAL SURVEY (WITH FREEBOARD)
 SCANTLING TO OBTAIN AN EXTREME LOAD DRAFT OF 28'-3"

NUMERALS.

1 st LONGITUDINAL NUMBER	L x D = 439.7 x 38.5	= 16928.45
2 nd	L x (B + D) = 439.7 (57.0 + 38.5)	= 41991.55
PROPORTIONS	$\frac{L}{D}$ TO UPPER DECK	= 439.7/38.5 = 11.42
d	CLEAR OF 3 RD DECK	= 38.5 - (3.87 x 10.0) = 24.63
d	N WAY OF 3 RD DECK	= 38.5 - (10.0 + 2.0 + 3.87) = 16.63
D		38.50

EQUIPMENT NUMBER.

2 ND LONGITUDINAL NUMBER		41991.55
FORECASTLE	42'-0" x 7.75' x $\frac{3}{8}$ "	244.10
SALOON HOUSE	20'-6" x 7.75' x $\frac{1}{2}$ "	103.10
OFFICERS HOUSE	23'-16" x 7.75' x $\frac{1}{2}$ "	89.14
CASINO & SIDEHOUSES	66'-6" x 7.75' x $\frac{3}{8}$ " & 8' x 7.75' x $\frac{1}{2}$ "	418.19
STEERING GEAR HOUSE	18'-6" x 7.75' x $\frac{3}{8}$ " & 22' x 7.75' x $\frac{1}{2}$ "	193.10
	EQUIPMENT NUMBER	43040.74

EQUIPMENT.

2 BOWER ANCHORS	58 CWTs	EX STOCK
1 ANCHOR	40" x 1"	
1 STREAM ANCHOR	20" x 1"	
300 FATHOMS 2" $\frac{1}{16}$ "	STUB LINK CHAIN CABLE	844 CWTs 1 DR
120' x 1" $\frac{1}{16}$ "	STREAM CHAIN OR 5" STEEL TIRE	
150' x 1" $\frac{1}{16}$ "	HEMP TOWLINE OR 5" STEEL WIRE	
2 HAWKERS	100 FATHOMS 8" HEMP OR 9"	
2 WARPS	100	

RIVETING.

RIVETS IN FLOORS & CROSS TIE PLATES IN AFT PEAK SPACED 5 DIA^{AS} OR TO CR
 1" FRAMES TO FLOORS & SHELL PLATING FOR 3" L FOR SPACED 3" DIA^{AS} OR TO CR
 1" SHELL IN WAY OF 3" SPACINGS SPACED 6 DIA^{AS} OR TO CR
 1" BUTTS OF SHELL PLATING & DECK STRINGERS SPACED 3" DIA^{AS} OR TO CR
 1" BUTTS OF SHELL PLATING & EDGES OF SHELL PLATING END LAPS OF DECK PLATING
 MARGIN PLATES & BUTTS OF INNER BOTTOM PLATING SPACED 4 DIA^{AS} OR TO CR
 RIVETS IN 5" BUTTS IN EDGES OF DECK PLATING BUTTS & EDGES OF BULKHEAD & TUNNEL PLATING
 GUNWALE ANGLES & BULK FRAME TO BULK SPACED 4" DIA^{AS} OR TO CR
 RIVETS AT FLAT KEEL ANGLES VERTICAL ANGLES CONNECTING FLOORS TO CR, SIDER & SHELL FLANGE
 OF W.T. BULK^{AS} FRAMES SPACED 5 DIA^{AS} OR TO CR
 RIVETS IN FRAMES TO SHELL IN FORE & AFT PEAKS SPACED 3" DIA^{AS} OR TO CR
 RIVETS IN FRAMES & REVERSE FRAMES TO FLOORS DECK PLATING TO BEAMS BULKHEAD STIFFENERS
 VERTICAL ANGLES CONNECTING FLOORS & DECK GIRDERS SPACED 7 DIA^{AS} OR TO CR
 RIVETS IN SHELL CONNECTING ANGLES & IN WAY OF 3" SPACINGS & 5" IN WAY OF 27" SPACINGS
 DEEP TANK RIVETING AS PER RULE.

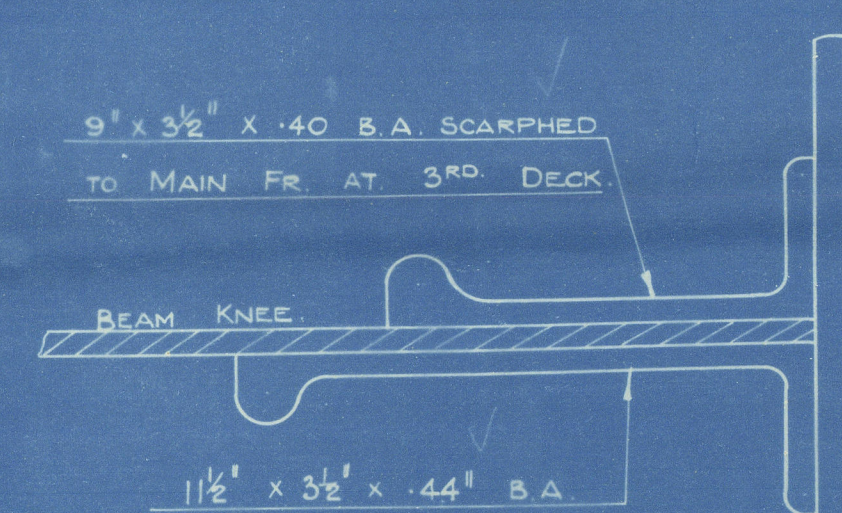
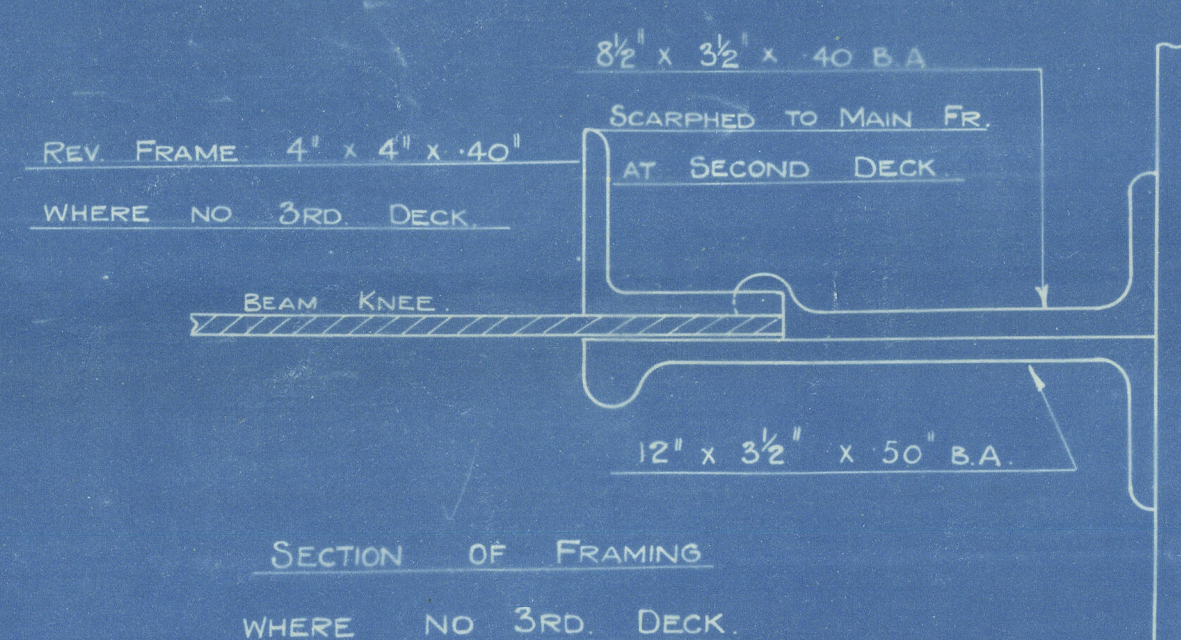

CENTRE STRAKE
55 x 54 FOR 1/2 L & TO 46 AT ENDS

CENTRE GIRDER TOP ANGLE
3 1/2' x 3 1/2' x 56' FOR 1/2 L & TO 56 AT ENDS

CENTRE GIRDER
46 1/2' x 60' FOR 1/2 L & TO 58 AT ENDS

6" GIRDER VERTICAL ANGLE SINGLE
3 1/2' x 3 1/2' x 43' SINGLE 5' x 48' FITTED
UNDER ENGINE & THRUST BEAMS
IN LIEU OF DOUBLE 3" ANGLE

CENTRE GIRDER BOTTOM ANGLE
5' x 48' FOR 1/2 L & TO 58 AT ENDS

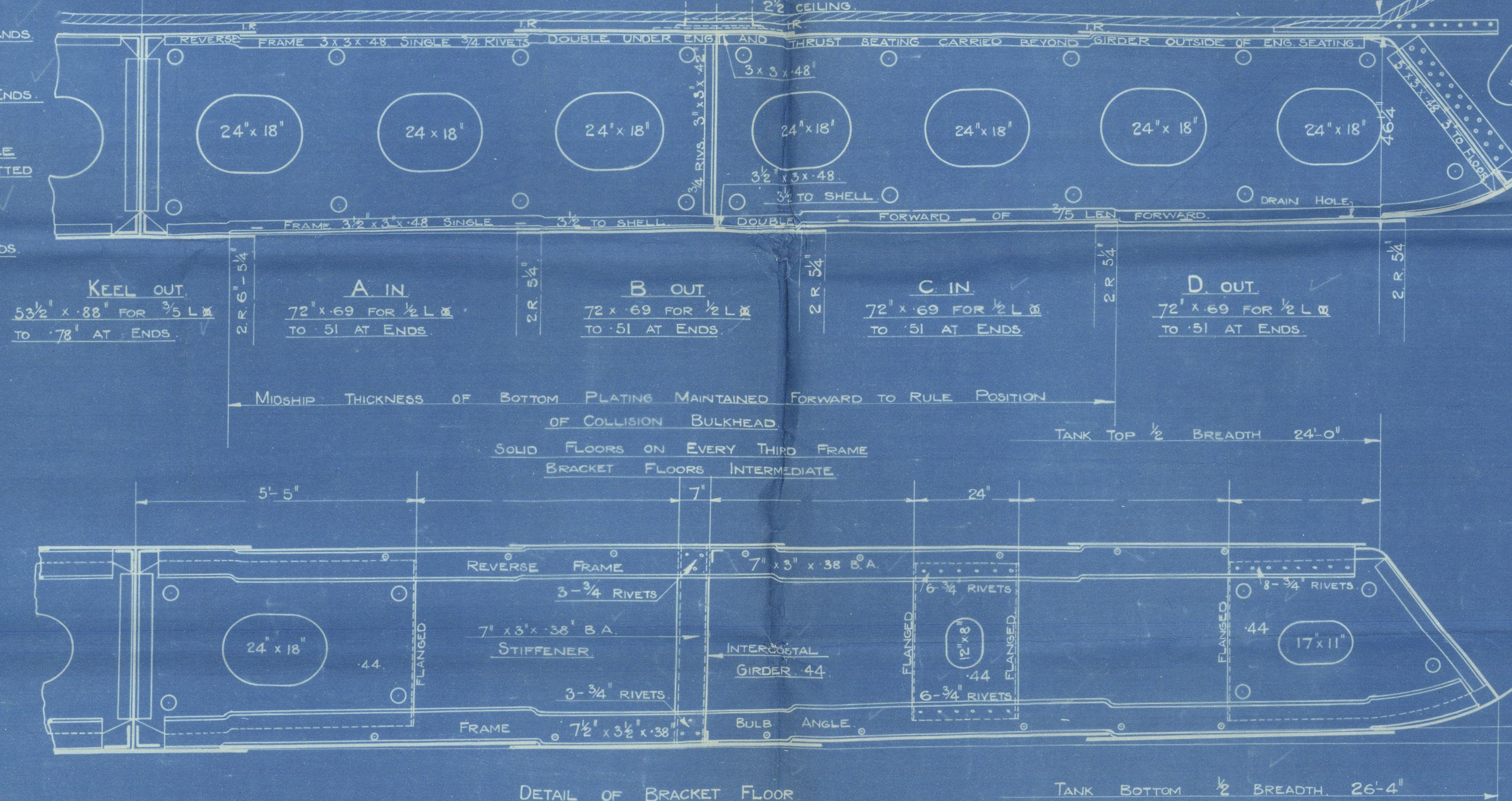

UPPER DECK PLATING
56 FOR 1/2 L & AHEAD OPENINGS
42 INSIDE LINE OF OPENINGS AND
MINIMUM THICKNESS AHEAD OPENINGS
36 AT ENDS

STRINGER PLATE
RULE 65' x 69' FITTED 70' x 68'
REDUCED 10' IN VIEW OF BREADTH
40' x 44' AT ENDS
STRINGER ANGLE 5 1/2' x 3 1/2' x 44' AT ENDS

FORECASTLE
BEAMS 10' x 3 1/2' x 48' B.A. ON ALL FRAMES WITH REDUCTIONS
TWO ROW SUEE (SPAN NOT EXCEEDING 13'-6")
STRINGER PLATE 55' x 36'
DECK PLATING 30 SHEATHED
STRINGER ANGLE 5 1/2' x 3 1/2' x 36'
SIDE SHELL PLATING 142

M OUT
RULE 51' x 75' FITTED 60' x 76'
REDUCED 12' IN VIEW OF INCREASED
BREADTH 48 AT ENDS

L IN
RULE 51' x 75' FITTED 60' x 76'
REDUCED 12' IN VIEW OF INCREASED
BREADTH 48 AT ENDS

K OUT
72' x 67' FOR 1/2 L & TO 48 AT ENDS

J IN
72' x 67' FOR 1/2 L & TO 48 AT ENDS

H OUT
72' x 67' FOR 1/2 L & TO 48 AT ENDS

G IN
72' x 67' FOR 1/2 L & TO 48 AT ENDS

F OUT
69' x 67' FOR 1/2 L & TO 48 AT ENDS

F IN
69' x 69' FOR 1/2 L & TO 51 AT ENDS

FRAME CONNECTED TO WING
BRACKET BY 10-8 RIVETS

GUSSET ANGLE
IN WAY OF 3RD DECK
3 1/2' x 3 1/2' x 48' SINGLE
6' x 8' RIVETS ON
EVERY FRAME

MARGIN PLATE
MARGIN PLATE 45' x 56' FORE AND AFT
MARGIN CONNECTION ANGLE 5' x 5' x 48'
WITH 17-8 HYDRAULIC RIVETED THRO
MARGIN

SECTION OF FRAMING
IN WAY OF 3RD DECK

MIDSHIP. SECTION. OF. SHIP

AS BUILT

LITHGOW'S LTD. No. 762.

T.S.M.V. "ATAGO MARU"

GRK. RPT. No. 18320.



© 2020

Lloyd's Register
Foundation

006505-006511-0073