

-7 JUL 1932

21 = 174

PARTICULARS OF PROTECTION TO OPENINGS, ETC.

All ports in ships sides between foreboard and second decks (i.e. whale & factory decks) are of strong construction, and are capable of being closed watertight when ship is at sea.

None

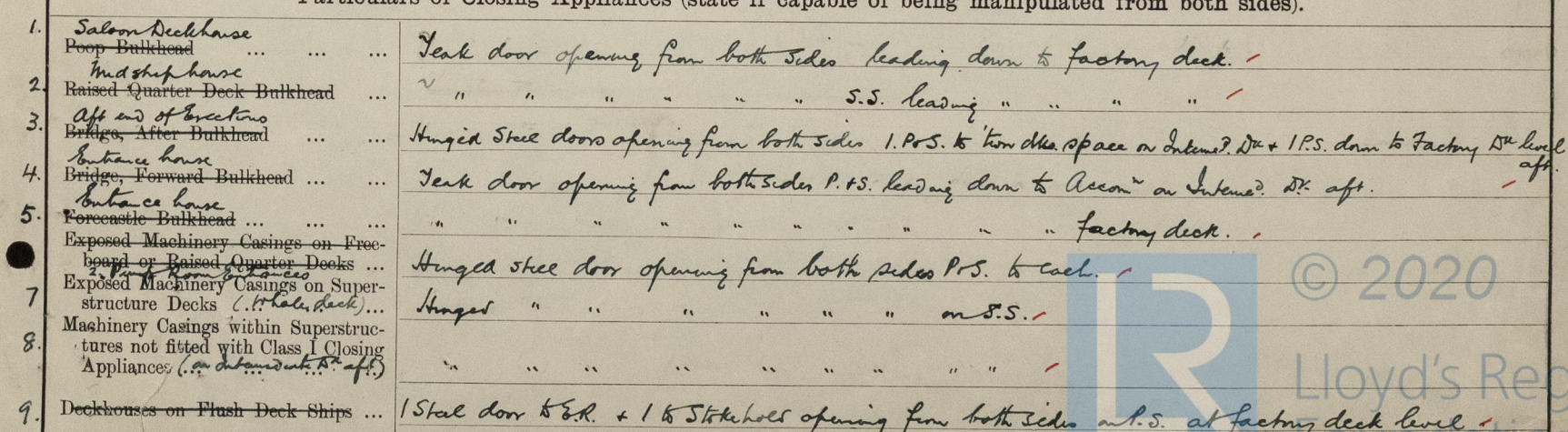

Superstructure bulkheads, trunks, deckhouses, casings, cargo and coaling hatchways, extent and thickness of sheathing on the freeboard deck, gangway, cargo and coaling ports, and any other openings, etc., which would affect the seaworthiness of the ship are to be shewn on the following sketches:—

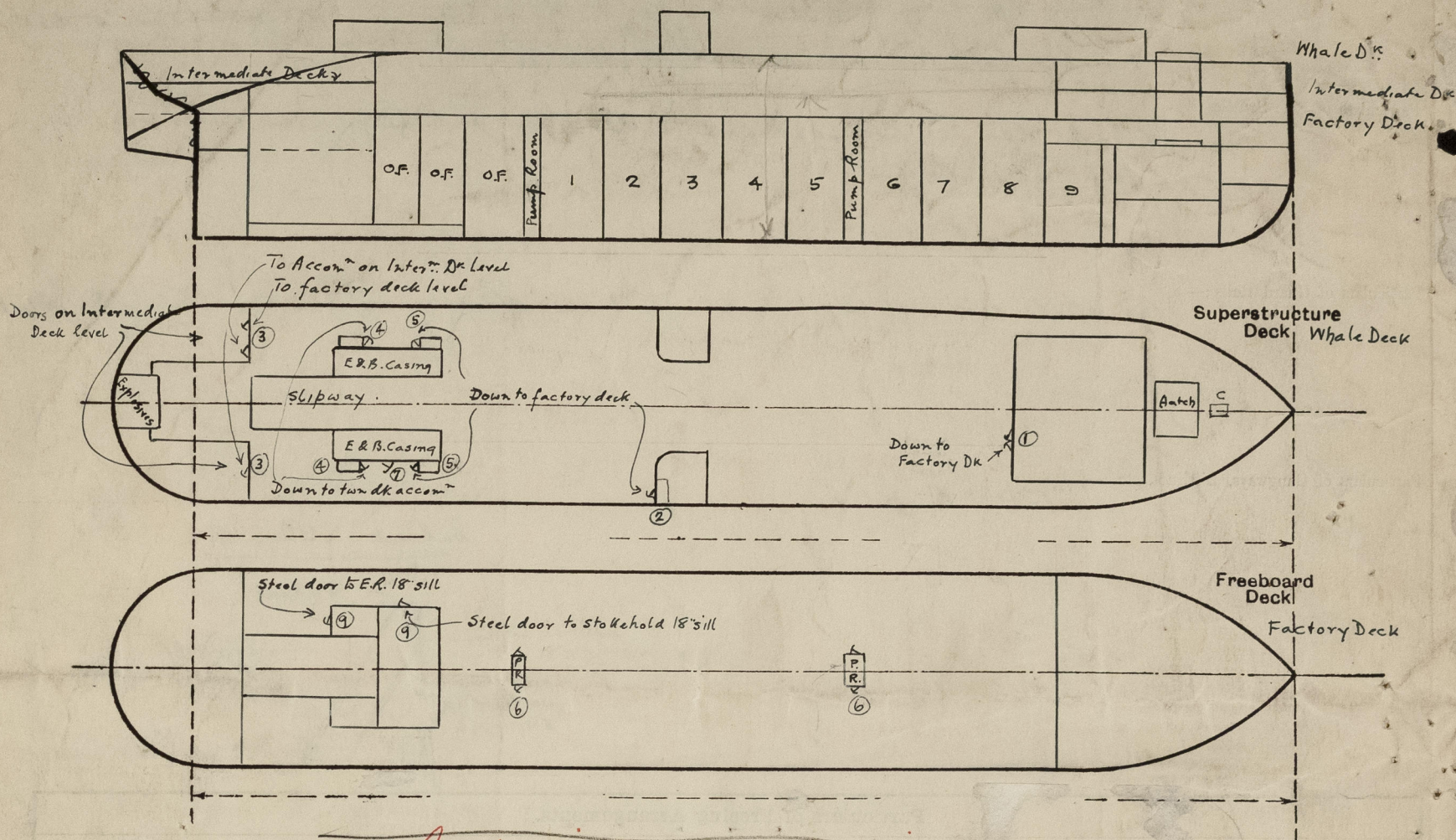

*For particulars of alterations
see attached sheet (copy) rec'd
from H.W.C. Surveyors. 1/8/33*

State any special features in the construction of the ship:—

*See plan now forwarded for displacement tons per inch - please return plan
Present L.R. freeboards from certificate on board*

*Summa = 21-8" below upper Dk.
F.W. = 7½"
I.S. = 6½"
W = 6½"*

1¾ stat. deck line.

The Survey has been confined to the above.

*31.05
17
31.24*

*23952
11500
25052*

Builder's name and yard number *Swan Hunter & Wigham Richardson*

Names of sister ships

Owners *Viking Whaling Co Ltd. (S. Cartwright)*

Fee *£ Kr. 310.00*

Received by me

Travelling Expenses 31.50



© 2020

Lloyd's Register
Foundation