

— STATE OF VICTORIA —  
— SUCTION HOPPER DREDGE —  
— UPPER DECK PLATING —

SCALE  $\frac{1}{4}$  IN = 1 FT

STRINGER PLATE

BUTTS TREBLE RIVETED FOR  $\frac{1}{2}$  LENGTH AMIDSHIPS, DOUBLE RIVETED AT ENDS *where 1/2 length*

DECK PLATING

BUTTS DOUBLE RIVETED FOR  $\frac{1}{2}$  LENGTH AMIDSHIPS, SINGLE RIVETED AT ENDS ✓

ALL LANDING EDGES THROUGHOUT SINGLE RIVETED ✓

BUTTS IN SHEER STRAKE SHEWN THUS \$

STRINGER PLATING  $\frac{3}{32}$   $\frac{1}{2}$  LENGTH AMIDSHIPS,  $\frac{3}{16}$  AT ENDS ✓

DECK PLATING  $\frac{3}{16}$  THROUGHOUT EXCEPT AT FORE & AFT ENDS OF HOPPER WHERE IT IS  $\frac{3}{16}$  ✓

PLATING TO BE  $\frac{1}{2}$  THICK UNDER ALL DECK MACHINERY ✓

— DRAWING N° 4



29.5.1.



BUTTS TO BE 5" THICK UNDER ALL DECK MACHINERY  
 DECK PLATING 30 THROUGHOUT EXCEPT AT BUTTS  
 STRINGER PLATING 25 1/2 LENGTH AMIDSHIP 30  
 BUTTS IN SHEER STRAKE SHOWN THREE  
 ALL LANDING EDGES THROUGHOUT SINGLE RIVETS  
 BUTTS DOUBLE RIVETED FOR 1/2 LENGTH AMIDSHIP 25  
 DECK PLATING  
 BUTTS TRIPLE RIVETED FOR 1/2 LENGTH AMIDSHIP 20  
 STRINGER PLATE

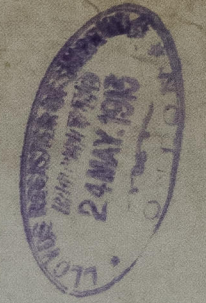
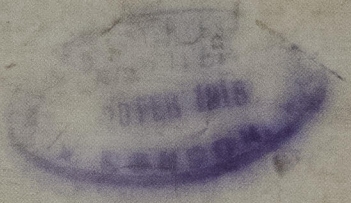

5300-532500-122900

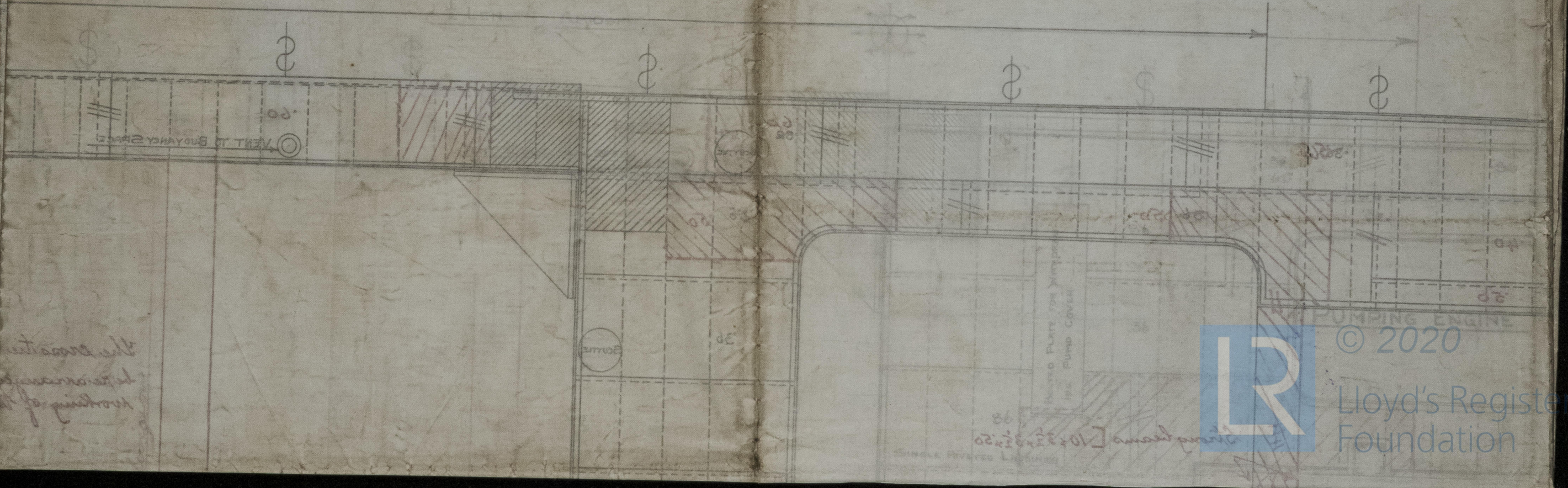

The structure  
 is shown  
 in the drawing