

30.6.09

John Doe

SKETCH OF SHELL PLATING

10
20 IN LIEU OF DOUBLING
FOR HAWSE PIPE

CANT BEAMS $4" \times 2\frac{1}{2}" \times \frac{5}{16}"$ ANGL.
— FRAMES $4" \times 3" \times \frac{5}{16}"$ ANGL.

POOP BULKHEAD $\frac{6}{20}$ PLATES /
NO COAMING. STIFFENED WITH
 $4 \times 3 \times \frac{6}{20}$ ANGL. SPACED 30" APART

BULKHEAD $5\frac{1}{2}$ " PL. WITH COAMING $18\frac{1}{2}$ "
STIFFENED WITH $4\frac{1}{2}$ " $3\frac{1}{2}$ " ANGLES
SPACED 30" APART
2 CARGO OPENINGS $4'-6"$ \times $3'-0"$

SIDE DECK HOUSE $\frac{5}{16}$ " PLATES STIFFENED
WITH $3 \times 2\frac{1}{2} \times \frac{5}{16}$ " ANGL. SPACED 30"
APART BEAMS $4 \times 3 \times \frac{5}{16}$ ", 46" APART.

5"
CASING 20 PL. WHERE DECK HOUSE
STIFFENED WITH 3x3x5/8" ANGL.
SPACED 30" APART
GALLERY

HALF BEAMS $5 \times 3 \times \frac{9}{16}$ ANG. BEAMS $7 \times 3 \times \frac{9}{16}$ B.A.
CASING $\frac{5}{8}$ PL
STIFFENED WITH $3 \times 3 \times \frac{1}{2}$ ANG. SPACED 30" APART

CHART
HOUSE
4" P.

HORIZONTAL BRACKETS CONNECTING
BULKHEAD WITH BULKHEADS

FRONT BULKHEAD $\frac{9}{16}$ " PL WITH COAMING
21" x $\frac{7}{16}$ " STIFFENERS 15" x $\frac{3}{4}$ " B.A. SPACED 30" APART
BRACKETS 18" x $\frac{7}{16}$ " TO BOTH DECKS. BOTTOM ANGLE
DOUBLE 3" x $\frac{5}{16}$ " ANGLE ON TOP SINGLE 3" x $\frac{5}{16}$ " ANGLE.
2 WT CARGO OPENINGS 2'-6" x 2'-6" (HINGED)

$\frac{6}{20}$ PLATES

E BULKHEAD $\frac{5}{20}$ PL. COAMING
ENED WITH $4 \times 3 \times \frac{6}{20}$ ANGL.
30" APART.

CREW SPACE

UPPER STRINGER

3" x 3" x $\frac{6}{16}$ "

3 1/2" x 3 1/2" x $\frac{7}{16}$ "

PLATE 19" x $\frac{7}{16}$ "

8" x 3 1/2" x $\frac{10}{16}$ " B.

KNIFE 8" x 8"

11425 ZDA /20

B. A.

BULKHEAD $\frac{6}{20}$ " PL. VERTICAL
WITH $7 \times 3 \times \frac{8}{20}$ " B.A. SPACED

CONNECTED WITH 15" x 8/20
TANKTOP



HECK

Date: 22-6-
 Tegner of
 [Signature]

BERG

22-6-09.

005489.

S/S № 159

PROFILE & DECK PLANS

SCALE $\frac{1}{8}$ " = 1 FOOT ENG. MEASURES B.M.V. 22-6-09.

Dnt. 22-6-09
 Tegner af G. A.
 Kontor af G. A.

© 2020
Lloyd's Register
Foundation
005489-005502-0100

3076709

Skibstegnekontoret No. 1694.

☒ SPACE FOR LOWERING OF BOILER

SCALE 1/8" = 1 FOOT END MEASUREMENTS
 PROFILE & DECK PLANS

S/S No 159

S.A.
 60-6-28

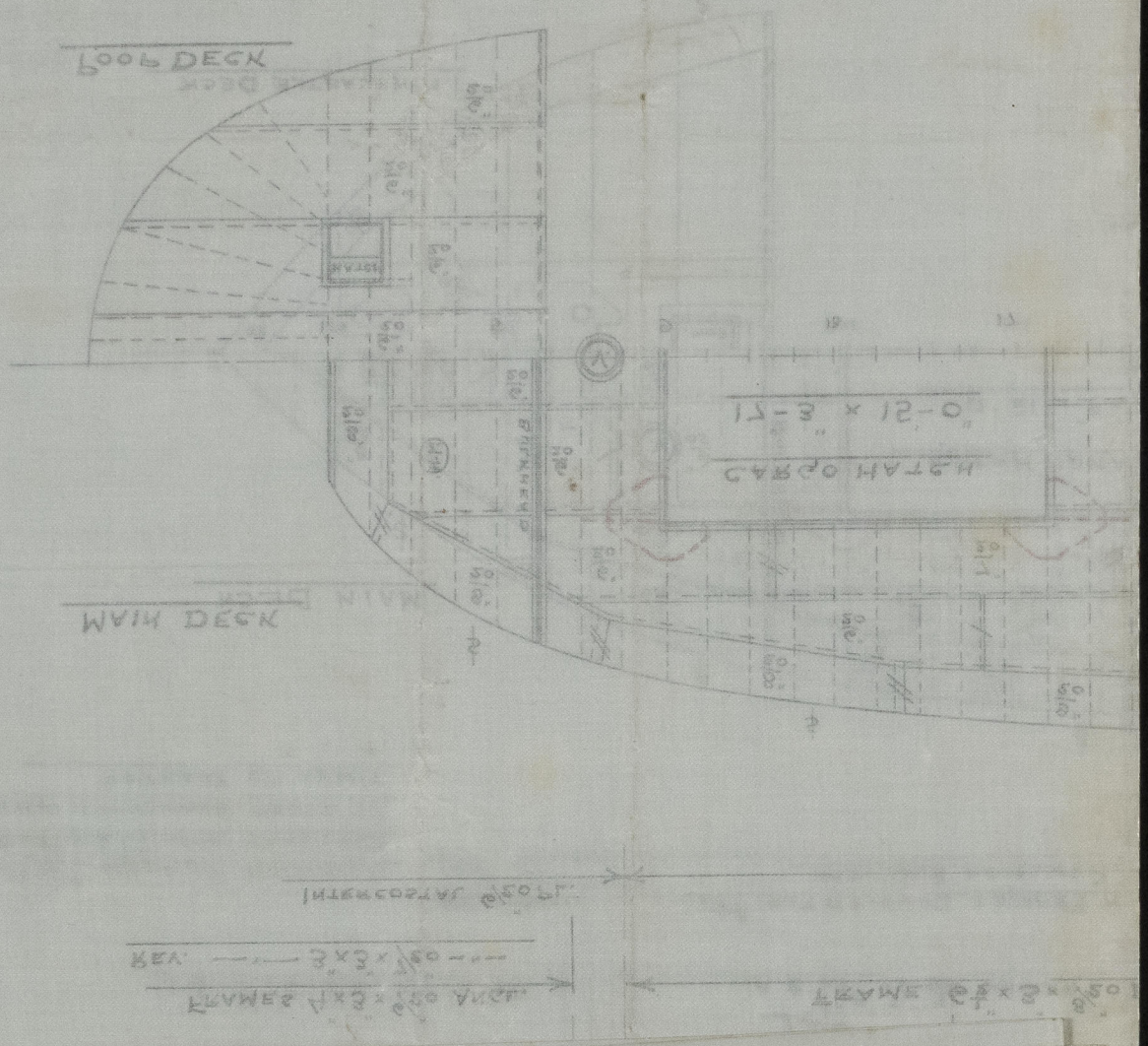

S.S. "Skulda"
 Regd 802

0010-205500-684500

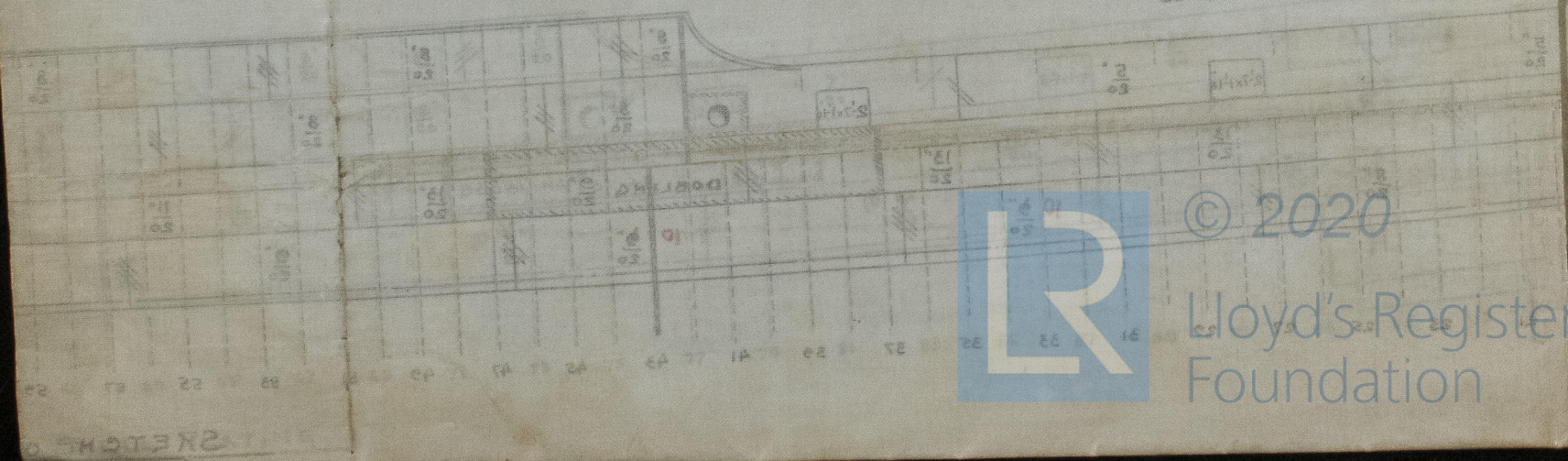

© 2020
 Lloyd's Register
 Foundation