

Lloyd's Register of Shipping.  
SURVEYS FOR FREEBOARD.  
(CONDITIONS OF ASSIGNMENT.)

Nº 16489.

Ship's Name *ss "Singkep"* Port of Survey *Amsterdam*  
Official Number *✓* Surveyor's Signature *J. J. J. J.*  
Nationality and Port of Registry *Netherlands Amsterdam* Date of Survey

Disposition and dimensions of superstructures, trunks, deckhouses and machinery casings to be inserted in the diagrams and tabular statement : -

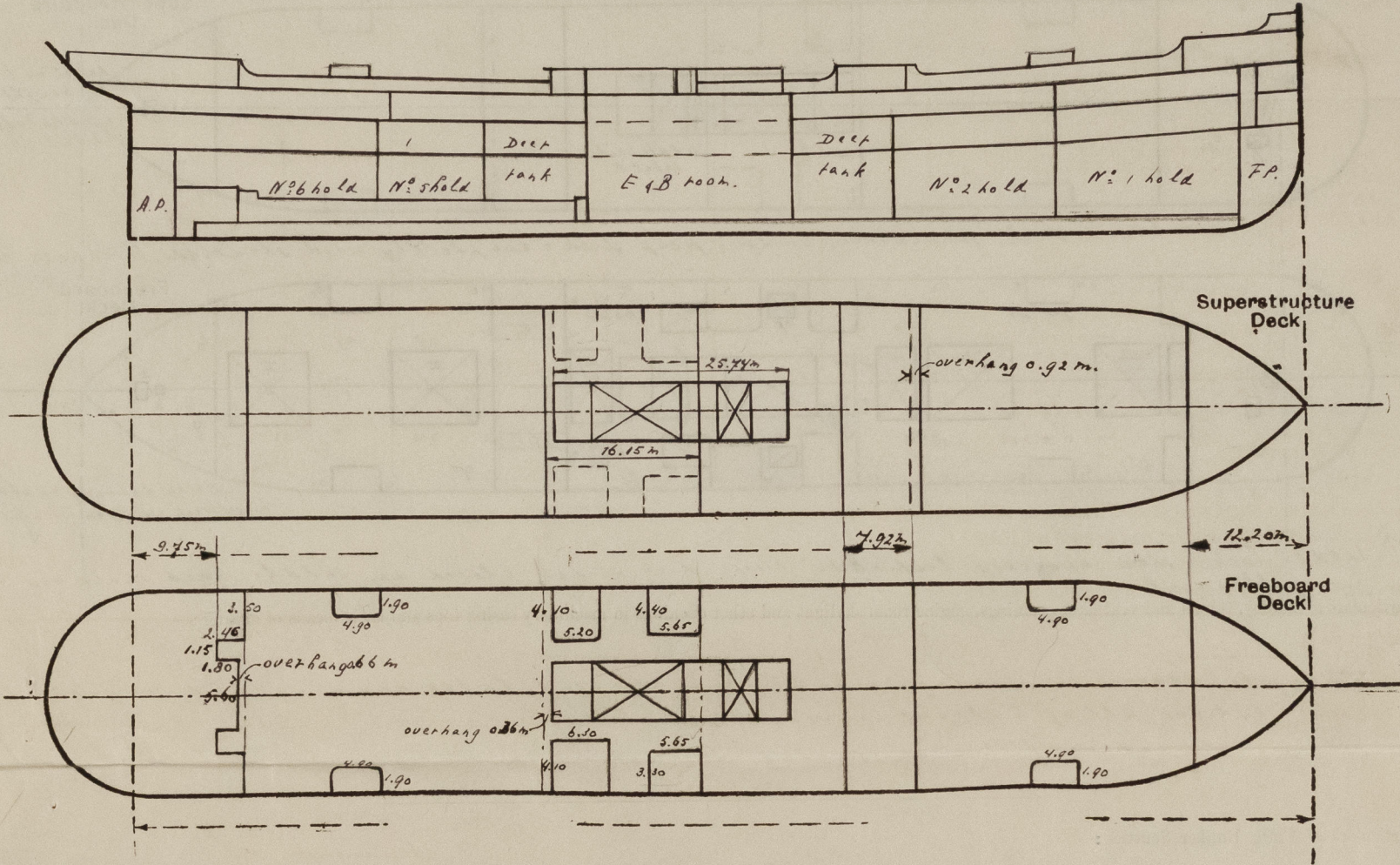

Particulars of Superstructures, Trunks, Casings, Deckhouses.								
	Coaming	Plating	Stiffeners	Spacing	End Attachments of Stiffeners	Size of Openings	Height of Sills	Height of Casings
Poop Bulkhead ...	—	8 mm	C 150x75x10	750 mm	none	2x 1.46 x 0.69 m 2x 1.45 x 0.60 m	0.40 m	2.23 m
Raised Quarter Deck Bulkhead ...	✓							
Bridge, After Bulkhead ...	—	8 mm	L 80 x 80 x 9	700 mm	none	2x 1.50 x 0.75 m	0.40 m	2.23 m
Bridge, Forward Bulkhead ...	—	10 mm	C 150 x 75 x 10	700 mm	Lugs top & bott.	2x 1.50 x 0.75 m	0.35 m	2.23 m
Forecastle Bulkhead ...	—	8 mm	L 75 x 75 x 9	630 mm	none	2x 1.55 x 1.20 m 3x 1.55 x 0.60 m 1x 1.45 x 0.90 m 1x 1.55 x 0.80 m	0.40 m	2.23 m
Trunk, Aft ...	✓							
Trunk, Forward ...	✓							
Exposed Machinery Casings on Freeboard or Raised Quarter Decks ...	0.70 m x 1.0 m	8 mm	L 100 x 65 x 9	660 mm	none	2x 1.52 x 0.75 m 2x 1.50 x 0.60 m 1x 0.50 x 0.35 m (1st 5.0)	0.61 m	2.35 m
Exposed Machinery Casings on Superstructure Decks ...	✓							
Machinery Casings within Superstructures not fitted with Class I Closing Appliances ...	✓							
Deckhouses on Flush Deck Ships ...	✓							

Particulars of Closing Appliances (state if capable of being manipulated from both sides).	
Poop Bulkhead ...	2 hinged steel + 2 hinged wood doors (operated from both sides) ✓
Raised Quarter Deck Bulkhead ...	✓
Bridge, After Bulkhead ...	2 hinged wood doors (operated from both sides.) ✓
Bridge, Forward Bulkhead ...	2 hinged w.t. steel doors (operated from both sides) ✓
Forecastle Bulkhead ...	4 hinged steel doors (operated from both sides) + 1 steel hinged w.t. door (op. fr. outside only) ✓
Exposed Machinery Casings on Freeboard or Raised Quarter Decks ...	2 portable steel plates on hook bolts. ✓
Exposed Machinery Casings on Superstructure Decks ...	4 hinged steel doors (operated from both sides) ✓
Machinery Casings within Superstructures not fitted with Class I Closing Appliances ...	1 hinged steel door on ash hoist (operated from outside only) ✓
Deckhouses on Flush Deck Ships ...	✓



# PARTICULARS OF PROTECTION TO OPENINGS, ETC.

The following diagrams should be used to indicate the positions of cargo and coaling hatchways, gangway, cargo and coaling ports, ventilators, companionways, etc., which would affect the seaworthiness of the ship:—

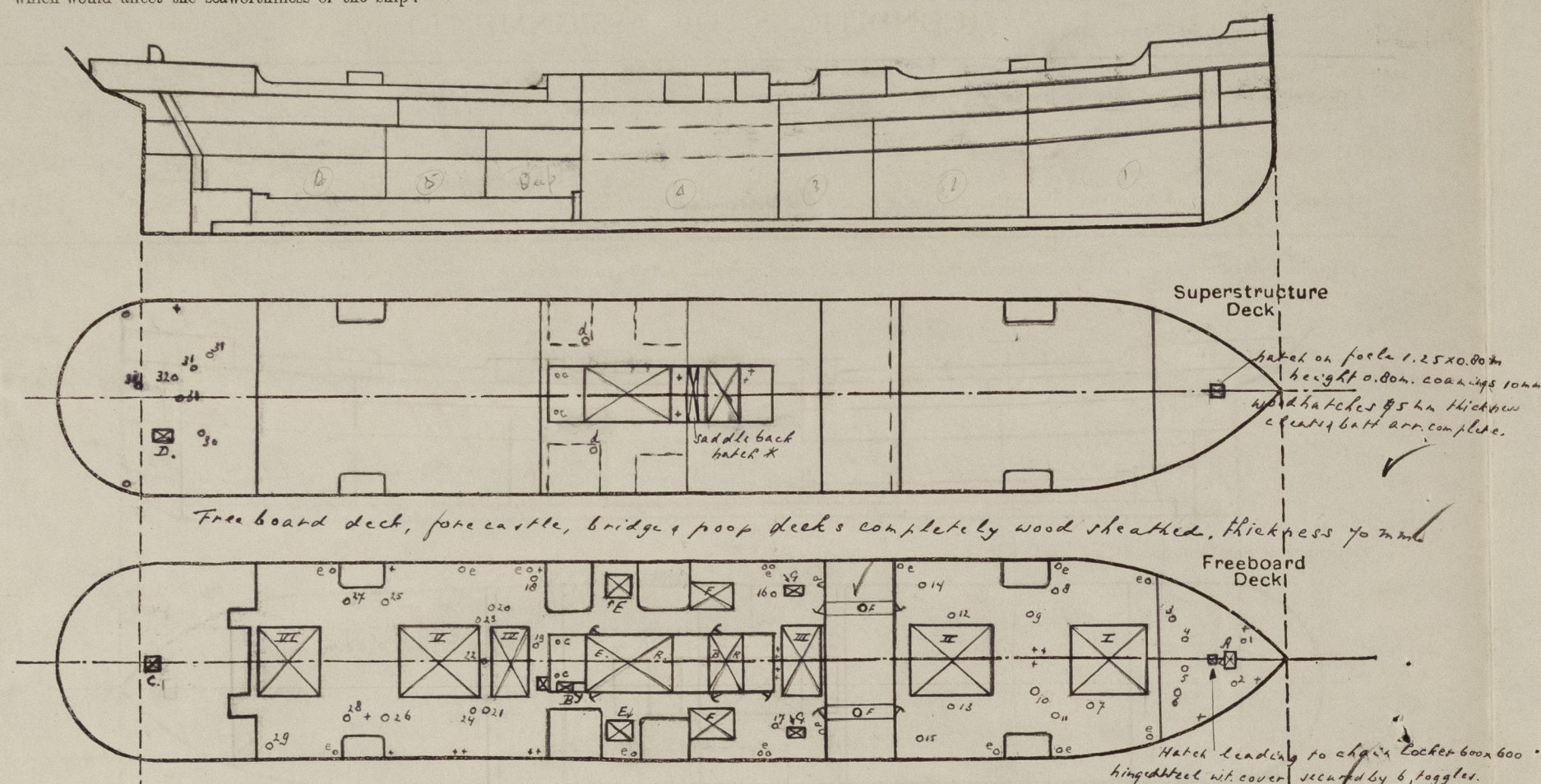

Saddle back side openings leading to tween deck spaces closed up, saddle back space now used for galley coal.

Particulars of fiddle, funnel and ventilator coamings, engine room skylight and other openings in machinery casing tops and their means of closing:—

Fiddle top, covers on openings in same, funnel, ventilator coamings and engine room skylight all of a strong construction. Strong steel covers fitted on openings in engine room skylight.

## Particulars of Flush Bunker Scuttles:—

2 flush bunker scuttles, strongly constructed, are fitted inside the bridge, dia 500 mm, provided with a permanent chain attachment (marked F in sketch).

## Particulars of Companionways:—

- In fore-castle door in trunk from hatch to space above fore-castle deck op. 1200 x 75 mm, door 150 x 100 mm, sill 0.40 m, steel hinged door operated from both sides.
- After mach. casing i.e. companion way to tween deck, deck op. 2111 mm, door op. 150 x 70 mm, hinged wood door (p. both sides) sill 0.61 mm.
- Funnel escape in poop, deck op. 2000 mm, door op. 1600 x 55 mm, hinged wood door, operated both sides, sill 0.30 m.
- On poop deck companion to poop space, deck op. 1900 x 80 mm, door op. 160 x 66, sill 0.30, hinged steel door, operated from both sides.

## Particulars of Ventilators in exposed positions on freeboard and superstructure decks:—

Coaming	Leading to	Coaming	Leading to	Coaming	Leading to
Nº dia height		Nº dia height		Nº dia height	
1 270 910 9	fore-castle space	14 450 760 10	Nº 2 lower hold	26 550 760 10	Nº 5 lower hold
2 250 910 9	space above fore-castle	15 450 760 10	Nº 2 upper tween deck	27 550 760 10	Nº 6 lower hold
3 530 910 10	Nº 1 upper tween deck	16 300 760 9	forward deep tank	28 550 760 10	Nº 6 lower tween deck
4 450 910 10	Nº 1 lower hold	17 300 760 9	Nº 3 upper tween deck	29 450 2800 10	Nº 6 lower hold poop
5 450 910 10	Nº 1 lower tween deck	18 300 760 9	Nº 3 lower tween deck	30 550 760 10	Nº 6 lower tween deck
6 270 910 9	fore-castle space	19 300 760 9	Nº 4 upper tween deck	31 150 150	mach room ventilation
7 550 910 10	Nº 1 lower tween deck	20 450 760 10	Nº 4 upper tween deck	32 450 760 10	Nº 6 upper tween deck
8 350 910 10	Nº 1 lower hold	21 450 760 10	after deep tank	33 300 760 9	steering gear comp.
9 450 910 10	Nº 2 lower hold	22 450 760 10	Nº 4 upper tween deck	34 250 760 9	Nº 4 upper tween deck
10 450 910 10	Nº 2 lower tween deck	23 450 760 10	Nº 5 upper tween deck	35 500 760 9	engine space over bunkers
11 550 910 10	Nº 1 lower tween deck	24 500 760 10	Nº 5 lower hold	36 125 910 10	goose necks for upper tween decks
12 550 760 10	Nº 2 lower tween deck	25 500 760 10	Nº 5 lower tween deck		wood plugs & canvas covers provided for all ventilators
13 550 760 10	Nº 2 lower hold				

## Particulars of Air Pipes in exposed positions on freeboard, raised quarter, or superstructure decks:—

Air pipes are situated as given in the sketch, marked +, height 920 in wells, 4600 on superstructure deck. Wood plugs and canvas covers complete. Bunker air pipes brought up 2500 mm above engine room casing.

## Particulars of Gangway Cargo and Coaling Ports:—

None fitted.

## Particulars of Scuppers and Sanitary Discharge Pipes:—

Free board deck scuppers, curved pipes through deck & shell. ✓  
No lavatories or wash places are situated below the freeboard deck. ✓  
Sanitary discharge pipes from spaces on the freeboard deck, discharging below the freeboard deck are fitted with automatic non return valves. ✓

## Particulars of Side Scuttles:—

Side scuttles are of substantial construction and fitted with strong hinged deadlights. ✓  
One side scuttle is situated below the freeboard deck in provision room a/baft engine room p.s. 250 mm dia. ✓  
All other existing side scuttles below the freeboard have been removed and plugged off. ✓

Vertical distance of Sill of lowest Side Scuttle above top of keel 10340 mm.

## Particulars of Guard Rails:—

Plain bulwarks in wells, height per below, top rail 165 x 75 x 11, stanchions 180 x 10, spacing 1.00 m, double lug on deck, single against bulwark. ✓  
Guard rails on poop, fore-castle & boat deck, height 1.05 m, forged stanchions, non-slip, 2" pipe on top, two 1" rods between. ✓

## Particulars of Gangways, Lifelines, etc.:—

Steel wire rope life lines set up with stretching screws between the erections are fitted together with rope through stanchions, fitted in permanent sockets, hand rails on sides of deck houses. ✓

## Particulars of Freeing Arrangements.

	Length of Bulwark	Height of Bulwark	Size of Freeing Ports	Number each side	Area each side	Rule area each side
After Well ...	33.55 m	1.05 m		five	9.2 m <sup>2</sup>	2.05 m <sup>2</sup>
Between bridge wing & fore	15.80 m	1.05 m		three	2.4 m <sup>2</sup>	1.09 m <sup>2</sup>
Forward Well ...	29.28 m	1.05 m		four	7.6 m <sup>2</sup>	1.8 m <sup>2</sup>

State position of each freeing port (F. and A. position and height above deck edge) { After Well:— } please see sketch  
{ Forward Well:— }

State whether the freeing ports are fitted with shutters, bars, or rails, and give particulars of such:—

Additional area where sheer is less than standard.

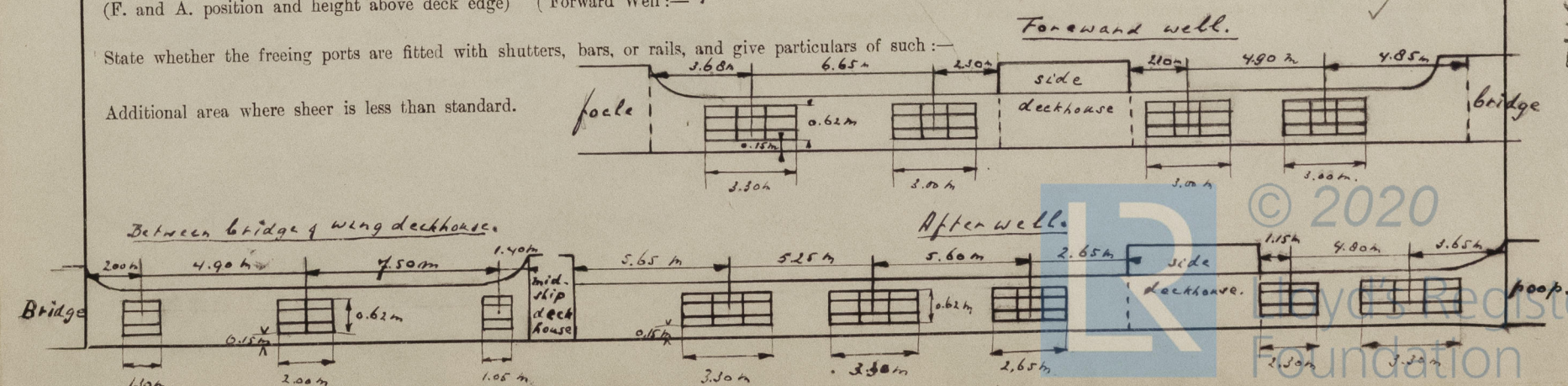

© 2020

Foundation

05462-005462-031212



# PARTICULARS OF PROTECTION TO OPENINGS, ETC.

HATCHWAYS ON FREEBOARD AND SUPERSTRUCTURE DECKS.										
please see sketch.										
Description of Hatchway	I	II	III	IV	V	VI	Provision Room Hatchway	Hatch E	Hatch F	Hatch G
Dimensions of Hatchway	8.50 x 6.10	9.25 x 6.10	4.60 x 6.10	8.95 x 6.10	9.25 x 6.10	7.25 x 6.10	1.70 x 1.40	5.10 x 1.80	4.90 x 2.80	1.35 x 1.15
COAMINGS	Height above Deck ... 760 mm	760 mm	760 mm	760 mm	760 mm	760 mm	760 mm	760 mm	760 mm	760 mm
	Thickness ... 11 mm	11 mm	11 mm	11 mm	11 mm	11 mm	11 mm	11 mm	11 mm	11 mm
	Sides ... 11 mm	11 mm	11 mm	11 mm	11 mm	11 mm	11 mm	11 mm	11 mm	11 mm
	Stiffeners ... 11 mm	11 mm	11 mm	11 mm	11 mm	11 mm	11 mm	11 mm	11 mm	11 mm
	Brackets & Stays ...									
HATCH BEAMS	Number ... five	five	two	two	five	four			three	
	Spacing ... 1.42 m	1.54 m	1.54 m	1.32 m	1.54 m	1.45 m			1.23 m	
	Scantling and Sketch ...									
	Bearing Surface ...									
FORE AND AFTERS	Number ... 100 x 75 x 11	100 x 75 x 11	100 x 75 x 11	100 x 75 x 11	100 x 75 x 11	100 x 75 x 11				
	Spacing ... 432 x 9	460 x 9	460 x 9	405 x 9	460 x 9	439 x 9				
	Unsupported Lengths ...									
	Scantling* and Sketch ...									
	Bearing Surface ...									
HATCH COVERS	Material ...		wood				wood	wood	wood	wood
	Thickness ...		75 mm				75 mm	75 mm	75 mm	75 mm
	How fitted ...		fit a.				fit a.	fit a.	fit a.	fit a.
	Bearing Surface ...		90 x 80 mm				75 mm	75 mm	75 mm	75 mm
Spacing of Cleats										
Number of Tarpaulins										
<p>*Are wood fore and afters steel shod at all bearing surfaces? not fitted</p> <p>Are battens and wedges efficient and in good condition? yes</p> <p>Are tarpaulins in good condition and in accordance with rule requirements? yes</p> <p>Are lashings provided in accordance with rule requirements? yes</p>										

Particulars of any special features:—

Endorsement at first survey and at surveys for renewal of Certificate:—

The fittings and appliances are in accordance with the particulars shown on this form (or as now modified) and are in good condition.



© 2020

Lloyd's Register  
Foundation